

CO-ORDINATION:
Where the drawing relates to completed construction the contractor is responsible for checking that there is no conflict between actual building dimensions and indicated drawing dimensions.

DISCREPANCIES:
In the event of discrepancies between this drawing and subcontractor's working drawings for relevant building components, the subcontractor's drawing shall take precedence.

ON SITE PROCEDURE:
Any conflicts arising out of information as noted above must be reported immediately.

COPYRIGHT:
This drawing is the copyright of Glynn Williams Architects Ltd and it is forbidden to reproduce this drawing in part or full without written permission.

DIMENSIONS:
All dimensions are in millimetres unless otherwise stated.

REMNANT STREET

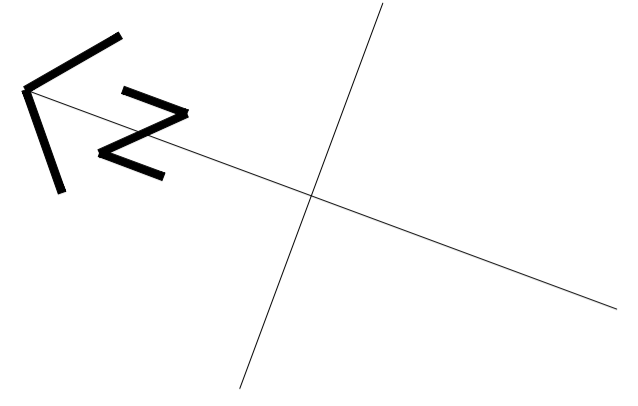
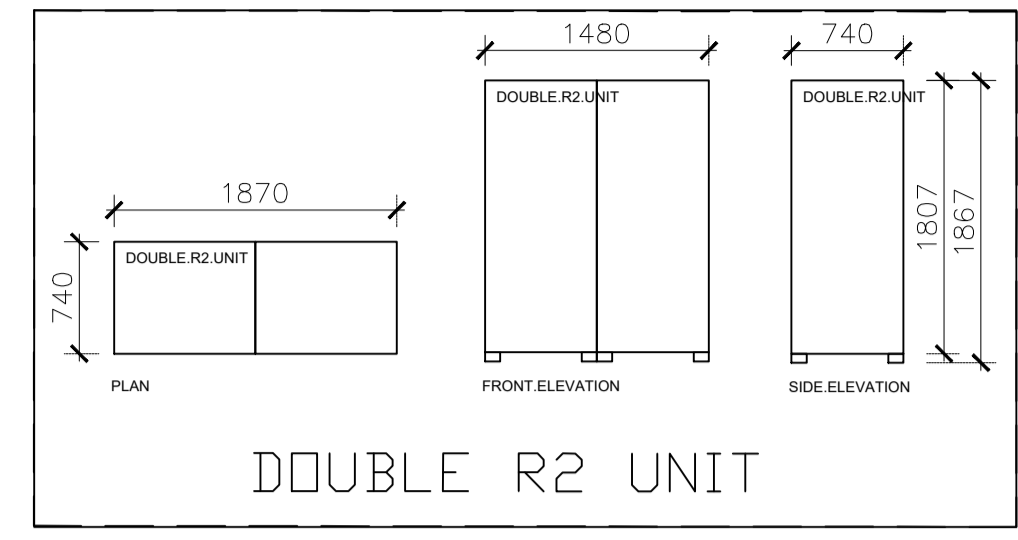
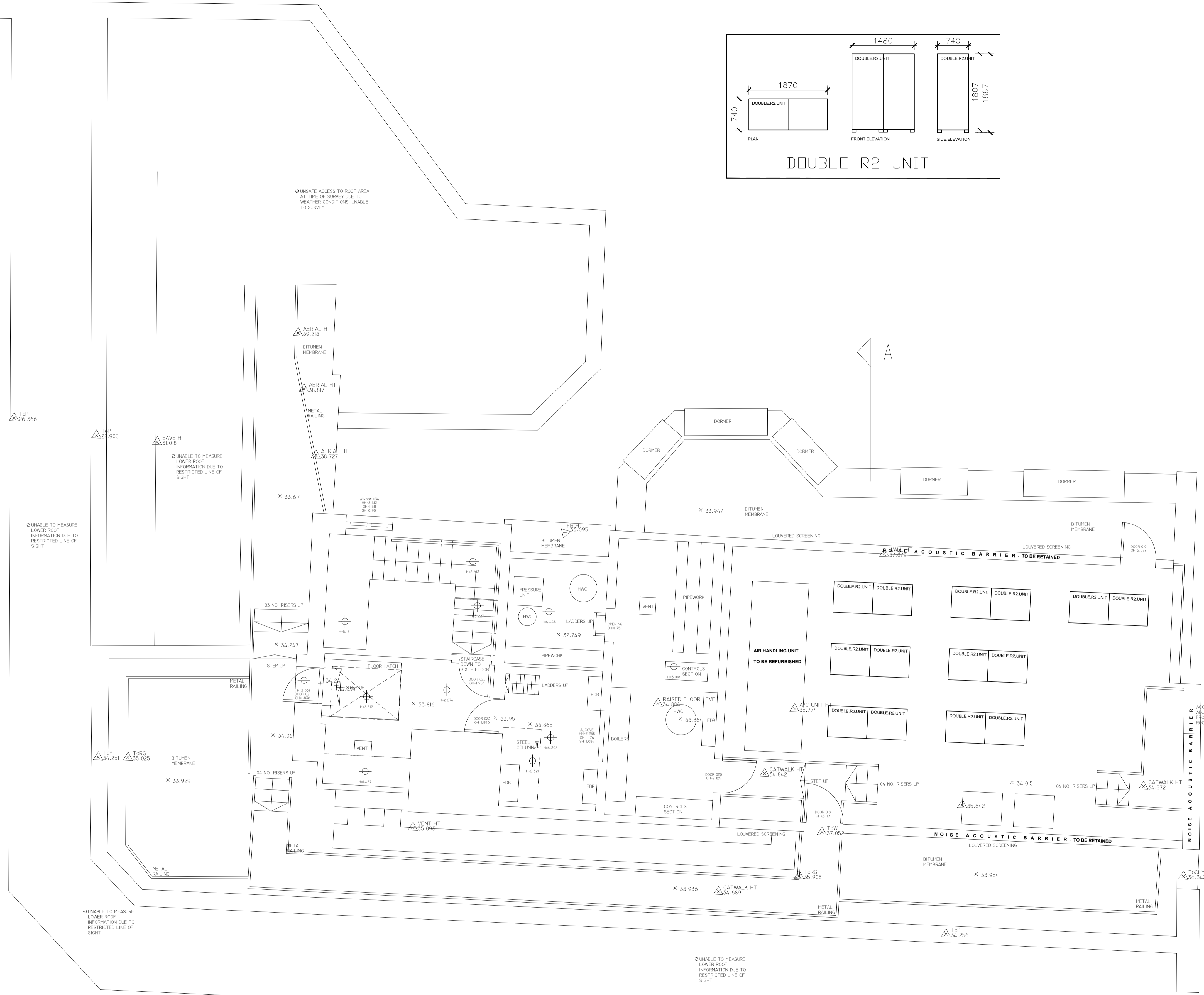

LEVEL 7 ROOF PLAN



KINGSWAY

W2-00 Window Reference - by floor
R200 Room Reference - by floor
D2-00 Door Reference - by floor

drawing title: LEVEL 7 ROOF PLAN - AS PROPOSED		rev.:	
date: 18/02/2019	scale: 1:50 @ A1	dwg.no. 1HK/RP07PR	rev. A

ARKELL IMPERIAL BUILDINGS REFURBISHMENT PROJECT.

Glynn Williams Dip.Arch(Hons) RIBA Chartered Architects

RIBA Chartered Practice

1 Highfield Close, Danbury, Essex, CM3 4EG
01245 - 222692
07973 - 835067