

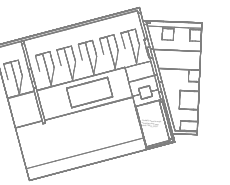

0m 2m 4m 6m 8m  
Drawing Scale 1:100 @ A1  
This drawing is subject to copyright and is not to be reproduced in part or whole without approval. Do not scale this drawing - check all dimensions on site

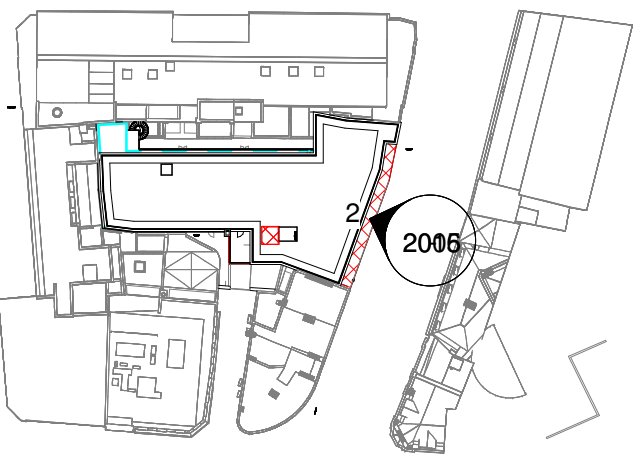

3 East Aspect  
1 : 1000

#### Materials

- Existing red brick facade
- Crittles style windows to be refurbished and repainted or replaced as required.
- Existing white rendered banding to be repainted
- Opening made larger to give more impressive entrance. White banding to be removed and replicated in new set back entrance.
- New painted galvanised railing.
- New painted steel framework to surround glazing.
- Render to fire escape to be repainted and repaired where needed.
- New powder coated minimal framed glazing system.
- New Fire escape stairs to meet current regulations.
- New painted black steel framework to surround entrance.
- New rendered finish to third floor fire escape extension.
- New roof.

#### ZZ Proposed East Elevation 1 : 100

P3	DESIGN CHANGES MADE	22.02.2019
P2	CONTEXT ADDED	14.02.2018
P1	MATERIAL CHANGE AND ADJUSTMENTS	14.02.2018
Rev	Description	Date
Client		
Senator Group		
Project		
White Bear Yard Clerkenwell		
Drawing Title		
Proposed East Elevation		
Drawn by	MA	Checked by ND Date 22.02.2019
C+A Job no.	9031	Status S4 - PLANNING Scale @ A: As indicated
Drawing no.	WBV-CAA-V1-ZZ-DR-A-2015	Rev. P3
Cassidy+Ashton		
Architecture + Building Surveying + Town Planning		
7 East Cliff, Preston, Lancashire, PR1 3JE T: 01772 258 356 10 Hunters Walk, Canal Street, Chester, CH1 4EB T: 01244 402 900 St Andrews Business Centre, Mold, Flintshire, CH7 1XB T: 01352 706 246		