

PROPOSED EAST ELEVATION

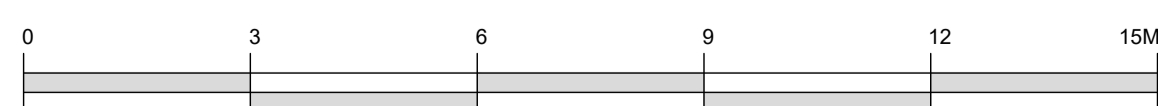

EXISTING EAST ELEVATION

Revisions					Revisions						
Rev	Date	By	Description	Checked	Approved	Rev	Date	By	Description	Checked	Approved
P1	18.01.17	ABF	EM&P Preliminary Issue	LP	RH						
P2	05.04.18	RS	Rationalised dormers, extensions & bat boxes	JM	RH						
P3	20.04.18	RS	Planning Amendments	JM	RH						
P4	22.10.18	TS	East Extension Amendment	JM	RH						
P5	29.11.18	RS	Bat and Bird Box Amendments	JM	RH						



For electrical services (inc. lighting and cctv) refer to MEP engineer drawings
 For finishes refer to 289_1_2_Planning Facing Materials_1128L
 For bat and bird box specifications refer to 289_1_2_Planning Bird and Bat Boxes

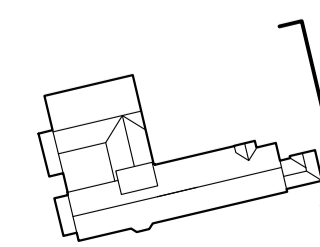

Client Sign Off	North	Archived / Original: Tate Harmer	Unit G182, Stamford Works, 3 Gilbert Street, London N16 8JH	Do not scale. All dimensions to be checked on site. This drawing is copyright.
		Client: Platinum Land	8 Quercet House, 1 Duke of York Square, Kings Road, London, SW3 4LY	
		Project: Belsize Park Firestation	Date of Origin: 28.11.17	Drawn By: ABF
		Drawing Title: Proposed and Existing East Elevation	Scale: 1:100	Drawing Status: Planning
		Drawing Number: BFS THA PR AL 330 P5		