

[01] EXISTING BASEMENT PLAN @1:100

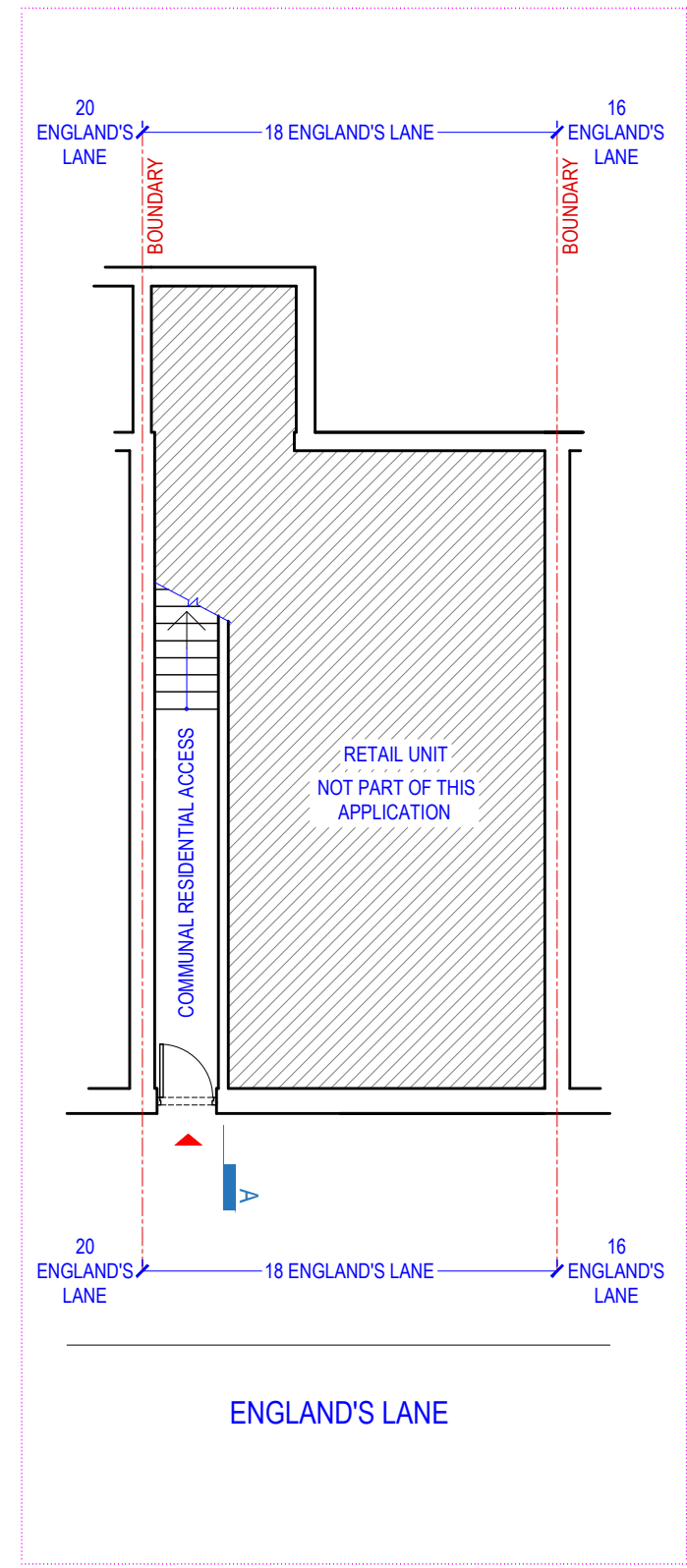

[02] EXISTING GROUND FLOOR PLAN @1:100

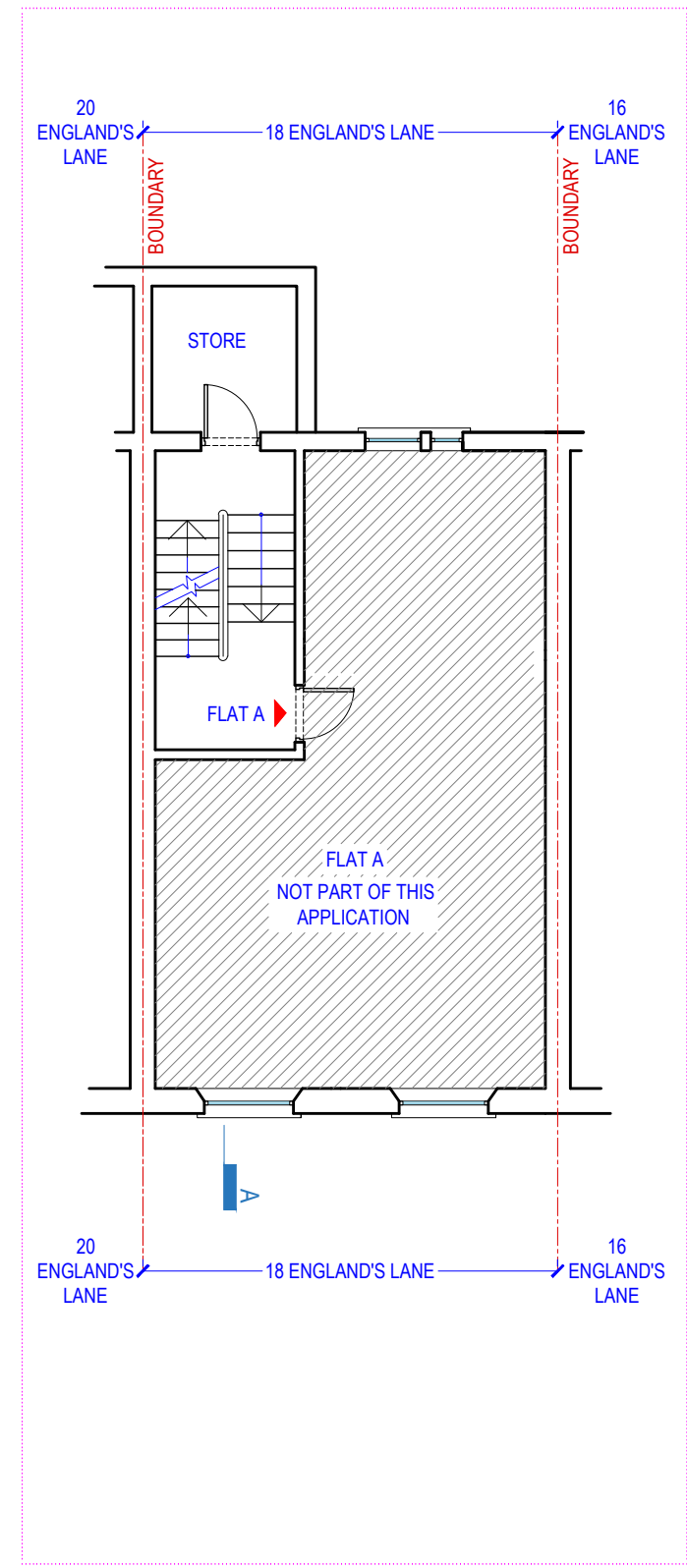

[03] EXISTING FIRST FLOOR PLAN @1:100

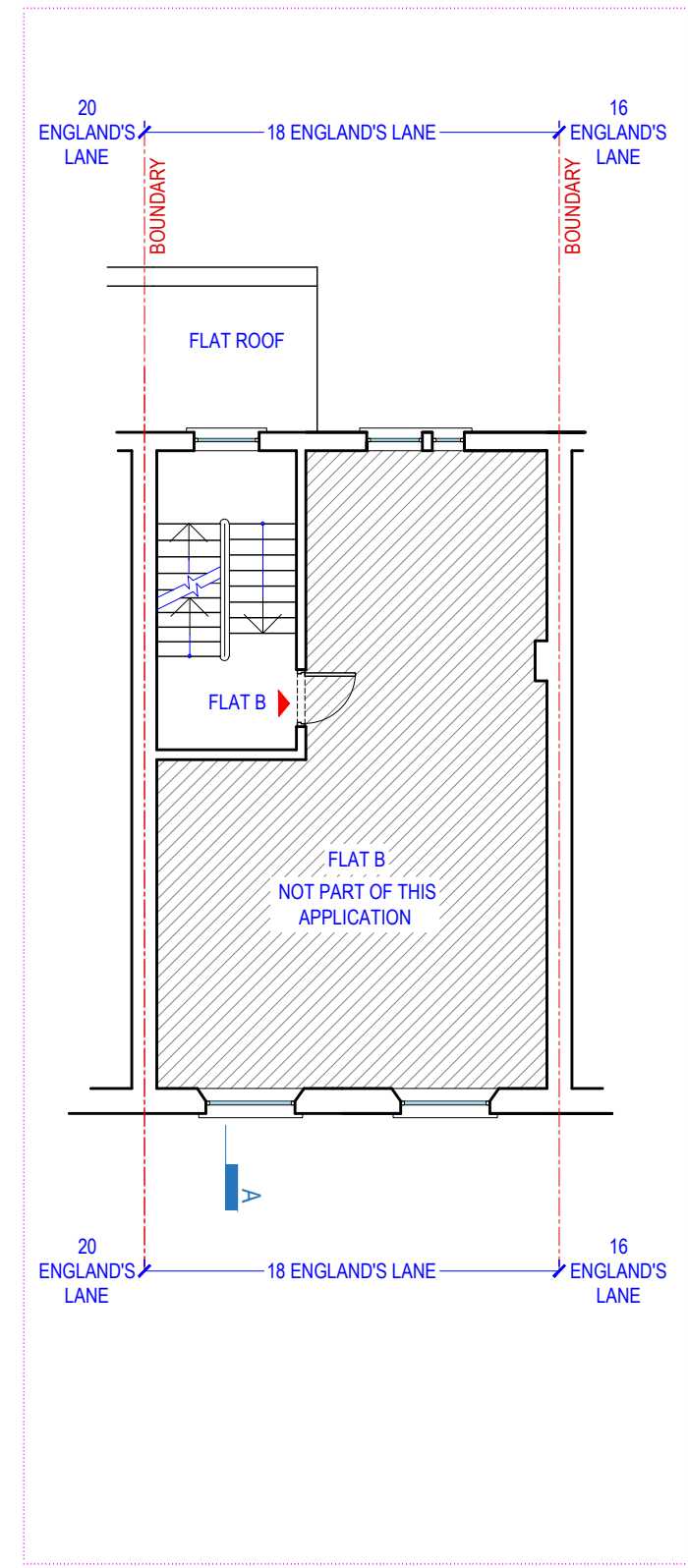

[04] EXISTING SECOND FLOOR PLAN @1:100

NOTE:  
DO NOT SCALE FROM DRAWINGS - EXCEPT FOR PLANNING PURPOSES.  
ALL DISCREPANCIES TO BE REPORTED TO ARCHITECT IMMEDIATELY.  
ALL DIMENSIONS TO BE VERIFIED BY CONTRACTOR ON SITE PRIOR TO THE COMMENCEMENT OF ANY WORKS.

P1 18/02/19 Issue For Planning

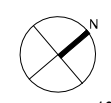

**VIVENDI ARCHITECTS LTD**  
Unit E3U, Bounds Green Industrial Estate, Ringway, London N11 2UD  
Tel/Fax +44 (0)20 3232 4000 - email: info@vivendiarchitects.com  
© VIVENDI ARCHITECTS LTD 2009  
All rights reserved, including but not limited to The Copyright, Designs and Patents Act 1988

**ISO-A3**

PROJECT TITLE:  
**18 ENGLAND'S LANE, LONDON NW3 4TG**

DRAWING TITLE:  
**Existing Basement, Ground, First & Second Floor Plans**

CLIENT:  
**LXE INVESTMENTS LTD.**

DRAWN: SM	STATUS: PLA
CHECKED: GK	SCALE AT A3: 1:100
ISSUED BY: GK	REVISION: P1
JOB AND DRAWING NO.:	

**1715-E02-00**