

DO NOT SCALE

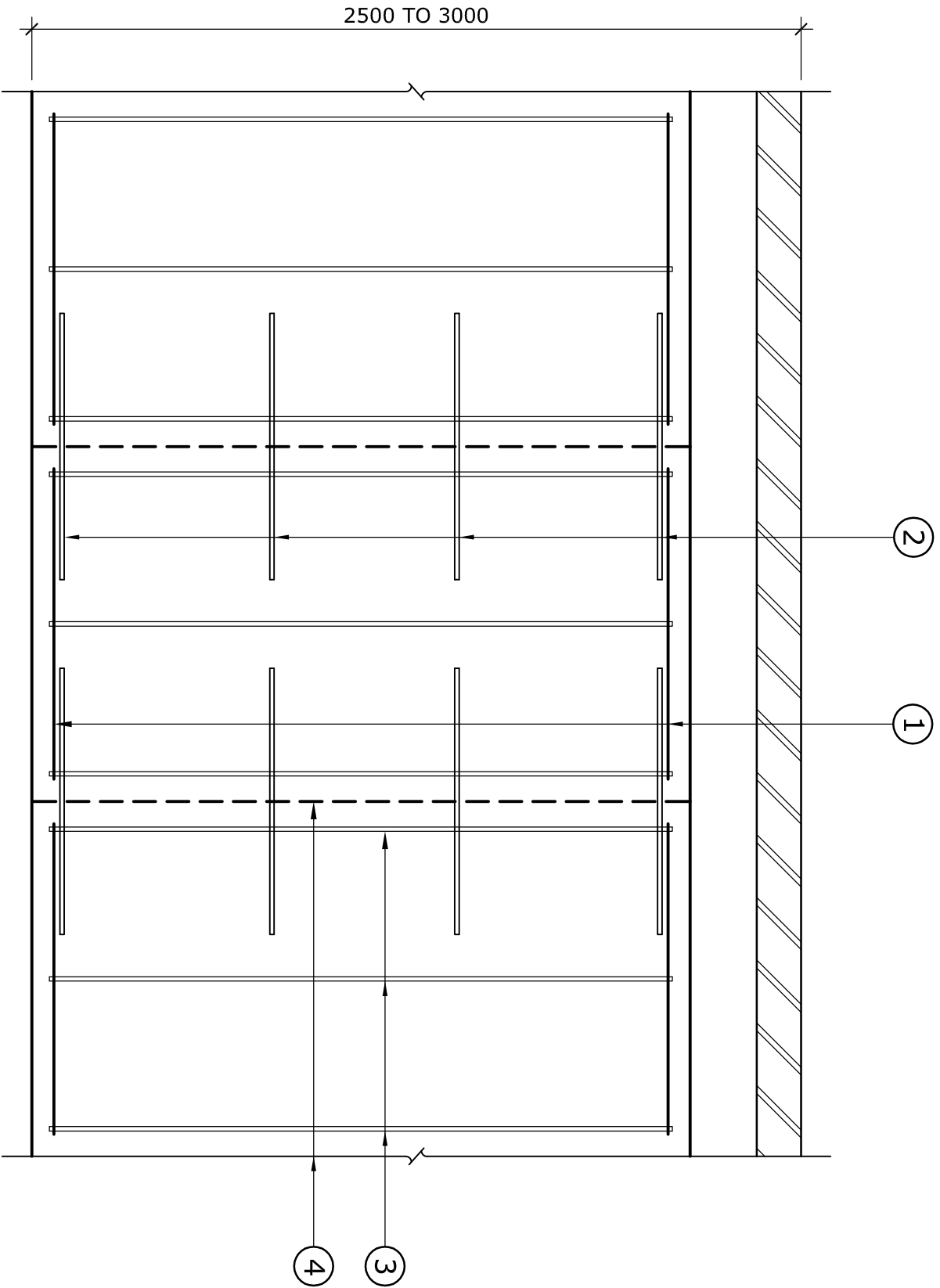

KEY
① 8H12 longitudinal bars (4t, 4B)
② 8H12 dowel bars bent straight on site
500
③ H10 overlapping 'U' bars
④ Joint between boys consist of exposed h/y/b and dowels. Place 1200g polythene on excavation of adjacent boy.
⑤ Surface to be reinstated as existing
⑥ Backfill to working space to be 300mm concrete plug or as detail with dot type 2 material compacted in 150mm maximum layers over
* Engineer to inspect and determine extent and depth of foundations
Suggested construction boys

HEALTH AND SAFETY
1. The contractor is responsible for identifying hazards and for carrying out risk assessments and for taking all necessary precautions to eliminate or reduce risks so far as reasonably practicable. The Engineer can advise if required.
2. The following hazards are known: i) Collapse of excavations. All excavations to be shored. ii) Underground services. Services may be present. Contractor to check and locate. iii) Building to remain occupied. Contractor to agree with residents areas of control and access. iv) Silica dust from breaking out; dampen down to avoid dusting. PPE essential. v) Exposure to noise: ears defenders essential. vi) Exposure to exhaust fumes: vent to external air.

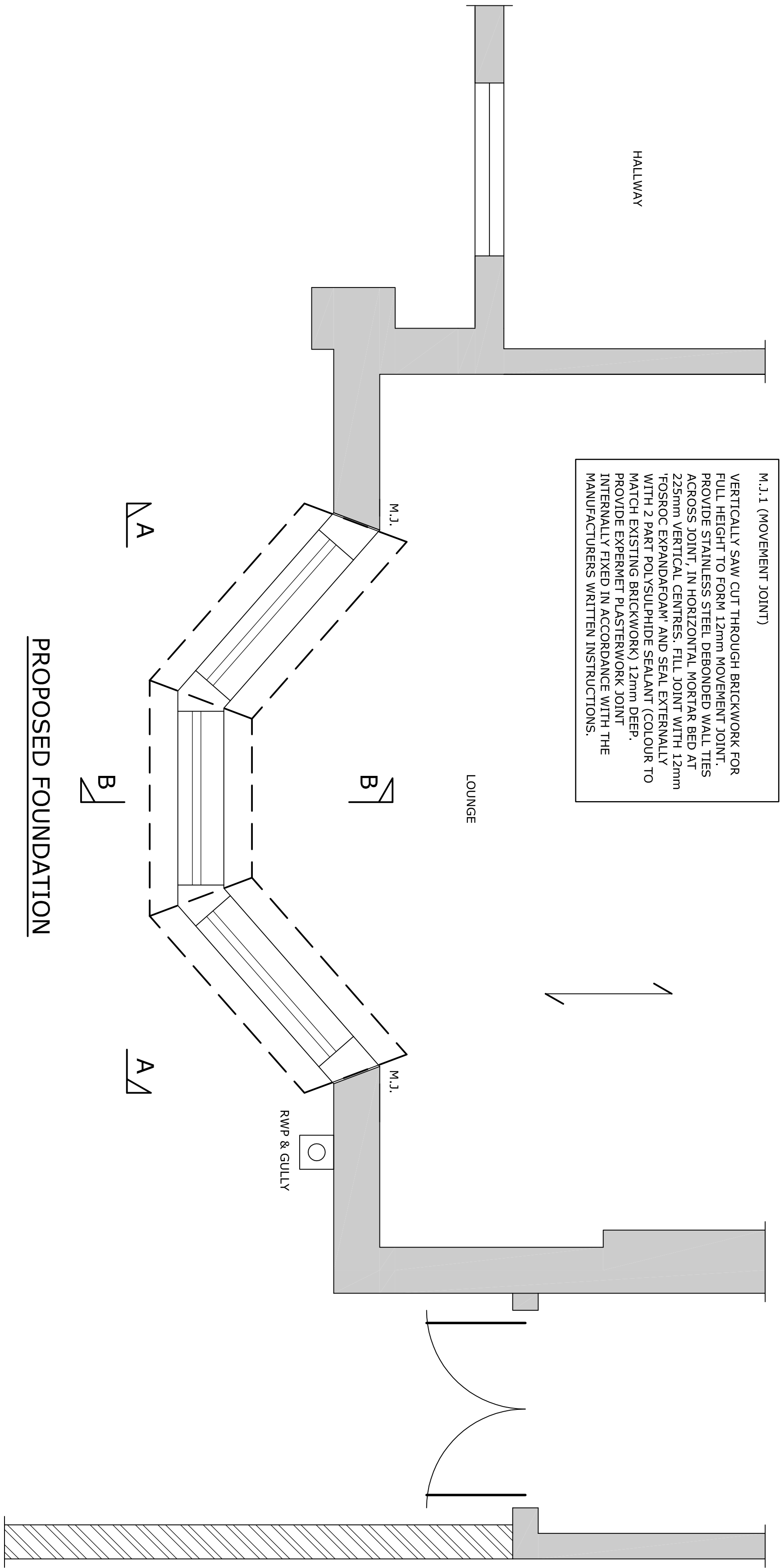
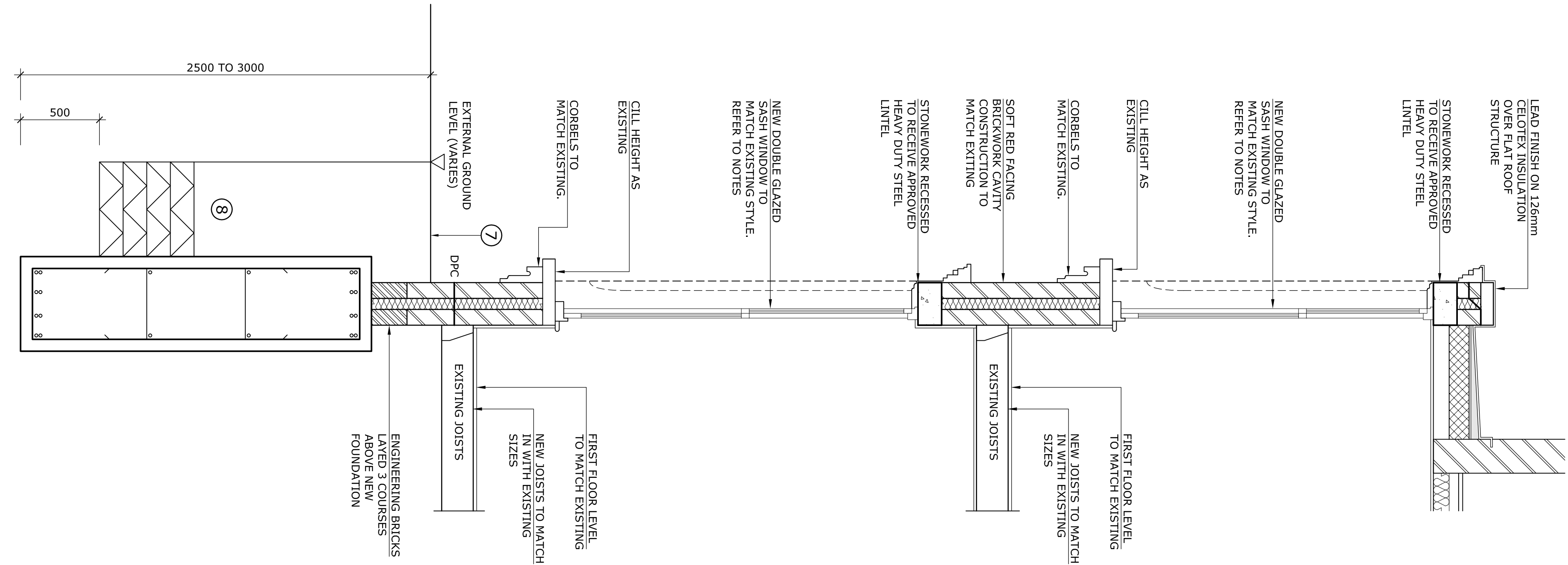

GENERAL NOTES

- See drawing 52859/B/03 for main Notes and requirements.
- The drawings, design and all information contained therein are the sole property of Richard Jackson Ltd. No part of this drawing may be reproduced or used in any form without written permission of the Engineer.
- All drawings shall be read in conjunction with all relevant Civil / Structural Engineers drawings, the project specification and Architects Services Engineers & Landscape Architects drawings.
- For all setting out information, D.P.M., D.P.C., finishes and waterproofing details refer to the Architects drawings and details.
- The Contractor shall verify all site and setting out dimensions before putting work in hand. Where dimensions are shown on the Engineers drawings, any discrepancies shall be reported to him.
- Dimensions must not be scaled from the Engineers drawings.
- All dimensions are in millimetres unless noted otherwise.
- Dimensions marked * are subject to confirmation by site measurement before construction proceeds.
- All dimensions are given to structural surfaces unless noted otherwise.
- All lighting connectors to be fixed in accordance with specialist details.
- No holes, chases, cut-outs, existing or proposed services or the like may be formed in or pass through any beam, column, or load bearing wall unless written permission is obtained from the Engineer.
- Contractor to confirm location of all services refer to the Service Engineers and Architects drawings.
- Inspections made by the local Authority, NHBC or other Statutory bodies, shall be arranged by the Contractor to suit the programme. Any costs arising out of the inspection shall be the responsibility of the Contractor.
- Non-structural things are generally not shown on the Engineers drawings and if any such detail is indicated it must be confirmed by cross-reference to other specialists before construction.
- All drawing specifications are given in accordance with NBS (National Building Specification) e.g. E10/E130 which refers to NBS Section E10, Clause 130.

REV	DATE	DESCRIPTION	DRAWN	CHECKED

REVISIONS

This drawing is to be read in conjunction with all other Designer's drawings and all other project information. Any discrepancy between the drawings and other project information is to be reported to the Contract Administrator immediately.



Project
**DEMOLITION & RECONSTRUCTION
OF FRONT BAY -
2 TANZA ROAD, LONDON,
NW3 2UB**

The
**PROPOSED SECTIONS &
FOUNDATION PLAN**

Client
MR EDWARD LYNDON-STANFORD

Scale	Drawn	Date
NTS	J.BAKER	DEC 2018
Job Manager	Checked	Approved
R.CALCUT	R.CALCUT	

48/ The Grange, Colindale, Essex CO1 1PQ
Tel: 01206 228880
Fax: 01206 228881
5 Green House, Mill Lane, Great Shelford, Cambs CB22 3SD
Tel: 01223 314949
4 The Red Church, St. Matthews Road, Norwich, Norfolk NR1 1SP
Tel: 01603 200248
The Whitehouse, South Hill, Bournemouth, Dorset BH10 3PF
Tel: 01172 020070
Email Address: info@rjcl.co.uk
Website: <http://www.rjcl.co.uk>

SECTION B-B

SCALE 1:20

REFER TO DRAWING 52859/B/02 FOR
EXISTING PLANS & ELEVATIONS

REFER TO DRAWING 52859/B/03 FOR
PROPOSED PLANS & ELEVATIONS