



FRESSON
AND TEE

6th Floor Queens House
55-56 Lincoln's Inn Fields
LONDON WC2A 3LJ

020 7391 7100 www.fandt.com

THIS IS A CAD DRAWING
Under no circumstances shall manual alterations be made.
Any discrepancy found between this drawing and any other document should be referred immediately to the architect.
No dimensions are to be scaled from this drawing and all measurements should be checked on site.
Copying or reproduction of this drawing without the written permission of Fresson and Tee is not permitted.
Copyright is Reserved

Disclaimer
The hard copy accompanying the electronic data is legal transmission of information. The electronic copies are issued only for convenience of use. No responsibility for the accuracy or for any consequence resulting from the use or alteration of information is accepted.

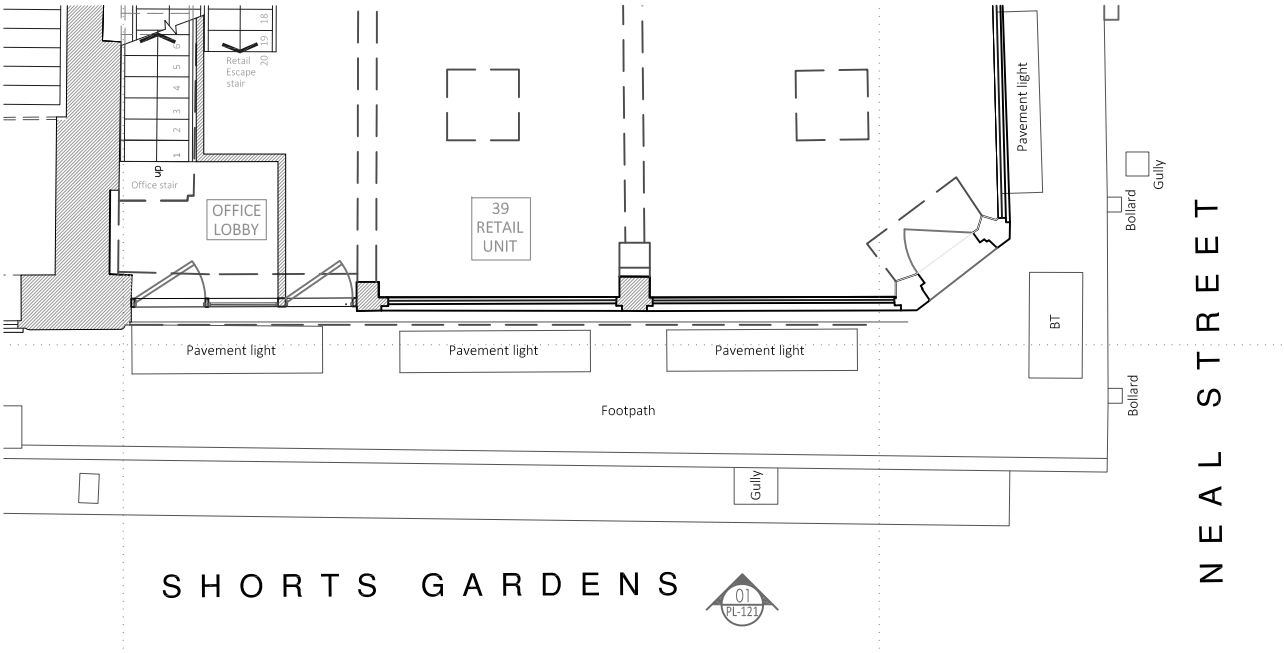

01 - PROPOSED - GROUND FLOOR PLAN
1:100 @ A3



| | | | |
|-----|------|---------------------|----------|
| | | | |
| | | | |
| | | | |
| | | | |
| | | | |
| A | DF | ISSUED FOR PLANNING | 04/02/19 |
| REV | D.B. | Description | Date |

| | |
|------------------------------|-------------|
| DRAWING TITLE | |
| Proposed - Ground Floor Plan | |
| PROJECT NAME | |
| 39 Neal Street | |
| ADDRESS | |
| 39 Neal Street WC2 9QG | |
| CLIENT | |
| Shaftesbury CL Ltd. | |
| JOB NO. | DRAWING NO. |
| 23161 | PL - 120 |
| SCALE | DATE |
| 1:100 @ A3 | FEB. 2019 |
| DRAWN BY | CHECKED BY |
| DF | - |