

Based on information supplied by others
All dimensions are approximate
Do not scale from this drawing

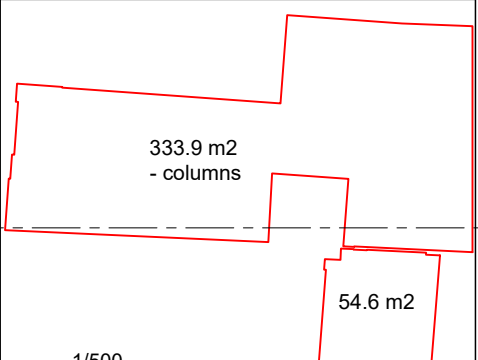

- 1/500
- A/C 700x600x200 or 1170x630x220
 - New wall
 - Existing wall to be removed

D	AA	06/02/19	Access floor throughout. Add lift lobby door
C	AA	19/12/18	As Lazari Investments comments 18/12/18
B	AA	13/12/18	As Lazari Investments comments 12/12/18
A	AA	06/12/18	One WC re-located near lift lobby

Rev	Drawn	Date	Description
-----	-------	------	-------------

2 'Cat A'

Contract
97-99 Camden High Street
London NW1

Drawing Title
Proposed
Second Floor

CDS PROJECTS LTD
22 Woodbastwick Road, London SE26 5LH
M 07802 441750

Scales	1/100 (at A3)	Date	October 2018
Drawn	AA	Checked	
Contract No	18/07/Li	Drawing No	G/12
		Revision	D