

revision / date / amendments

- / 26/01/18 /	- First Issue
A / 02/02/18 /	- WC indicated under Dome.
B / 01/03/18 /	- Windows numbers updated in line with window schedule.
C / 23/03/18 /	1. Tender Addendum (1), indication of 4 post truss fixed at stage level for integrated automatic retractable acoustic baffles and integrated lighting rig. 2. Tender Addendum (2), New AHU + Attenuator over stage to be hung to existing relocated secondary beams in Flytower.
D / 09/04/18 /	- Alterations to 3rd floor ID layout.
E / 12/04/18 /	- Window and door numbers updated.
F / 01/06/18 /	1. Indication of 4 post truss fixed at stage level for integrated automatic retractable acoustic baffles and integrated lighting rig. 2. New AHU + Attenuator over stage to be hung to existing relocated secondary beams in Flytower.
G / 05/07/18 /	- Updated stage 4 fit out interior and kitchen layouts.
H / 31/07/18 /	3.1. AV/IT rack room added with cooling 3.5. Ventilation grille for fresh air to dressing rooms
I / 15/08/18 /	Colour coding added to revised drawing Rev H
J / 29/01/19 /	Retrospective Planning for Dome Propping up works.

LEGEND

- Proposed Works
- Existing Building Fabric KOKO née Camden Palace Theatre (1900)
- Existing Building Fabric Hope & Anchor (approx. 1850)
- Existing Building Fabric Bayham Place (from 1875)
- Existing Modern Building Fabric Bayham Place (from 2006)
- Building Fabric to be demolished
- Demolition of Flooring / Elevation / Wall
- Proposed Excavation
- Remove and retain in alternate location
- Retain and protect existing
- Retain, make good, ease and adjusted
- Means of escape Route
- Private Members Route
- Koko Customer Route
- Public Route
- Artist Route
- Proposed Riser
- Proposed Risers Above
- RM.4-06 Room Number
- D4-02 Door Number
- W4-05 Window Number
- Hope & Anchor Demise
- Koko Demise
- 1 Bayham Street & 65 Bayham Place Demise
- Blue Roof

29.01.19

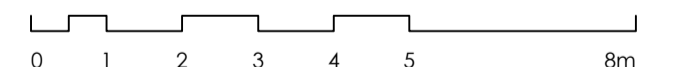
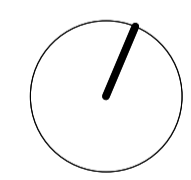

PLANNING

Archer Humphries Architects

Basement
Central House
142 Central Street
London, United Kingdom
EC1V 8AR
T: +44 (0) 20 7251 8555

project title		KOKO + Hope & Anchor + Bayham Place Camden, London	
drawing title	scale	date	
Proposed Third Floor Plan	1:100 (A1)	13.04.17	
drawing number	drawn / checked	FR/PC	DA
AHA/KCC/GA/103	revision		J

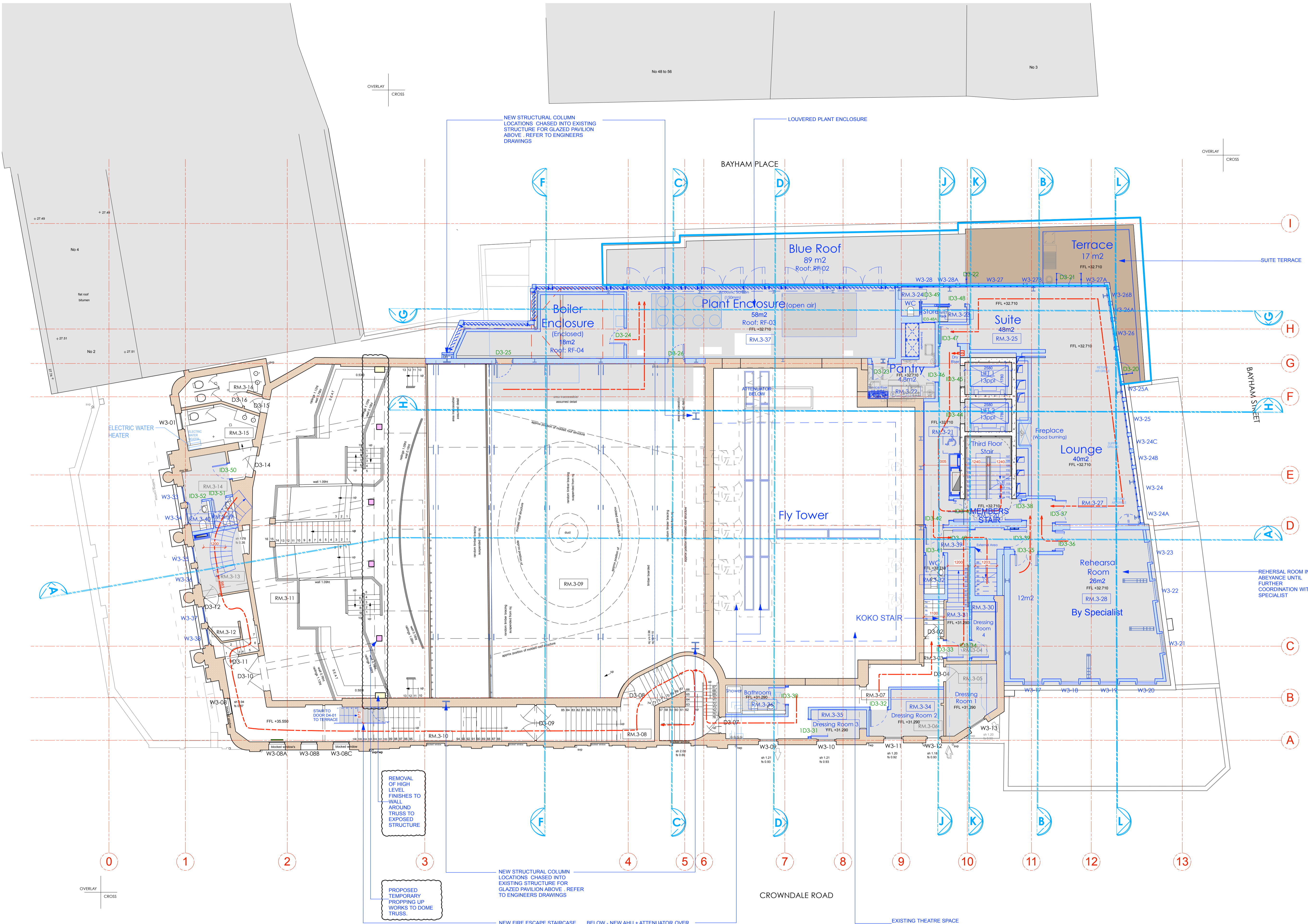

NEW STRUCTURAL COLUMN LOCATIONS CHASED INTO EXISTING STRUCTURE FOR GLAZED PAVILION ABOVE. REFER TO ENGINEERS DRAWINGS

LOUVERED PLANT ENCLOSURE

BAYHAM PLACE

Blue Roof
89 m2
Roof: RF-D2

Terrace
17 m2
FFL +32.710

Boiler Enclosure
(Enclosed)
8m2
Roof: RF-04

Plant Enclosure
(open air)
58m2
Roof: RF-03
FFL +32.710

Suite
48m2
RM.3-25

Pantry
4.50m2
RM.3-22

Lounge
40m2
FFL +32.710

Fly Tower

Rehearsal Room
26m2
FFL +32.710
By Specialist

KOKO STAIR

REMOVAL OF HIGH LEVEL FINISHES TO WALL AROUND TRUSS TO EXPOSED STRUCTURE

PROPOSED TEMPORARY PROPPING UP WORKS TO DOME TRUSS

NEW STRUCTURAL COLUMN LOCATIONS CHASED INTO EXISTING STRUCTURE FOR GLAZED PAVILION ABOVE. REFER TO ENGINEERS DRAWINGS

NEW FIRE ESCAPE STAIRCASE

BELOW - NEW AHU + ATTENUATOR OVER STAGE SUPPLYING VENTILATION TO STAGE AND TO AUDITORIUM. MEP UNITS TO BE FIXED TO SPACE FRAME AND HUNG TO FLYTOWER USING EXISTING RELOCATED SECONDARY STEEL BEAMS. REFER TO STRUCTURAL ENGINEER'S DETAILS. FLYTOWER TIMBER REPORT BY SPECIALIST AND DETAILS FROM EXTREME RIGGING.

NB: ATTENUATOR AND MEP EQUIPMENT WILL HANG ABOVE NEW 4-POST TRUSS. REFER TO AHA DRAWING AHA/KCC/DET/615 AND AHA/KCC/PR/303

EXISTING THEATRE SPACE OPENED UP WITH VIEWS UP TO FLY TOWER

REHEARSAL ROOM IN ABEYANCE UNTIL FURTHER COORDINATION WITH SPECIALIST

OVERLAY CROSS

OVERLAY CROSS