

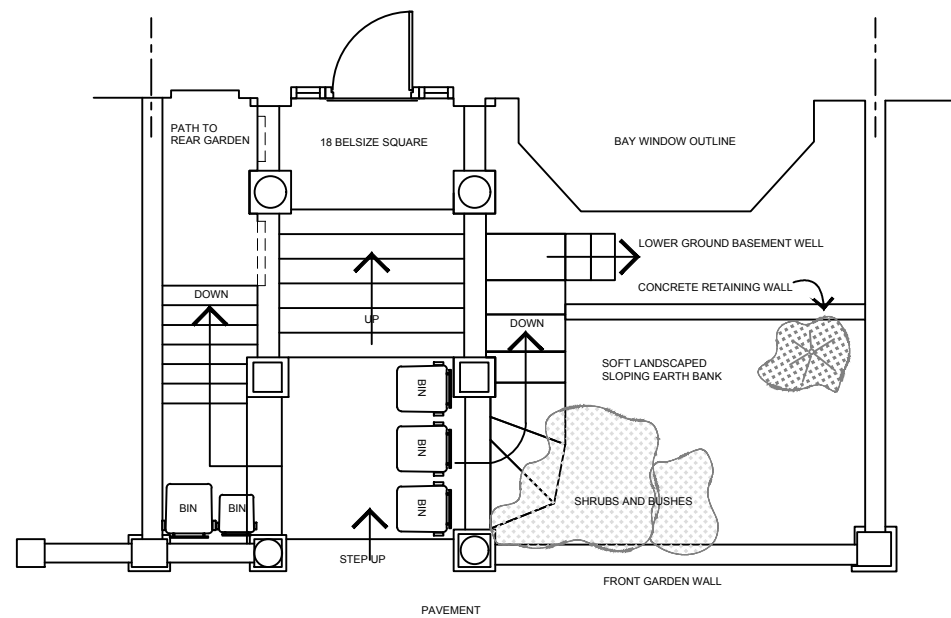

EXISTING FRONT ELEVATION

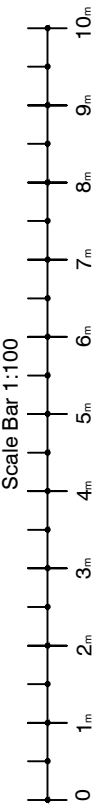

PROPOSED FRONT ELEVATION



EXISTING PLAN

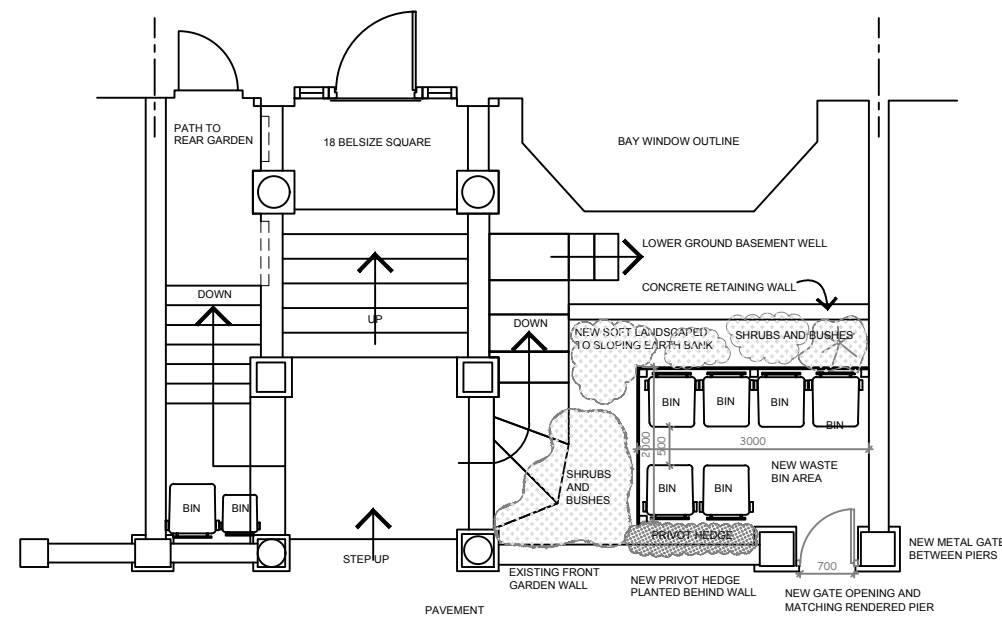

PROPOSED PLAN

A:	01/02/2019	AMENDED TO MATTHEW DEMPSEY COMMENTS
		PLANNER OF CAMDEN COUNCIL RECOMMENDS
		FRONT TIMBER FENCE REPLACED BY PRIVOT
		HEDGE BEHIND WALL + TIMBER GATE NOW METAL

REV:	DATE	DESCRIPTION
------	------	-------------

AMENDMENTS



Lewis Berkeley

92 BANNER STREET
LONDON W1B 2LL

Tel: 020 7491 3198 Fax: 020 7491 4488
email: admin@lewisberkeley.co.uk

PROJECT:-	NEW WASTE BIN AREA WITHIN FRONT GARDEN DEMISE
-----------	---

TITLE:-	EXISTING AND PROPOSED SECTION THROUGH WASTE BIN AREA
---------	--

CLIENT:-	18 BELSIZE SQUARE FREEHOLD LIMITED
----------	------------------------------------

ADDRESS:-	18 BELSIZE SQUARE LONDON
-----------	-----------------------------

DRAWN BY:-	FG	CHECKED BY:-	
------------	----	--------------	--

SCALES:-	1:100 @ A3	DATE:-	MARCH 2018
----------	------------	--------	------------

PROJECT NUMBER:-	NUMBER	REVISION
6595 / 18	01	A

DO NOT SCALE THIS DRAWING