

NEW INTERNAL 4 PANEL TIMBER DOOR

D.LG.02, D.LG.04, D.LG.05, D.LG.08,
D.LG.09, D.LG.20, D.G.06,, D.G.08,
D.G.12, D.T.11, D.T.12

Size of door to suit location

- 1

Top rail
- 2

Mid rail
- 3

Bottom rail
- 4

Stiles
- 5

12mm infill panels or 2x6mm with
intumescent paper for 9A
- 6

Mouldings to match existing
- 7

Architrave/frame matching existing
- 8

Bun mortice knob

Fire Door FD30S
-overhead door closer
-intumescent strips / smoke seals

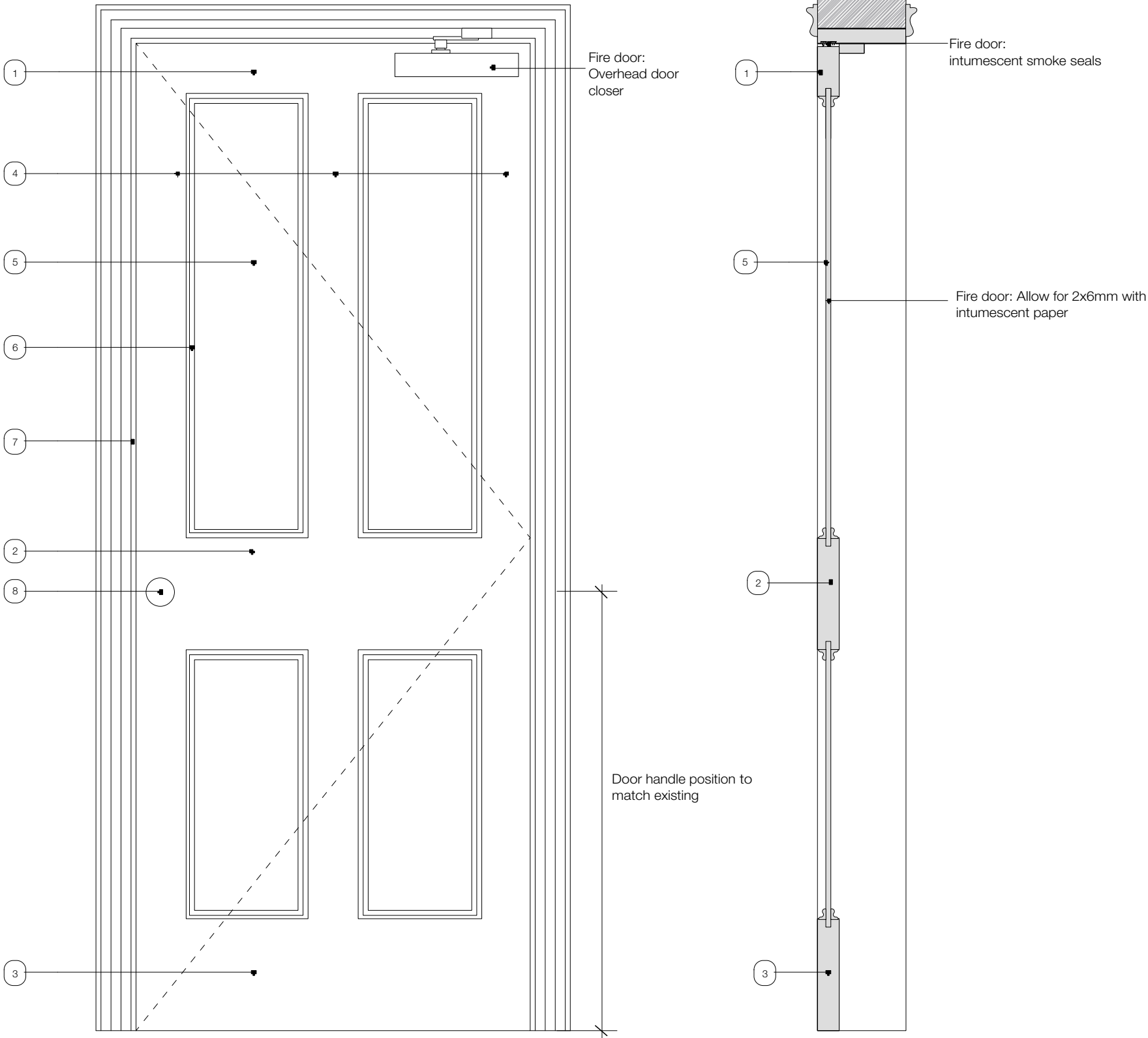
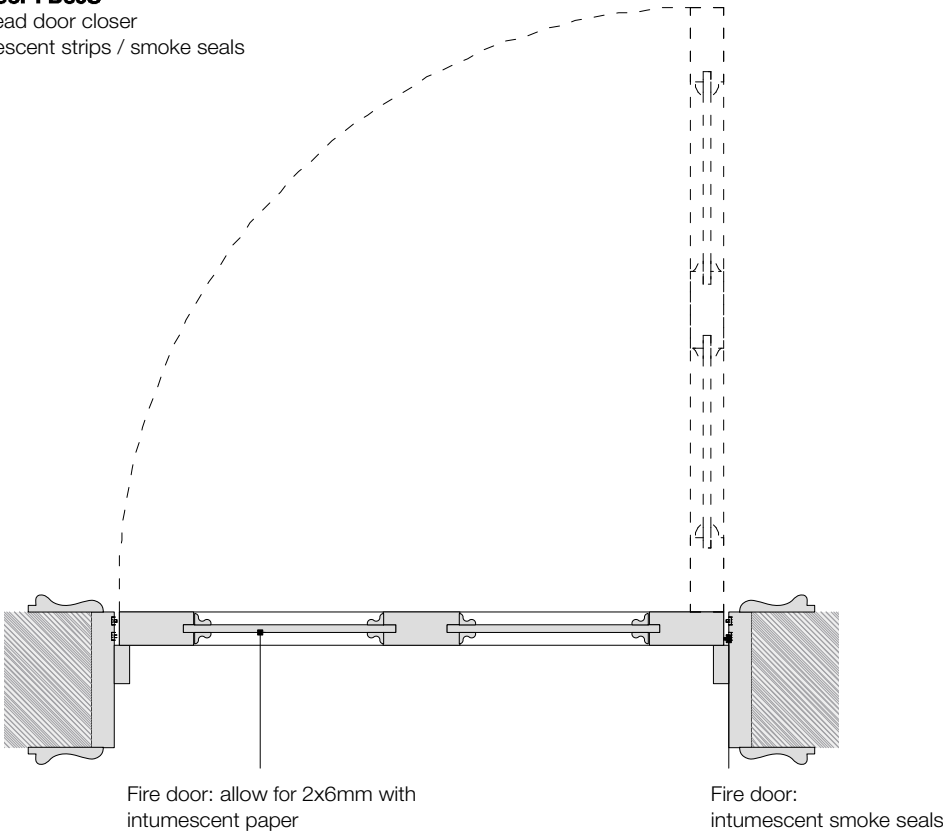

NOTES
Door elevation are seen from the hinged side.
Door sizes to be confirmed on site.
Drawing to be read in conjunction with 257.04 Door Schedule,Ironmongery Specification and NBS.

JOHANNA MOLINEUS ARCHITECTS

22 GREAT CHAPEL STREET
LONDON W1F 8FR
0207 734 8320
info@johannamolineus.com

© 2017 Johanna Molineus Architects Ltd

Do not scale dimensions from drawing.
Check all dimensions on site prior to commencement of work.
Do not copy or use this drawing without written consent.
Issue or publication does not convey or imply grant of licence.
If the drawing exceeds the quantities in any way the architects
are to be informed before work is commenced.
Drawing to be read in conjunction with structural engineer's
drawings and specification.

revisions

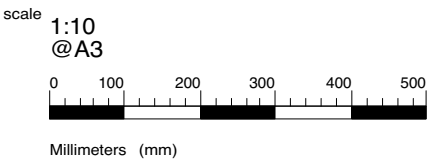

drawn / checked by
WS / PB
issue
Planning

date
July 2018
revision
P1

project
4 Bloomsbury Place
London, WC1A 2QA
client
The Bedford Estates

drawing title
Internal 4 panel door
drawing no.
257.04-910

NEW EXTERNAL 4 PANEL TIMBER DOOR

D.LG.14

- 1 Glazed upper panels
- 2 Top rail
- 3 Mid rail
- 4 Bottom rail
- 5 Stiles
- 6 12mm infill panels
- 7 Panic latch
- 8 Bottom cill
- 9 Frame

Allow for weatherseals to external doors.

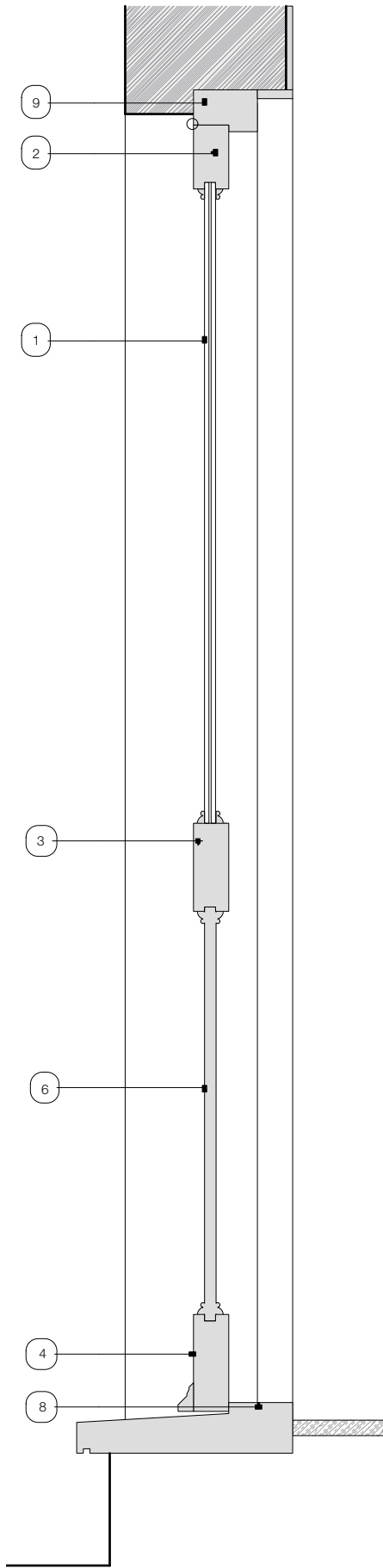
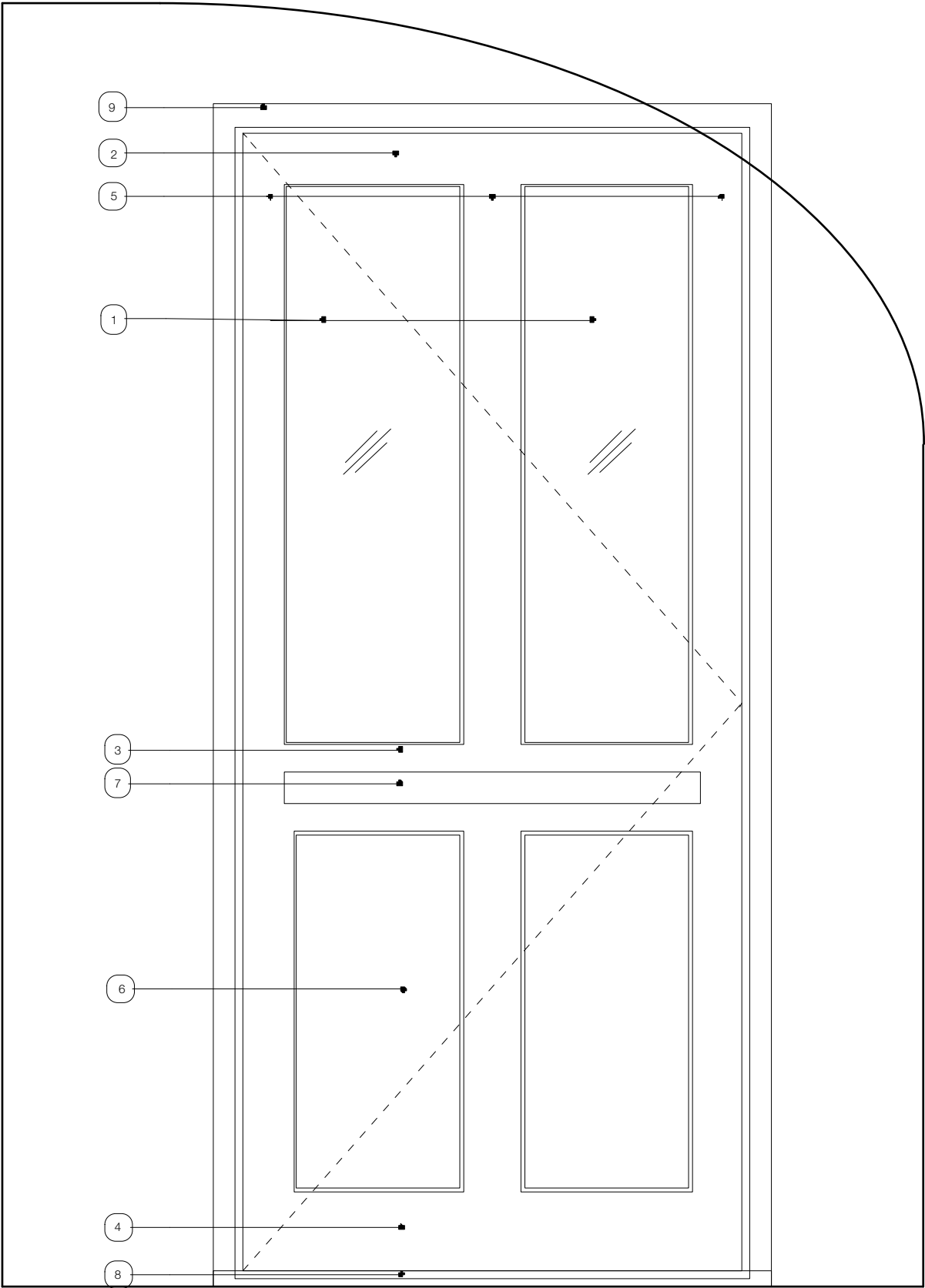
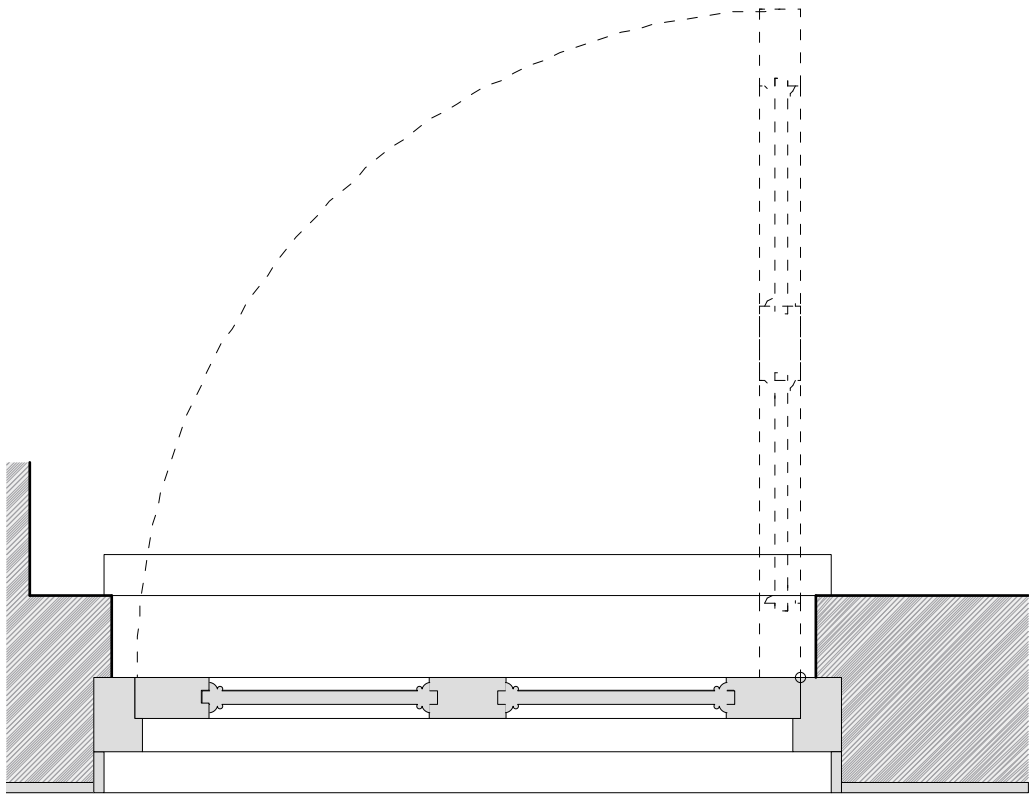

NOTES
Door elevation are seen from the hinged side.
Door sizes to be confirmed on site.
Drawing to be read in conjunction with 257.04 Door Schedule,Ironmongery Specification and NBS.

JOHANNA MOLINEUS ARCHITECTS

22 GREAT CHAPEL STREET
LONDON W1F 8FR
0207 734 8320
info@johannamolineus.com

© 2017 Johanna Molineus Architects Ltd

revisions
Do not scale dimensions from drawing.
Check all dimensions on site prior to commencement of work.
Do not copy or use this drawing without written consent.
Issue or publication does not convey or imply grant of licence.
If the drawing exceeds the quantities in any way the architects are to be informed before work is commenced.
Drawing to be read in conjunction with structural engineer's drawings and specification.

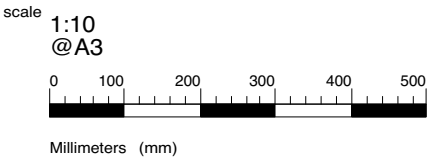

drawn / checked by
WS / PB
issue
Planning

date
July 2018
revision
P1

project
4 Bloomsbury Place
London, WC1A 2QA
client
The Bedford Estates

drawing title
External 4 panel door
drawing no.
257.04-911

NEW SINGLE TIMBER FLAT PANEL DOOR

Size of door to suit location

D.LG.15
D.F. 08
D.F. 09
D.T.09
D.T.10

- 1Frame/architrave - refer to door schedule
- 2Door leaf - refer to door schedule
- 3Ironmongery - refer to door schedule

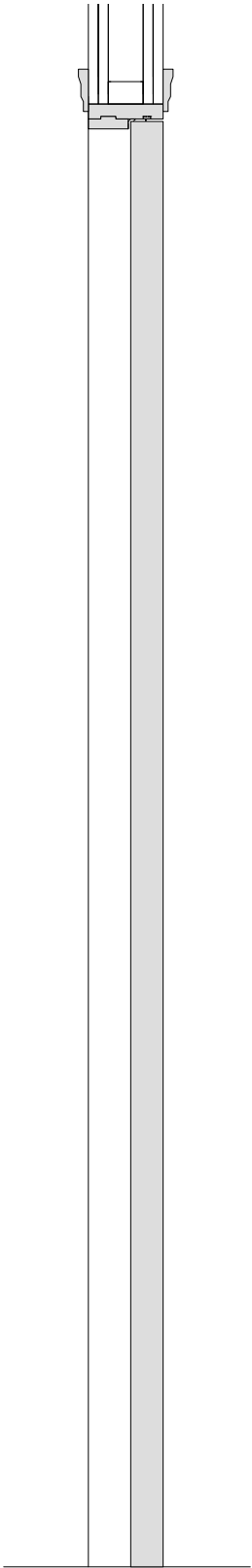
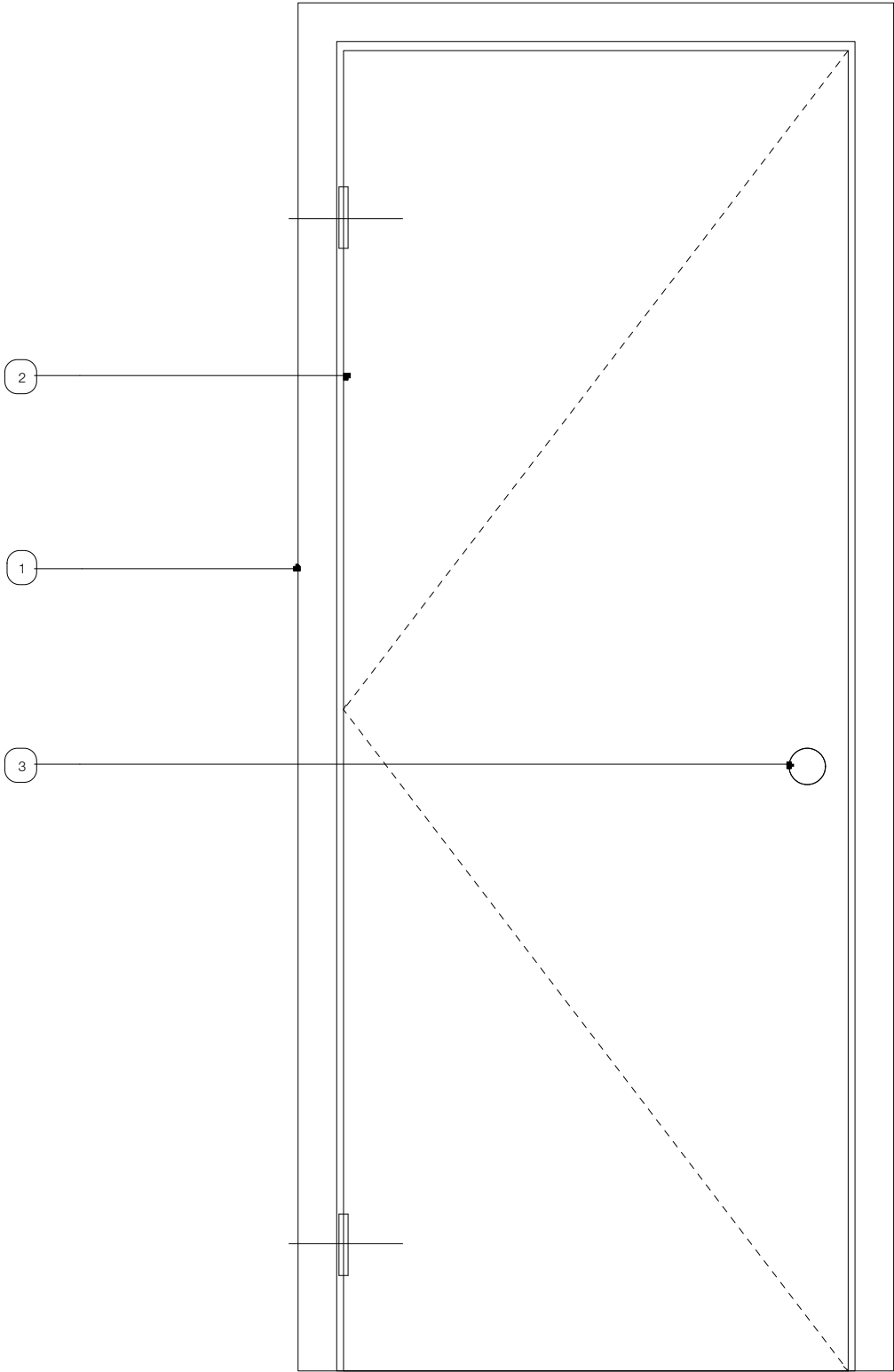
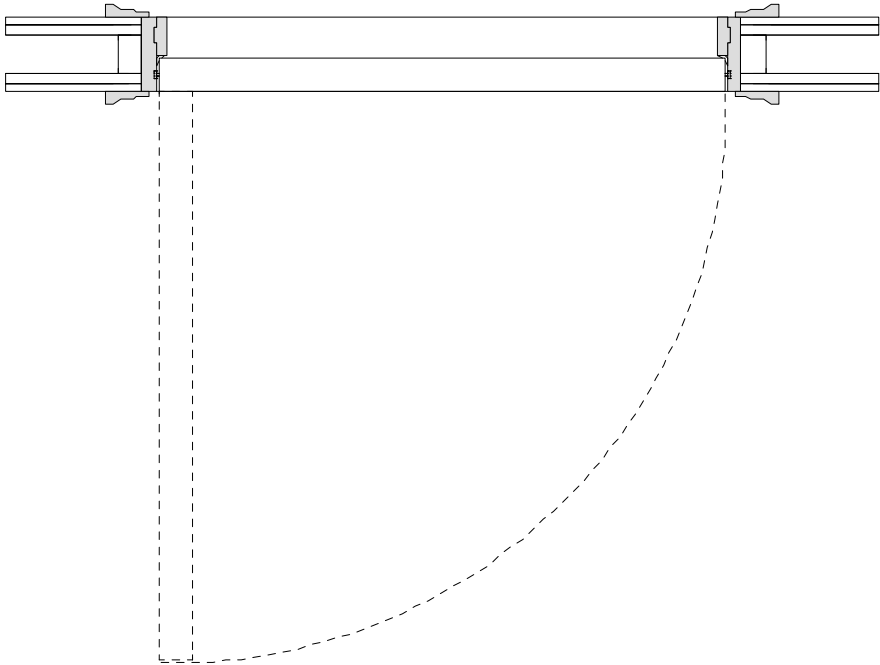

NOTES
Door elevation are seen from the hinged side.
Door sizes to be confirmed on site.
Drawing to be read in conjunction with 257.04 Door Schedule,Ironmongery Specification and NBS.

JOHANNA MOLINEUS ARCHITECTS

22 GREAT CHAPEL STREET
LONDON W1F 8FR
0207 734 8320
info@johannamolineus.com

© 2017 Johanna Molineus Architects Ltd
Do not scale dimensions from drawing.
Check all dimensions on site prior to commencement of work.
Do not copy or use this drawing without written consent.
Issue or publication does not convey or imply grant of licence.
If the drawing exceeds the quantities in any way the architects
are to be informed before work is commenced.
Drawing to be read in conjunction with structural engineer's
drawings and specification.

revisions

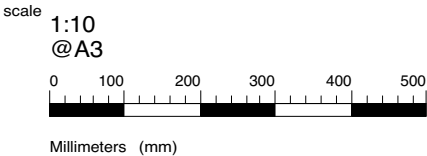

drawn / checked by
WS / PB
issue
Planning

date
July 2018
revision
P1

project
4 Bloomsbury Place
London, WC1A 2QA
client
The Bedford Estates

drawing title
Single flat panel door
drawing no.
257.04-912

NEW DOUBLE TIMBER FLAT PANEL DOOR

Size of door to suit location

D.LG.13

- 1

Frame/architrave - refer to door schedule
- 2

Door leaf - refer to door schedule
- 3

Ironmongery - refer to door schedule

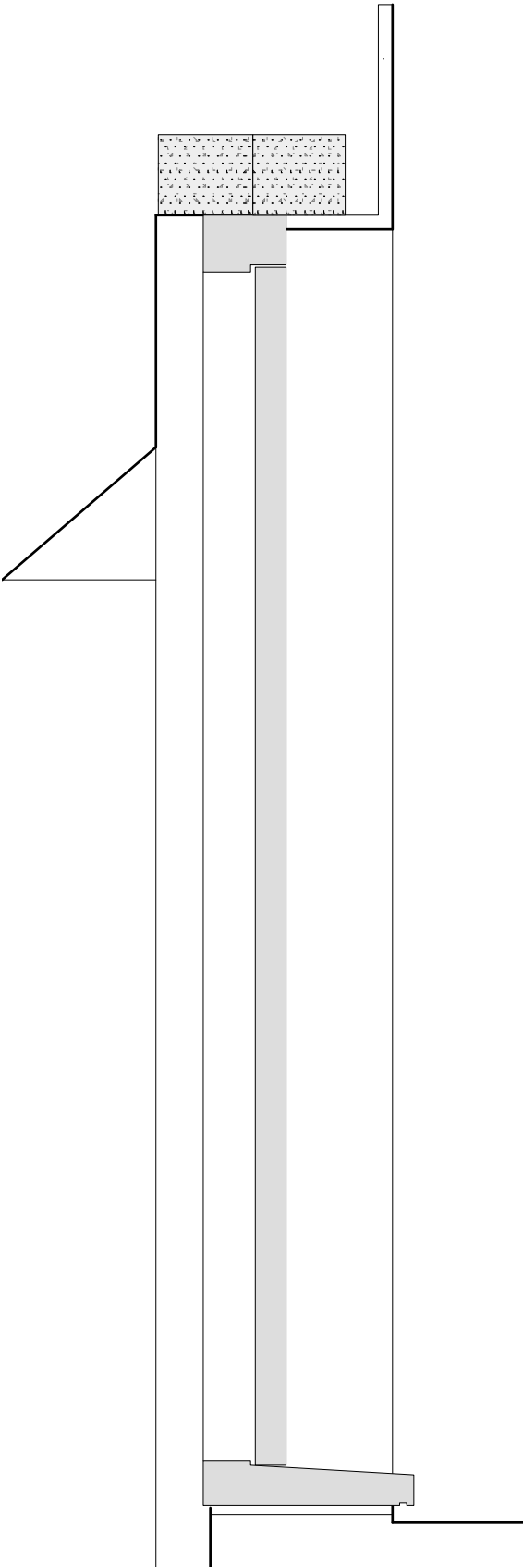
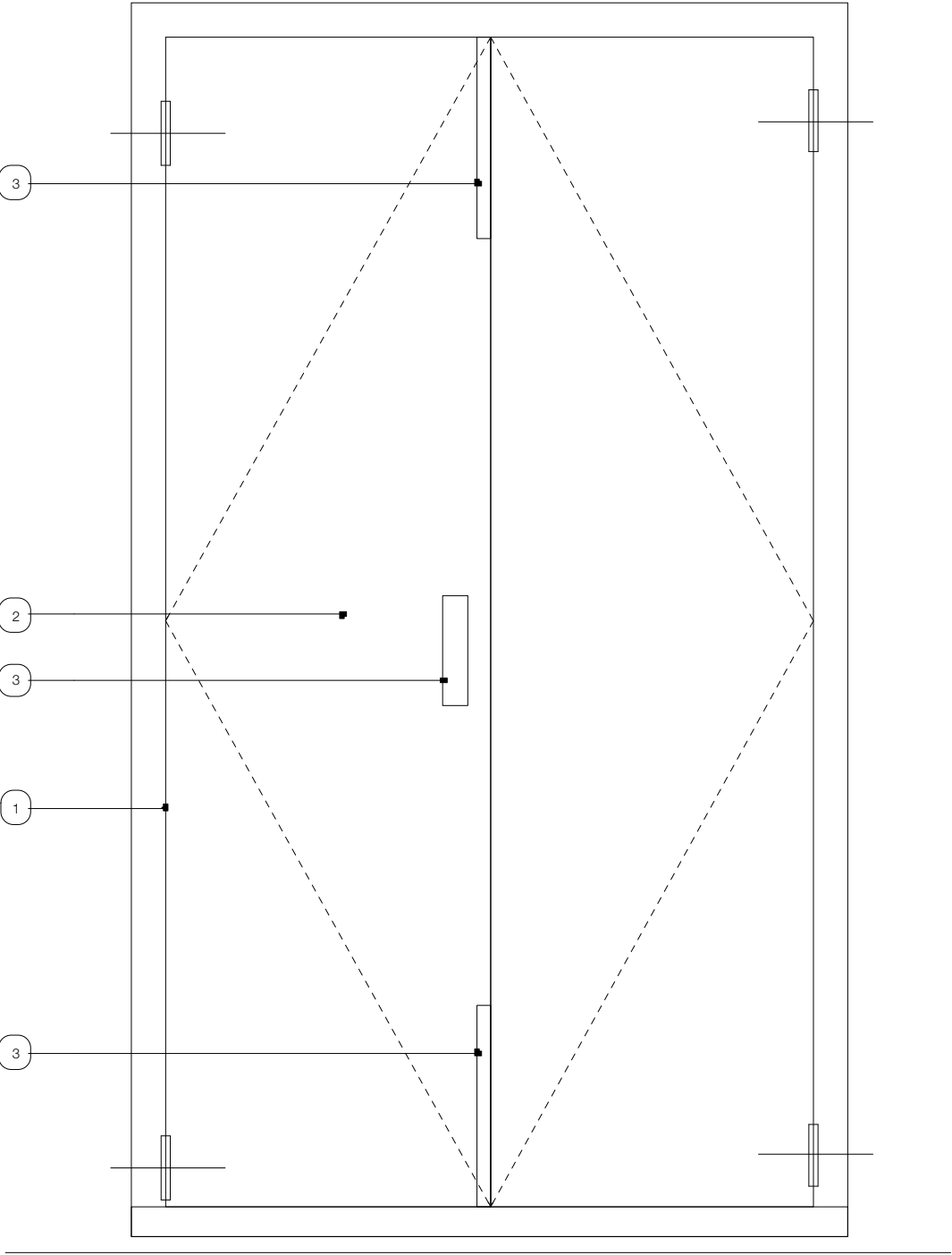
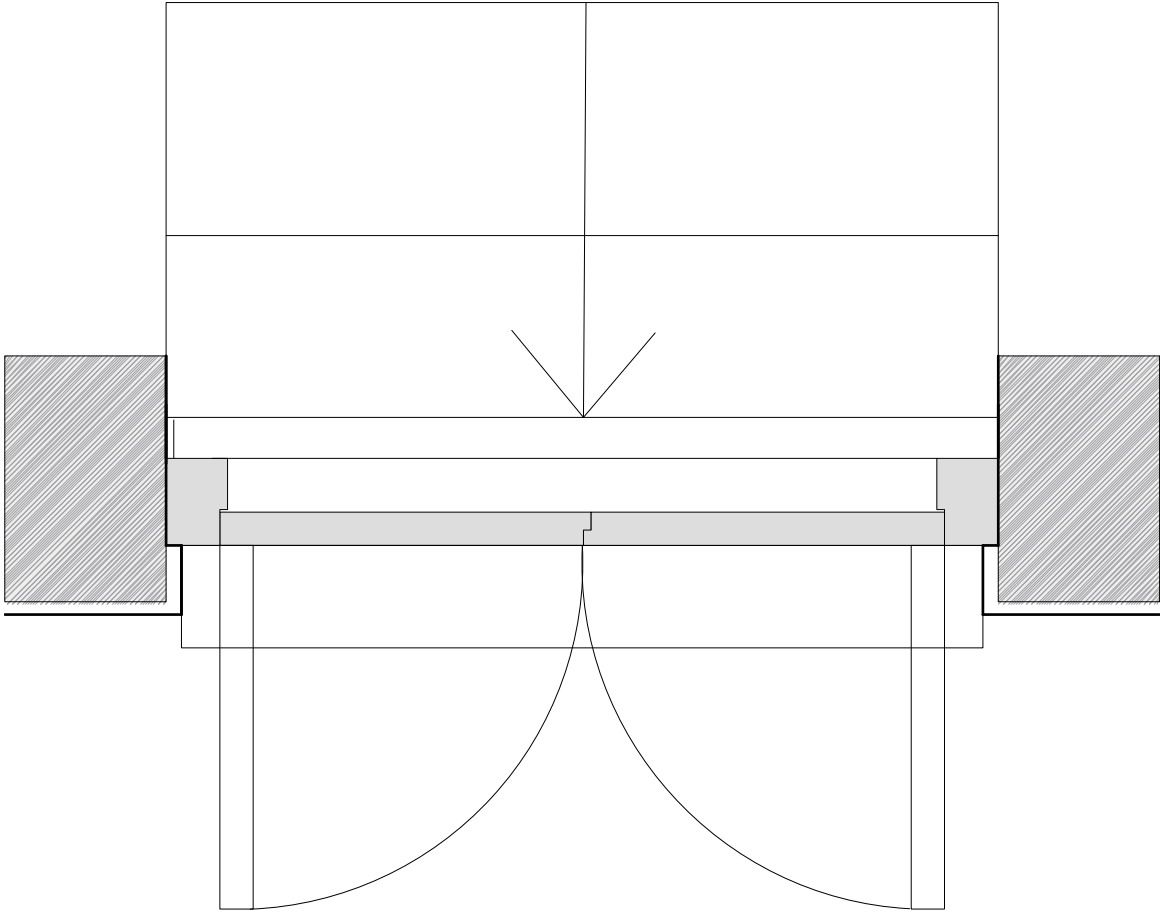

NOTES
Door elevation are seen from the hinged side.
Door sizes to be confirmed on site.
Drawing to be read in conjunction with 257.04 Door Schedule,Ironmongery Specification and NBS.

JOHANNA MOLINEUS ARCHITECTS

22 GREAT CHAPEL STREET
LONDON W1F 8FR
0207 734 8320
info@johannamolineus.com

© 2017 Johanna Molineus Architects Ltd

Do not scale dimensions from drawing.
Check all dimensions on site prior to commencement of work.
Do not copy or use this drawing without written consent.
Issue or publication does not convey or imply grant of licence.
If the drawing exceeds the quantities in any way the architects
are to be informed before work is commenced.
Drawing to be read in conjunction with structural engineer's
drawings and specification.

revisions

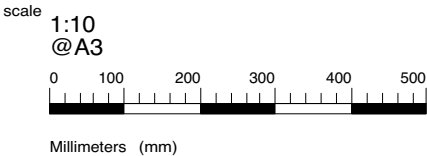

drawn / checked by

WS / PB

issue

Planning

date

July 2018

revision

P1

project

4 Bloomsbury Place

London, WC1A 2QA

client

The Bedford Estates

drawing title

Double flat panel door

drawing no.

257.04-913

- 1 Timber rails/stiles
- 2 Timber glazing bars
- 3 Timber frame
- 4 Single glazing+ toughened
- 5 Flush shoot bolts. See ironmongery specification
- 6 Handles. See ironmongery specification

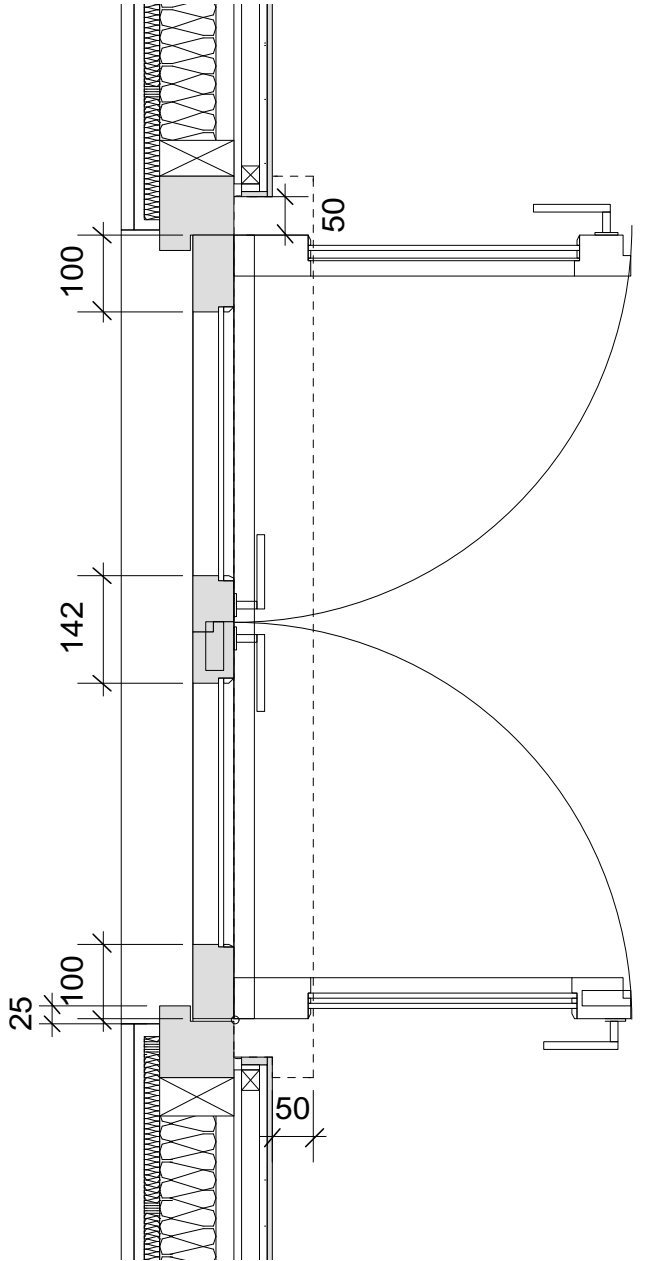

NOTES
Door ele

drawing title

External glazed timber door

drawing no.

257.04-915

D.S.08

- | | |
|---|--|
| 1 | Top rail |
| 2 | Mid rail |
| 3 | Bottom rail |
| 4 | Stiles |
| 5 | 12mm infill panels or 2x6mm with
intumescent paper for 9A |
| 6 | Mouldings to match existing |
| 7 | Architrave/frame as existing/to
match existing |

ation are seen from the hinged side.
es to be confirmed on site.
to be read in conjunction with 257.04 Door Schedule, Ironmongery Specification and NBS.

