

1

Site Location Plan

1 : 1000 @ A3

Hoarding
The hoarding is to be manufactured to 1hr Fire Rating, which is to maintained throughout. No penetrations are to be made after installation without prior approval of the Client's representative. All junctions between the hoarding and the unit to have intumescent seals.
Hoarding to be a PVC system supplied from Excel Hoardings or similar and include a outward opening access door fitted with a Digi Lock externally and an Emergency Thurnbturn door release internally.
Any floor protection required is to be fitted prior to the hoarding installation.
No additional loading to be placed against or on the hoarding, other than the Site Board and UCL graphics/notices.
Items / materials can not be lent against the inside of the hoarding.

Green hatching shows proposed temporary hoarding.

Green line denotes proposed outward opening hoarding door location. Fit with Digi lock.

Red hatch shows new opening to be cut out for new wheelchair accessible door. Existing changing room entrance door, frame and architrave to be replaced.

Line of existing suspended ceiling. Make good ceiling affected by hoarding.

Existing changing room entrance door, frame and architrave to be stripped out. Door has been confirmed to have asbestos lining. Removal to be carried out by Licensed Asbestos Removal Contractor (LARC)

Door to Logan Hall lobby in open position.

Existing light fitting to be safely disconnected and returned to Client

All existing fittings/services highlighted in Blue to remain. Allow to protect services.

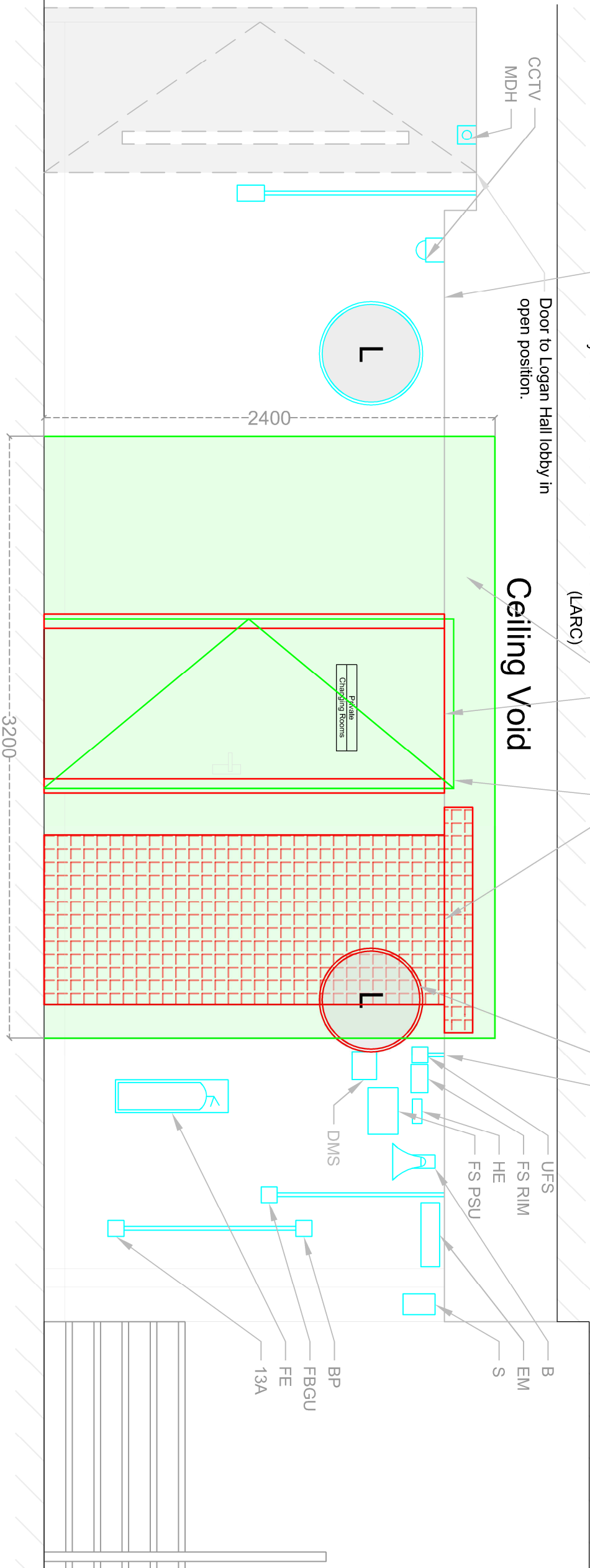

2

Demolition Elevation A-A - Main Lobby

1 : 25 @ A3



KEY

- B Bell
- BP Blanking Plate
- DMS Deaf Message Service Unit
- EM Emergency Luminaire
- FBGU Fire Break Glass Unit
- FE Fire Extinguisher
- FS PSU Fire System Power Supply Unit
- FS RIM Fire System Relay Interface Module
- HE Hum Eliminator
- L Luminaire
- MDH Magnetic Door Holder
- S Speaker
- UFS Unswitched Fused Spur
- Structures to be removed
- Services to remain
- 1 hr Fire hoarding with door

Rev	Description	Date
	For Information	22.01.2019

Client: University College London

Project Location: Institute of Education
20 Bedford Way
London WC1H 0AL

Project Status: Statutory Approval

Project Name: IOE Greenroom Washroom Refurbishment

Scale: As Shown Sheet Size: 297 mm x 420 mm @ A3

Sheet Name: Demolition Works
Elevation AA - R190 Lobby

LA692 102B

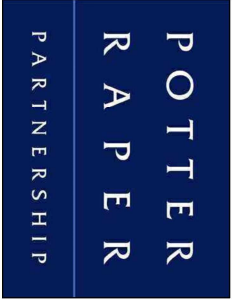

101 St Martin's Lane,
London,
WC2N 4AZ
Tel: 020 7436 5005