

Basement Floor

Proposed GA Plan

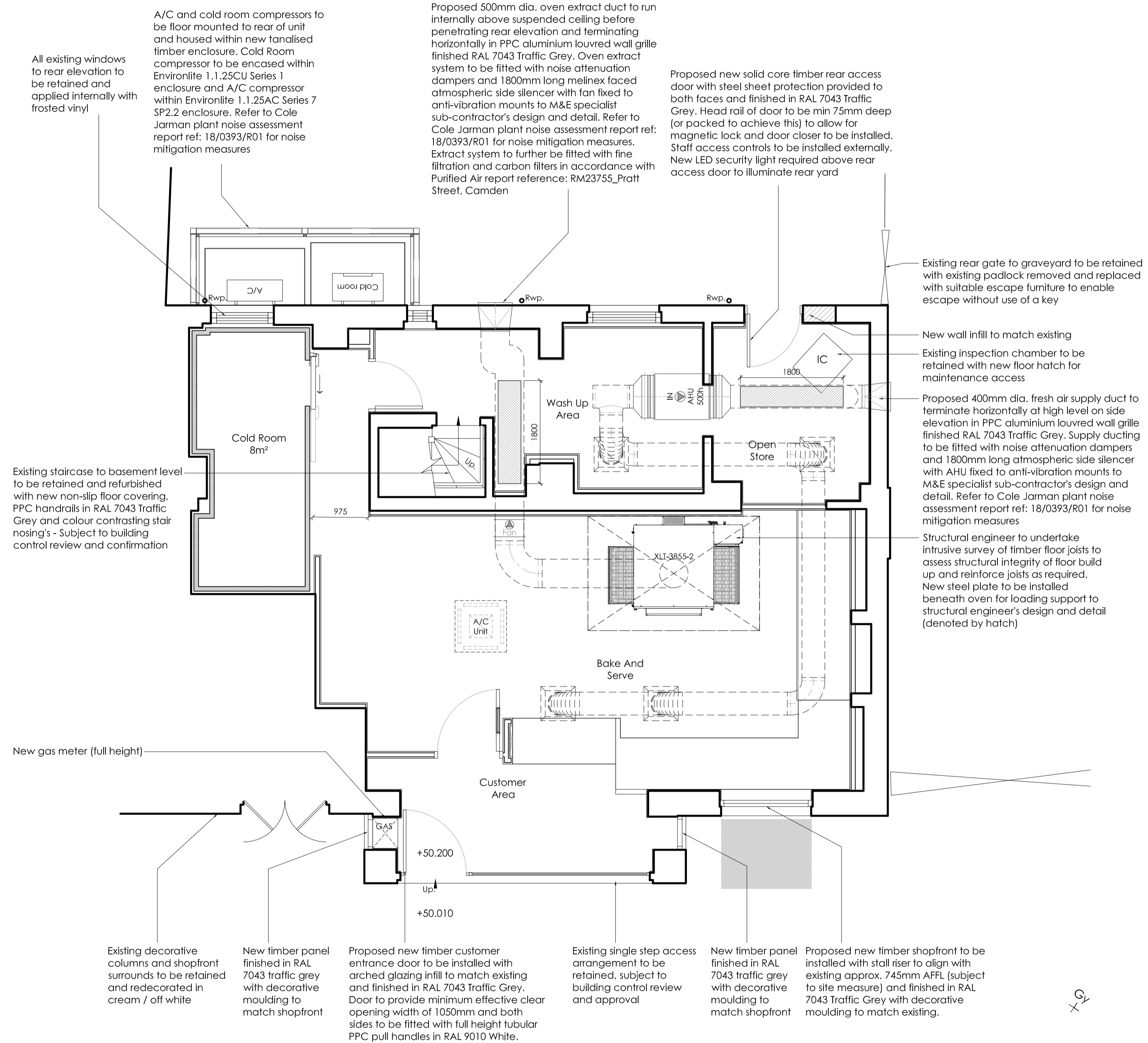

Ground Floor

NOTES

- All dimensions and levels are to be checked on site.
- Any discrepancies are to be reported to the architect before any work commences.
- This drawing shall not be scaled to ascertain any dimensions. Work to figured dims only.
- This drawing shall not be reproduced without express written permission from AEW.
- Title overlay drawings and ownership boundaries are produced using all reasonable endeavors. AEW cannot be responsible for the accuracy or scale discrepancy of base plans supplied to them.
- This drawing is based on Green Hatch Survey Solutions drawing 19803-164\_01-02\_PES (dated 06/07/2018)

DESIGN HAZARD IDENTIFICATION

- Asbestos survey report required prior to commencement.
- Proposed layout subject to Building Control approval of fire strategy and access arrangements.
- Main contractor to check and confirm all structure achieves minimum 60 minutes fire resistance.
- Sub-dividing walls between separate occupancies to be checked on site prior to commencement of works to ensure 60 minutes fire resistance is achieved. If existing wall is sufficiently fire resistant then no additional works are to be carried out to wall lining. If sub-dividing wall build-up is unclear, main contractor to communicate with Building Control and Project Manager for advice.
- Presence of damp in basement TBC and assessed for treatment prior to commencement of works.
- Assessment and reinforcing of timber floor joists and installation of new steel plate beneath oven to structural engineer's design and detail.
- Refer to Purified Air report reference RM23755\_Prat Street, Camden for oven extract system odour abatement detail and specification.
- Refer to Cole Jarman plant noise assessment report ref: 18/0393/R01 for recommended noise mitigation measures.

Schedule of Areas	m <sup>2</sup>
Existing GIA Basement Floor	74.6
Existing GIA Ground Floor	93.7
Proposed GIA Basement Floor	74.6
Proposed GIA Ground Floor	93.7

F	08/01/2019	BMR	JJS
Elevation updated to case officer's comments received on 07/01/2019.			
E	23/11/2018	BMR	LB
External bins removed and temporary bin store shown internally within basement			
D	22/11/2018	TS	BMR
Updated to case officer's comments received on 12/11/2018.			
C	12/09/2018	BMR	JJS
Annotations updated following comments received from planning consultant dated 12/09/2018			
B	10/09/2018	BMR	JJS
Drawing updated to reflect Cole Jarman Plant Noise Assessment report ref: 18/0393/R01			
A	10/08/2018	BMR	JJS
Existing windows to rear elevation to be retained and applied internally with frosted vinyl			
-	03/08/2018	BMR	LB

REV	Date	Drawn by:	Checked by:
S2			

Initial Issue

Status Purpose of Issue

drawing stage **Stage 2a - Change of Use**

client **Domino's Pizza Group**

project **35 Pratt Street Camden, London NW1 0BG**

store **PJ003029**

drawing title **Proposed GA Plan**

date **02/08/2018** drawn **BMR**

scale@A1 **1:50** checked **LB**