

PROPOSED ARE TIMBER WINDOWS WITH SLIM LINE DOUBLE GLAZING
IN A LIKE FOR LIKE STYLE TO MATCH EXISTING



FRONT ELEVATION
(Proposed)

It is proposed that the existing single glazed timber frame windows are replaced with slim line double glazed timber windows in a like for like style to match the existing.

It is proposed that the existing single glazed timber frame windows are replaced with slimline double glazed timber windows in a like for like style to match the existing.

PROPOSALS:

The proposals are for replacement of the existing timber windows at the front, rear and side of the property.

The proposed windows are timber slim line double glazed windows in a like for like style to the existing to current building regulations as per attached details.

The fenestration will be followed to the front, side and rear elevation.

PROPOSED ARE TIMBER WINDOWS WITH SLIM LINE DOUBLE GLAZING
IN A LIKE FOR LIKE STYLE TO MATCH EXISTING



REAR ELEVATION
(Proposed)

It is proposed that the existing single glazed timber frame windows are replaced with slim line double glazed timber windows in a like for like style to match the existing.

PROPOSED ARE TIMBER WINDOWS WITH SLIM LINE DOUBLE GLAZING
IN A LIKE FOR LIKE STYLE TO MATCH EXISTING

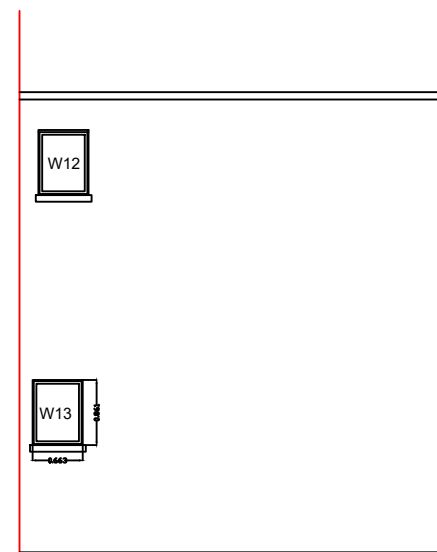

SIDE ELEVATION
(Proposed)

10 Meter

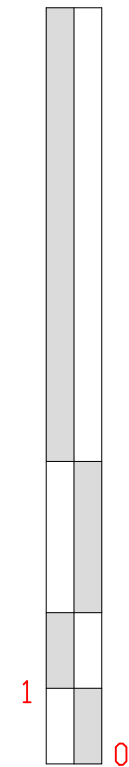

1:100



walker
CONSTRUCTION CONSULTANTS

EMPLOYER'S AGENTS & PROJECT MANAGERS
UNIT A COURT HOUSE, 11A HIGH STREET
BARNET EN5 5UJ
TEL: 020 8446 5537
E-MAIL: Planning@walkercc.co.uk

TITLE
PROPOSED ELEVATIONS

PROJECT
113 Iverson Road

CLIENT
GENESIS HOUSING ASSOCIATION / KIER

SCALE: AS IDENTIFIED
CAD FILE: -
DATE: 30.10.18
DRAWN BY: SHA
CHECKED:

PROJECT NO.	DRAWING NO.	REVISION
4247	4247/WM/02	1