

← - - - = Right of Access
 ← - - - = Public Access Route

SITE LOCATION

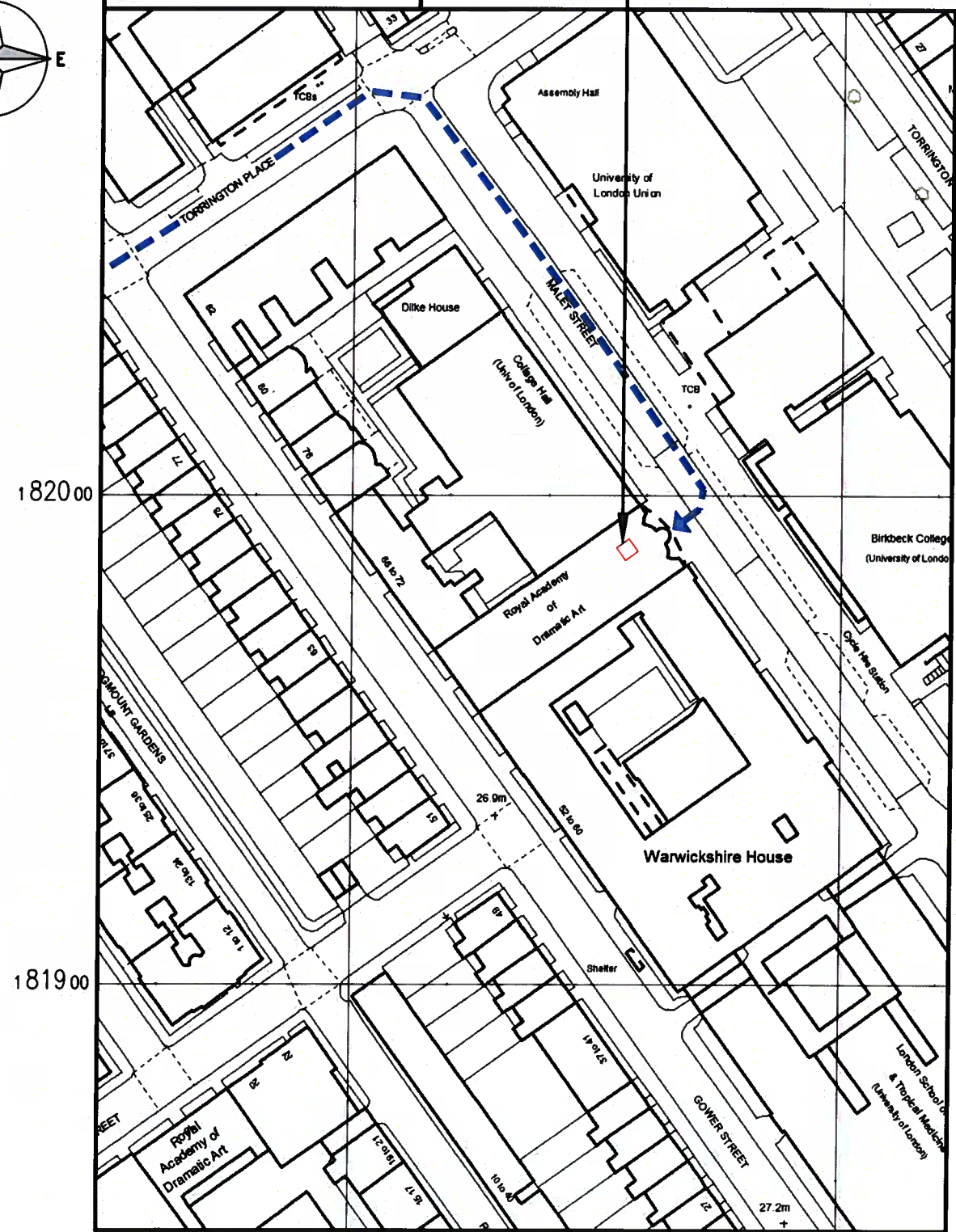

DETAILED SITE LOCATION
 (Scale 1:1250)

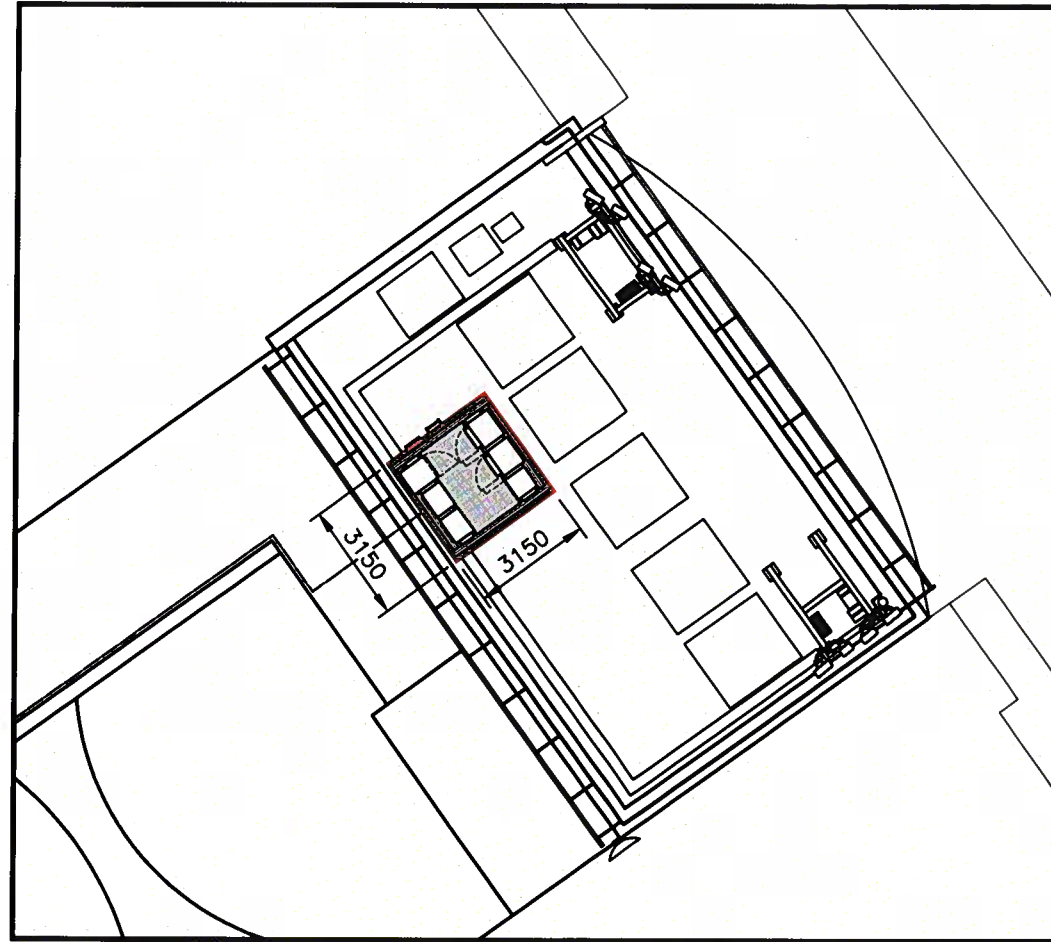

DEMISE PLAN
 (1:200)

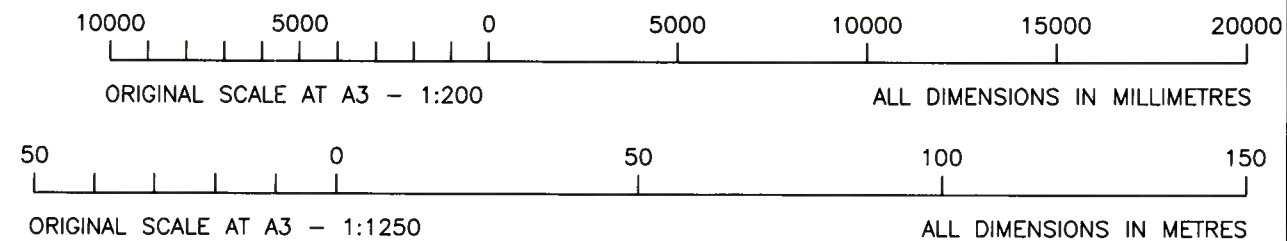

ALL DIMENSIONS ARE IN mm UNLESS NOTED OTHERWISE

N.G.R | E: 529749 N: 181980

DIRECTIONS TO SITE:
 HEADING SOUTH ON M1, LEAVE AT JUNCTION 1 TAKE SLIPROAD LEFT TO A406 TOWARDS BRENT CROSS. AFTER 0.5 TAKE SLIPROAD LEFT. AT ROUNDABOUT TAKE 3RD EXIT. KEEP STRAIGHT ON TO BRENTFIELD GARDENS. KEEP STRAIGHT ON TO A41 (HENDON WAY). AFTER 2.8 MILES KEEP LEFT TO STAY ON A41. KEEP STRAIGHT ON TO B525 (AVENUE ROAD). AFTER 0.7 MILE TURN RIGHT ONTO A5205 (PRINCE ALBERT ROAD). TURN LEFT ONTO A41 (PARK ROAD). AFTER 0.5 MILE KEEP LEFT ONTO PARK ROAD. TURN RIGHT ONTO A501 MARYLEBONE ROAD AFTER 0.2 MILE. KEEP LEFT ONTO EUSTON ROAD AFTER 0.7 MILE. TURN RIGHT ONTO A400 (HAMPSTEAD ROAD). KEEP RIGHT THEN TURN LEFT ONTO EUSTON ROAD. BEAR RIGHT ONTO A400 (GOWER STREET). SITE IS ON LEFT AFTER 0.3 MILE.

NOTES:

A	Issued for Approval	BB	GD	23.08.18
REV	MODIFICATION	BY	CH	DATE



Cell Name		Opt.
RADA 62-64 GOWER STREET		-
Cell ID No		
CTIL	TEF	VF
207705	078359	13825

Site Address / Contact Details
 62-64 GOWER STREET
 LONDON
 WC1E 6ED

Drawing Title:		LEASE DRAWING	
Purpose of issue:		PLANNING	
Drawing Number:		101	
Dwg Rev:		A	
Surveyed By:	Original Sheet Size:	Pack Issue:	
CT	A3	A	
Drawn:	Date:	Checked:	Date:
BB	23.08.18	GD	23.08.18

The drawings comply with TEF & Vodafone Standard ICNIRP guidelines.
 Designed in accordance with CTIL document: SDN0008