



Are you affected by this planning application?

The Council has received an application for:

Erection of a single storey ground floor full width rear extension and part width first floor rear extension with glazed balustrade and 1.8m high screening panel at first floor level and erection of an enclosed porch to front elevation.

At: 5 Court Close St John's Wood Park London NW8 6NN

Application Number: 2018/5504/P

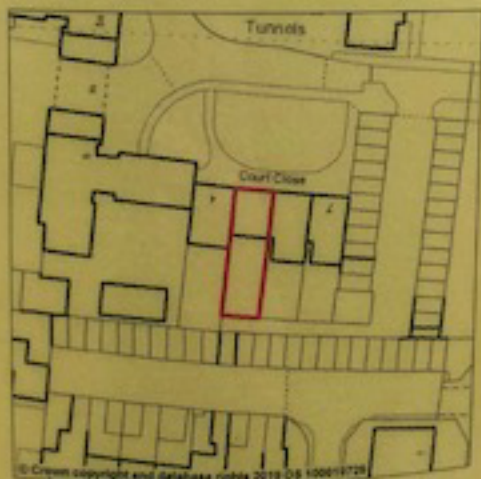

HAVE YOUR SAY

You can comment until: **Monday 04th February 2019**

See the plans / make a comment: www.camden.gov.uk/viewplans

The person dealing with this application is:

Leela Muthoora (020 7974 2506)

All comments are public and can be viewed online. We will not acknowledge receipt of your comments. In the event of an appeal all comments will be shared with the Secretary of State. If this is a householder or minor commercial application you will not have a further opportunity to comment at appeal stage.

P Permit
holders
only
CA-J
Mon - Fri
8.30 am - 6 pm

