

1 Existing Lightwell Stair Plan - Ground Floor
Scale: 1:20

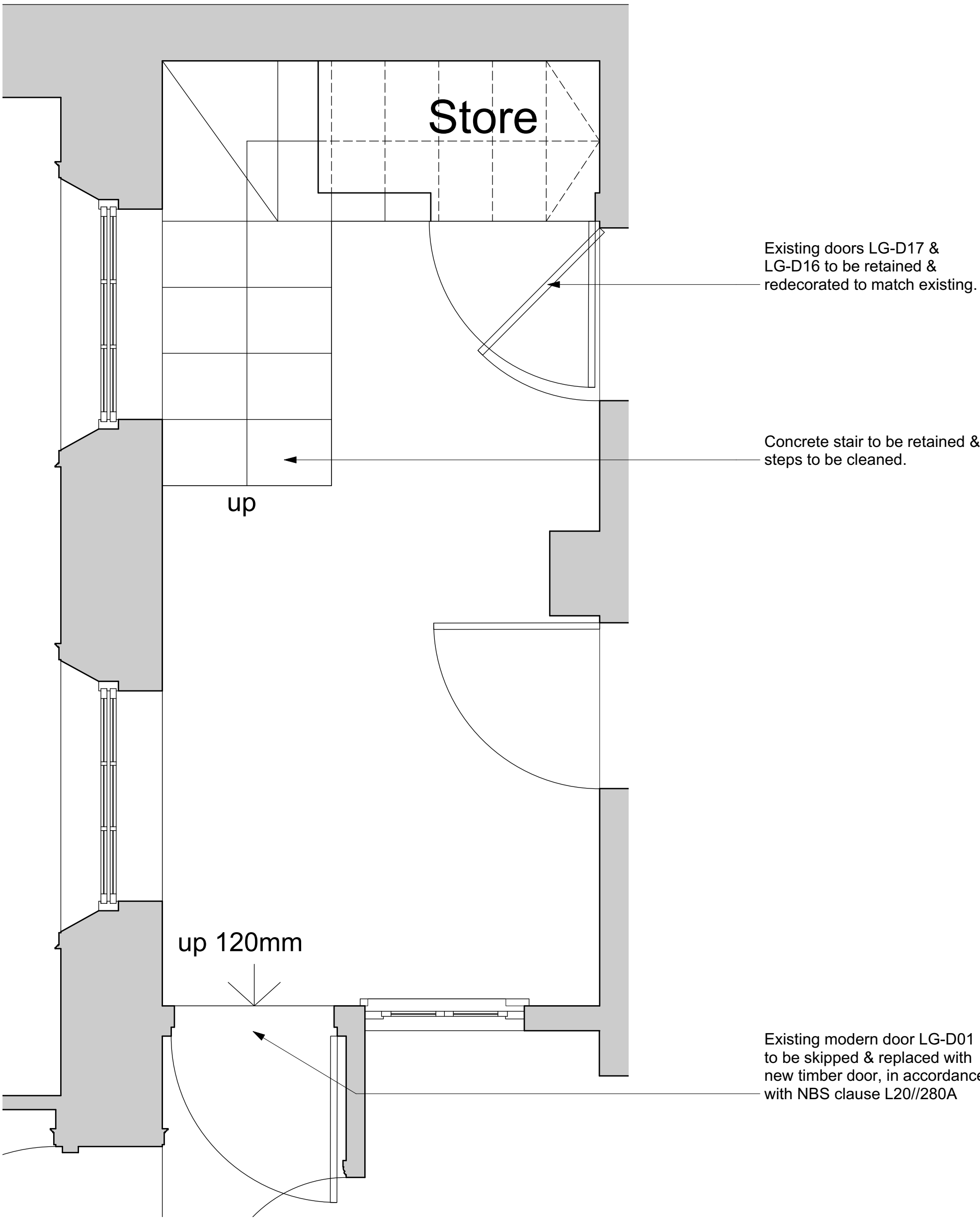

2 Existing Lightwell Stair Plan - Lower Ground Floor
Scale: 1:20

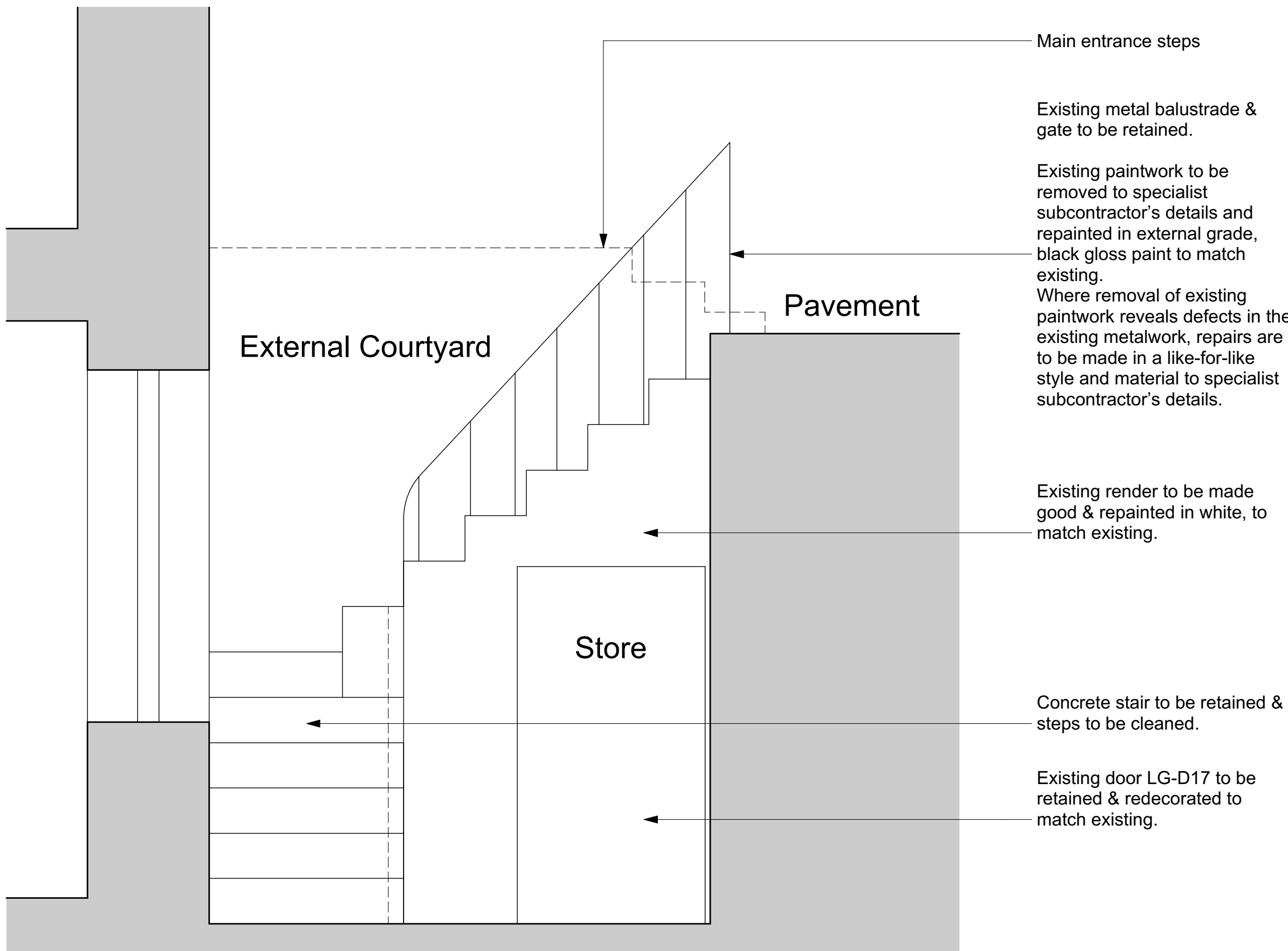

3 Existing Lightwell Stair Elevation
Scale: 1:20



4 Existing Lightwell Stair



5 Proposed Door LG-D01

NOTES:
For door details refer to NBS clause L20/280A as noted in the title block.

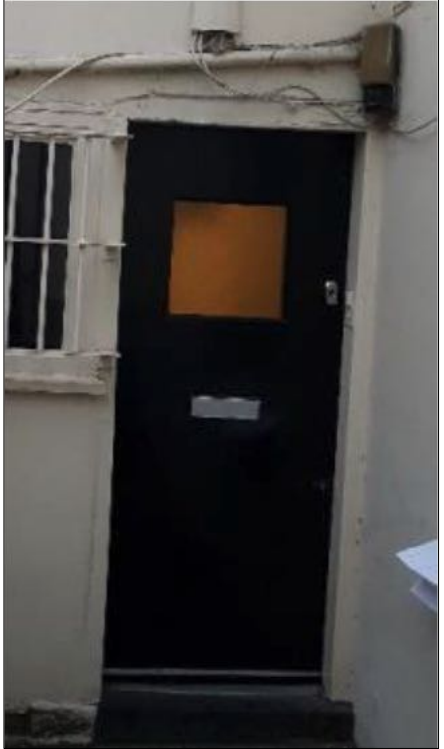

6 Existing Door LG-D01

DO NOT SCALE: Use figured dimensions only. All dimensions are to be checked on site. Any queries or discrepancies must be reported immediately to the architect.

This drawing is to be read in conjunction with drawings and specifications prepared by the architects and any other information prepared by others for the stated project.

All illustrated material is subject to copyright unless otherwise agreed in writing. This document must be read for the express purpose and project for which it has been created and delivered and must be read with relevant specification clauses.

NOTES:

- NBS CLAUSE L20/280A:
- Manufacturer: Hampton Windows.
 - Web: www.hamptonwindows.co.uk/.
 - Email: sophie@hamptonwindows.co.uk.
 - Product reference: Luxury Timber Entrance Door
 - Frame depth: 105 mm.
 - Projection sill: 50 mm.
 - Door thickness: 57 mm.
 - Material: Accoya.
 - Colour/ Finish: Black.
 - Glazing:
 - Thickness: Not required.
 - Glazing bar: N/A.
 - Threshold: Extruded aluminium.
 - Panel: Timber with steel reinforcement.
 - Ironmongery:
 - Hinge type: Butt hinge.
 - Locking mechanism: Multipoint lock.
 - Colour/ Finish: Polished brass

FOR PLANNING

Rev	Date	Drawn	Description
1	08.01.19	LM	Issued for Information
2	10.01.19	LM	Issued for Information
3	16.01.19	LM	Issued for Planning

STANESBY
ARCHITECTURE
info@stanesbyarchitecture.co.uk
www.Stanesbyarchitecture.co.uk
t: 0208 004 5910

Project title		
1 Taviton Street		
Drawing title		
Front Lightwell		
Date	Drawn by	Checked
Jan 2019	LM	AC
Scale	1:20 @ A1 1:40 @ A3	Rev. 2
Drawing number:		1803-C-2-710