

Location	KH_LEVEL LG																	
Door Ref	KH-D-LG-01	KH-D-LG-02	KH-D-LG-03	KH-D-LG-04	KH-D-LG-06	KH-D-LG-07	KH-D-LG-09	KH-D-LG-10	KH-D-LG-11	KH-D-LG-12	KH-D-LG-13	KH-D-LG-14	KH-D-LG-15	KH-D-LG-17	KH-D-LG-18	KH-D-LG-19	KH-D-LG-20	KH-D-LG-21
Nominal leaf size W x H (excluding undercut)	929x2,120	838x2,120	820x2,120	820x2,120	820x2,120	620x1,800	838x2,120	762x1,981	762x1,981	762x1,981	762x1,981	762x1,981	620x1,800	820x2,120	1,300x2,400	820x2,120	838x2,120	838x2,120
Elevation																		
Fire Rating	FD20	FD20	FD30s	FD30s	FD20	N/A	FD30s	FD20	FD20	FD20	FD20	FD20	N/A	FD20	FD20	FD20	FD20	FD20
Status	New Door, existing opening	New Door	New Door, existing opening	New Door, existing opening	New Door, Existing Opening	New Door	New Door	New Door, existing opening	New Door, existing opening	New Door, existing opening	New Door, existing opening	New Door, existing opening	New Door, Existing Opening	New Door, Existing Opening	New Door, existing opening	New Door, existing opening	New Door	New Door
Glazing	N/A	N/A	N/A	N/A	N/A	Specialist	N/A	N/A	Single Glazed	Single Glazed	Single Glazed	Single Glazed	Specialist	N/A	Single Glazed	N/A	N/A	N/A
Description	Ahmarra 4 panel door Chatsworth 4A with PPM27 Palladian Range moulding	Ahmarra 4 panel door Chatsworth 4A with PPM27 Palladian Range moulding	Ahmarra 4 panel door Chatsworth 4A with PPM27 Palladian Range moulding	Ahmarra 4 panel door Chatsworth 4A with PPM27 Palladian Range moulding	Ahmarra 4 panel door Chatsworth 4A with PPM27 Palladian Range moulding	Glazed Steam Room Door To Specialist Details	Ahmarra 4 panel door Chatsworth 4A with PPM27 Palladian Range moulding	Top arched timber door	Top arched timber door with glazed panel, GB4 glazing bars and pane configuration to match existing.	Top arched timber door with glazed panel, GB4 glazing bars and pane configuration to match existing.	Top arched timber door with glazed panel, GB4 glazing bars and pane configuration to match existing.	Top arched timber door with glazed panel, GB4 glazing bars and pane configuration to match existing.	Glazed Sauna Room Door To Specialist Details	Timber 4 paneled door	Top arched timber double door with glazed panel, GB4 glazing bars and pane configuration to match existing.	Ahmarra 4 panel door Chatsworth 4A with PPM27 Palladian Range moulding	Timber 4 paneled door by Ahmarra - Chatsworth 4A Architraves to match existing in style	Timber 4 paneled door by Ahmarra - Chatsworth 4A Architraves to match existing in style
Proposed Approach	New frame, leaf, Ahmarra ARC13 architrave & plinth block	New frame, leaf, Ahmarra ARC13 architrave & plinth block	New frame, leaf, Ahmarra ARC13 architrave & plinth block	New frame, leaf, Ahmarra ARC13 architrave & plinth block	New frame, leaf, Ahmarra ARC13 architrave & plinth block	To Specialist Details	New frame, leaf, Ahmarra ARC13 architrave & plinth block	New frame, leaf, Ahmarra ARC13 architrave & plinth block	New frame, leaf, Ahmarra ARC13 architrave & plinth block	New frame, leaf, Ahmarra ARC13 architrave & plinth block	New frame, leaf, Ahmarra ARC13 architrave & plinth block	New frame, leaf, Ahmarra ARC13 architrave & plinth block	To Specialist Details	N/A	New frame, leaf, Ahmarra ARC13 architrave & plinth block	New frame, leaf, Ahmarra ARC13 architrave & plinth block	New frame, leaf, Ahmarra ARC13 architrave & plinth block	New frame, leaf, Ahmarra ARC13 architrave & plinth block
Ironmongery	New ironmongery to match in style throughout the building.	New ironmongery to match in style throughout the building.	New ironmongery to match in style throughout the building.	New ironmongery to match in style throughout the building.	New ironmongery to match in style throughout the building.	To Specialist Details	New ironmongery to match in style throughout the building.	New ironmongery to match in style throughout the building.	New ironmongery to match in style throughout the building.	New ironmongery to match in style throughout the building.	New ironmongery to match in style throughout the building.	New ironmongery to match in style throughout the building.	To Specialist Details	New ironmongery to match in style throughout the building.	New ironmongery to match in style throughout the building.	New ironmongery to match in style throughout the building.	New ironmongery to match in style throughout the building.	New ironmongery to match in style throughout the building.

Location	KH_LEVEL LG														KH_LEVEL UG			
Door Ref	KH-D-LG-22	KH-D-LG-23	KH-D-LG-24	KH-IW-LG-01	KH-IW-LG-02	KH-IW-LG-03	KH-IW-LG-04	KH-IW-LG-05	KH-IW-LG-06	KH-IW-LG-07	KH-IW-LG-08	KH-IW-LG-09	KH-IW-LG-10	KH-D-UG-01	KH-D-UG-02	KH-D-UG-03	KH-D-UG-04	
Nominal leaf size W x H (excluding undercut)	1,372x2,162	1,682x2,120	838x2,120	1,206x1,770	1,204x1,770	1,204x2,560	1,130x1,770	1,130x1,770	1,130x1,770	828x1,770	1,140x1,770	1,097x1,770	828x1,770	1,280x2,400	875x2,410	1,200x2,410	875x2,410	
Elevation																		
Fire Rating	FD20	FD30s	FD30s	N/A	N/A	N/A	N/A	N/A	N/A	N/A	N/A	N/A	N/A	FD20	FD20	FD30s	FD30s	
Status	New Door, existing opening	New Door	New Door	New Glazing, Existing Opening	New Glazing, Existing Opening	New Glazing, Existing Opening	New Glazing, Existing Opening	New Glazing, Existing Opening	New Glazing, Existing Opening	New Glazing, Existing Opening	New Glazing, Existing Opening	New Glazing, Existing Opening	New Glazing, Existing Opening	Existing Door	Existing Door	New Door, existing opening	New Door, Existing Opening	
Glazing	N/A	N/A	N/A	Double Glazed	Double Glazed	Double Glazed	Double Glazed	Double Glazed	Double Glazed	Double Glazed	Double Glazed	Double Glazed	Double Glazed	Single Glazed	N/A	N/A	N/A	
Description	Top arched timber double door with top glazed panel.	Timber 4 paneled door by Ahmarra - Chatsworth 4A, Architraves to match existing in style	Timber 4 paneled door by Ahmarra - Chatsworth 4A, Architraves to match existing in style	Single pane Metal Frame Hinged Secondary Glazing Double Glazed Unit with Ventilated Void Behind	Single pane Metal Frame Hinged Secondary Glazing Double Glazed Unit with Ventilated Void Behind	Double door Metal Frame Hinged Secondary Glazing Double Glazed Unit with Ventilated Void Behind	Curved Single pane Metal Frame Hinged Secondary Glazing Double Glazed Unit with Ventilated Void Behind	Curved Single pane Metal Frame Hinged Secondary Glazing Double Glazed Unit with Ventilated Void Behind	Curved Single pane Metal Frame Hinged Secondary Glazing Double Glazed Unit with Ventilated Void Behind	Single pane Metal Frame Hinged Secondary Glazing Double Glazed Unit with Ventilated Void Behind	Single pane Metal Frame Hinged Secondary Glazing Double Glazed Unit with Ventilated Void Behind	Single pane Metal Frame Hinged Secondary Glazing Double Glazed Unit with Ventilated Void Behind	Single pane Metal Frame Hinged Secondary Glazing Double Glazed Unit with Ventilated Void Behind	2 paneled door with glazing section each.	Timber 4 paneled door	Ahmarra 4 panel door Chatsworth 4A with PPM27 Palladian Range moulding	Ahmarra 4 panel door Chatsworth 4A with PPM27 Palladian Range moulding	
Proposed Approach	New frame, leaf, Ahmarra ARC13 architrave & plinth block	New frame, leaf, Ahmarra ARC13 architrave & plinth block	New frame, leaf, Ahmarra ARC13 architrave & plinth block	To specialist details	To specialist details	To specialist details	To specialist details	To specialist details	To specialist details	To specialist details	To specialist details	To specialist details	To specialist details	Completely refurbish and repair existing Door, Frame and Architrave.	Completely refurbish and repair existing Door, Frame and Architrave.	Completely refurbish and repair existing frame and architrave.	Completely refurbish and repair existing Frame and Architrave.	
Ironmongery	New ironmongery to match in style throughout the building.	New ironmongery to match in style throughout the building.	New ironmongery to match in style throughout the building.	Simple Key Lock	Simple Key Lock	Simple Key Lock	Simple Key Lock	Simple Key Lock	Simple Key Lock	Simple Key Lock	Simple Key Lock	Simple Key Lock	Simple Key Lock	Existing ironmongery to be replaced with new similar in style throughout the building.	Existing ironmongery to be replaced with new similar in style throughout the building.	New ironmongery to match in style throughout the building.	New ironmongery to match in style throughout the building.	

Location	KH_LEVEL UG																	
Door Ref	KH-D-UG-05	KH-D-UG-06	KH-D-UG-07	KH-D-UG-08	KH-D-UG-09	KH-D-UG-10	KH-D-UG-11	KH-D-UG-14	KH-D-UG-15	KH-D-UG-16	KH-D-UG-17	KH-D-UG-18	KH-D-UG-19	KH-D-UG-21	KH-D-UG-22	KH-D-UG-23	KH-IW-UG-12	
Nominal leaf size W x H (excluding undercut)	901x2,410	786x2,410	762x2,410	915x2,410	1,985x3,020	1,985x3,020	785x2,410	875x2,410	808x2,410	1,015x2,420	825x2,410	860x2,410	917x2,410	927x2,410	770x1,740	769x1,600	785x2,410	
Elevation																		
Fire Rating	FD20	FD30	Zero	FD30	FD20	FD20	FD20	FD20	FD20	N/A - existing	FD20	FD30	FD30	FD30	FD20	FD20	FD20	
Status	Existing Door	Existing Door	New Door	Existing Door Handed	Existing Door	Existing Door	New Door	Existing Door	New Door	Existing Door	Existing Door Flipped	Existing Door	Existing Door	Existing Door	New Door	New door Existing Opening	New Fixed Window	
Glazing	N/A	N/A	N/A	N/A	N/A	N/A	Single Glazed	N/A	N/A	N/A	N/A	N/A	N/A	N/A	N/A	N/A	Single Glazed	
Description	Timber 4 paneled door with decorative architrave to Hall Side. Existing Door to be blocked off	Timber 4 paneled door with decorative architrave to Hall Side. Existing Door to be blocked off	Ahmarra 4 panel door Chatsworth 4A with PPM27 Palladian Range moulding	Timber 4 paneled door. Door forms part of decorative room paneling which includes fake door.	Timber 4 paneled double door. have decorated architraves and classical crosshead.	Timber 4 paneled double door. have decorated architraves and classical crosshead.	Timber, glazed door, GB2 glazing bars and pane configuration to match existing in style.	Timber 4 paneled door with decorative architrave.	New door to be in line with Master Bedroom door - mirroring stiles, rails etc along with door thickness	Timber 4 paneled door with decorative architrave.	Timber 4 paneled door with decorative architrave.	Timber 4 paneled door with decorative architrave.	Timber 4 paneled door with decorative architrave.	Timber 4 paneled door with decorative architrave. Fixed door	Timber 4 paneled door with decorative architrave. Fixed door	New door to be in line with Master Bedroom door - mirroring stiles, rails etc along with door thickness	New door to be in line with Master Bedroom door - mirroring stiles, rails etc along with door thickness	Timber, glazed fixed window. GB2 glazing bars and pane configuration to match existing in style.
Proposed Approach	Completely refurbish and repair existing Door, Frame and Architrave.	Completely refurbish and repair existing Door, Frame and Architrave.	New frame, leaf, Ahmarra ARC13 architrave & plinth block	Completely refurbish and repair existing Door, Frame and Architrave.	Completely refurbish and repair existing Door, Frame and Architrave.	Completely refurbish and repair existing Door, Frame and Architrave.	No architrave. Door to match new window KH-IW-UG-12 in style and configuration	Completely refurbish and repair existing Door, Frame and Architrave.	Frame and architrave to mirror that on Master Bedroom Door	Completely refurbish and repair existing Door, Frame and Architrave.	Completely refurbish and repair existing Door, Frame and Architrave.	Completely refurbish and repair existing Door, Frame and Architrave.	Completely refurbish and repair existing Door, Frame and Architrave.	Completely refurbish and repair existing Door, Frame and Architrave.	New Door Incorporated to existing niche Architrave to match existing	New Door Incorporated to under stair cupboard.	No architrave. Window to match new door KH-D-UG-11 in style and configuration	
Ironmongery	Existing ironmongery to be replaced with new similar in style throughout the building.	Existing ironmongery to be replaced with new similar in style throughout the building.	New ironmongery to match in style throughout the building.	Existing ironmongery to be replaced with new similar in style throughout the building.	Existing ironmongery to be replaced with new similar in style throughout the building.	Existing ironmongery to be replaced with new similar in style throughout the building.	New ironmongery to match in style throughout the building.	Existing ironmongery to be replaced with new similar in style throughout the building.	New ironmongery to match in style throughout the building.	Existing ironmongery to be replaced with new similar in style throughout the building.	Existing ironmongery to be replaced with new similar in style throughout the building.	Existing ironmongery to be replaced with new similar in style throughout the building.	Existing ironmongery to be replaced with new similar in style throughout the building.	Existing ironmongery to be replaced with new similar in style throughout the building.	New ironmongery to match in style throughout the building.	New ironmongery to match in style throughout the building.	N/A	

INTERNAL DOOR NOTES:

All Doors CONTRACTORS, SUB-CONTRACTORS AND MANUFACTURERS TO ENSURE THAT ALL MATERIALS AND COMPONENTS ARE SUITABLE FOR THEIR INTENDED PURPOSE AND LOCATION; DESIGNED, MANUFACTURED AND INSTALLED IN ACCORDANCE WITH ALL RELEVANT CURRENT BRITISH STANDARDS, CODES OF PRACTICE, AND MANUFACTURER'S SPECIFICATIONS.

Any reference to an Approved Document in this Specification relates to the relevant Approved Document of the Building Regulations.

All door leaf sizes shown exclude undercuts and packing zones.

ALL existing and proposed structural openings, frames, door leaves and associated structures (ceilings, stairs, etc) to be confirmed on site prior to manufacture.

For door handing, refer to GA Plans.

Sliding Doors
Scheduled sliding door widths and height are shown as the visible width only. Manufacturer to advise on actual width and height required. Sliding door gear, pockets and jacks to be confirmed and sized prior to manufacture to ensure structural openings are adequate

Fire Doors
All FD30 doors to receive smoke seals and intumescent strips.

All fire door sets to meet all requirements of BS 588. Fire door sets to be tested to meet BS 476-22 or BS EN4967 and supplied with product conformity certificates.

Door linings, stops, vision panels, cold smoke seals (denoted by the 's' suffix) etc., all to meet doors manufacturers standard fire tested details to achieve fire ratings as noted.

Door schedules to be read in conjunction with relevant joinery details.

* For ALL apartment doors, refer to Fire Drawings

Ironmongery
All ironmongery TBC.

Plant room doors to meet BS 3621 and engineers requirements.

Cycle store doors to have PAS 24 doors (or LPS 175 Security 2) and fob access.

Door Finishes:
Refer to finishes schedule.

Refer to drawings 9000-08GN-DE047 to 9000-08GN-DE048 for details outlined above.

NOTE: Existing opening sizes to be confirmed on site and new door sizes to be set (to suit opening size) and agreed prior to manufacture.

NOTE: All new door to have split linings - mirroring the existing without planted stop.

For glazing bar references please refer to drawing number: 9000-DRG-00GN-DE350

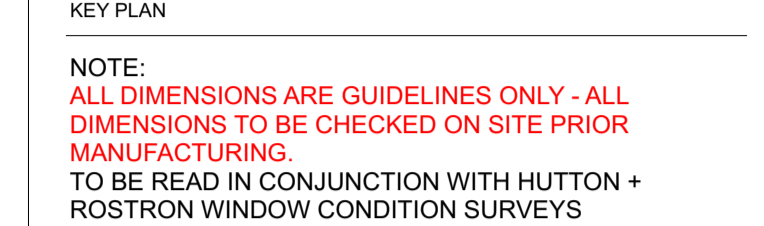
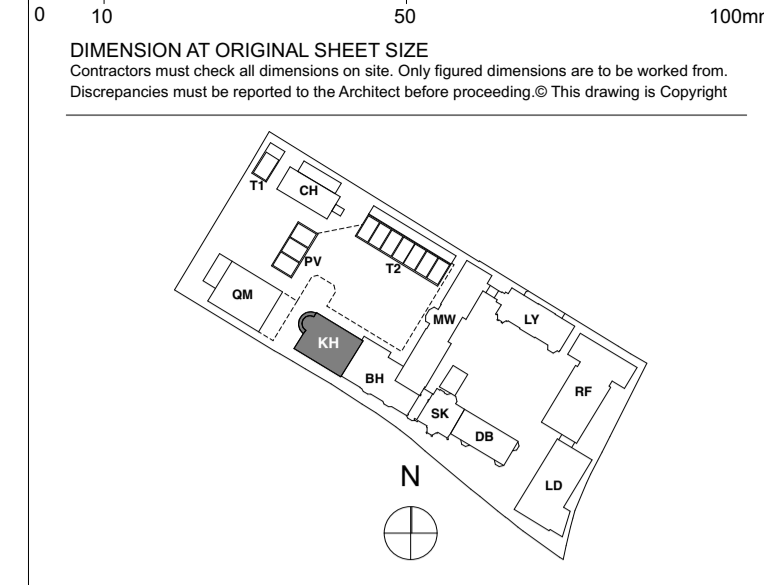

NOTE:
ALL DIMENSIONS ARE GUIDELINES ONLY - ALL DIMENSIONS TO BE CHECKED ON SITE PRIOR TO MANUFACTURE.
TO BE READ IN CONJUNCTION WITH HUTTON + ROSTRON WINDOW CONDITION SURVEYS WHERE APPLICABLE.
ALL ADDITIONAL IRONMONGERY TO BE AGREED WITH THE ARCHITECT PRIOR TO INSTALLATION

All new and replacement window and door shop drawings are to be reviewed and approved by the architect prior to manufacture.

Glazing
Any 'new' glazing panels below 800mm in windows or 1200mm in glazed doors or screens within 300mm of doors, will need to be able to break safely on impact.

Door panels
Refer to 9000-08GN-DE005 for panel setting out of door panels, handle heights, etc.

Key:
References in red apply to the surrounding masonry conditions of doors and windows:
H1 - Head Detail reference
J2 - Jamb detail reference
TS/SD1 - Sill Detail Reference

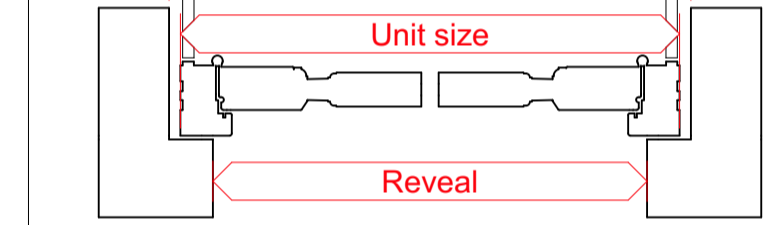

Ex - Existing condition
Details for individual door and window frames, glazing bars, mouldings, stiles, etc., where not shown in the details above, are annotated in blue:
HD1 - Door / window component detail reference

Refer to drawings 9000-DRG-00GN-DE047 to 9000-DRG-00GN-DE048 for details outlined above.

REVISION	DRN	CHKD	DATE
C1 Issued for Construction	GC	TW	17/01/2017
C2 Revised to Conservation Officer's Comments	GC	KC	10/02/2017
C3 Revised as detailed	K/C	K/C	04/06/2018
C4 New doors and windows highlighted	K/C	K/C	04/06/2018
C5 Revisions following Change to Single Dwelling	K/C	K/C	20/12/2018



CLIENT
MOUNT ANVIL LTD



PROJECT
KIDDERPORE AVENUE

DRAWING
Kidderpore Hall
Internal Windows And Doors Schedule Sheet 1 of 2

SCALE: M50 @ A1 DATE: December 2018

DRAWING No. 15 230
9000-SCH-KH-005
DRAWN BY: K/C
REV: C4

A & Q PARTNERSHIP (LONDON) LTD
THE LUX BUILDING, 2-4 HOXTON SQUARE, LONDON N1 6NU
Tel: 020 7613 2244 Fax: 020 7613 2642 Email: london@aqa.co.uk
ARCHITECTURE DESIGN MASTERPLANNING INTERIORS