

KEY PLAN

NOTE:
ALL INFORMATION SHOWN ON THIS DRAWING IS SUBJECT TO DESIGN DEVELOPMENT BY SPECIALIST

THIS DRAWING SHOWS CONCEPT DESIGN ONLY.
STEEL STAIRCASE TO BE DEVELOPED FURTHER BY SPECIALIST MANUFACTURER BASED ON THIS CONCEPT.

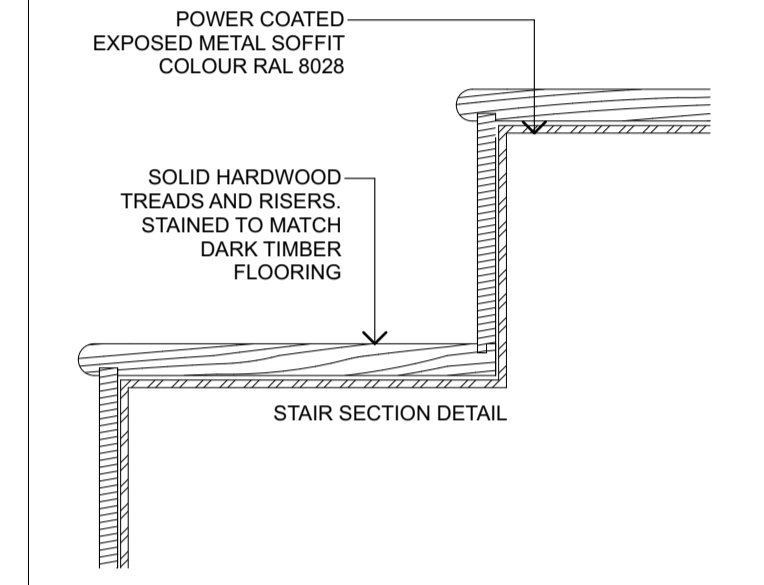

STAIR SECTION DETAIL

FOR TENDER

REVISION	DRN	CHKD	DATE	
C2	Issued for Construction	NV	KC	10/03/2017
T1	Issued for Tender	NV	KC	18/04/2017
T2	Bid/quote information revised	KC	KC	20/06/2017
T3	Detail Added	KC	KC	03/07/2017
T4	TRAL Information Added	KC	KC	20/12/2018
	Update Following Single Dwelling Change	KC	KC	20/12/2018



CLIENT
MOUNT ANVIL LTD

PROJECT
KIDDERPORE AVENUE

DRAWING
Kidderpore Hall
LG-UG Stair 1

SCALE 1:20, 1:5 @A1 DATE 20/12/2018

DRAWING No. 15 230
9000-DRG-55KH- AL001

DRAWN BY K/C
REV T4

A & Q PARTNERSHIP (LONDON) LTD
THE LUX BUILDING, 2-4 HOXTON SQUARE, LONDON N1 6 NU
Tel: 020 7613 2244 Fax: 020 7613 2642 Email: london@aqp.co.uk
ARCHITECTURE DESIGN MASTERPLANNING INTERIORS

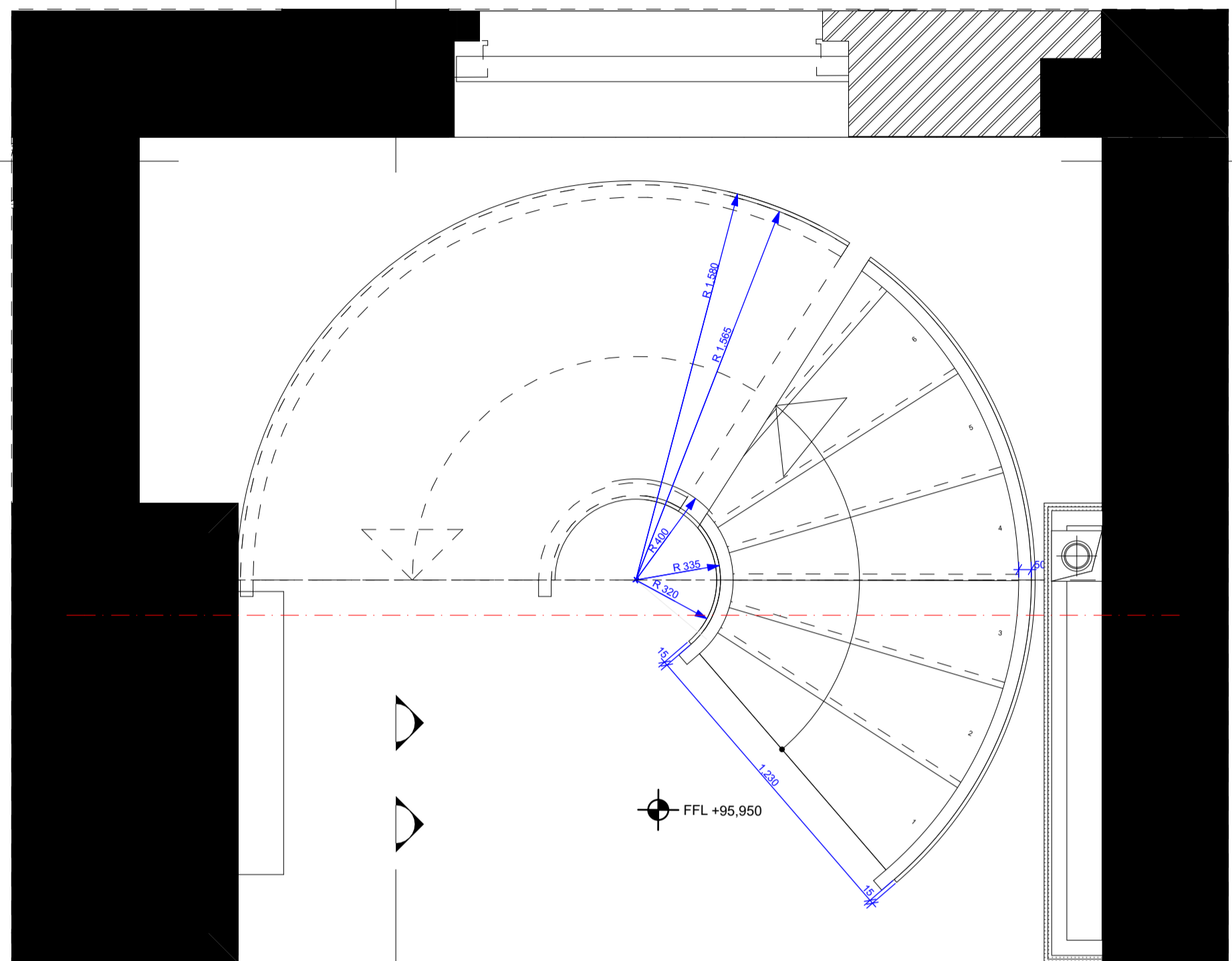

KH_LEVEL LG 1:20

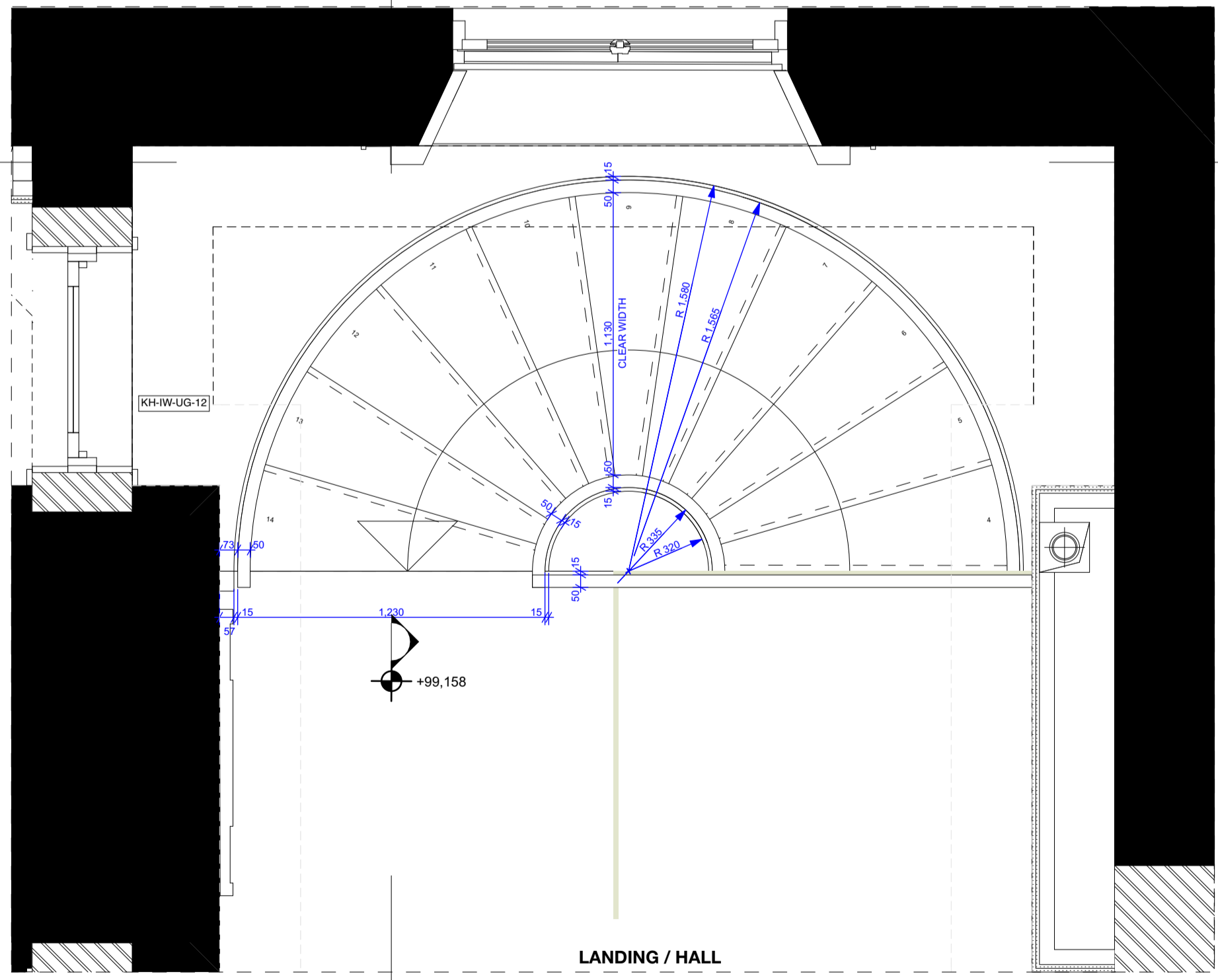

KH_LEVEL UG 1:20

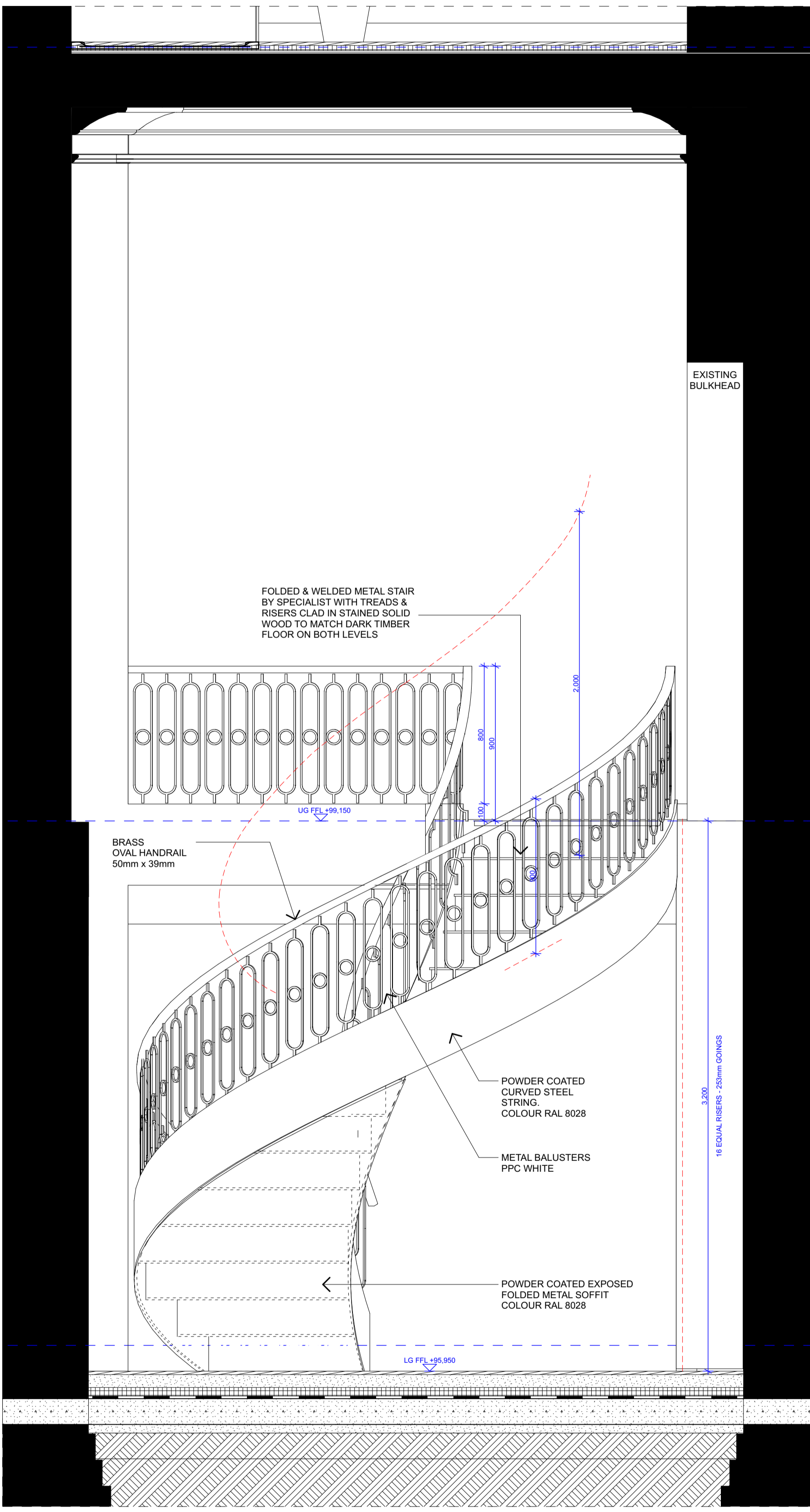

A-A 1:20

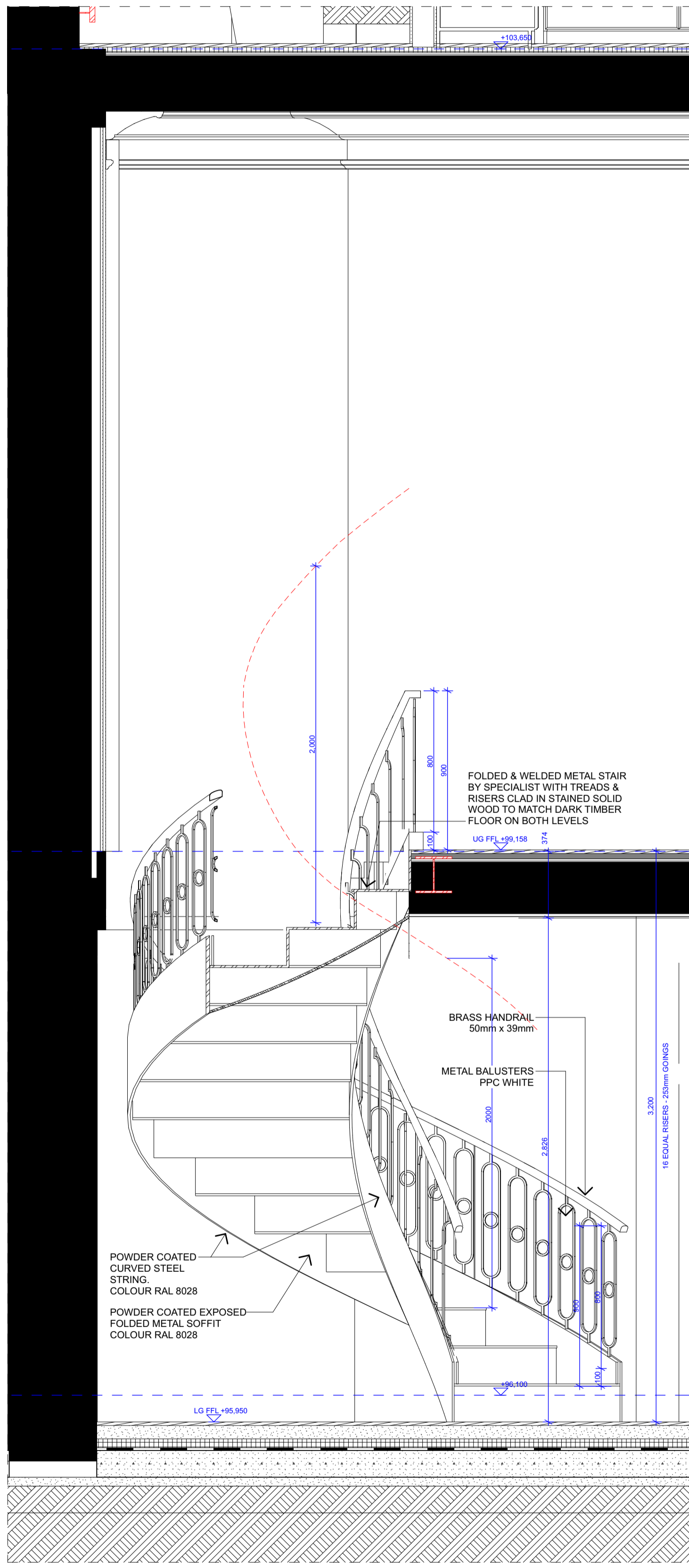

B-B 1:20