

NOTE
 Refer to M&E drawings for Utility cupboard, kitchen and electrical layouts.
 For further Entry Equipment Please Refer to M&E Drawings.
Pendant Lights & Pendant Wiring position shown on RCP Plans. Wired connection point for possible future pendant with associated pattressing. Separate switch for each Pendant.
All Pendants to have Winding Gear
 Structural requirements for pattress TBC by SE.
 Wiring for speaker system in Living, Dining, kitchen and Master Bedroom, for future installation of speakers by customer.
 Wiring and connection point to **All** glazing for electrical Curtains/Blind System.
Dimable Lights - In Living/dining and Master Bedroom.
Automated Lights - In Utility/Coat cupboards. LED Lights to all wardrobes.
Kitchen Manufacture to provide setting out of all sockets and fittings within cabinets as required. Pop up sockets in kitchens
Bathroom layouts shown indicatively only.
 Refer to Detailed Bathroom Layouts drawings.
Level 02 Light Fittings - allow for shallow fittings due to limited joist depth / buildup

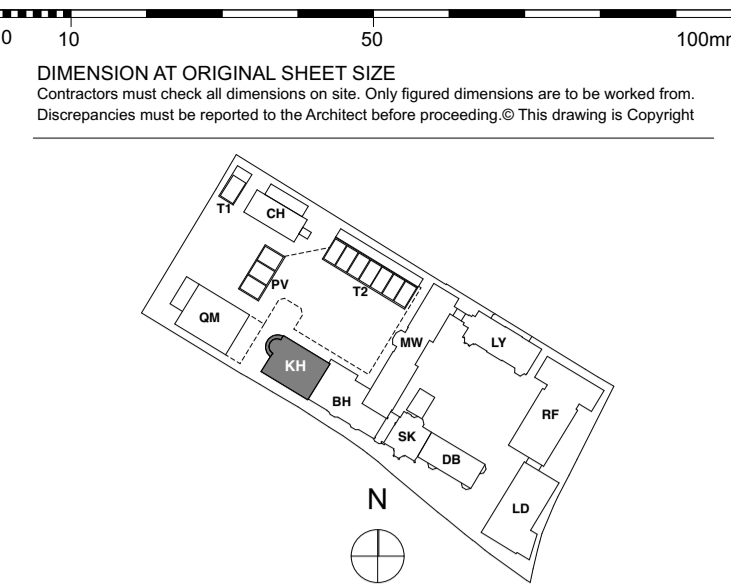

LEGEND

Switch	Heat detector
2 way switch	Extractor
3 way switch	Air supply in
Switch dimmer	Linear air diffuser for supply & extract air
Pendant light	Emergency Light
Pendant Wiring	Fire Detector
Modular luminaire	Fire Detector Sounder base & flashing beacon
Linear downlights	Manual Fire alarm call point
Double directional downlights	Thermostatic Sensor
Wall light, internal	Access Panel
Recessed low energy LED downlighter	Surface Mounted LED Circular Luminaire
LED strip lighting to wardrobes & under wall units	Fob Access
Wall light, external	Speakers
Recessed wall lights at floor level	Recessed uplighter
Wall light	Deck Mounted Light
Single socket	FCU Isolator
Double socket	
lamp switch sockets for lamp circuit	
Lockable single cleaners socket	
PIR Passive Infrared Sensor	
Shaver socket	
Video entryphone and intercom	
TV media plate. Refer to M&E specification	
BT phone & data point	
Floor recessed outlet Power, Data	
Smoke detector	

Ceiling Info.

Ceiling Recess	
Existing Cornice	
Proposed Cornice to match existing	
New Cornice	
Dropped Ceiling	

FOR CONSTRUCTION

REVISION	DRN	CHKD	DATE	
C1	Issued for Construction	NV	TW	17/01/2017
C2	RCPs reviewed following client's comments in workshop coordination 17.04.17	GC	TW	12/04/2017
C3	Existing Shutters/Architrave Info Updated	KVC	KC	01/05/2018
C4	Height and Cornice revision	KVC	AP	25/07/2018
C5	Update to Single Dwelling	KVC	KC	20/12/2018



CLIENT
 MOUNT ANVIL LTD

PROJECT
 KIDDERPORE AVENUE

DRAWING
 Kidderpore Hall
 Level 01 RCP

SCALE
 1:50, 1:5 @ A1

DATE
 December 2018

DRAWING No.
 15 230

DRAWN BY
 KVC

REV
 CS

9000-DRG-23KH-01030

A & Q PARTNERSHIP (LONDON) LTD
 THE LUX BUILDING, 2-4 HOXTON SQUARE, LONDON N1 6 NU
 Tel: 020 7613 2244 Fax: 020 7613 2642 Email: london@aqp.co.uk
 ARCHITECTURE DESIGN MASTERPLANNING INTERIORS

