

Arboricultural Impacts: Summary (For details, see below)		
Impact		No. of Trees
Trees to be removed		0
Trees where manual excavation needed within RPAs		5
Trees where above soil surfacing needed within RPAs		0
Trees with proposed underground services within RPAs		0
Trees that will require pruning		0

Trees that require manual excavation within RPAs		
No.	Species	Type of structure
1	Crab apple	Proposed screw piles
2	Swamp cypress	Proposed screw piles
3	Yew	Proposed screw piles
4	Beech	Proposed screw piles
5	Ash	Proposed screw piles

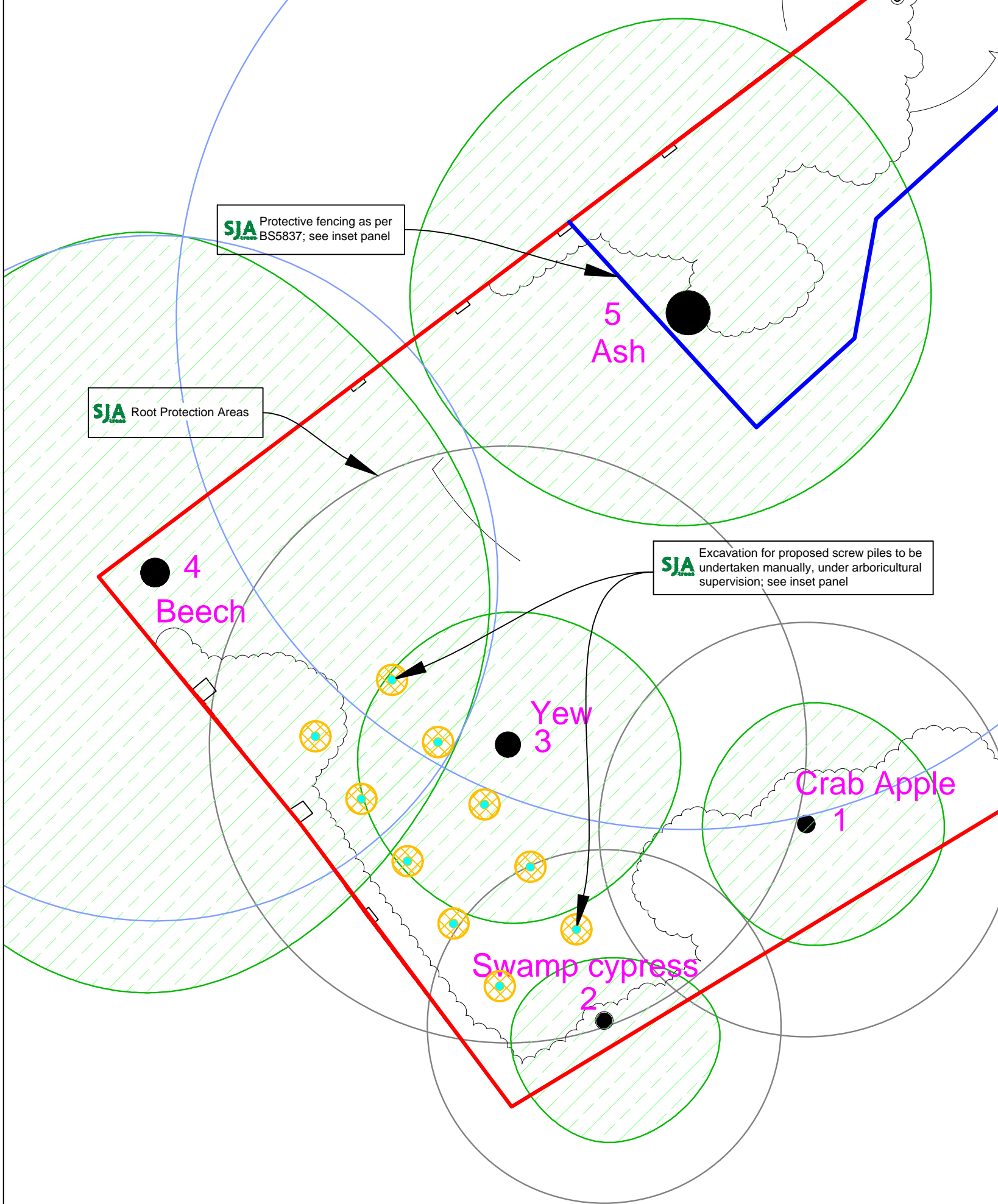

Existing Protective Fencing

Currently installed and to be left in place throughout construction. Comprising a 2m high scaffolding framework, with uprights at maximum 3m spacings, every other one braced to the ground with 45 degree struts; supporting standard anti-climb 'Heras' welded mesh fence panels secured with anti-lift devices to concrete or plastic bases pinned to the ground by scaffold uprights sunk to a minimum depth of 600mm; individual panels fixed to each other with at least 2 clamps and to scaffolding with heavy-duty cable ties. "TREE PROTECTION ZONE - KEEP OUT" or similar notices to be attached to every fifth panel.

Manual Excavation

Within root protection areas the first 600mm depth of excavation for the location and siting of the proposed screw piles shall be undertaken by hand under arboricultural supervision. The soil will be loosened with a pick or fork, and then will be cleared from roots using hand tools. If roots larger than 25mm diameter are encountered they shall be retained and protected, and the pile will be relocated. Any smaller roots shall be cut cleanly by the arboricultural consultant. If roots larger than 25mm diameter are discovered the screw pile has a margin of relocation allowance. Pile locations can be adapted within 250mm to avoid the severance and damage to roots. Once dug, and a suitable location for the piles found, the screw piles will be 'screwed' into the ground by hand. No machinery or heavy plant are to be used. The edge of the excavation closest to the trees will be covered with hessian sacking to prevent drying out until the screw piles are installed. If back filling is needed around piles, a sharp sand and topsoil mix will be used (builders' sand will not be used as it has a high salt content and may be toxic to trees). This will be firmed and consolidated in layers, by hand.

Arboricultural Supervision

The arboricultural consultant will directly supervise all construction works that have to be undertaken within root protection areas. These include:

- Excavations and installations of proposed screw pile foundations.



3D exposed cross sectional representation of screw pile foundations.

SJA ARBORICULTURAL PLANNING CONSULTANTS		
Project:	No. 1 Boscastle Road, NW5	
Client:	Mr J Cuppage & Ms L Hegarty	
Drawing:	ARBORICULTURAL METHOD STATEMENT PLAN	
Drawing no:	SJA AMSP 00689-01	
Based on:	17000-C-100	
Drawn by:	Date of Issue:	Scale:
NHK	20/12/2018	1: 100 @ A3
Checked by:	Tel: (01737) 813058	sj@sjatrees.co.uk
FPS		
Tree nos.:	Canopies of trees to be retained:	Protective fencing:
● 3		
Manual excavation:	Category 'B' RPA:	Category 'C' RPA:

For further information refer to the SJA Tree Schedule. Do not scale from this drawing; please check all dimensions on site, and notify us of any discrepancies. Simon Jones Associates cannot be held responsible for inaccuracies in the topographical plan on which this drawing is based. © Simon Jones Associates Ltd. 2018. This drawing is copyright and may not be used or changed without the written consent of Simon Jones Associates. This drawing is designed to reflect only the principles of layout and/or design insofar as these relate to the protection of trees to be retained, and should NOT be read as a definitive engineering or construction method statement. Reference should be made to the architect or structural engineer, as appropriate, over any matters of construction detail or specification, or any engineering standards or regulatory requirements relating to proposed structures, hard surfaces or underground services.

