



P. U5

KEY

 INDICATES WHEELCHAIR TURNING CIRCLE

 EXISTING CORE UNALTERED

FURNITURE KEY

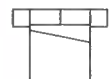
 DOUBLE BEDS ARE 1500X2000 MM

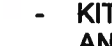
 KITCHEN WORK SURFACES AND WARDROBES ARE 700MM DEEP

DRAWING STATUS
PLANNING - CONDITION 16

NOTES

- DO NOT SCALE FROM THIS DRAWING.
- ALL DIMENSIONS ARE TO BE VERIFIED ON SITE BY THE CONTRACTOR.
- ANY DISCREPANCY FOUND BETWEEN THIS DRAWING AND ANY OTHER DOCUMENTS MUST BE REPORTED IMMEDIATELY TO THE CONTRACT ADMINISTRATOR.
- REMOVE THIS DRAWING FROM CURRENCY WHEN A REVISED DRAWING IS ISSUED.
- COPYRIGHT OF THIS DRAWING REMAINS WITH SCH ARCHITECTS.
- THIS DRAWING IS TO BE READ IN COLLATION WITH THE EMPLOYER'S AND CONSULTANT'S PROJECT DOCUMENTS.

NOTE

APPLICATION FOR DISCHARGE OF CONDITION 16 ISSUE AS PART M4 (2) COMPLIANT

FOR PREVIOUS PLANNING CONSENT. REFER TO PLANNING CONSENT NUMBER: 2016/6366/P. DATE GRANTED: 15/05/17 WITH CONDITION 16 ATTACHED.

A3

C 08/07/18 ISSUED FOR PLANNING (COND. 16)

B 10/11/18 ISSUED FOR PLANNING

A 13/08/18 ISSUED FOR PLANNING (PRE-APP2)

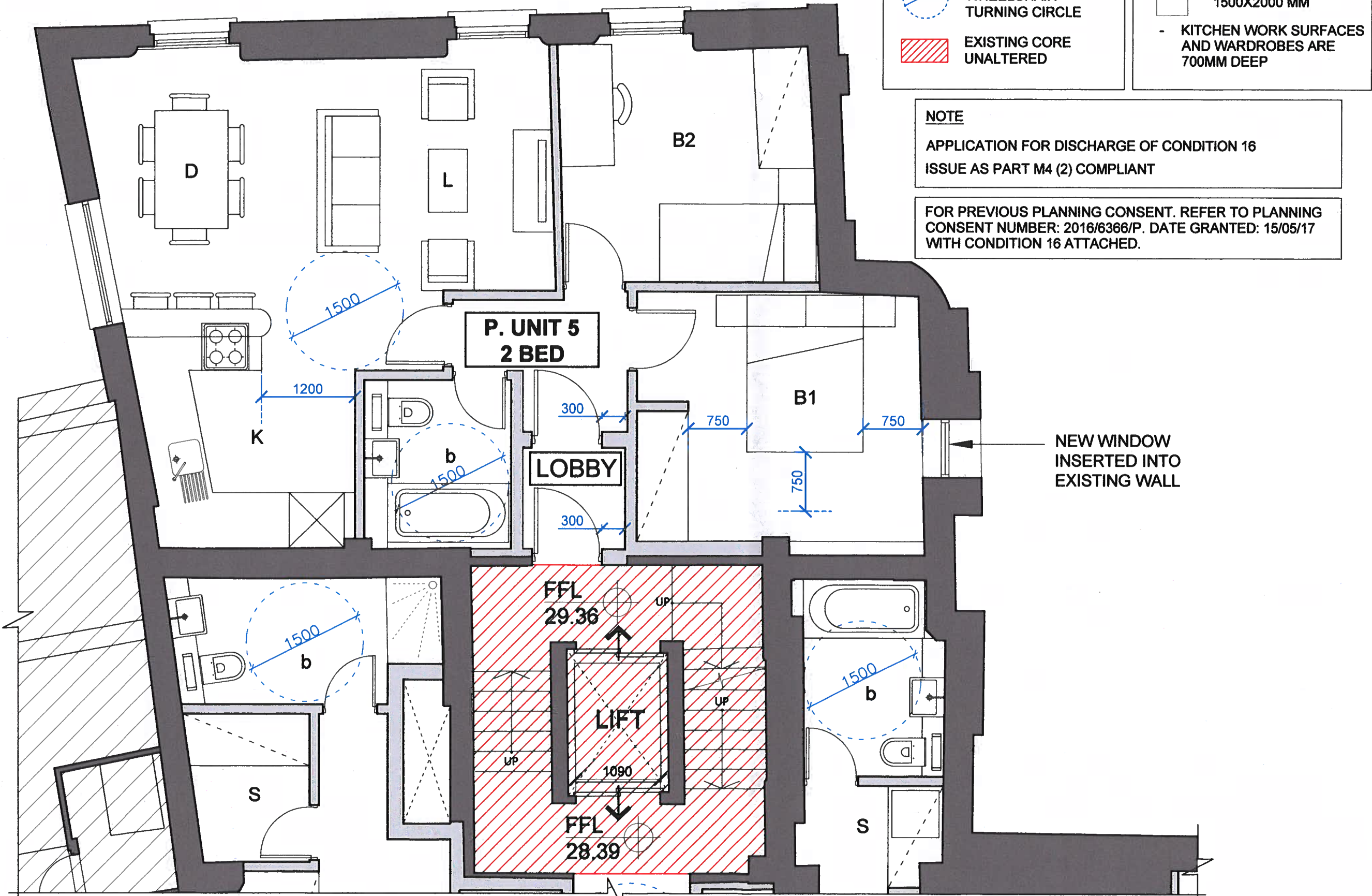

PROPOSED UNIT 5
SCALE 1:50 @ A3

P. UNITS 3 AND 4

 SCALE 1:50 @A3

 0 3m

SMITH C-H ARCHITECTS

23 WEXNER BUILDING
2 STRYPE STREET
LONDON E1 7LF
TEL. 020 7377 8710
FAX. 020 7377 9757
email: mh@sch-architects.com
www.sch-architects.com

ARCHITECTS • DESIGNERS

CLIENT
HATTON GARDEN PROPERTIES

PROJECT
72 - 80 LEATHER LANE LONDON, EC1N 7TR

SCALE 1:50 @ A3	DATE 13.11.18
DRAWN ZOM	CHKD DB

DRAWING TITLE
**PROPOSED UNIT 5
CONDITION 16 PART M4 (2)**

PROJECT NO. 723	DRAWING NO. A111	REV. C
--------------------	---------------------	-----------

P. U8 + P. U9

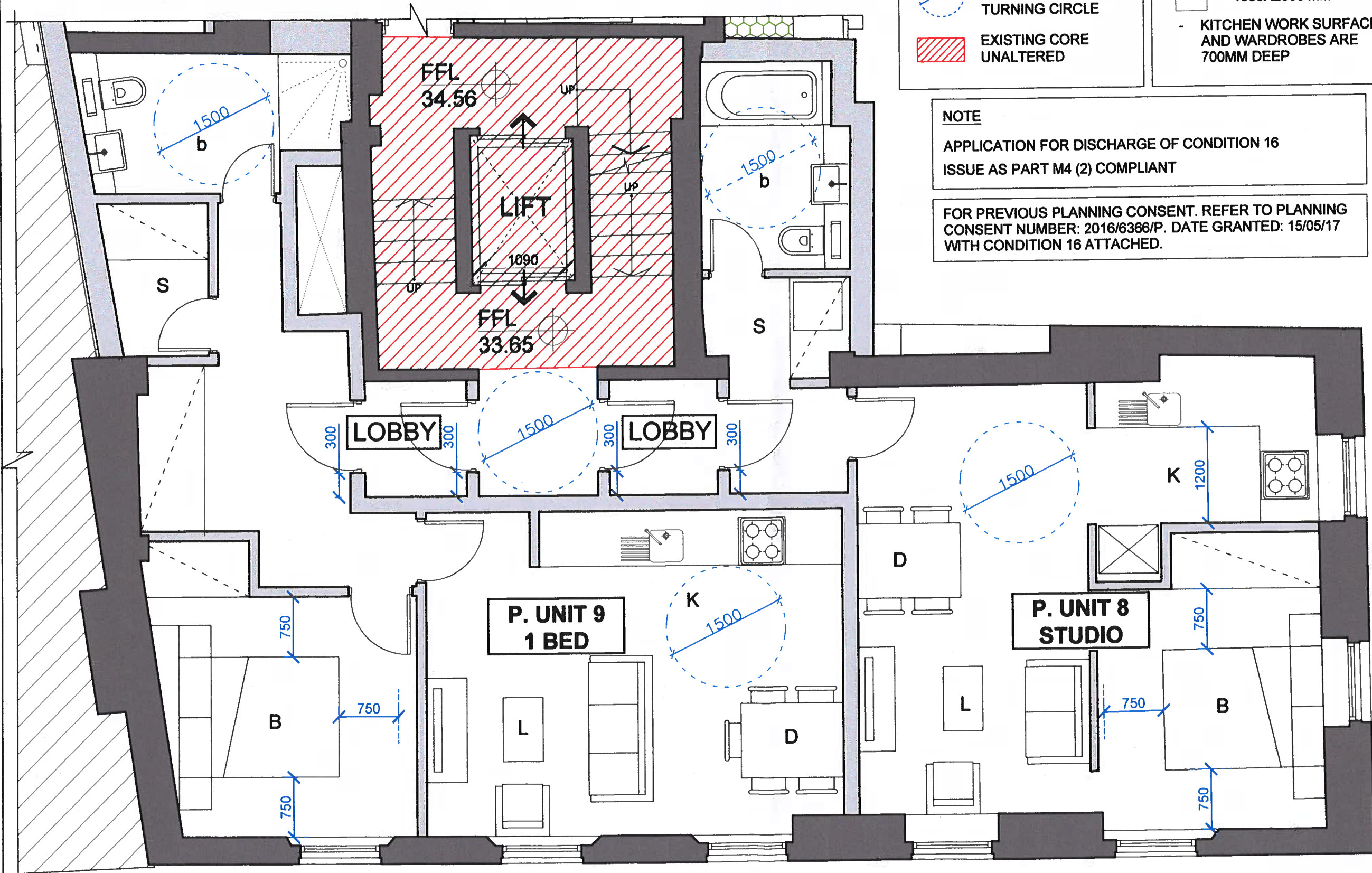

KEY

- INDICATES WHEELCHAIR TURNING CIRCLE
- EXISTING CORE UNALTERED

FURNITURE KEY

- DOUBLE BEDS ARE 1500X2000 MM
- KITCHEN WORK SURFACES AND WARDROBES ARE 700MM DEEP

NOTE
APPLICATION FOR DISCHARGE OF CONDITION 16
ISSUE AS PART M4 (2) COMPLIANT

FOR PREVIOUS PLANNING CONSENT. REFER TO PLANNING
CONSENT NUMBER: 2016/6366/P. DATE GRANTED: 15/05/17
WITH CONDITION 16 ATTACHED.

DRAWING STATUS
PLANNING - CONDITION 16

NOTES

- DO NOT SCALE FROM THIS DRAWING.
- ALL DIMENSIONS ARE TO BE VERIFIED ON SITE BY THE CONTRACTOR.
- ANY DISCREPANCY FOUND BETWEEN THIS DRAWING AND ANY OTHER DOCUMENTS MUST BE REPORTED IMMEDIATELY TO THE CONTRACT ADMINISTRATOR.
- REMOVE THIS DRAWING FROM CURRENCY WHEN A REVISED DRAWING IS ISSUED.
- COPYRIGHT OF THIS DRAWING REMAINS WITH BCH ARCHITECTS.
- THIS DRAWING IS TO BE READ IN CONJUNCTION WITH THE EMPLOYER'S AND CONSULTANT'S PROJECT DOCUMENTS.

A3

C 08/11/18 ISSUED FOR PLANNING (COND. 16)
B 16/11/18 ISSUED FOR PLANNING
A 13/06/18 ISSUED FOR PLANNING (PRE-APP)

SMITH C-H ARCHITECTS

23 WEXNER BUILDING
2 STRYPE STREET
LONDON E1 7LF
TEL : 020 7377 8710
FAX : 020 7377 8757
email : mail@sch-architects.com
www.sch-architects.com

ARCHITECTS • DESIGNERS

CLIENT

HATTON GARDEN PROPERTIES

PROJECT

72 - 80 LEATHER LANE
LONDON, EC1N 7TR

SCALE	DATE
1:50 @ A3	13.11.18
DRAWN	CHKD
ZOM	DS

DRAWING TITLE

PROPOSED UNIT 8 & 9
CONDITION 16 PART M4 (2)

PROJECT NO.	DRAWING NO.	REV.
723	A112	C

PROPOSED UNIT 8 & PROPOSED UNIT 9

SCALE 1:50 @ A3

1

SCALE 1:50 @ A3

0 3m

P. U11

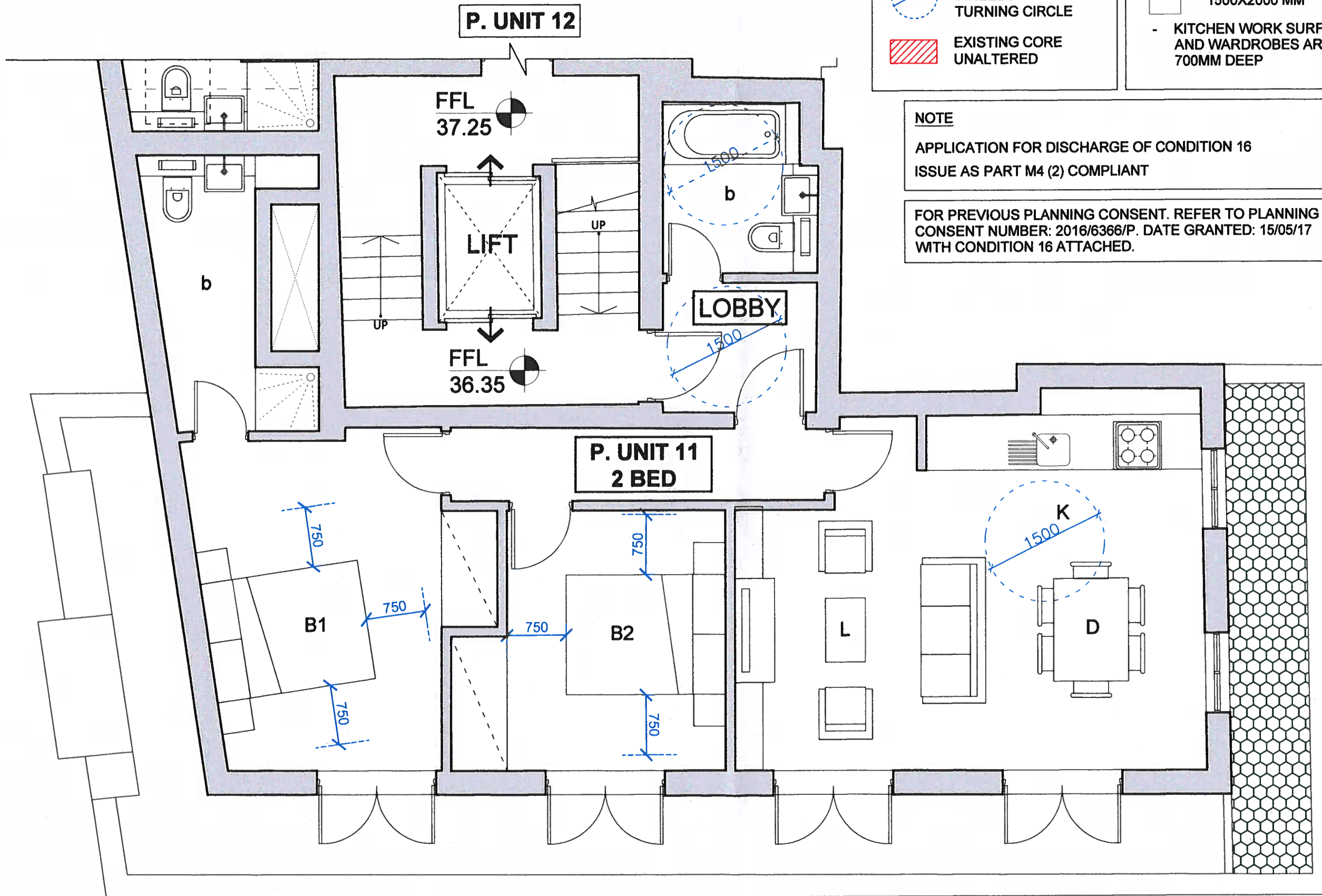

KEY

INDICATES WHEELCHAIR TURNING CIRCLE

EXISTING CORE UNALTERED

FURNITURE KEY

DOUBLE BEDS ARE 1500X2000 MM

KITCHEN WORK SURFACES AND WARDROBES ARE 700MM DEEP

NOTE

APPLICATION FOR DISCHARGE OF CONDITION 16 ISSUE AS PART M4 (2) COMPLIANT

FOR PREVIOUS PLANNING CONSENT. REFER TO PLANNING CONSENT NUMBER: 2016/6366/P. DATE GRANTED: 15/05/17 WITH CONDITION 16 ATTACHED.

DRAWING STATUS
PLANNING - CONDITION 16

- NOTES:
- DO NOT SCALE FROM THIS DRAWING.
 - ALL DIMENSIONS ARE TO BE VERIFIED ON SITE BY THE CONTRACTOR.
 - ANY DISCREPANCY FOUND BETWEEN THIS DRAWING AND ANY OTHER DOCUMENTS MUST BE REPORTED IMMEDIATELY TO THE CONTRACT ADMINISTRATOR.
 - REMOVE THIS DRAWING FROM CURRENCY WHEN A REVISED DRAWING IS ISSUED.
 - COPYRIGHT OF THIS DRAWING REMAINS WITH BCH ARCHITECTS.
 - THIS DRAWING IS TO BE READ IN CONJUNCTION WITH THE EMPLOYER'S AND CONSULTANT'S PROJECT DOCUMENTS.

A3

C 10/07/18 ISSUED FOR PLANNING (COND. 16)

B 10/11/18 ISSUED FOR PLANNING

A 13/08/18 ISSUED FOR PLANNING (PRE-APP)

SMITH C-H ARCHITECTS

23 WEXNER BUILDING
2 STRYPE STREET
LONDON E1 7LF
TEL: 020 7377 8710
FAX: 020 7377 8787
email: mail@sch-architects.com
www.sch-architects.com

ARCHITECTS • DESIGNERS

CLIENT
HATTON GARDEN PROPERTIES

PROJECT
72 - 80 LEATHER LANE LONDON, EC1N 7TR

SCALE 1:50 @ A3	DATE 13.11.18
DRAWN ZOM	CHK'D DS

DRAWING TITLE
**PROPOSED UNIT 11
CONDITION 16 PART M4 (2)**

PROJECT NO. 723	DRAWING NO. A113	REV. C
--------------------	---------------------	-----------

PROPOSED UNIT 11

SCALE 1:50 @ A3

1



SCALE 1:50 @A3

0 3m

P. U12

NOTE

APPLICATION FOR DISCHARGE OF CONDITION 16
ISSUE AS PART M4 (2) COMPLIANT

FOR PREVIOUS PLANNING CONSENT. REFER TO PLANNING
CONSENT NUMBER: 2016/6366/P. DATE GRANTED: 15/05/17
WITH CONDITION 16 ATTACHED.

KEY



INDICATES
WHEELCHAIR
TURNING CIRCLE



EXISTING CORE
UNALTERED

FURNITURE KEY

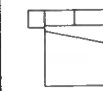

DOUBLE BEDS ARE
1500X2000 MM

- KITCHEN WORK SURFACES
AND WARDROBES ARE
700MM DEEP

DRAWING STATUS
PLANNING - CONDITION 16

- NOTES
- DO NOT SCALE FROM THIS DRAWING.
 - ALL DIMENSIONS ARE TO BE VERIFIED ON SITE BY THE CONTRACTOR.
 - ANY DISCREPANCY FOUND BETWEEN THIS DRAWING AND ANY OTHER DOCUMENTS MUST BE REPORTED IMMEDIATELY TO THE CONTRACT ADMINISTRATOR.
 - REMOVE THIS DRAWING FROM CURRENCY WHEN A REVISED DRAWING IS ISSUED.
 - COPYRIGHT OF THIS DRAWING REMAINS WITH SCA ARCHITECTS.
 - THIS DRAWING IS TO BE READ IN CONNECTION WITH THE EMPLOYER'S AND CONSULTANT'S PROJECT DOCUMENTS.

A3

LOWER FLOOR

UPPER FLOOR

ROOF LIGHTS ABOVE

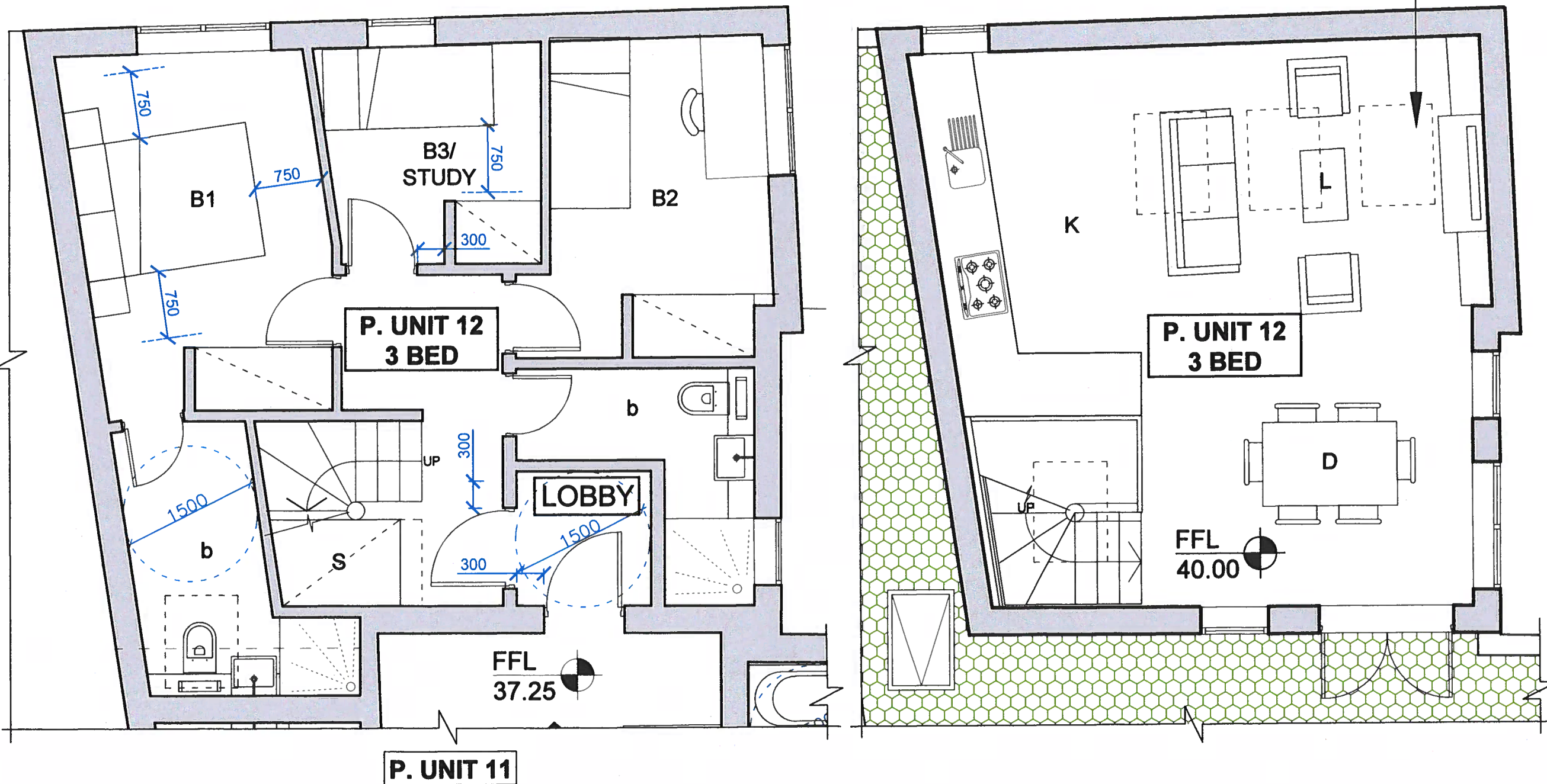

PROPOSED UNIT 12

SCALE 1:50 @ A3

1

SCALE 1:50 @ A3



C 08/01/18 ISSUED FOR PLANNING (COND. 16)
B 18/11/18 ISSUED FOR PLANNING
A 13/08/18 ISSUED FOR PLANNING (PRE-APP)

**SMITH C-H
ARCHITECTS**

23 WEXNER BUILDING
2 STRYPE STREET
LONDON E1 7LF
TEL. 020 7377 8710
FAX. 020 7377 8757
email: mail@sc-h-architects.com
www.sc-h-architects.com

ARCHITECTS • DESIGNERS

CLIENT

HATTON GARDEN
PROPERTIES

PROJECT

72 - 80 LEATHER LANE
LONDON, EC1N 7TR

SCALE

1:50 @ A3

DATE

13.11.18

DRAWN

ZOM

CHKD

DS

DRAWING TITLE

PROPOSED UNIT 12
CONDITION 16 PART M4 (2)

PROJECT NO.

723

DRAWING NO. REV.

A114

C

