

EXTERNAL ELEVATIONS

IF IN DOUBT ASK

SPECIFICATION

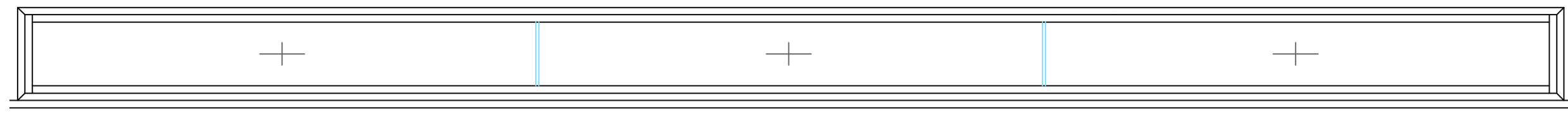

EXTERNAL ELEVATION OF HIGH LEVEL GLAZING  
1:16 @ A1

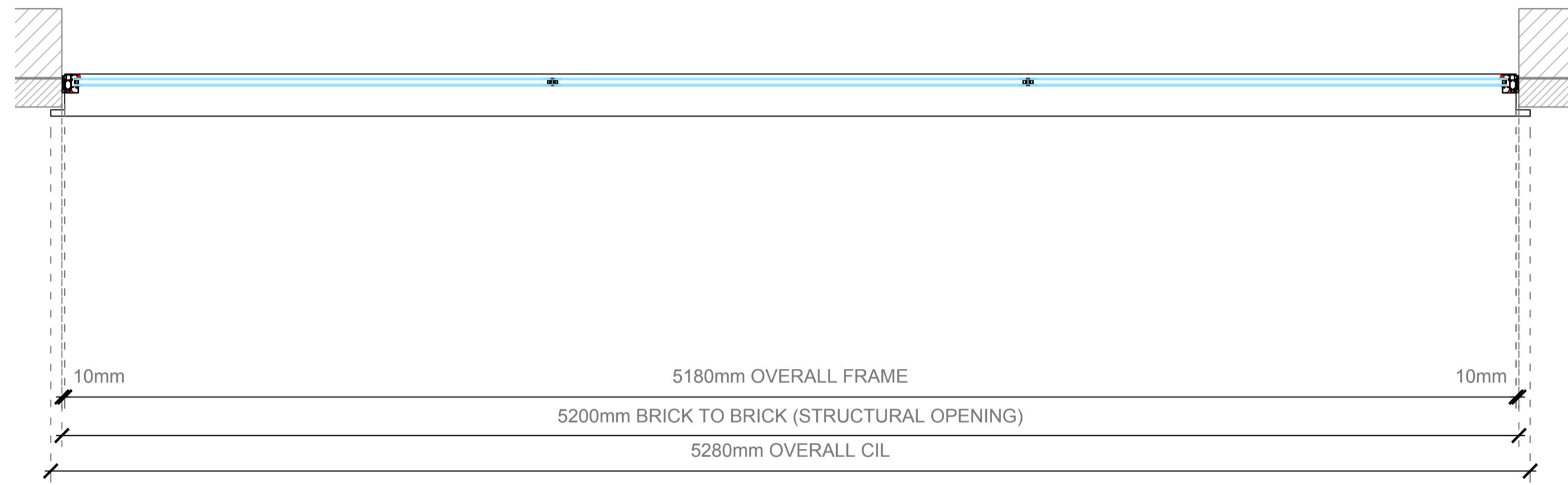

PLAN VIEW OF HIGH LEVEL GLAZING  
1:16 @ A1

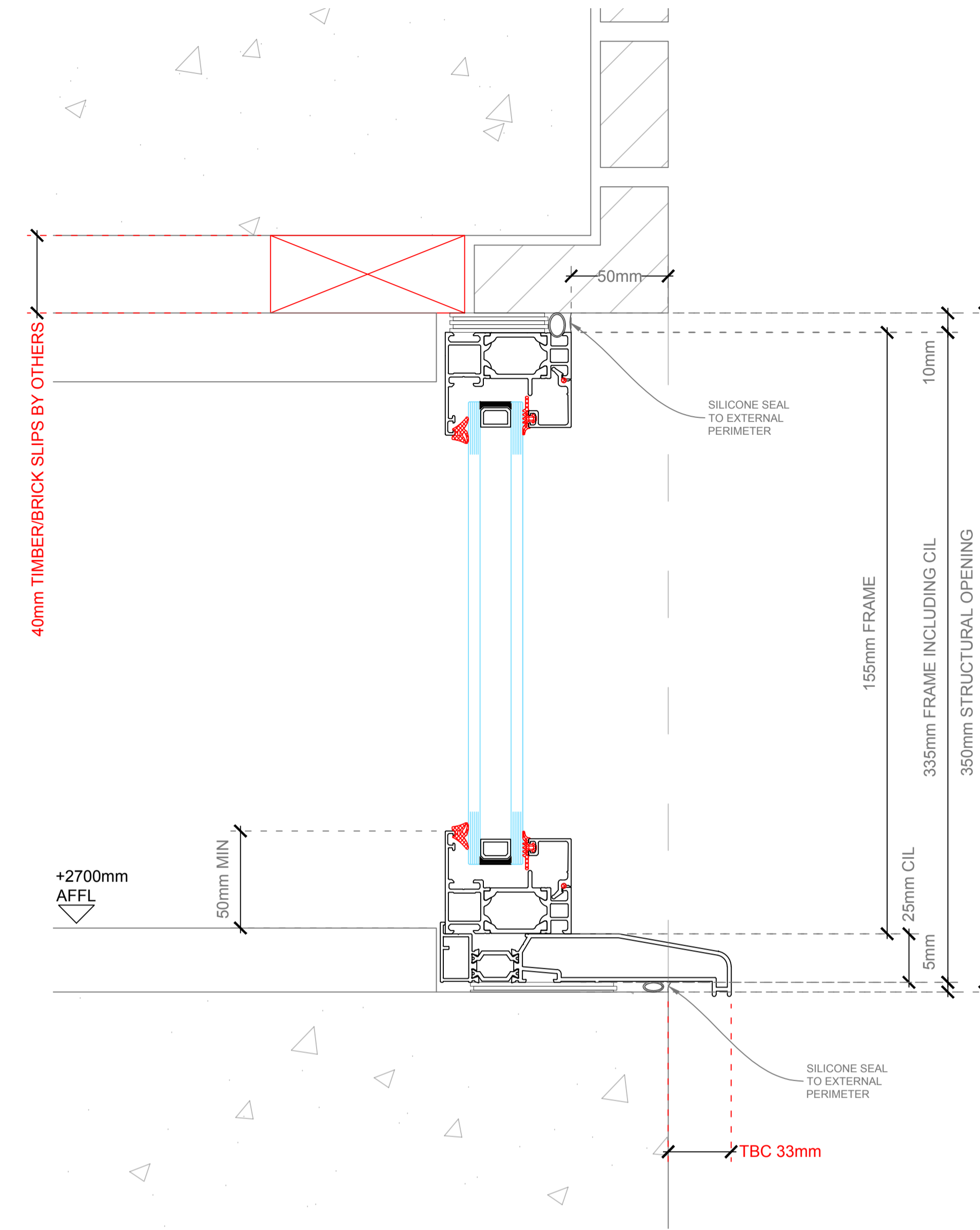

O U T S I D E

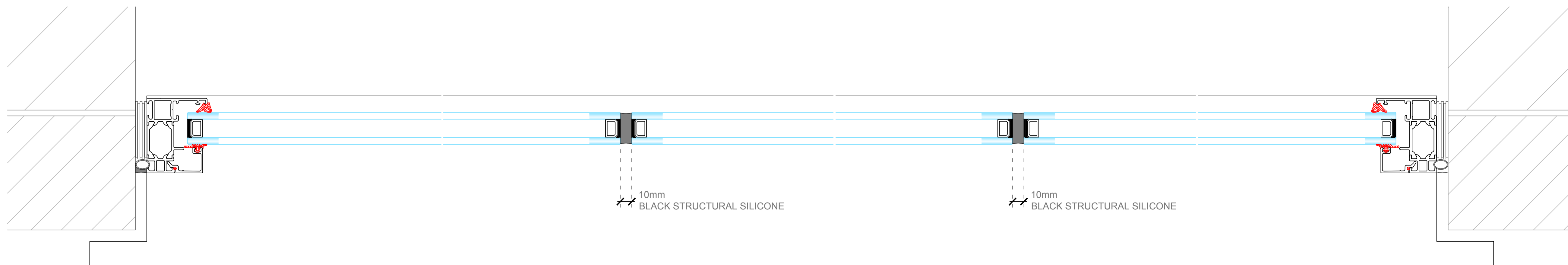

O U T S I D E

MATERIAL	SCHUCO AWS 65
FINISH	POLYESTER POWDER COATED RAL 7011 SATIN
GLASS	6mm CLEAR TOUGHENED EXT 16mm WARM EDGE SPACER 6mm LOW-E TOUGHENED INT (LOW-E TO FACE 3)
GLAZING	BLACK GASKET
FIXING	BY NORTHOLT GLASS
POINTING	SILICONE
GEARING	

FITTINGS	
FACE DRAIN AS PER SYSTEM	

**ISSUE FOR APPROVAL**  
29.10.2018

C		
B		
A	REMOVED OPENING VENT	31.10.2018

AMENDMENTS	
SITE	
6 ROSECROFT AVENUE HAMPSTEAD LONDON NW3 7QB	
ARCHITECT	
CONTRACTOR	
TITLE	
HIGH LEVEL WINDOWS	

DRAWN	DATE	SCALE
RAH	29.10.2018	1:16/2 @ A1

**NG ARCHITECTURAL**  
GLASS & ALUMINIUM SYSTEMS  
UNIT 2, CHILTERN BUSINESS VILLAGE, ARUNDEL ROAD  
UXBRIDGE, MIDDLESEX, UB8 2SN  
E-mail: info@northoltglass.co.uk  
TEL: 01895 206650 FAX: 01895 238471

DRG.No. 18 2324 .03 A