

3. Landfill and Other Waste Sites Map

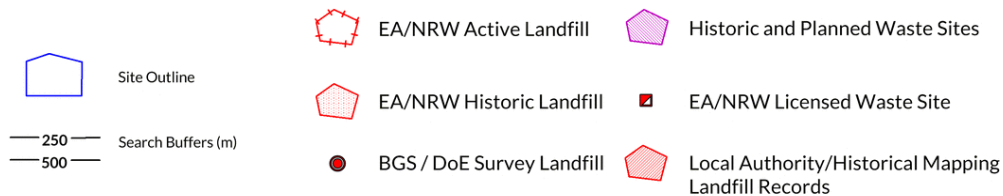
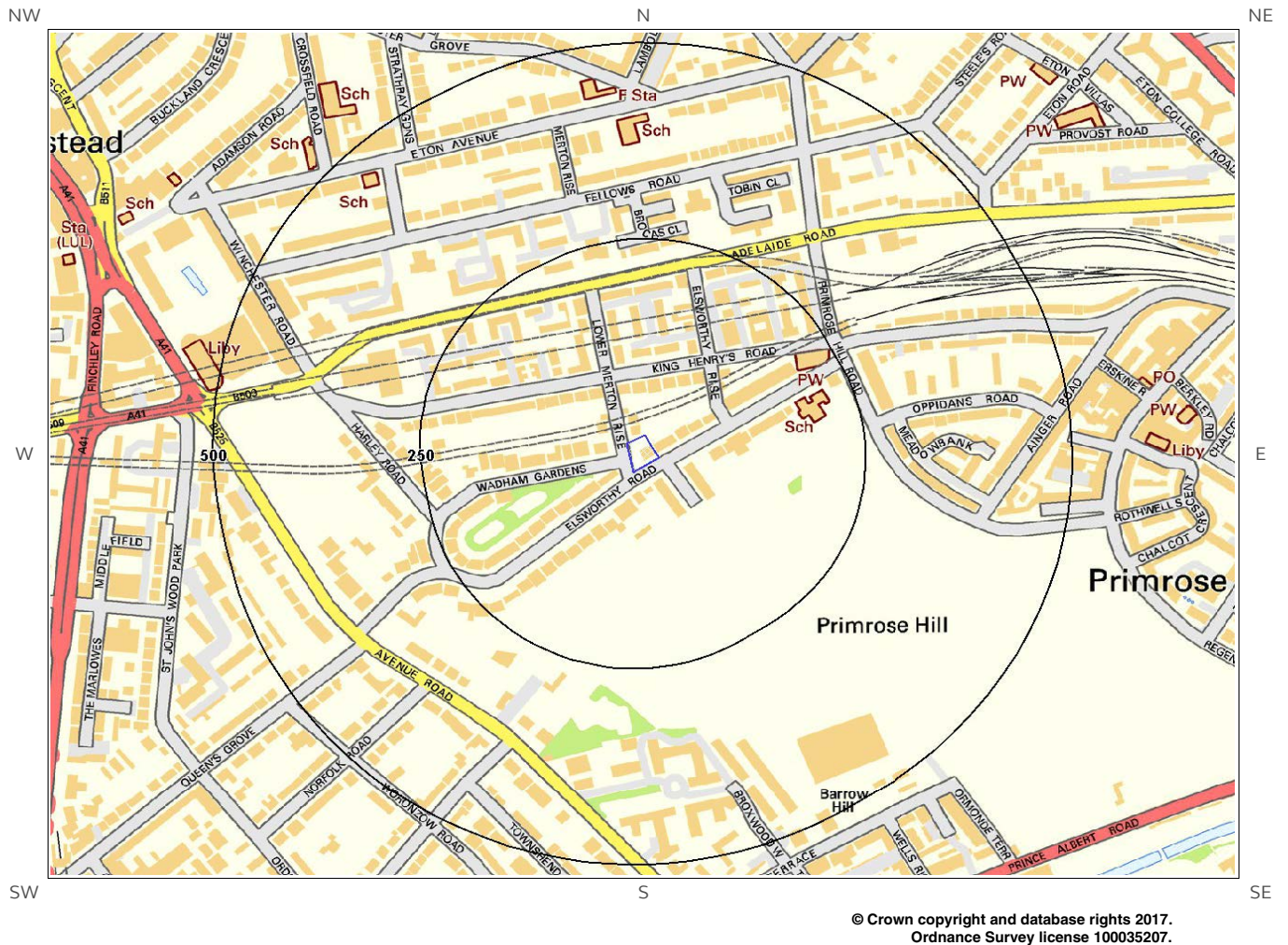

3. Landfill and Other Waste Sites

3.1 Landfill Sites

3.1.1 Records from Environment Agency/Natural Resources Wales landfill data within 1000m of the study site:

0

Database searched and no data found.

3.1.2 Records of Environment Agency/Natural Resources Wales historic landfill sites within 1500m of the study site:

1

The following landfill records are represented as either points or polygons on the Landfill and Other Waste Sites map:

ID	Distance (m)	Direction	NGR	Details	
Not shown	1408	NW	526000 184800	Site Address: Canfield Place, London NW6 Waste Licence: - Site Reference: DON009 Waste Type: - Environmental Permitting Regulations (Waste) Reference: -	Licence Issue: Licence Surrendered: Licence Holder Address: - Operator: - Licence Holder: - First Recorded: - Last Recorded: -

3.1.3 Records of BGS/DoE non-operational landfill sites within 1500m of the study site:

0

Database searched and no data found.

3.1.4 Records of Landfills from Local Authority and Historical Mapping Records within 1500m of the study site:

0

Database searched and no data found.

3.2 Other Waste Sites

3.2.1 Records of waste treatment, transfer or disposal sites within 500m of the study site:

0

Database searched and no data found.

3.2.2 Records of Environment Agency/Natural Resources Wales licensed waste sites within 1500m of the study site:

3

The following waste treatment, transfer or disposal sites records are represented as points on the Landfill and Other Waste Sites map:

ID	Distance (m)	Direction	NGR	Details
Not shown	939	S	527519 183131	<p>Site Address: Regents Park Office, The Store Yard, Inner Circle, Regents Park, London, NW1 4NR Type: Composting Facility Size: < 25000 tonnes Environmental Permitting Regulations (Waste) Licence Number: ROY003 EPR reference: EA/EPR/CB3106XV/A001 Operator: The Royal Parks Waste Management licence No: 401853 Annual Tonnage: 575.0</p> <p>Issue Date: 24/02/2015 Effective Date: - Modified: - Surrendered Date: - Expiry Date: - Cancelled Date: - Status: Issued Site Name: Regents Park Leaf Yard Correspondence Address: -</p>
Not shown	1340	E	528667 184035	<p>Site Address: - Type: Household Waste Amenity Site Size: Unknown Environmental Permitting Regulations (Waste) Licence Number: CAM003 EPR reference: - Operator: Camden London Borough Council Waste Management licence No: 80482 Annual Tonnage: 0.0</p> <p>Issue Date: 15/10/1994 Effective Date: - Modified: - Surrendered Date: 25/07/1997 Expiry Date: - Cancelled Date: - Status: Surrendered Site Name: Jamestown Road Ca Site Correspondence Address: Camden LB Council, Town Hall Extension, Argyle Street, London, WC1H 8EQ</p>
Not shown	1340	E	528667 184035	<p>Site Address: - Type: Household Waste Amenity Site Size: < 25000 tonnes Environmental Permitting Regulations (Waste) Licence Number: CAM003 EPR reference: EA/EPR/UP3697NB/S002 Operator: Camden London Borough Council Waste Management licence No: 80482 Annual Tonnage: 20000.0</p> <p>Issue Date: 15/10/1994 Effective Date: - Modified: - Surrendered Date: 25/07/1997 Expiry Date: - Cancelled Date: - Status: Surrendered Site Name: Jamestown Road CA Site Correspondence Address: -</p>

4. Current Land Use Map

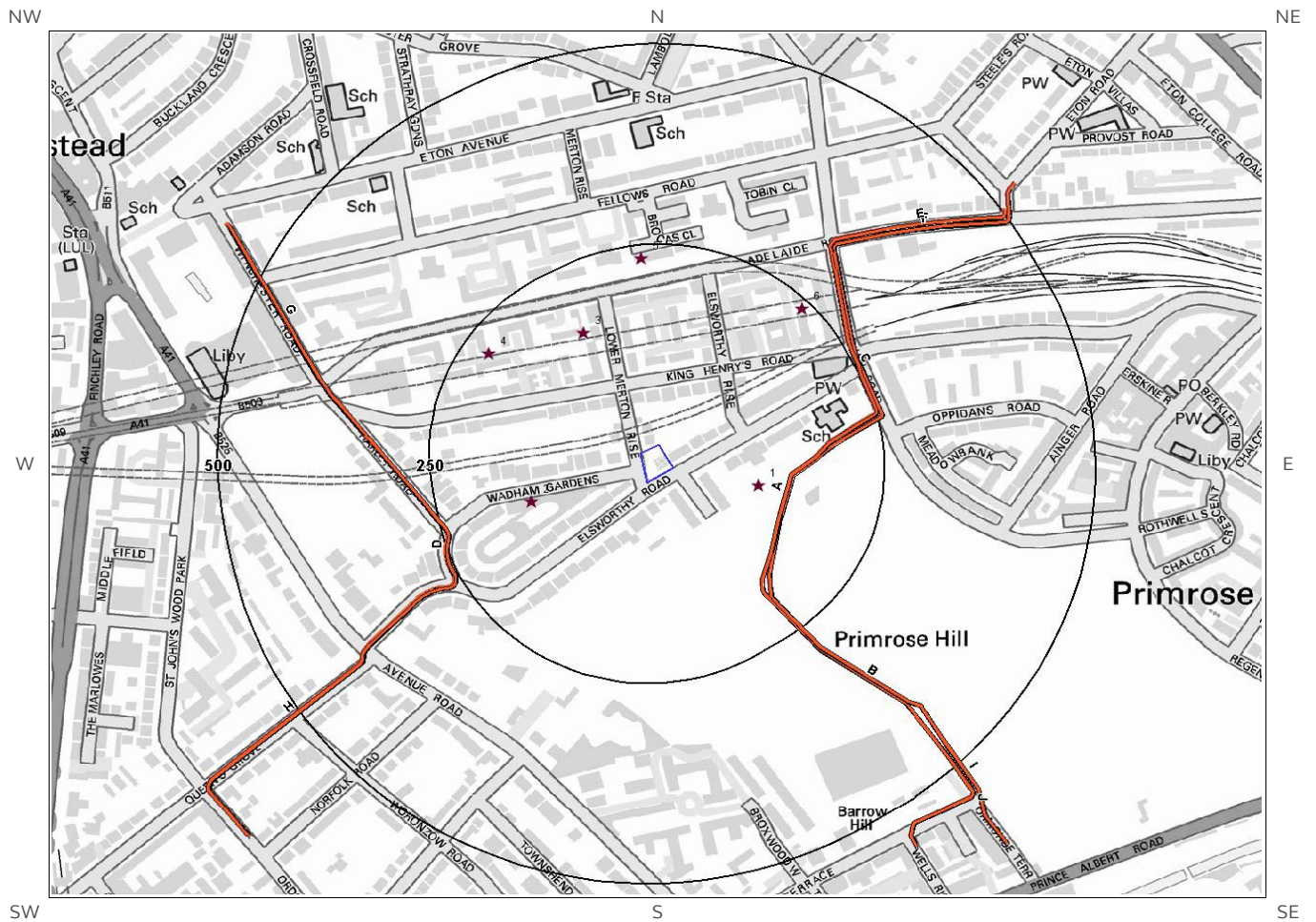

© Crown copyright and database rights 2017.
Ordnance Survey license 100035207.



4. Current Land Uses

4.1 Current Industrial Data

Records of potentially contaminative industrial sites within 250m of the study site:

6

The following records are represented as points on the Current Land Uses map.

ID	Distance (m)	Direction	Company	NGR	Address	Activity	Category
1	103	E	Electricity Sub Station	527428 184041	Electricity Sub Station, NW3	Electrical Features	Infrastructure and Facilities
2	138	W	Electricity Sub Station	527160 184021	Electricity Sub Station, NW3	Electrical Features	Infrastructure and Facilities
3	166	NW	Electricity Sub Station	527221 184231	Electricity Sub Station, NW3	Electrical Features	Infrastructure and Facilities
4	219	NW	Electricity Sub Station	527110 184205	Electricity Sub Station, NW3	Electrical Features	Infrastructure and Facilities
5	234	N	Aquarium Art Ltd	527289 184324	Aquarium Art Ltd, 27, Brocas Close, London, NW3 3LD	Hobby, Sports and Pastime Products	Consumer Products
6	239	NE	Electricity Sub Station	527480 184261	Electricity Sub Station, NW3	Electrical Features	Infrastructure and Facilities

4.2 Petrol and Fuel Sites

Records of petrol or fuel sites within 500m of the study site:

0

Database searched and no data found.

4.3 National Grid High Voltage Underground Electricity Transmission Cables

This dataset identifies the high voltage electricity transmission lines running between generating power plants and electricity substations. The dataset does not include the electricity distribution network (smaller, lower voltage cables distributing power from substations to the local user network). This information has been extracted from databases held by National Grid and is provided for information only with no guarantee as to its completeness or accuracy. National Grid do not offer any warranty as to the accuracy of the available data and are excluded from any liability for any such inaccuracies or errors.

Records of National Grid high voltage underground electricity transmission cables within 500m of the study site:

32

The following Underground Electricity Transmission Cable records are represented as linear features on the Current Land Use map:

ID	Distance (m)	Direction	Details
7A	136	E	Cable Set: CABLE SECT 58 Cable Route: ST JOHNS WOOD - TOTTENHAM 1 Cable Make: BICC 275KV OIL FILLED PB SHEATH CABLE Cable Type: A/C Operating Voltage (kV): 275 Year of installation: 1965 Cable in tunnel: -
8A	137	E	Cable Set: - Cable Route: - Cable Make: - Cable Type: PILOT Operating Voltage (kV): - Year of installation: - Cable in tunnel: -
9A	138	E	Cable Set: - Cable Route: - Cable Make: - Cable Type: PILOT Operating Voltage (kV): - Year of installation: - Cable in tunnel: -
10A	139	E	Cable Set: CABLE SECT 58 Cable Route: ST JOHNS WOOD - TOTTENHAM 2 Cable Make: BICC 275KV OIL FILLED PB SHEATH CABLE Cable Type: A/C Operating Voltage (kV): 275 Year of installation: 1965 Cable in tunnel: -
11B	200	SE	Cable Set: - Cable Route: - Cable Make: - Cable Type: PILOT Operating Voltage (kV): - Year of installation: - Cable in tunnel: -
12B	200	SE	Cable Set: CABLE SECT 59 Cable Route: ST JOHNS WOOD - TOTTENHAM 1 Cable Make: BICC 275KV OIL FILLED PB SHEATH CABLE Cable Type: A/C Operating Voltage (kV): 275 Year of installation: 1965 Cable in tunnel: -
13C	201	E	Cable Set: CABLE SECT 57 Cable Route: ST JOHNS WOOD - TOTTENHAM 1 Cable Make: BICC 275KV OIL FILLED PB SHEATH CABLE Cable Type: A/C Operating Voltage (kV): 275 Year of installation: 1965 Cable in tunnel: -
14C	201	E	Cable Set: - Cable Route: - Cable Make: - Cable Type: PILOT Operating Voltage (kV): - Year of installation: - Cable in tunnel: -
15C	203	E	Cable Set: - Cable Route: - Cable Make: - Cable Type: PILOT Operating Voltage (kV): - Year of installation: - Cable in tunnel: -
16C	203	E	Cable Set: CABLE SECT 57 Cable Route: ST JOHNS WOOD - TOTTENHAM 2 Cable Make: BICC 275KV OIL FILLED PB SHEATH CABLE Cable Type: A/C Operating Voltage (kV): 275 Year of installation: 1965 Cable in tunnel: -
17B	235	SE	Cable Set: CABLE SECT 59 Cable Route: ST JOHNS WOOD - TOTTENHAM 2 Cable Make: BICC 275KV OIL FILLED PB SHEATH CABLE Cable Type: A/C Operating Voltage (kV): 275 Year of installation: 1965 Cable in tunnel: -

ID	Distance (m)	Direction	Details	
18B	235	SE	Cable Set: - Cable Route: - Cable Make: -	Cable Type: PILOT Operating Voltage (kV): - Year of installation: - Cable in tunnel: -
19D	243	W	Cable Set: - Cable Route: - Cable Make: -	Cable Type: PILOT Operating Voltage (kV): - Year of installation: - Cable in tunnel: -
20D	244	W	Cable Set: - Cable Route: MILL HILL - ST JOHNS WOOD 1 Cable Make: -	Cable Type: DECOMMISSIONED Operating Voltage (kV): 275 Year of installation: - Cable in tunnel: -
21D	244	W	Cable Set: - Cable Route: MILL HILL - ST JOHNS WOOD 2 Cable Make: -	Cable Type: DECOMMISSIONED Operating Voltage (kV): 275 Year of installation: - Cable in tunnel: -
22D	245	W	Cable Set: - Cable Route: - Cable Make: -	Cable Type: PILOT Operating Voltage (kV): - Year of installation: - Cable in tunnel: -
23E	301	NE	Cable Set: CABLE SECT 56 Cable Route: ST JOHNS WOOD - TOTTENHAM 1 Cable Make: BICC 275KV OIL FILLED PB SHEATH CABLE	Cable Type: A/C Operating Voltage (kV): 275 Year of installation: 1965 Cable in tunnel: -
24E	301	NE	Cable Set: - Cable Route: - Cable Make: -	Cable Type: PILOT Operating Voltage (kV): - Year of installation: - Cable in tunnel: -
25F	316	NE	Cable Set: - Cable Route: - Cable Make: -	Cable Type: PILOT Operating Voltage (kV): - Year of installation: - Cable in tunnel: -
26F	316	NE	Cable Set: CABLE SECT 56 Cable Route: ST JOHNS WOOD - TOTTENHAM 2 Cable Make: BICC 275KV OIL FILLED PB SHEATH CABLE	Cable Type: A/C Operating Voltage (kV): 275 Year of installation: 1965 Cable in tunnel: -
27G	322	W	Cable Set: - Cable Route: - Cable Make: -	Cable Type: PILOT Operating Voltage (kV): - Year of installation: - Cable in tunnel: -
28G	325	W	Cable Set: - Cable Route: MILL HILL - ST JOHNS WOOD 1 Cable Make: -	Cable Type: DECOMMISSIONED Operating Voltage (kV): 275 Year of installation: - Cable in tunnel: -
29G	325	W	Cable Set: - Cable Route: MILL HILL - ST JOHNS WOOD 2 Cable Make: -	Cable Type: DECOMMISSIONED Operating Voltage (kV): 275 Year of installation: - Cable in tunnel: -
30G	327	W	Cable Set: - Cable Route: - Cable Make: -	Cable Type: PILOT Operating Voltage (kV): - Year of installation: - Cable in tunnel: -
31H	377	SW	Cable Set: - Cable Route: - Cable Make: -	Cable Type: PILOT Operating Voltage (kV): - Year of installation: - Cable in tunnel: -
32H	380	SW	Cable Set: - Cable Route: MILL HILL - ST JOHNS WOOD 1 Cable Make: -	Cable Type: DECOMMISSIONED Operating Voltage (kV): 275 Year of installation: - Cable in tunnel: -

ID	Distance (m)	Direction	Details	
33H	380	SW	Cable Set: - Cable Route: MILL HILL - ST JOHNS WOOD 2 Cable Make: -	Cable Type: DECOMMISSIONED Operating Voltage (kV): 275 Year of installation: - Cable in tunnel: -
34H	383	SW	Cable Set: - Cable Route: - Cable Make: -	Cable Type: PILOT Operating Voltage (kV): - Year of installation: - Cable in tunnel: -
35I	425	SE	Cable Set: - Cable Route: - Cable Make: -	Cable Type: PILOT Operating Voltage (kV): - Year of installation: - Cable in tunnel: -
36I	425	SE	Cable Set: CABLE SECT 60 Cable Route: ST JOHNS WOOD - TOTTENHAM 2 Cable Make: BICC 275KV OIL FILLED PB SHEATH CABLE	Cable Type: A/C Operating Voltage (kV): 275 Year of installation: 1965 Cable in tunnel: -
37J	426	SE	Cable Set: CABLE SECT 60 Cable Route: ST JOHNS WOOD - TOTTENHAM 1 Cable Make: BICC 275KV OIL FILLED PB SHEATH CABLE	Cable Type: A/C Operating Voltage (kV): 275 Year of installation: 1965 Cable in tunnel: -
38J	426	SE	Cable Set: - Cable Route: - Cable Make: -	Cable Type: PILOT Operating Voltage (kV): - Year of installation: - Cable in tunnel: -

4.4 National Grid High Pressure Gas Transmission Pipelines

This dataset identifies high-pressure, large diameter pipelines which carry gas between gas terminals, power stations, compressors and storage facilities. The dataset does not include the Local Transmission System (LTS) which supplies gas directly into homes and businesses. This information has been extracted from databases held by National Grid and is provided for information only with no guarantee as to its completeness or accuracy. National Grid do not offer any warranty as to the accuracy of the available data and are excluded from any liability for any such inaccuracies or errors.

Records of National Grid high pressure gas transmission pipelines within 500m of the study site: 0

Database searched and no data found.

5. Geology

5.1 Artificial Ground and Made Ground

Database searched and no data found.

The database has been searched on site, including a 50m buffer.

5.2 Superficial Ground and Drift Geology

Database searched and no data found.

The database has been searched on site, including a 50m buffer.

5.3 Bedrock and Solid Geology

The database has been searched on site, including a 50m buffer.

Lex Code	Description	Rock Type
LC-XCZS	LONDON CLAY FORMATION	CLAY, SILT AND SAND

(Derived from the BGS 1:50,000 Digital Geological Map of Great Britain)

6 Hydrogeology and Hydrology

6a. Aquifer Within Superficial Geology

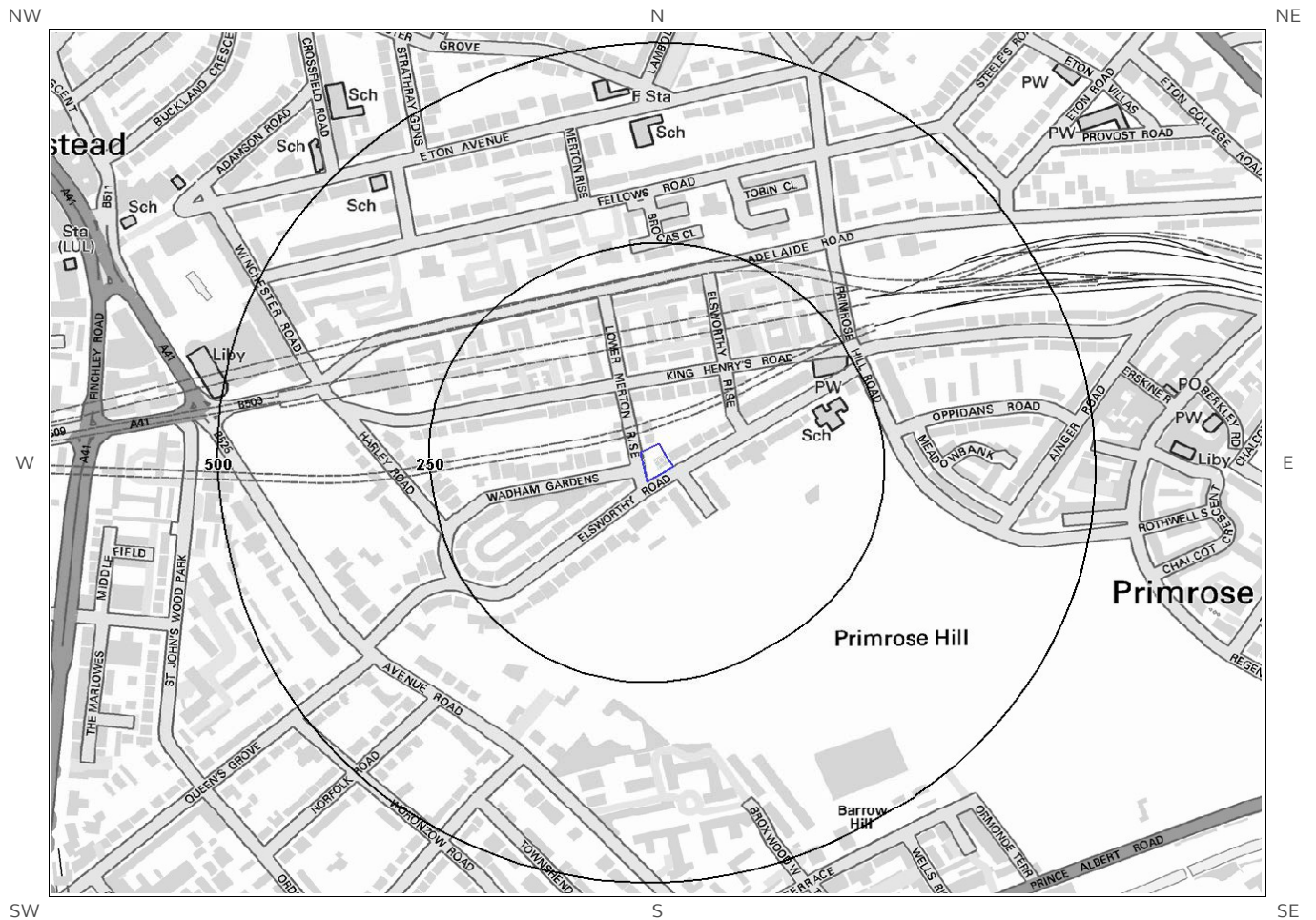

© Crown copyright and database rights 2017
Ordnance Survey license 100035207.

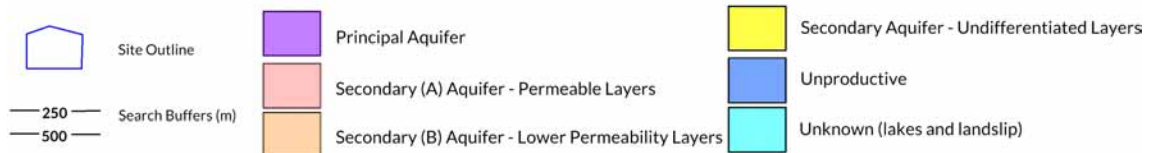

6b. Aquifer Within Bedrock Geology and Abstraction Licenses

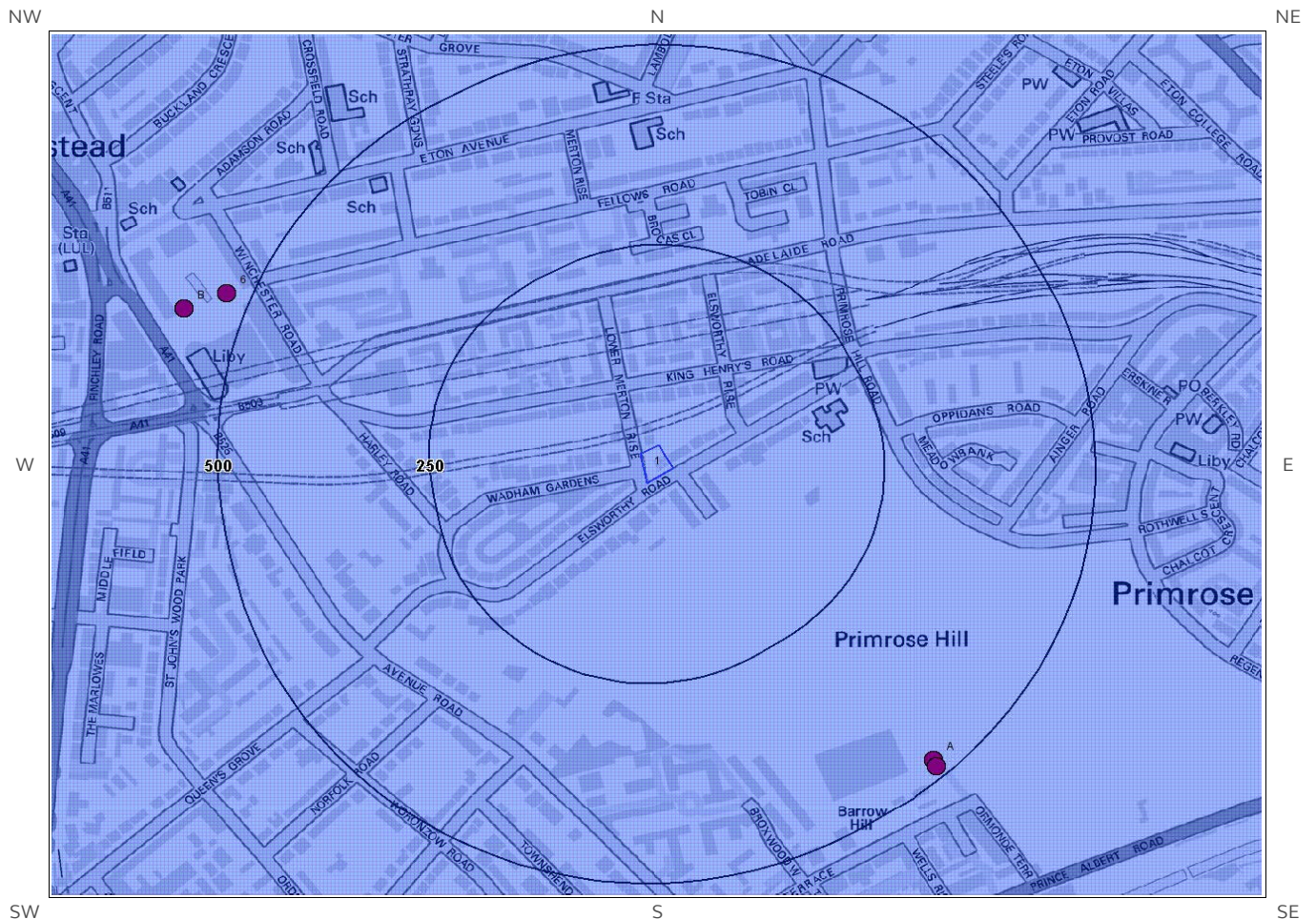

© Crown copyright and database rights 2017
Ordnance Survey license 100035207.



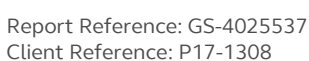
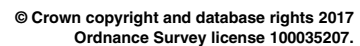

6d. Hydrogeology – Source Protection Zones within confined aquifer

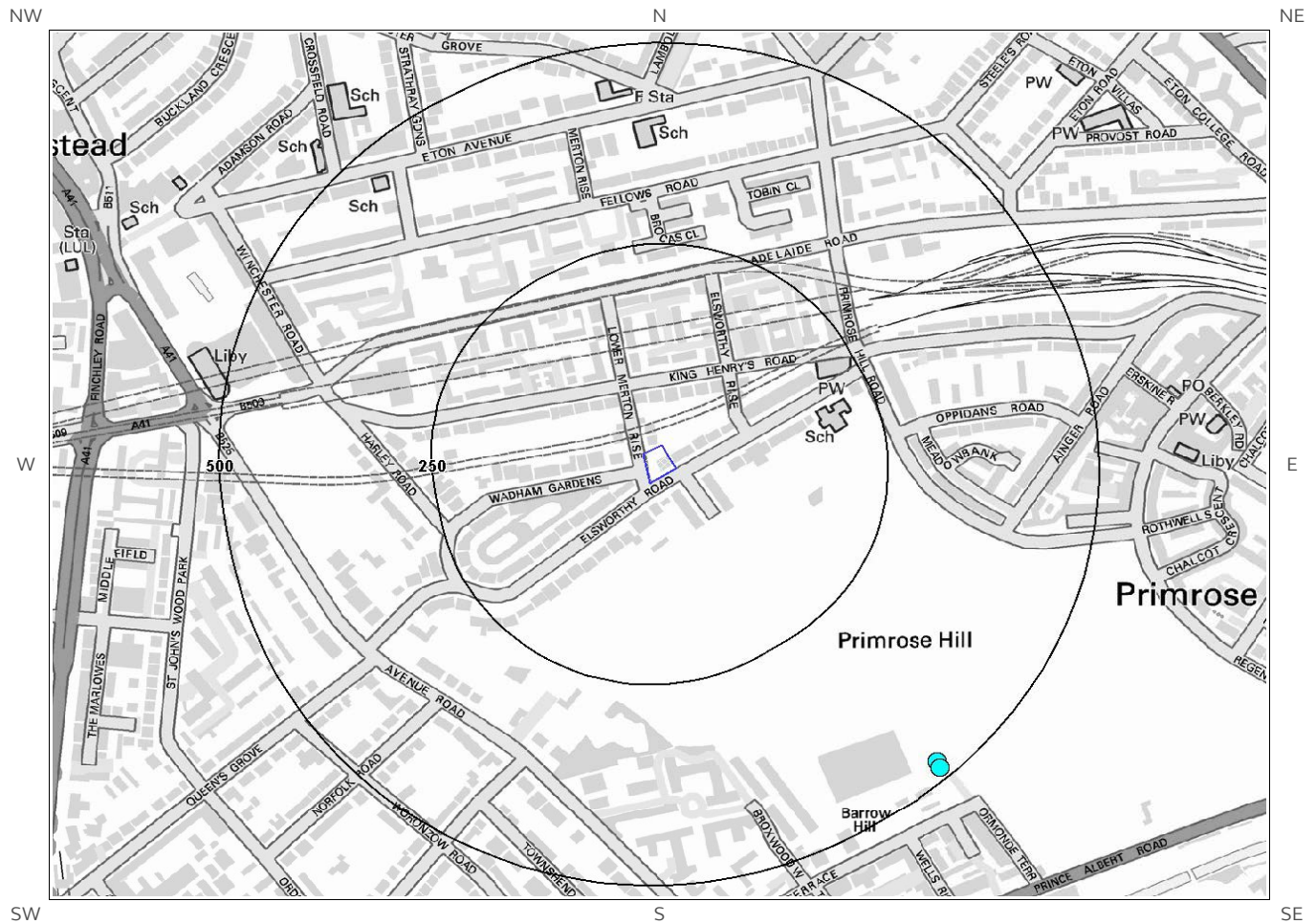

© Crown copyright and database rights 2017
Ordnance Survey license 100035207.

6e. Hydrology – Detailed River Network and River Quality

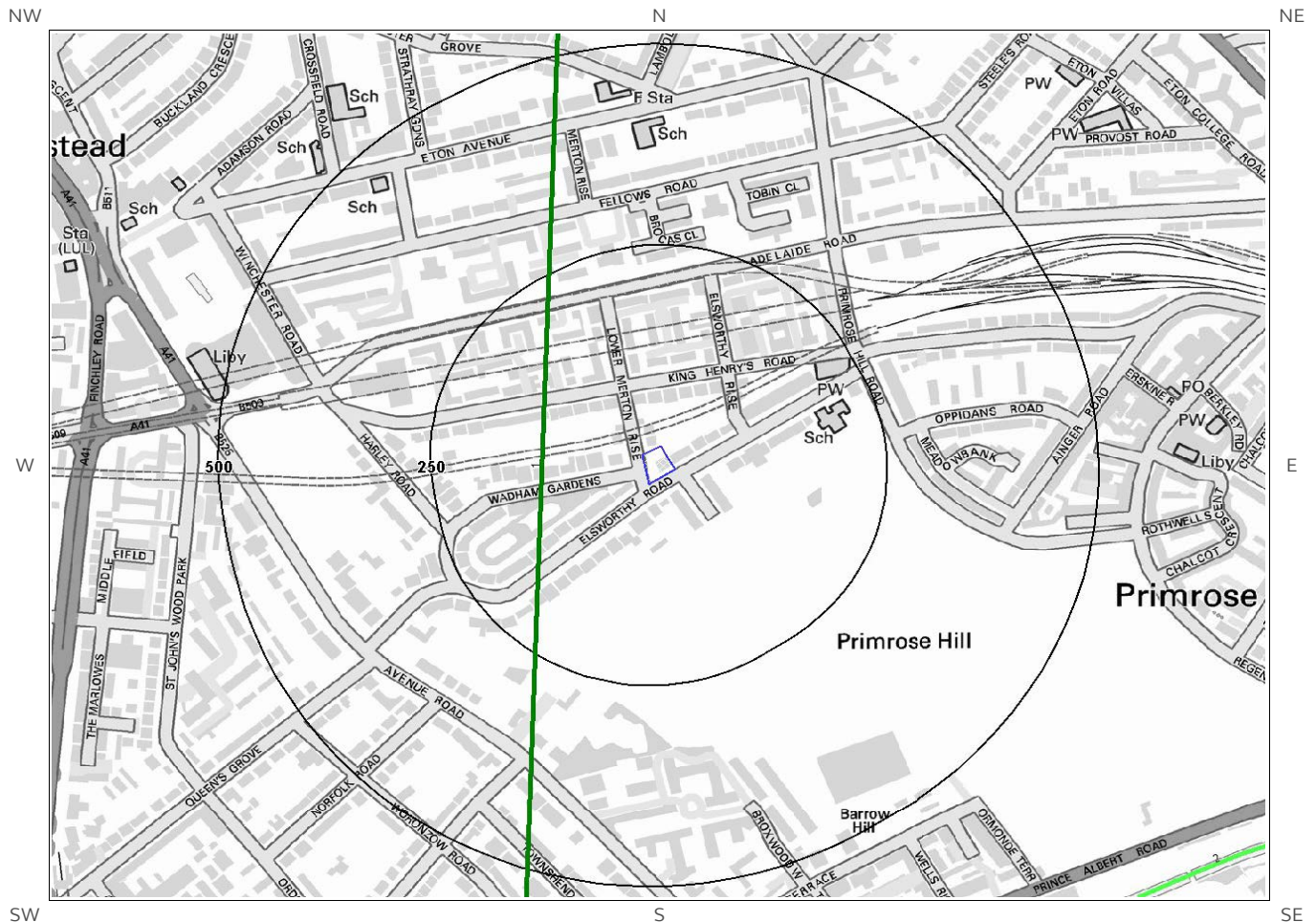

© Crown copyright and database rights 2017.
Ordnance Survey license 100035207.

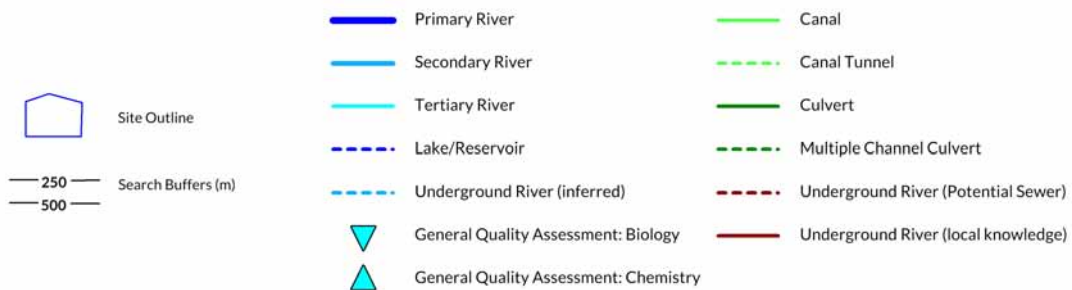

6. Hydrogeology and Hydrology

6.1 Aquifer within Superficial Deposits

Are there records of strata classification within the superficial geology at or in proximity to the property? No

Database searched and no data found.

From 1 April 2010, the Environment Agency/Natural Resources Wales's Groundwater Protection Policy has been using aquifer designations consistent with the Water Framework Directive. For further details on the designation and interpretation of this information, please refer to the Groundsure Enviro Insight User Guide.

6.2 Aquifer within Bedrock Deposits

Are there records of strata classification within the bedrock geology at or in proximity to the property? Yes

From 1 April 2010, the Environment Agency/Natural Resources Wales's Groundwater Protection Policy has been using aquifer designations consistent with the Water Framework Directive. For further details on the designation and interpretation of this information, please refer to the Groundsure Enviro Insight User Guide.

The following aquifer records are shown on the Aquifer within Bedrock Geology Map (6b):

ID	Distance (m)	Direction	Designation	Description
1	0	On Site	Unproductive	These are rock layers or drift deposits with low permeability that have negligible significance for water supply or river base flow

6.3 Groundwater Abstraction Licences

Are there any Groundwater Abstraction Licences within 2000m of the study site? Yes

The following Abstraction Licences records are represented as points, lines and regions on the Aquifer within Bedrock Geology Map (6b):

ID	Distance (m)	Direction	NGR	Details
3A	478	SE	527636 183697	<div> <div> Status: Active Licence No: TH/039/0039/058 Details: Potable Water Supply - Direct Direct Source: Thames Groundwater Point: Borehole At Barrow Hill Data Type: Point Name: THAMES WATER UTILITIES LTD </div> <div> Annual Volume (m³): 631000 Max Daily Volume (m³): 2000 Original Application No: NPS/WR/009229 Original Start Date: 1/4/2013 Expiry Date: 31/3/2025 Issue No: 1 Version Start Date: 1/4/2013 Version End Date: </div> </div>

ID	Distance (m)	Direction	NGR	Details
4A	486	SE	527640 183690	<p>Status: Historical Licence No: 28/39/39/0231 Details: Potable Water Supply - Direct Direct Source: Thames Groundwater Point: Barrow Hill Pumping Station - Borehole Data Type: Point Name: THAMES WATER UTILITIES LTD</p> <p>Annual Volume (m³): 631000 Max Daily Volume (m³): 2000 Original Application No: WRA/R/1026 Original Start Date: 1/4/2007 Expiry Date: 31/3/2013 Issue No: 1 Version Start Date: 1/4/2007 Version End Date:</p>
5A	486	SE	527640 183690	<p>Status: Historical Licence No: 28/39/39/0202 Details: Potable Water Supply - Direct Direct Source: Thames Groundwater Point: Barrow Hill Pumping Station - Borehole Data Type: Point Name: THAMES WATER UTILITIES LTD</p> <p>Annual Volume (m³): 631000 Max Daily Volume (m³): 2000 Original Application No: WRA/2/2(24) Original Start Date: 26/9/2002 Expiry Date: 31/3/2007 Issue No: 1 Version Start Date: 26/9/2002 Version End Date:</p>
6	529	W	526800 184280	<p>Status: Historical Licence No: 28/39/39/0219 Details: Spray Irrigation - Direct Direct Source: Thames Groundwater Point: Swiss Cottage Open Space- Borehole Data Type: Point Name: LONDON BOROUGH OF CAMDEN</p> <p>Annual Volume (m³): 10512 Max Daily Volume (m³): 28.8 Original Application No: WRA/N/1407 Original Start Date: 12/8/2005 Expiry Date: 31/3/2013 Issue No: 1 Version Start Date: 1/4/2008 Version End Date:</p>
7B	569	W	526750 184261	<p>Status: Active Licence No: TH/039/0039/087 Details: Spray Irrigation - Direct Direct Source: Thames Groundwater Point: Swiss Cottage Open Space- Borehole Data Type: Point Name: LONDON BOROUGH OF CAMDEN</p> <p>Annual Volume (m³): 10512 Max Daily Volume (m³): 28.8 Original Application No: NPS/WR/014567 Original Start Date: 5/12/2013 Expiry Date: 31/3/2025 Issue No: 1 Version Start Date: 5/12/2013 Version End Date:</p>
8B	569	W	526750 184261	<p>Status: Active Licence No: TH/039/0039/087 Details: General Washing/Process Washing Direct Source: Thames Groundwater Point: Swiss Cottage Open Space- Borehole Data Type: Point Name: LONDON BOROUGH OF CAMDEN</p> <p>Annual Volume (m³): 10512 Max Daily Volume (m³): 28.8 Original Application No: NPS/WR/014567 Original Start Date: 5/12/2013 Expiry Date: 31/3/2025 Issue No: 1 Version Start Date: 5/12/2013 Version End Date:</p>
9B	569	W	526750 184261	<p>Status: Active Licence No: TH/039/0039/087 Details: Lake & Pond Throughflow Direct Source: Thames Groundwater Point: Swiss Cottage Open Space- Borehole Data Type: Point Name: LONDON BOROUGH OF CAMDEN</p> <p>Annual Volume (m³): 10512 Max Daily Volume (m³): 28.8 Original Application No: NPS/WR/014567 Original Start Date: 5/12/2013 Expiry Date: 31/3/2025 Issue No: 1 Version Start Date: 5/12/2013 Version End Date:</p>
Not shown	944	SE	528000 183400	<p>Status: Historical Licence No: 28/39/39/0035 Details: Animal Watering & General Use in non Farming situations Direct Source: Thames Groundwater Point: Borehole At Regent's Park, London Nw1 Data Type: Point Name: ZOOLOGICAL SOCIETY OF LONDON</p> <p>Annual Volume (m³): 681.9 Max Daily Volume (m³): 59 Original Application No: - Original Start Date: 4/4/1966 Expiry Date: - Issue No: 100 Version Start Date: 4/4/1966 Version End Date:</p>
Not shown	1429	S	527420 182620	<p>Status: Active Licence No: 28/39/39/0115 Details: Drinking, Cooking, Sanitary, Washing, (Small Garden) - Household Direct Source: Thames Groundwater Point: Abbey Lodge, Park Road, London Nw8- two Boreholes Data Type: Point Name: ABBEY LODGE RTM COMPANY LIMITED</p> <p>Annual Volume (m³): 28640 Max Daily Volume (m³): 100 Original Application No: - Original Start Date: 5/9/1966 Expiry Date: - Issue No: 101 Version Start Date: 1/6/2006 Version End Date:</p>

ID	Distance (m)	Direction	NGR	Details	
Not shown	1429	S	527420 182620	Status: Historical Licence No: 28/39/39/0115 Details: Drinking, Cooking, Sanitary, Washing, (Small Garden) - Household Direct Source: Thames Groundwater Point: Two Boreholes At Abbey Lodge, Park Road, London Nw8 Data Type: Point Name: WOOD MANAGEMENT TRUSTEES LTD	Annual Volume (m³): 28640 Max Daily Volume (m³): 100 Original Application No: - Original Start Date: 5/9/1966 Expiry Date: - Issue No: 100 Version Start Date: 28/11/1991 Version End Date:
Not shown	1605	NE	528800 184700	Status: Historical Licence No: 28/39/39/0091 Details: Drinking, Cooking, Sanitary, Washing, (Small Garden) - Commercial/Industrial/Public Services Direct Source: Thames Groundwater Point: Two Bores At Kentish Town Sports Centre, Prince Of Wales St Data Type: Point Name: GREENWICH LEISURE LTD	Annual Volume (m³): 94506 Max Daily Volume (m³): 1813.8 Original Application No: NPS/WR/010565 Original Start Date: 13/6/1966 Expiry Date: - Issue No: 101 Version Start Date: 5/4/2012 Version End Date:
Not shown	1605	NE	528800 184700	Status: Historical Licence No: 28/39/39/0091 Details: Process Water Direct Source: Thames Groundwater Point: Two Bores At Kentish Town Sports Centre, Prince Of Wales St Data Type: Point Name: GREENWICH LEISURE LTD	Annual Volume (m³): 94506 Max Daily Volume (m³): 1813.8 Original Application No: NPS/WR/010565 Original Start Date: 13/6/1966 Expiry Date: - Issue No: 101 Version Start Date: 5/4/2012 Version End Date:
Not shown	1605	NE	528800 184700	Status: Historical Licence No: 28/39/39/0091 Details: Laundry Use Direct Source: Thames Groundwater Point: Two Bores At Kentish Town Sports Centre, Prince Of Wales St Data Type: Point Name: GREENWICH LEISURE LTD	Annual Volume (m³): 94506 Max Daily Volume (m³): 1813.8 Original Application No: NPS/WR/010565 Original Start Date: 13/6/1966 Expiry Date: - Issue No: 101 Version Start Date: 5/4/2012 Version End Date:
Not shown	1605	NE	528800 184700	Status: Active Licence No: 28/39/39/0091 Details: Process Water Direct Source: Thames Groundwater Point: Kentish Town Sports Centre, Prince Of Wales St Data Type: Point Name: GREENWICH LEISURE LIMITED	Annual Volume (m³): 17997 Max Daily Volume (m³): 604.6 Original Application No: NPS/WR/010565 Original Start Date: 13/6/1966 Expiry Date: - Issue No: 101 Version Start Date: 25/5/2012 Version End Date:
Not shown	1605	NE	528800 184700	Status: Active Licence No: 28/39/39/0091 Details: Drinking, Cooking, Sanitary, Washing, (Small Garden) - Commercial/Industrial/Public Services Direct Source: Thames Groundwater Point: Kentish Town Sports Centre, Prince Of Wales St Data Type: Point Name: GREENWICH LEISURE LIMITED	Annual Volume (m³): 17997 Max Daily Volume (m³): 604.6 Original Application No: NPS/WR/010565 Original Start Date: 13/6/1966 Expiry Date: - Issue No: 101 Version Start Date: 25/5/2012 Version End Date:

6.4 Surface Water Abstraction Licences

Are there any Surface Water Abstraction Licences within 2000m of the study site?

Yes

The following Surface Water Abstraction Licences records are represented as points, lines and regions on the Aquifer within Bedrock Geology Map (6b):

ID	Distance (m)	Direction	NGR	Details
Not shown	1163	E	528490 184020	Status: Historical Licence No: 28/39/39/0173 Details: Non-Evaporative Cooling Direct Source: Thames Surface Water - Non Tidal Point: Oval Road, Camden - Grand Union Regents Canal Data Type: Point Name: BRITISH WATERWAYS BOARD Annual Volume (m³): - Max Daily Volume (m³): - Application No: - Original Start Date: 8/12/1994 Expiry Date: - Issue No: 100 Version Start Date: 8/12/1994 Version End Date:
Not shown	1173	E	528500 184020	Status: Active Licence No: 28/39/39/0164 Details: Non-Evaporative Cooling Direct Source: Thames Surface Water - Non Tidal Point: Southampton Bridge, London, Nw8 - Regents Canal Data Type: Point Name: Canal and River Trust Annual Volume (m³): 7010000 Max Daily Volume (m³): 19520 Application No: - Original Start Date: 18/7/1980 Expiry Date: - Issue No: 101 Version Start Date: 17/12/2007 Version End Date:
Not shown	1603	S	527050 182460	Status: Active Licence No: 28/39/39/0164 Details: Non-Evaporative Cooling Direct Source: Thames Surface Water - Non Tidal Point: St John's Wood, London - Regents Canal Data Type: Point Name: Canal and River Trust Annual Volume (m³): 7010000 Max Daily Volume (m³): 19520 Application No: - Original Start Date: 18/7/1980 Expiry Date: - Issue No: 101 Version Start Date: 17/12/2007 Version End Date:

6.5 Potable Water Abstraction Licences

Are there any Potable Water Abstraction Licences within 2000m of the study site?

Yes

The following Potable Water Abstraction Licences records are represented as points, lines and regions on the SPZ and Potable Water Abstraction Licences Map (6c):

ID	Distance (m)	Direction	NGR	Details
3A	478	SE	527636 183697	Status: Active Licence No: TH/039/0039/058 Details: Potable Water Supply - Direct Direct Source: Thames Groundwater Point: Borehole At Barrow Hill Data Type: Point Name: THAMES WATER UTILITIES LTD Annual Volume (m³): 631000 Max Daily Volume (m³): 2000 Original Application No: NPS/WR/009229 Original Start Date: 1/4/2013 Expiry Date: 31/3/2025 Issue No: 1 Version Start Date: Version End Date:
4A	486	SE	527640 183690	Status: Historical Licence No: 28/39/39/0202 Details: Potable Water Supply - Direct Direct Source: Thames Groundwater Point: Barrow Hill Pumping Station - Borehole Data Type: Point Name: THAMES WATER UTILITIES LTD Annual Volume (m³): 631000 Max Daily Volume (m³): 2000 Original Application No: WRA/2/2(24) Original Start Date: 26/9/2002 Expiry Date: 31/3/2007 Issue No: 1 Version Start Date: Version End Date:

ID	Distance (m)	Direction	NGR	Details
5A	486	SE	527640 183690	<p>Status: Historical Licence No: 28/39/39/0231 Details: Potable Water Supply - Direct Direct Source: Thames Groundwater Point: Barrow Hill Pumping Station - Borehole Data Type: Point Name: THAMES WATER UTILITIES LTD</p> <p>Annual Volume (m³): 631000 Max Daily Volume (m³): 2000 Original Application No: WRA/R/1026 Original Start Date: 1/4/2007 Expiry Date: 31/3/2013 Issue No: 1 Version Start Date: Version End Date:</p>
Not shown	1429	S	527420 182620	<p>Status: Active Licence No: 28/39/39/0115 Details: Drinking, Cooking, Sanitary, Washing, (Small Garden) - Household Direct Source: Thames Groundwater Point: Abbey Lodge, Park Road, London Nw8-two Boreholes Data Type: Point Name: ABBEY LODGE RTM COMPANY LIMITED</p> <p>Annual Volume (m³): 28640 Max Daily Volume (m³): 100 Original Application No: - Original Start Date: 5/9/1966 Expiry Date: - Issue No: 101 Version Start Date: Version End Date:</p>
Not shown	1429	S	527420 182620	<p>Status: Historical Licence No: 28/39/39/0115 Details: Drinking, Cooking, Sanitary, Washing, (Small Garden) - Household Direct Source: Thames Groundwater Point: Two Boreholes At Abbey Lodge, Park Road, London Nw8 Data Type: Point Name: WOOD MANAGEMENT TRUSTEES LTD</p> <p>Annual Volume (m³): 28640 Max Daily Volume (m³): 100 Original Application No: - Original Start Date: 5/9/1966 Expiry Date: - Issue No: 100 Version Start Date: Version End Date:</p>
Not shown	1605	NE	528800 184700	<p>Status: Historical Licence No: 28/39/39/0091 Details: Drinking, Cooking, Sanitary, Washing, (Small Garden) - Commercial/Industrial/Public Services Direct Source: Thames Groundwater Point: Two Bores At Kentish Town Sports Centre, Prince Of Wales St Data Type: Point Name: GREENWICH LEISURE LTD</p> <p>Annual Volume (m³): 94506 Max Daily Volume (m³): 1813.8 Original Application No: NPS/WR/010565 Original Start Date: 13/6/1966 Expiry Date: - Issue No: 101 Version Start Date: Version End Date:</p>
Not shown	1605	NE	528800 184700	<p>Status: Active Licence No: 28/39/39/0091 Details: Drinking, Cooking, Sanitary, Washing, (Small Garden) - Commercial/Industrial/Public Services Direct Source: Thames Groundwater Point: Kentish Town Sports Centre, Prince Of Wales St Data Type: Point Name: GREENWICH LEISURE LIMITED</p> <p>Annual Volume (m³): 17997 Max Daily Volume (m³): 604.6 Original Application No: NPS/WR/010565 Original Start Date: 13/6/1966 Expiry Date: - Issue No: 101 Version Start Date: Version End Date:</p>

6.6 Source Protection Zones

Are there any Source Protection Zones within 500m of the study site?

Yes

The following Source Protection Zones records are represented on the SPZ and Potable Water Abstraction Map (6c):

ID	Distance (m)	Direction	Zone	Description
2	0	On Site	2	Outer catchment
1	183	SE	1	Inner catchment

6.7 Source Protection Zones within Confined Aquifer

Are there any Source Protection Zones within the Confined Aquifer within 500m of the study site? No

Historically, Source Protection Zone maps have been focused on regulation of activities which occur at or near the ground surface, such as prevention of point source pollution and bacterial contamination of water supplies. Sources in confined aquifers were often considered to be protected from these surface pressures due to the presence of a low permeability confining layer (e.g. glacial till, clay). The increased interest in subsurface activities such as onshore oil and gas exploration, ground source heating and cooling requires protection zones for confined sources to be marked on SPZ maps where this has not already been done.

Database searched and no data found.

6.8 Groundwater Vulnerability and Soil Leaching Potential

Is there any Environment Agency/Natural Resources Wales information on groundwater vulnerability and soil leaching potential within 500m of the study site? No

Database searched and no data found.

6.9 River Quality

Is there any Environment Agency/Natural Resources Wales information on river quality within 1500m of the study site? No

6.9.1 Biological Quality:

Database searched and no data found.

6.9.2 Chemical Quality:

Database searched and no data found.

6.10 Detailed River Network

Are there any Detailed River Network entries within 500m of the study site? Yes

The following Detailed River Network records are represented on the Hydrology Map (6e):

ID	Distance (m)	Direction	Details	
1	118	W	River Name: - Welsh River Name: - Alternative Name: -	River Type: Culvert Main River Status: Currently Undefined

6.11 Surface Water Features

Are there any surface water features within 250m of the study site?

No

Database searched and no data found.

7a. Environment Agency/Natural Resources Wales Flood Map for Planning (from rivers and the sea)

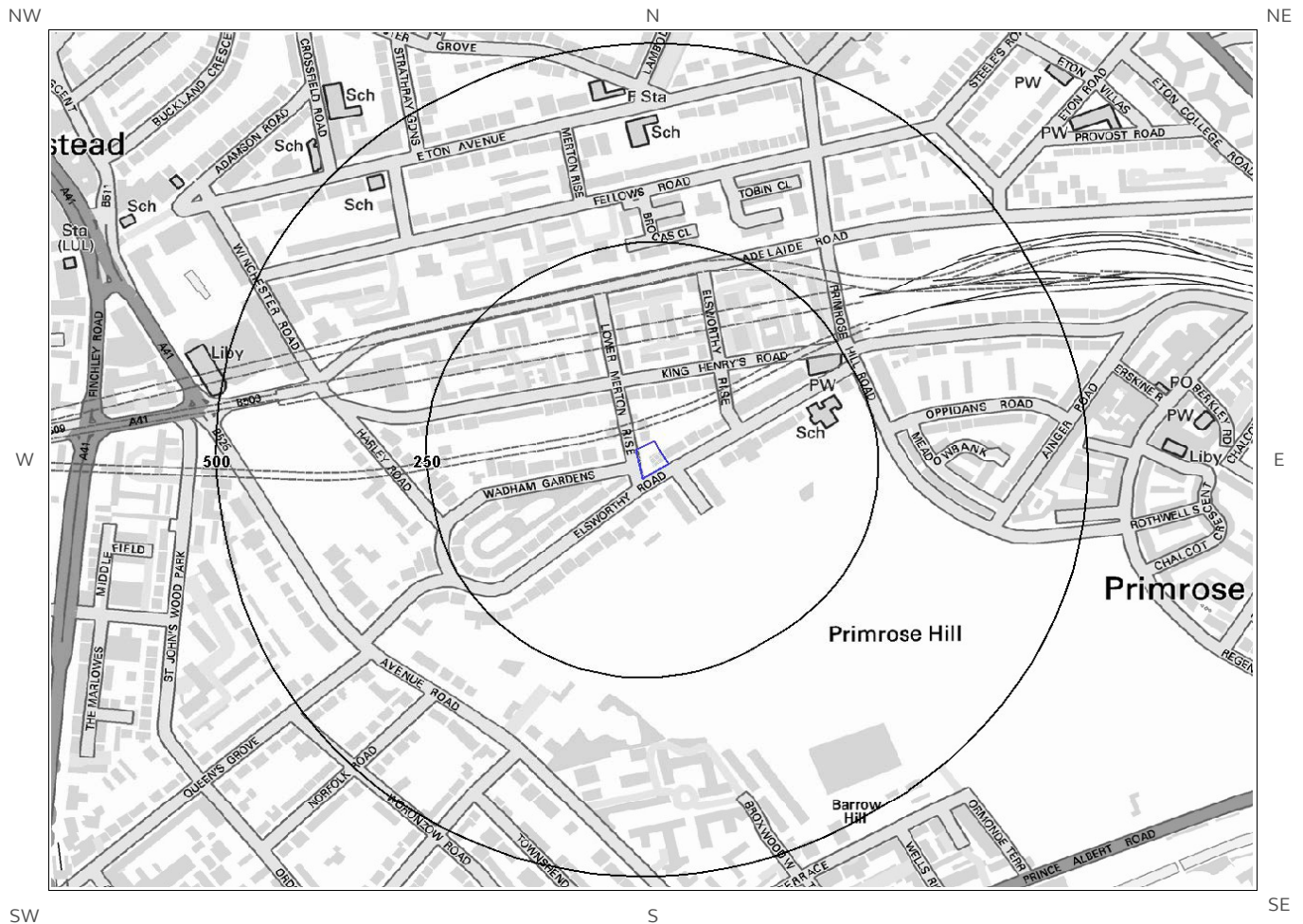

© Crown copyright and database rights 2017.
Ordnance Survey license 100035207.

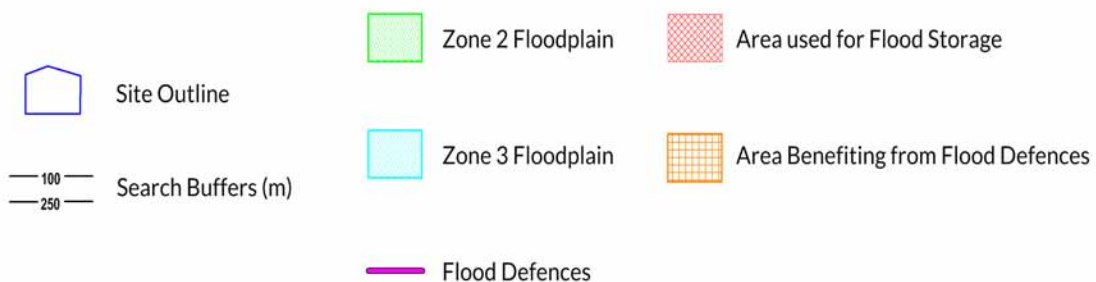

7b. Environment Agency/Natural Resources Wales Risk of Flooding from Rivers and the Sea (RoFRaS) Map

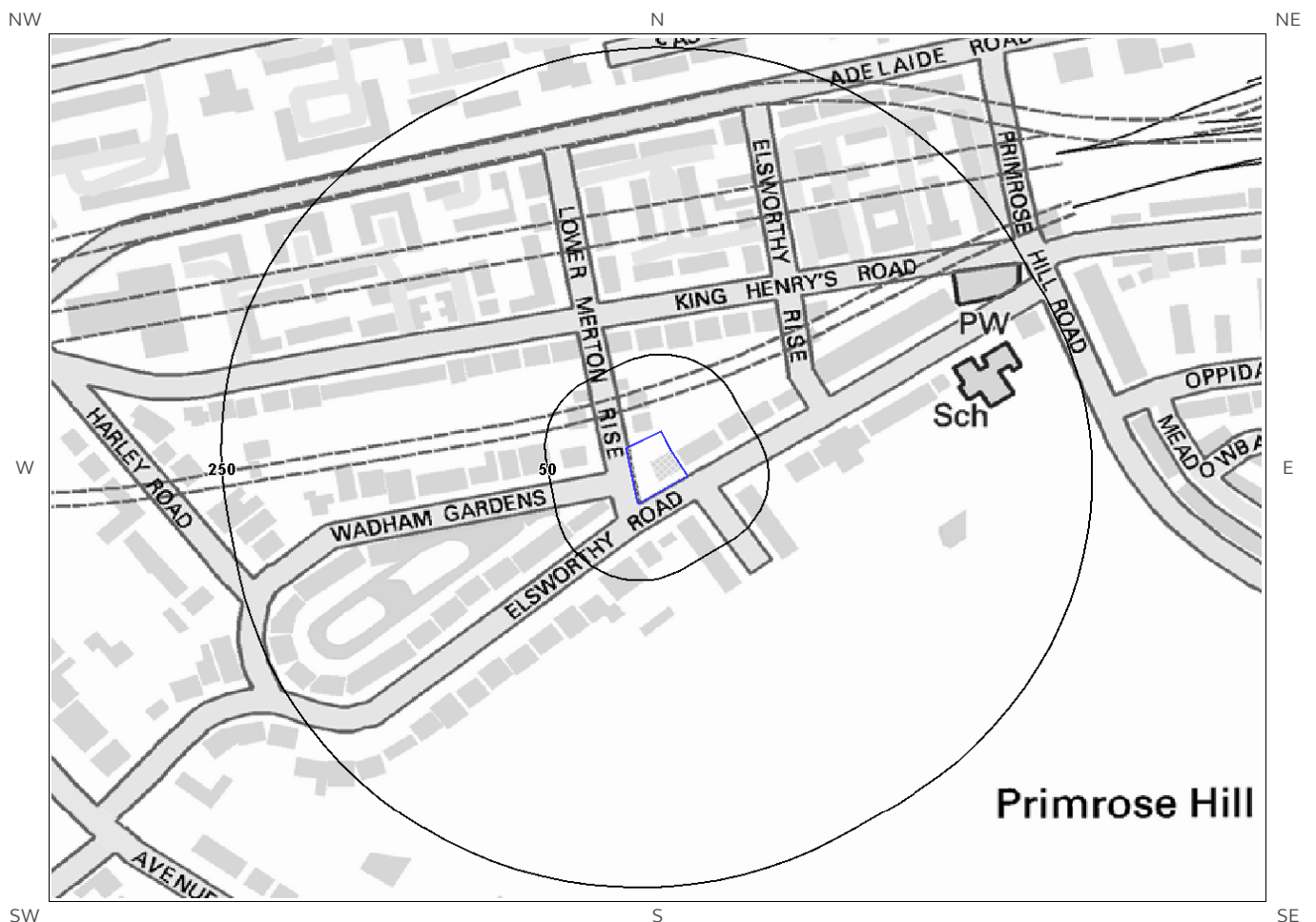

© Crown copyright and database rights 2017.
Ordnance Survey license 100035207.

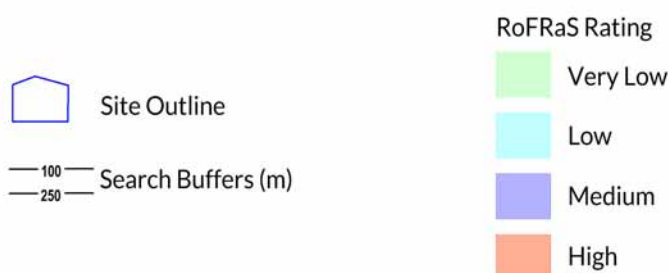

7 Flooding

7.1 River and Coastal Zone 2 Flooding

Is the site within 250m of an Environment Agency/Natural Resources Wales Zone 2 floodplain? No

Environment Agency/Natural Resources Wales Zone 2 floodplains estimate the annual probability of flooding as between 1 in 1000 (0.1%) and 1 in 100 (1%) from rivers and between 1 in 1000 (0.1%) and 1 in 200 (0.5%) from the sea. Any relevant data is represented on Map 7a – Flood Map for Planning:

Database searched and no data found.

7.2 River and Coastal Zone 3 Flooding

Is the site within 250m of an Environment Agency/Natural Resources Wales Zone 3 floodplain? No

Zone 3 shows the extent of a river flood with a 1 in 100 (1%) or greater chance of occurring in any year or a sea flood with a 1 in 200 (0.5%) or greater chance of occurring in any year. Any relevant data is represented on Map 7a – Flood Map for Planning.

Database searched and no data found.

7.3 Risk of Flooding from Rivers and the Sea (RoFRaS) Flood Rating

What is the highest risk of flooding onsite? Very Low

The Environment Agency/Natural Resources Wales RoFRaS database provides an indication of river and coastal flood risk at a national level on a 50m grid with the flood rating at the centre of the grid calculated and given above. The data considers the probability that the flood defences will overtop or breach by considering their location, type, condition and standard of protection.

RoFRaS data for the study site indicates the property is in an area with a Very Low (less than 1 in 1000) chance of flooding in any given year.

7.4 Flood Defences

Are there any Flood Defences within 250m of the study site? No
Database searched and no data found.

7.5 Areas benefiting from Flood Defences

Are there any areas benefiting from Flood Defences within 250m of the study site? No

7.6 Areas benefiting from Flood Storage

Are there any areas used for Flood Storage within 250m of the study site?

No

7.7 Groundwater Flooding Susceptibility Areas

7.7.1 Are there any British Geological Survey groundwater flooding susceptibility areas within 50m of the boundary of the study site? No

Notes: Groundwater flooding may either be associated with shallow unconsolidated sedimentary aquifers which overlie unproductive aquifers (Superficial Deposits Flooding), or with unconfined aquifers (Clearwater Flooding).

7.7.2 What is the highest susceptibility to groundwater flooding in the search area based on the underlying geological conditions?

Not Prone

The area is not considered to be prone to groundwater flooding based on rock type.

7.8 Groundwater Flooding Confidence Areas

What is the British Geological Survey confidence rating in this result?

Not Applicable

Notes: Groundwater flooding is defined as the emergence of groundwater at the ground surface or the rising of groundwater into man-made ground under conditions where the normal range of groundwater levels is exceeded.

The confidence rating is on a threefold scale - Low, Moderate and High. This provides a relative indication of the BGS confidence in the accuracy of the susceptibility result for groundwater flooding. This is based on the amount and precision of the information used in the assessment. In areas with a relatively lower level of confidence the susceptibility result should be treated with more caution. In other areas with higher levels of confidence the susceptibility result can be used with more confidence.

8. Designated Environmentally Sensitive Sites Map

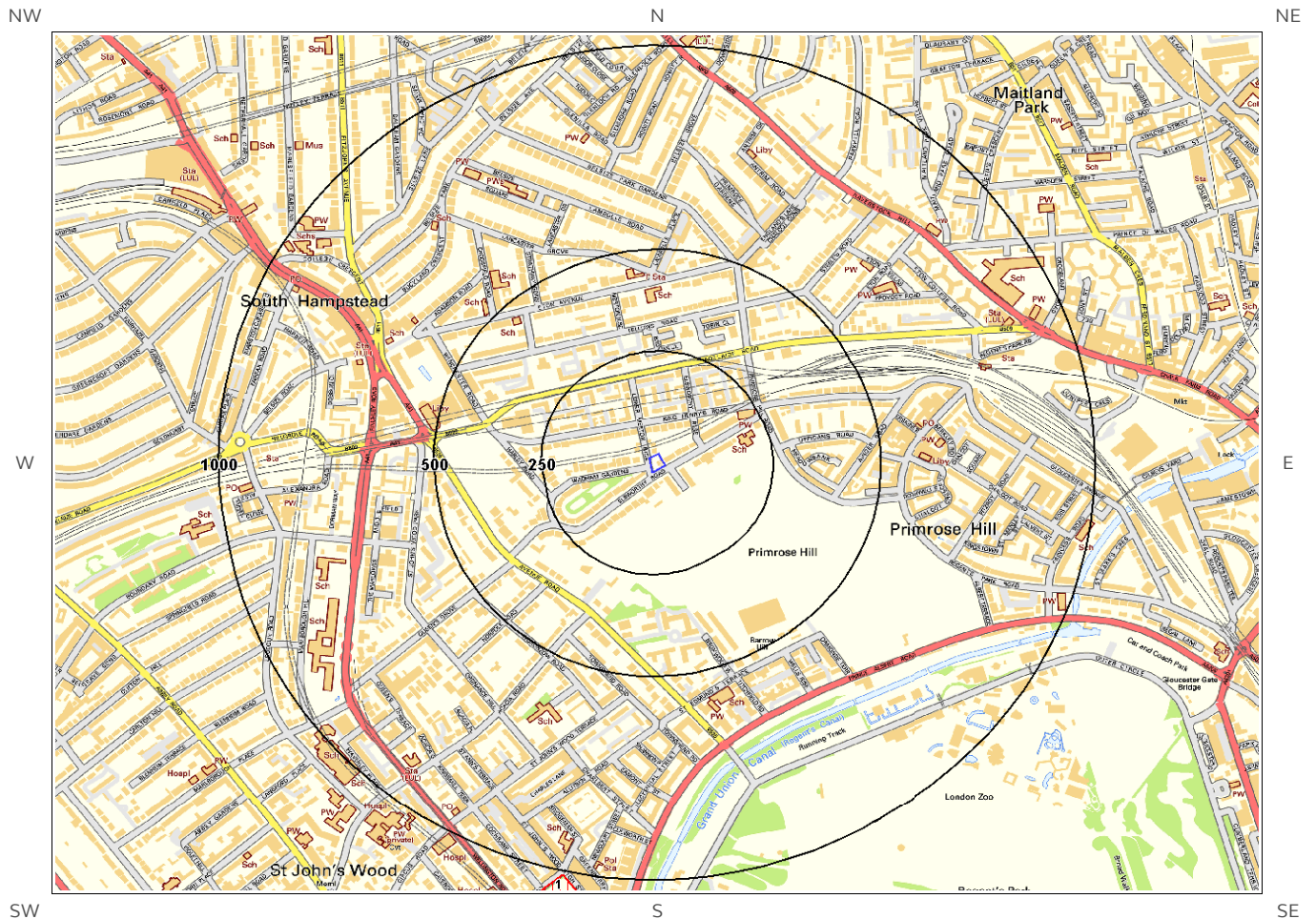

© Crown copyright and database rights 2017.
Ordnance Survey license 100035207.



8. Designated Environmentally Sensitive Sites

Presence of Designated Environmentally Sensitive Sites within 2000m of the study site?

Yes

8.1 Records of Sites of Special Scientific Interest (SSSI) within 2000m of the study site:

0

Database searched and no data found.

8.2 Records of National Nature Reserves (NNR) within 2000m of the study site:

0

Database searched and no data found.

8.3 Records of Special Areas of Conservation (SAC) within 2000m of the study site:

0

Database searched and no data found.

8.4 Records of Special Protection Areas (SPA) within 2000m of the study site:

0

Database searched and no data found.

8.5 Records of Ramsar sites within 2000m of the study site:

0

Database searched and no data found.

8.6 Records of Ancient Woodland within 2000m of the study site:

0

Database searched and no data found.

8.7 Records of Local Nature Reserves (LNR) within 2000m of the study site:

2

The following Local Nature Reserve (LNR) records provided by Natural England/Natural Resources Wales are represented as polygons on the Designated Environmentally Sensitive Sites Map:

ID	Distance (m)	Direction	LNR Name	Data Source
1	1009	S	St John's Wood Church Grounds	Natural England
Not shown	1137	N	Belsize Wood	Natural England

8.8 Records of World Heritage Sites within 2000m of the study site:

0

Database searched and no data found.

8.9 Records of Environmentally Sensitive Areas within 2000m of the study site:

0

Database searched and no data found.

8.10 Records of Areas of Outstanding Natural Beauty (AONB) within 2000m of the study site:

0

Database searched and no data found.

8.11 Records of National Parks (NP) within 2000m of the study site:

0

Database searched and no data found.

8.12 Records of Nitrate Sensitive Areas within 2000m of the study site:

0

Database searched and no data found.

8.13 Records of Nitrate Vulnerable Zones within 2000m of the study site:

0

Database searched and no data found.

8.14 Records of Green Belt land within 2000m of the study site:

0

Database searched and no data found.

9. Natural Hazards Findings

9.1 Detailed BGS GeoSure Data

BGS GeoSure Data has been searched to 50m. The data is included in tabular format. If you require further information on geology and ground stability, please obtain a **Groundsure Geo Insight**, available from our [website](#). The following information has been found:

9.1.1 Shrink Swell

What is the maximum Shrink-Swell* hazard rating identified on the study site? Moderate

The following natural subsidence information provided by the British Geological Survey is not represented on mapping:

Hazard
Ground conditions predominantly high plasticity. Do not plant or remove trees or shrubs near to buildings without expert advice about their effect and management. For new build, consideration should be given to advice published by the National House Building Council (NHBC) and the Building Research Establishment (BRE). There is a probable increase in construction cost to reduce potential shrink-swell problems. For existing property, there is a probable increase in insurance risk during droughts or where vegetation with high moisture demands is present.

9.1.2 Landslides

What is the maximum Landslide* hazard rating identified on the study site? Very Low

The following natural subsidence information provided by the British Geological Survey is not represented on mapping:

Hazard
Slope instability problems are unlikely to be present. No special actions required to avoid problems due to landslides. No special ground investigation required, and increased construction costs or increased financial risks are unlikely due to potential problems with landslides.

9.1.3 Soluble Rocks

What is the maximum Soluble Rocks* hazard rating identified on the study site? Negligible

The following natural subsidence information provided by the British Geological Survey is not represented on mapping:

Hazard
Soluble rocks are present, but unlikely to cause problems except under exceptional conditions. No special actions required to avoid problems due to soluble rocks. No special ground investigation required, and increased construction costs or increased financial risks are unlikely due to potential problems with soluble rocks.

* This indicates an automatically generated 50m buffer and site.

9.1.4 Compressible Ground

What is the maximum Compressible Ground* hazard rating identified on the study site? Negligible

The following natural subsidence information provided by the British Geological Survey is not represented on mapping:

Hazard
No indicators for compressible deposits identified. No special actions required to avoid problems due to compressible deposits. No special ground investigation required, and increased construction costs or increased financial risks are unlikely due to potential problems with compressible deposits.

9.1.5 Collapsible Rocks

What is the maximum Collapsible Rocks* hazard rating identified on the study site? Very Low

The following natural subsidence information provided by the British Geological Survey is not represented on mapping:

Hazard
Deposits with potential to collapse when loaded and saturated are unlikely to be present. No special ground investigation required or increased construction costs or increased financial risk due to potential problems with collapsible deposits.

9.1.6 Running Sand

What is the maximum Running Sand** hazard rating identified on the study site? Negligible

The following natural subsidence information provided by the British Geological Survey is not represented on mapping:

Hazard
No indicators for running sand identified. No special actions required to avoid problems due to running sand. No special ground investigation required, and increased construction costs or increased financial risks are unlikely due to potential problems with running sand.

9.2 Radon

9.2.1 Radon Affected Areas

Is the property in a Radon Affected Area as defined by the Health Protection Agency (HPA) and if so what percentage of homes are above the Action Level? The property is not in a Radon Affected Area, as less than 1% of properties are above the Action Level.

* This indicates an automatically generated 50m buffer and site.

9.2.2 Radon Protection

Is the property in an area where Radon Protection are required for new properties or extensions to existing

ones as described in publication BR211 by the Building Research Establishment?

No radon protective measures are necessary.

10. Mining

10.1 Coal Mining

Are there any coal mining areas within 75m of the study site? No

Database searched and no data found.

10.2 Non-Coal Mining

Are there any Non-Coal Mining areas within 50m of the study site boundary? No

Database searched and no data found.

10.3 Brine Affected Areas

Are there any brine affected areas within 75m of the study site? No

Guidance: No Guidance Required.

Contact Details

Groundsure Helpline
Telephone: 08444 159 000
info@groundsure.com

British Geological Survey Enquiries

Kingsley Dunham Centre
Keyworth, Nottingham NG12 5GG
Tel: 0115 936 3143.
Fax: 0115 936 3276.
Email:

Web: www.bgs.ac.uk

BGS Geological Hazards Reports and general geological enquiries:
enquiries@bgs.ac.uk

Environment Agency

National Customer Contact Centre, PO Box 544
Rotherham, S60 1BY
Tel: 03708 506 506

Web: www.environment-agency.gov.uk

Email: enquiries@environment-agency.gov.uk

Public Health England

Public information access office
Public Health England, Wellington House
133-155 Waterloo Road, London, SE1 8UG
www.gov.uk/phe

Email: enquiries@phe.gov.uk
Main switchboard: 020 7654 8000

The Coal Authority

200 Lichfield Lane
Mansfield
Notts NG18 4RG
Tel: 0345 7626 848
DX 716176 Mansfield 5
www.coal.gov.uk

Ordnance Survey

Adanac Drive, Southampton
SO16 0AS
Tel: 08456 050505

Local Authority

Authority: London Borough of Camden
Phone: 020 7974 4444
Web: <http://www.camden.gov.uk/>
Address: Camden Town Hall, Judd Street, London, WC1H 9JE

Gemapping PLC

Virginia Villas, High Street, Hartley Witney,
Hampshire RG27 8NW
Tel: 01252 845444



Acknowledgements: Site of Special Scientific Interest, National Nature Reserve, Ramsar Site, Special Protection Area, Special Area of Conservation data is provided by, and used with the permission of, Natural England who retain the Copyright and Intellectual Property Rights for the data.

PointX © Database Right/Copyright, Thomson Directories Limited © Copyright Link Interchange Network Limited © Database Right/Copyright and Ordnance Survey © Crown Copyright and/or Database Right. All Rights Reserved. Licence Number [03421028].

This report has been prepared in accordance with the Groundsure Ltd standard Terms and Conditions of business for work of this nature.

Standard Terms and Conditions

Groundsure's Terms and Conditions can be viewed online at this link:
<https://www.groundsure.com/terms-and-conditions-sept-2016>



APPENDIX C

STATUTORY UTILITY PLANS

Create Consulting Engineers Ltd
15 Princes Street
NORWICH
NR3 1AF

Search address supplied 42
Elsworthy Road
London
NW3 3DL

Your reference P17-1308

Our reference ALS/ALS Standard/2017_3599751

Search date 28 June 2017

Notification of Price Changes...

From **1 September 2016** Thames Water Property Searches will be increasing the prices of its Asset Location Searches. This will be the first price rise in three years and is in line with the RPI at 1.84%. The increase follows significant capital investment in improving our systems and infrastructure.

Enquiries received with a higher payment prior to 1 September 2016 will be non-refundable. For further details on the price increase please visit our website at

www.thameswater-propertysearches.co.uk



Thames Water Utilities Ltd
Property Searches, PO Box 3189, Slough SL1 4WW
DX 151280 Slough 13



searches@thameswater.co.uk
www.thameswater-propertysearches.co.uk



0845 070 9148



Search address supplied: 42, Elsworthy Road, London, NW3 3DL

Dear Sir / Madam

An Asset Location Search is recommended when undertaking a site development. It is essential to obtain information on the size and location of clean water and sewerage assets to safeguard against expensive damage and allow cost-effective service design.

The following records were searched in compiling this report: - the map of public sewers & the map of waterworks. Thames Water Utilities Ltd (TWUL) holds all of these.

This search provides maps showing the position, size of Thames Water assets close to the proposed development and also manhole cover and invert levels, where available.

Please note that none of the charges made for this report relate to the provision of Ordnance Survey mapping information. The replies contained in this letter are given following inspection of the public service records available to this company. No responsibility can be accepted for any error or omission in the replies.

You should be aware that the information contained on these plans is current only on the day that the plans are issued. The plans should only be used for the duration of the work that is being carried out at the present time. Under no circumstances should this data be copied or transmitted to parties other than those for whom the current work is being carried out.

Thames Water do update these service plans on a regular basis and failure to observe the above conditions could lead to damage arising to new or diverted services at a later date.

Contact Us

If you have any further queries regarding this enquiry please feel free to contact a member of the team on 0845 070 9148, or use the address below:

Thames Water Utilities Ltd
Property Searches
PO Box 3189
Slough
SL1 4WW

Email: searches@thameswater.co.uk
Web: www.thameswater-propertysearches.co.uk

Waste Water Services

Please provide a copy extract from the public sewer map.

Enclosed is a map showing the approximate lines of our sewers. Our plans do not show sewer connections from individual properties or any sewers not owned by Thames Water unless specifically annotated otherwise. Records such as "private" pipework are in some cases available from the Building Control Department of the relevant Local Authority.

Where the Local Authority does not hold such plans it might be advisable to consult the property deeds for the site or contact neighbouring landowners.

This report relates only to sewerage apparatus of Thames Water Utilities Ltd, it does not disclose details of cables and or communications equipment that may be running through or around such apparatus.

The sewer level information contained in this response represents all of the level data available in our existing records. Should you require any further Information, please refer to the relevant section within the 'Further Contacts' page found later in this document.

For your guidance:

- The Company is not generally responsible for rivers, watercourses, ponds, culverts or highway drains. If any of these are shown on the copy extract they are shown for information only.
- Any private sewers or lateral drains which are indicated on the extract of the public sewer map as being subject to an agreement under Section 104 of the Water Industry Act 1991 are not an 'as constructed' record. It is recommended these details be checked with the developer.

Clean Water Services

Please provide a copy extract from the public water main map.

Enclosed is a map showing the approximate positions of our water mains and associated apparatus. Please note that records are not kept of the positions of individual domestic supplies.

For your information, there will be a pressure of at least 10m head at the outside stop valve. If you would like to know the static pressure, please contact our Customer Centre on 0800 316 9800. The Customer Centre can also arrange for a full flow and pressure test to be carried out for a fee.

Asset location search



Property Searches

For your guidance:

- Assets other than vested water mains may be shown on the plan, for information only.
- If an extract of the public water main record is enclosed, this will show known public water mains in the vicinity of the property. It should be possible to estimate the likely length and route of any private water supply pipe connecting the property to the public water network.

Payment for this Search

A charge will be added to your suppliers account.

Further contacts:

Waste Water queries

Should you require verification of the invert levels of public sewers, by site measurement, you will need to approach the relevant Thames Water Area Network Office for permission to lift the appropriate covers. This permission will usually involve you completing a TWOSA form. For further information please contact our Customer Centre on Tel: 0845 920 0800. Alternatively, a survey can be arranged, for a fee, through our Customer Centre on the above number.

If you have any questions regarding sewer connections, budget estimates, diversions, building over issues or any other questions regarding operational issues please direct them to our service desk. Which can be contacted by writing to:

Developer Services (Waste Water)
Thames Water
Clearwater Court
Vastern Road
Reading
RG1 8DB

Tel: 0845 850 2777
Email: developer.services@thameswater.co.uk

Clean Water queries

Should you require any advice concerning clean water operational issues or clean water connections, please contact:

Developer Services (Clean Water)
Thames Water
Clearwater Court
Vastern Road
Reading
RG1 8DB

Tel: 0845 850 2777
Email: developer.services@thameswater.co.uk

NB. Levels quoted in metres Ordnance Newlyn Datum. The value -9999.00 indicates that no survey information is available

Manhole Reference	Manhole Cover Level	Manhole Invert Level
21CG	n/a	n/a
21CH	n/a	n/a
21CI	n/a	n/a
21CJ	n/a	n/a
21DA	n/a	n/a
21DB	n/a	n/a
2102	49.29	45.91
2103	n/a	n/a
n/a	n/a	n/a
n/a	n/a	n/a
2903	46.26	43.11
29AI	n/a	n/a
29BJ	n/a	n/a
20BH	n/a	n/a
20BC	n/a	n/a
29BI	n/a	n/a
29BA	n/a	n/a
20AI	n/a	n/a
29BH	n/a	n/a
20BB	n/a	n/a
20BA	n/a	n/a
29BG	n/a	n/a
20AJ	n/a	n/a
2002	47.08	44.03
39AD	n/a	n/a
3002	n/a	n/a
3001	49.54	46.77
2003	46.97	44.15
The position of the apparatus shown on this plan is given without obligation and warranty, and the accuracy cannot be guaranteed. Service pipes are not shown but their presence should be anticipated. No liability of any kind whatsoever is accepted by Thames Water for any error or omission. The actual position of mains and services must be verified and established on site before any works are undertaken.		



ALS Sewer Map Key

Public Sewer Types (Operated & Maintained by Thames Water)

	Foul: A sewer designed to convey waste water from domestic and industrial sources to a treatment works.
	Surface Water: A sewer designed to convey surface water (e.g. rain water from roofs, yards and car parks) to rivers or watercourses.
	Combined: A sewer designed to convey both waste water and surface water from domestic and industrial sources to a treatment works.
	Trunk Surface Water
	Trunk Foul
	Storm Relief
	Trunk Combined
	Vent Pipe
	Bio-solids (Sludge)
	Proposed Thames Surface Water Sewer
	Proposed Thames Water Foul Sewer
	Gallery
	Foul Rising Main
	Surface Water Rising Main
	Combined Rising Main
	Sludge Rising Main
	Proposed Thames Water Rising Main
	Vacuum

Notes:

- 1) All levels associated with the plans are to Ordnance Datum Newlyn.
- 2) All measurements on the plans are metric.
- 3) Arrows (on gravity fed sewers) or flecks (on rising mains) indicate direction of flow.
- 4) Most private pipes are not shown on our plans, as in the past, this information has not been recorded.
- 5) 'na' or '0' on a manhole level indicates that data is unavailable.

Sewer Fittings

A feature in a sewer that does not affect the flow in the pipe. Example: a vent is a fitting as the function of a vent is to release excess gas.

	Air Valve
	Dam Chase
	Fitting
	Meter
	Vent Column

Operational Controls

A feature in a sewer that changes or diverts the flow in the sewer. Example: A hydrobrake limits the flow passing downstream.

	Control Valve
	Drop Pipe
	Ancillary
	Weir

End Items

End symbols appear at the start or end of a sewer pipe. Examples: an Undefined End at the start of a sewer indicates that Thames Water has no knowledge of the position of the sewer upstream of that symbol, Outfall on a surface water sewer indicates that the pipe discharges into a stream or river.

	Outfall
	Undefined End
	Inlet

Other Symbols

Symbols used on maps which do not fall under other general categories

	Public/Private Pumping Station
	Change of characteristic indicator (C.O.C.I.)
	Invert Level
	Summit

Areas

Lines denoting areas of underground surveys, etc.

	Agreement
	Operational Site
	Chamber
	Tunnel
	Conduit Bridge

Other Sewer Types (Not Operated or Maintained by Thames Water)

	Foul Sewer
	Surface Water Sewer
	Combined Sewer
	Gully
	Culverted Watercourse
	Proposed
	Abandoned Sewer

- 6) The text appearing alongside a sewer line indicates the internal diameter of the pipe in millimetres. Text next to a manhole indicates the manhole reference number and should not be taken as a measurement. If you are unsure about any text or symbology present on the plan, please contact a member of Property Insight on 0845 070 9148.

The width of the displayed area is 200 m and the centre of the map is located at OS coordinates 527309, 184068.

The position of the apparatus shown on this plan is given without obligation and warranty, and the accuracy cannot be guaranteed. Service pipes are not shown but their presence should be anticipated. No liability of any kind whatsoever is accepted by Thames Water for any error or omission. The actual position of mains and services must be verified and established on site before any works are undertaken.

[Thames Water Utilities Ltd](#), Property Searches, PO Box 3189, Slough SL1 4W, DX 151280 Slough 13
T 0845 070 9148 E searches@thameswater.co.uk | www.thameswater-propertysearches.co.uk



ALS Water Map Key

Water Pipes (Operated & Maintained by Thames Water)

- 4"** **Distribution Main:** The most common pipe shown on water maps. With few exceptions, domestic connections are only made to distribution mains.
- 16"** **Trunk Main:** A main carrying water from a source of supply to a treatment plant or reservoir, or from one treatment plant or reservoir to another. Also a main transferring water in bulk to smaller water mains used for supplying individual customers.
- 3" SUPPLY** **Supply Main:** A supply main indicates that the water main is used as a supply for a single property or group of properties.
- 3" FIRE** **Fire Main:** Where a pipe is used as a fire supply, the word FIRE will be displayed along the pipe.
- 3" METERED** **Metered Pipe:** A metered main indicates that the pipe in question supplies water for a single property or group of properties and that quantity of water passing through the pipe is metered even though there may be no meter symbol shown.
- Transmission Tunnel:** A very large diameter water pipe. Most tunnels are buried very deep underground. These pipes are not expected to affect the structural integrity of buildings shown on the map provided.
- Proposed Main:** A main that is still in the planning stages or in the process of being laid. More details of the proposed main and its reference number are generally included near the main.

PIPE DIAMETER	DEPTH BELOW GROUND
Up to 300mm (12")	900mm (3')
300mm - 600mm (12" - 24")	1100mm (3' 8")
600mm and bigger (24" plus)	1200mm (4')

Valves

- General Purpose Valve
- Air Valve
- Pressure Control Valve
- Customer Valve

Hydrants

- Single Hydrant

Meters

- Meter

End Items

Symbol indicating what happens at the end of a water main.

- Blank Flange
- Capped End
- Emptying Pit
- Undefined End
- Manifold
- Customer Supply
- Fire Supply

Operational Sites

- Booster Station
- Other
- Other (Proposed)
- Pumping Station
- Service Reservoir
- Shaft Inspection
- Treatment Works
- Unknown
- Water Tower

Other Symbols

- Data Logger

Other Water Pipes (Not Operated or Maintained by Thames Water)

- Other Water Company Main:** Occasionally other water company water pipes may overlap the border of our clean water coverage area. These mains are denoted in purple and in most cases have the owner of the pipe displayed along them.
- Private Main:** Indicates that the water main in question is not owned by Thames Water. These mains normally have text associated with them indicating the diameter and owner of the pipe.

Terms and Conditions

All sales are made in accordance with Thames Water Utilities Limited (TWUL) standard terms and conditions unless previously agreed in writing.

1. All goods remain in the property of Thames Water Utilities Ltd until full payment is received.
2. Provision of service will be in accordance with all legal requirements and published TWUL policies.
3. All invoices are strictly due for payment 14 days from due date of the invoice. Any other terms must be accepted/agreed in writing prior to provision of goods or service, or will be held to be invalid.
4. Thames Water does not accept post-dated cheques-any cheques received will be processed for payment on date of receipt.
5. In case of dispute TWUL's terms and conditions shall apply.
6. Penalty interest may be invoked by TWUL in the event of unjustifiable payment delay. Interest charges will be in line with UK Statute Law 'The Late Payment of Commercial Debts (Interest) Act 1998'.
7. Interest will be charged in line with current Court Interest Charges, if legal action is taken.
8. A charge may be made at the discretion of the company for increased administration costs.

A copy of Thames Water's standard terms and conditions are available from the Commercial Billing Team (cashoperations@thameswater.co.uk).

We publish several Codes of Practice including a guaranteed standards scheme. You can obtain copies of these leaflets by calling us on 0800 316 9800

If you are unhappy with our service you can speak to your original goods or customer service provider. If you are not satisfied with the response, your complaint will be reviewed by the Customer Services Director. You can write to him at: Thames Water Utilities Ltd. PO Box 492, Swindon, SN38 8TU.

If the Goods or Services covered by this invoice falls under the regulation of the 1991 Water Industry Act, and you remain dissatisfied you can refer your complaint to Consumer Council for Water on 0121 345 1000 or write to them at Consumer Council for Water, 1st Floor, Victoria Square House, Victoria Square, Birmingham, B2 4AJ.

Ways to pay your bill

Credit Card	BACS Payment	Telephone Banking	Cheque
Call 0845 070 9148 quoting your invoice number starting CBA or ADS.	Account number 90478703 Sort code 60-00-01 A remittance advice must be sent to: Thames Water Utilities Ltd., PO Box 3189, Slough SL1 4WW. or email ps.billing@thameswater.co.uk	By calling your bank and quoting: Account number 90478703 Sort code 60-00-01 and your invoice number	Made payable to ' Thames Water Utilities Ltd ' Write your Thames Water account number on the back. Send to: Thames Water Utilities Ltd., PO Box 3189, Slough SL1 4WW or by DX to 151280 Slough 13

Thames Water Utilities Ltd Registered in England & Wales No. 2366661 Registered Office Clearwater Court, Vastern Rd, Reading, Berks, RG1 8DB.



Search Code

IMPORTANT CONSUMER PROTECTION INFORMATION

This search has been produced by Thames Water Property Searches, Clearwater Court, Vastern Road, Reading RG1 8DB, which is registered with the Property Codes Compliance Board (PCCB) as a subscriber to the Search Code. The PCCB independently monitors how registered search firms maintain compliance with the Code.

The Search Code:

- provides protection for homebuyers, sellers, estate agents, conveyancers and mortgage lenders who rely on the information included in property search reports undertaken by subscribers on residential and commercial property within the United Kingdom
- sets out minimum standards which firms compiling and selling search reports have to meet
- promotes the best practise and quality standards within the industry for the benefit of consumers and property professionals
- enables consumers and property professionals to have confidence in firms which subscribe to the code, their products and services.

By giving you this information, the search firm is confirming that they keep to the principles of the Code. This provides important protection for you.

The Code's core principles

Firms which subscribe to the Search Code will:

- display the Search Code logo prominently on their search reports
- act with integrity and carry out work with due skill, care and diligence
- at all times maintain adequate and appropriate insurance to protect consumers
- conduct business in an honest, fair and professional manner
- handle complaints speedily and fairly
- ensure that products and services comply with industry registration rules and standards and relevant laws
- monitor their compliance with the Code

Complaints

If you have a query or complaint about your search, you should raise it directly with the search firm, and if appropriate ask for any complaint to be considered under their formal internal complaints procedure. If you remain dissatisfied with the firm's final response, after your complaint has been formally considered, or if the firm has exceeded the response timescales, you may refer your complaint for consideration under The Property Ombudsman scheme (TPOs). The Ombudsman can award compensation of up to £5,000 to you if he finds that you have suffered actual loss as a result of your search provider failing to keep to the Code.

Please note that all queries or complaints regarding your search should be directed to your search provider in the first instance, not to TPOs or to the PCCB.

TPOs Contact Details

The Property Ombudsman scheme
Milford House
43-55 Milford Street
Salisbury
Wiltshire SP1 2BP
Tel: 01722 333306
Fax: 01722 332296
Email: admin@tpos.co.uk

You can get more information about the PCCB from www.propertycodes.org.uk

PLEASE ASK YOUR SEARCH PROVIDER IF YOU WOULD LIKE A COPY OF THE SEARCH CODE

Create Consulting Engineers Ltd

Princes Street

Search address supplied 42
Elsworthy Road
London
NW3 3DL

Your reference P17-1308

Our reference SFH/SFH Standard/2017_3599750

Received date 28 June 2017

Search date 28 June 2017



Thames Water Utilities Ltd
Property Searches, PO Box 3189, Slough SL1 4WW
DX 151280 Slough 13



searches@thameswater.co.uk
www.thameswater-propertysearches.co.uk



0845 070 9148

Search address supplied: 42, Elsworthy Road, London, NW3 3DL

This search is recommended to check for any sewer flooding in a specific address or area

TWUL, trading as Property Searches, are responsible in respect of the following:-

- (i) any negligent or incorrect entry in the records searched;
- (ii) any negligent or incorrect interpretation of the records searched;
- (iii) and any negligent or incorrect recording of that interpretation in the search report
- (iv) compensation payments



Thames Water Utilities Ltd
Property Searches, PO Box 3189, Slough SL1 4WW
DX 151280 Slough 13



searches@thameswater.co.uk
www.thameswater-propertysearches.co.uk



0845 070 9148

History of Sewer Flooding

Is the requested address or area at risk of flooding due to overloaded public sewers?

The flooding records held by Thames Water indicate that there have been no incidents of flooding in the requested area as a result of surcharging public sewers.

For your guidance:

- A sewer is “overloaded” when the flow from a storm is unable to pass through it due to a permanent problem (e.g. flat gradient, small diameter). Flooding as a result of temporary problems such as blockages, siltation, collapses and equipment or operational failures are excluded.
- “Internal flooding” from public sewers is defined as flooding, which enters a building or passes below a suspended floor. For reporting purposes, buildings are restricted to those normally occupied and used for residential, public, commercial, business or industrial purposes.
- “At Risk” properties are those that the water company is required to include in the Regulatory Register that is presented annually to the Director General of Water Services. These are defined as properties that have suffered, or are likely to suffer, internal flooding from public foul, combined or surface water sewers due to overloading of the sewerage system more frequently than the relevant reference period (either once or twice in ten years) as determined by the Company’s reporting procedure.
- Flooding as a result of storm events proven to be exceptional and beyond the reference period of one in ten years are not included on the At Risk Register.
- Properties may be at risk of flooding but not included on the Register where flooding incidents have not been reported to the Company.
- Public Sewers are defined as those for which the Company holds statutory responsibility under the Water Industry Act 1991.
- It should be noted that flooding can occur from private sewers and drains which are not the responsibility of the Company. This report excludes flooding from private sewers and drains and the Company makes no comment upon this matter.
- For further information please contact Thames Water on Tel: 0800 316 9800 or website www.thameswater.co.uk



Thames Water Utilities Ltd
Property Searches, PO Box 3189, Slough SL1 4WW
DX 151280 Slough 13



searches@thameswater.co.uk
www.thameswater-propertysearches.co.uk

Aidan Fisher
Create Consulting Engineers
15
Princes Street
Norwich
Norwich
Norfolk
NR3 1AF

Plant Protection
Cadent
Block 1; Floor 1
Brick Kiln Street
Hinckley
LE10 0NA
E-mail: plantprotection@cadentgas.com
Telephone: +44 (0)800 688588

National Gas Emergency Number:
0800 111 999*

National Grid Electricity Emergency Number:
0800 40 40 90*

* Available 24 hours, 7 days/week.
Calls may be recorded and monitored.

www.cadentgas.com

Date: 27/06/2017
Our Ref: NL_TE_Z5_3SWX_340745
Your Ref: 42 Elsworthy Road
RE: Proposed Works, 42 ELSORTHY ROAD, LONDON,

Thank you for your enquiry which was received on 27/06/2017.
Please note this response and any attached map(s) are valid for 28 days.

An assessment has been carried out with respect to Cadent Gas Ltd, National Grid Electricity Transmission plc's and National Grid Gas plc's apparatus. Please note it does not cover the items listed in the section "Your Responsibilities and Obligations", including gas service pipes and related apparatus.
For details of Network areas please see the Cadent website (<http://cadentgas.com/Digging-safely/Dial-before-you-dig>) or the enclosed documentation.

As your works are at a "proposed" stage, any maps and guidance provided are for information purposes only. This is not approval to commence work. You must submit a "Scheduled Works" enquiry at the earliest opportunity and failure to do this may lead to disruption to your plans and works. Plant Protection will endeavour to provide an initial assessment within 14 days of receipt of a Scheduled Works enquiry and dependent on the outcome of this, further consultation may be required.

In any event, for safety and legal reasons, works must not be carried out until a Scheduled Works enquiry has been completed and final response received.

Your Responsibilities and Obligations

The "Assessment" Section below outlines the detailed requirements that must be followed when planning or undertaking your scheduled activities at this location.

It is your responsibility to ensure that the information you have submitted is accurate and that all relevant documents including links are provided to all persons (either direct labour or contractors) working for you near Cadent and/or National Grid's apparatus, e.g. as contained within the Construction (Design and Management) Regulations.

This assessment solely relates to Cadent Gas Ltd, National Grid Electricity Transmission plc (NGET) and National Grid Gas plc (NGG) and apparatus. This assessment does **NOT** include:

- Cadent and/or National Grid's legal interest (easements or wayleaves) in the land which restricts activity in proximity to Cadent and/or National Grid's assets in private land. You must obtain details of any such restrictions from the landowner in the first instance and if in doubt contact Plant Protection.
- Gas service pipes and related apparatus
- Recently installed apparatus
- Apparatus owned by other organisations, e.g. other gas distribution operators, local electricity companies, other utilities, etc.

It is **YOUR** responsibility to take into account whether the items listed above may be present and if they could be affected by your proposed activities. Further "Essential Guidance" in respect of these items can be found on the National Grid Website (<http://www2.nationalgrid.com/WorkArea/DownloadAsset.aspx?id=8589934982>).

This communication does not constitute any formal agreement or consent for any proposed development work; either generally or with regard to Cadent and/or National Grid's easements or wayleaves nor any planning or building regulations applications.

Cadent Gas Ltd, NGG and NGET or their agents, servants or contractors do not accept any liability for any losses arising under or in connection with this information. This limit on liability applies to all and any claims in contract, tort (including negligence), misrepresentation (excluding fraudulent misrepresentation), breach of statutory duty or otherwise. This limit on liability does not exclude or restrict liability where prohibited by the law nor does it supersede the express terms of any related agreements.

If you require further assistance please contact the Plant Protection team via e-mail ([click here](#)) or via the contact details at the top of this response.

Yours faithfully

Plant Protection Team

ASSESSMENT

Affected Apparatus

The apparatus that has been identified as being in the vicinity of your proposed works is:

- Low or Medium pressure (below 2 bar) gas pipes and associated equipment. (As a result it is highly likely that there are gas services and associated apparatus in the vicinity)
- Electricity Transmission underground cables and associated equipment

Requirements

BEFORE carrying out any work you must:

- Carefully read these requirements including the attached guidance documents and maps showing the location of apparatus.
- Contact the landowner and ensure any proposed works in private land do not infringe Cadent and/or National Grid's legal rights (i.e. easements or wayleaves). If the works are in the road or footpath the relevant local authority should be contacted.
- Ensure that all persons, including direct labour and contractors, working for you on or near Cadent and/or National Grid's apparatus follow the requirements of the HSE Guidance Notes HSG47 - 'Avoiding Danger from Underground Services' and GS6 – 'Avoidance of danger from overhead electric power lines'. This guidance can be downloaded free of charge at <http://www.hse.gov.uk>
- In line with the above guidance, verify and establish the actual position of mains, pipes, cables, services and other apparatus on site before any activities are undertaken.

GUIDANCE

Working Near National Grid Electricity Transmission equipment:

If you are carrying out any work in proximity to an overhead line or any excavation that may be near an underground cable then please consult National Grid Technical Guidance Note 287 that can be found at <http://www2.nationalgrid.com/WorkArea/DownloadAsset.aspx?id=8589935533> Further guidance related to underground cables can also be found at <http://www2.nationalgrid.com/WorkArea/DownloadAsset.aspx?id=8589936512>

Excavating Safely - Avoiding injury when working near gas pipes:

http://www.nationalgrid.com/NR/rdonlyres/2D2EEA97-B213-459C-9A26-18361C6E0B0D/25249/Digsafe_leaflet3e2finalamends061207.pdf

Standard Guidance

Essential Guidance document:

<http://www2.nationalgrid.com/WorkArea/DownloadAsset.aspx?id=8589934982>

General Guidance document:

<http://www2.nationalgrid.com/WorkArea/DownloadAsset.aspx?id=35103>

Excavating Safely in the vicinity of gas pipes guidance (Credit card):

<http://www.nationalgrid.com/NR/rdonlyres/A3D37677-6641-476C-9DDA-E89949052829/44257/ExcavatingSafelyCreditCard.pdf>

Excavating Safely in the vicinity of electricity cables guidance (Credit card):

<http://www.nationalgrid.com/NR/rdonlyres/35DDEC6D-D754-4BA5-AF3C-D607D05A25C2/44858/ExcavatingSafelyCreditCardelectricitycables.pdf>

Copies of all the Guidance Documents can also be downloaded from the National Grid Website:

<http://www.nationalgrid.com/uk/Gas/Safety/work/downloads/>

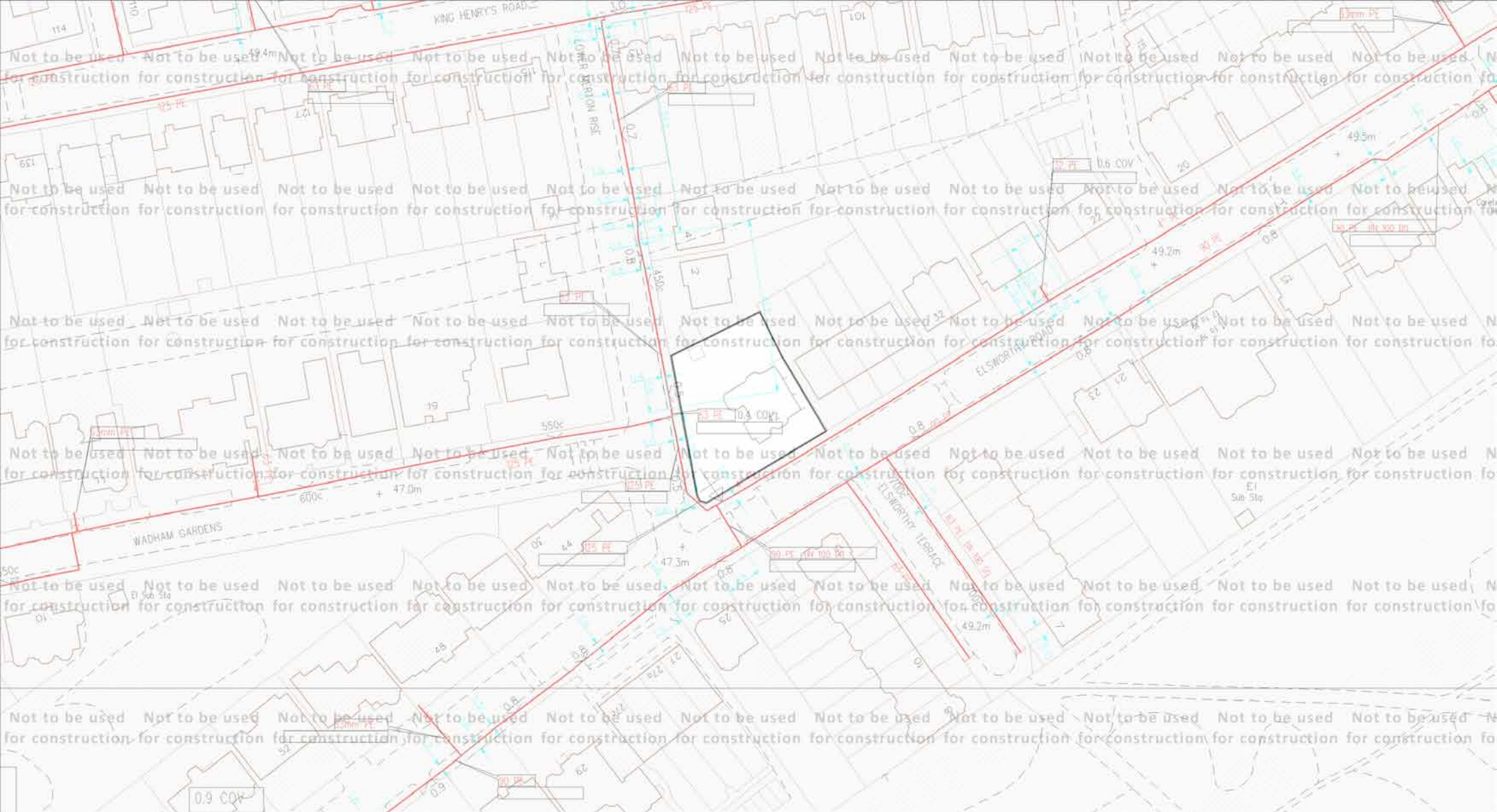

ID: NL_TE_Z5_3SWX_340745		View extent: 361m, 196m	Map not to be used for construction		Map 1 of 2 (GAS)												
USER: create01	LP MAINS		<p>This plan shows those pipes owned by National Grid Gas plc in its role as a Licensed Gas Transporter (GT). Gas pipes owned by other GTs, or otherwise privately owned, may be present in this area. Information with regard to such pipes should be obtained from the relevant owners. The information shown on this plan is given without warranty, the accuracy thereof cannot be guaranteed. Service pipes, valves, syphons, stub connections, etc., are not shown but their presence should be anticipated. No liability of any kind whatsoever is accepted by National Grid Gas plc or their agents, servants or contractors for any error or omission. Safe digging practices, in accordance with HS(G)47, must be used to verify and establish the actual position of mains, pipes, services and other apparatus on site before any mechanical plant is used. It is your responsibility to ensure that this information is provided to all persons (either direct labour or contractors) working for you on or near gas apparatus. The information included on this plan should not be referred to beyond a period of 28 days from the date of issue.</p>														
DATE: 27/06/2017	MP MAINS																
DATA DATE: 24/06/2017	IP MAINS																
REF: 42 Elsworth Road	LHP MAINS																
MAP REF: TQ2784	NHP MAINS																
CENTRE: 527309, 184068	 Approximate scale 1:1250 on A4 Colour Landscape		<p>Some examples of Plant Items:</p> <table><tr><td>Valve</td><td>Depth of Cover</td><td>Syphon</td><td>Diameter Change</td><td>Material Change</td><td>Out of Standard Service</td></tr><tr><td></td><td></td><td></td><td></td><td></td><td></td></tr></table>			Valve	Depth of Cover	Syphon	Diameter Change	Material Change	Out of Standard Service						
Valve	Depth of Cover	Syphon	Diameter Change	Material Change	Out of Standard Service												
			<p>MAPS Plot Server Version 1.9.0</p> <p>Cadent</p> <p>Your Gas Network</p> <p>Requested by: Create Consulting Engineers</p> <p>This plan is reproduced from or based on the OS map by National Grid Gas plc, with the sanction of the controller of HM Stationery Office. Crown Copyright Reserved. Ordnance Survey Licence number 100024886</p>														