

**Notes:**

Do not Scale.

Read in conjunction with engineer's suggested method statement.

⑩ Numbers refer to loads in calculations.

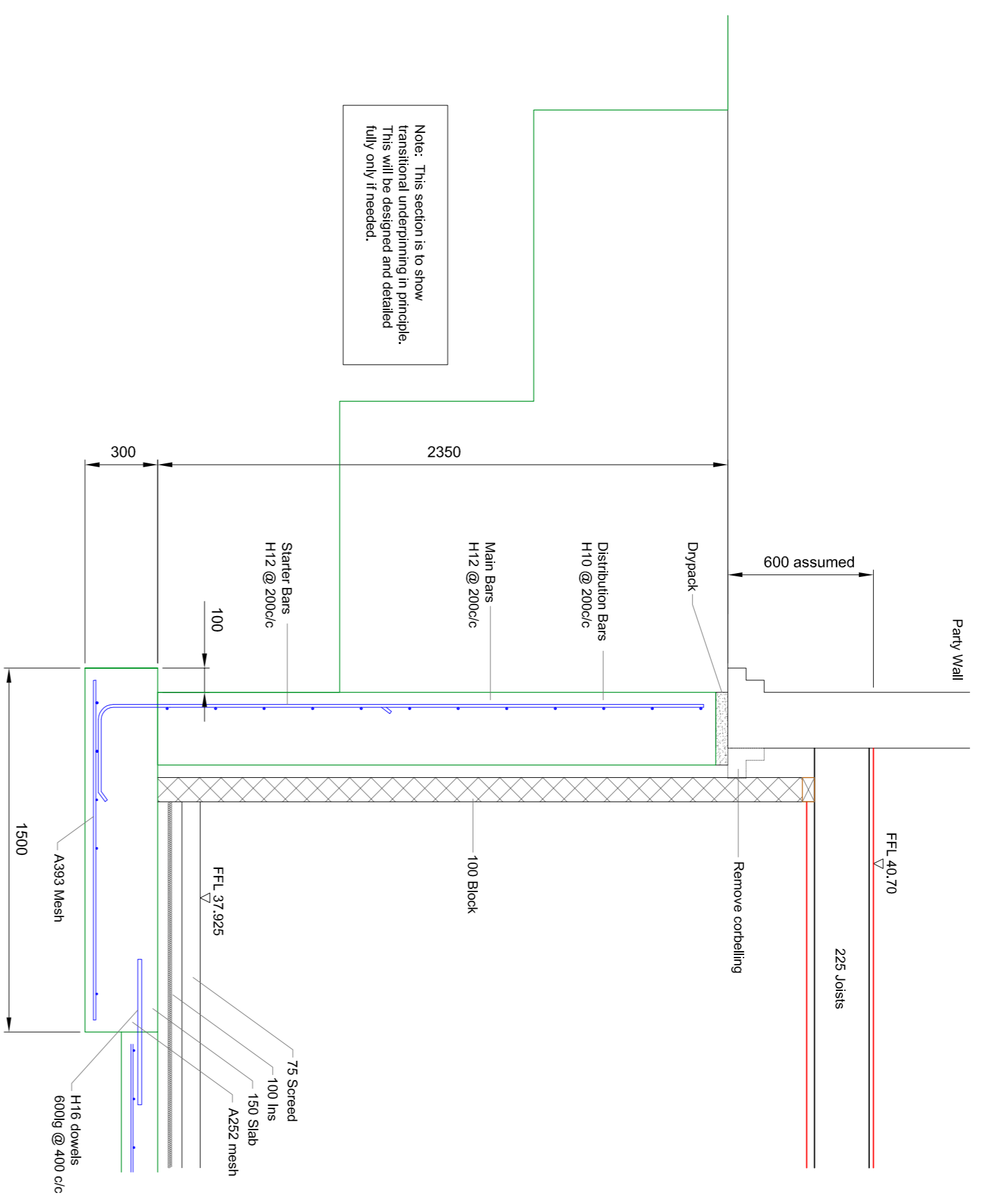
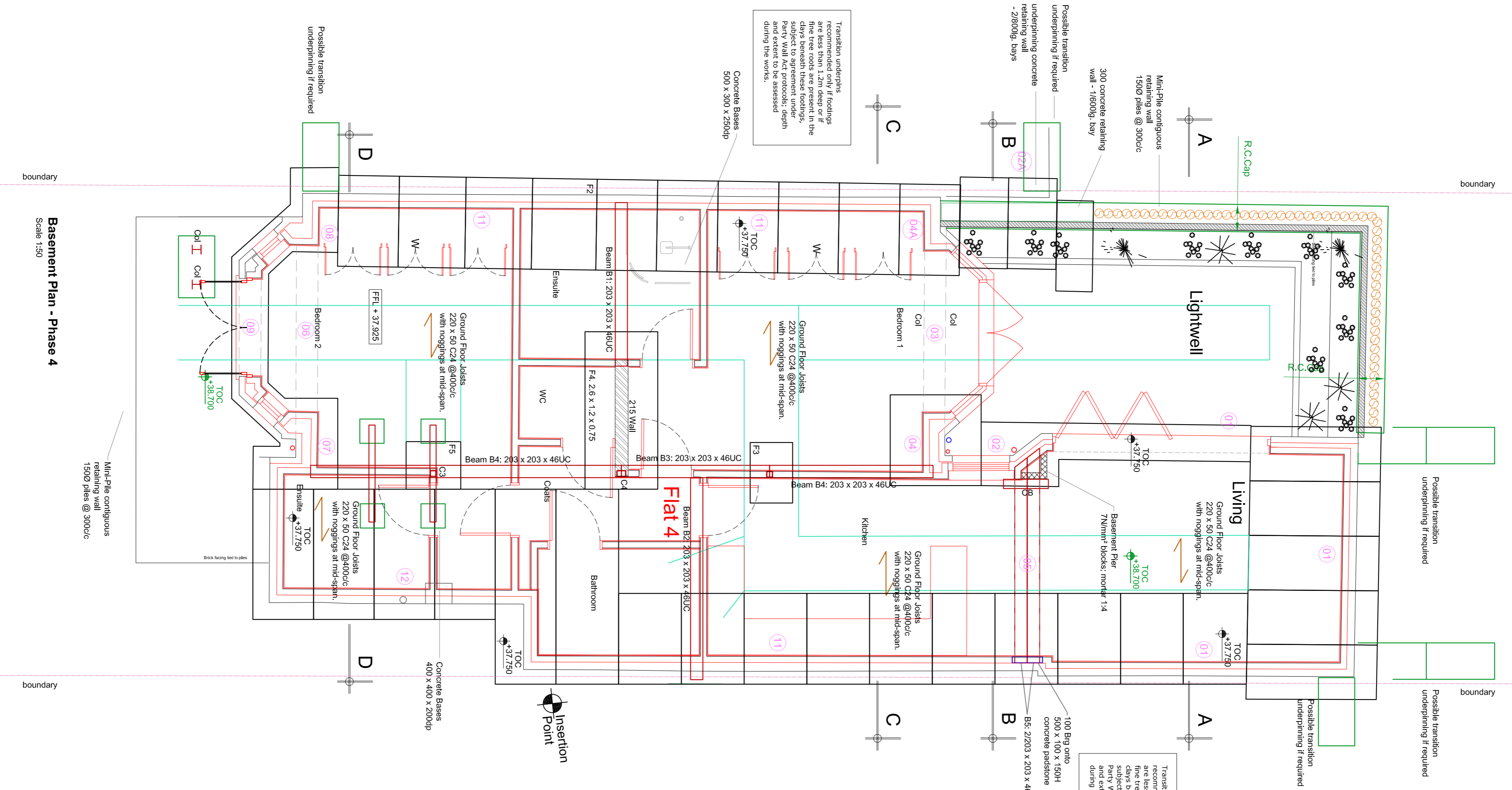

**Typical Basement Underpinning Section (Internal Wall)**  
Section 1:20

Revision	Description
F	28.03.18 Internal substructure removed. External access added.
E	11.10.17 Possible transitional underpinning added.
D	04.10.16 Amendments to party wall retaining wall in light wall.
C	16.03.16 References amended. Piles removed and underpinning added at rear of number 192.
B	31.08.16 Layout revised to amended scheme.
A	01.05.16 Layout revised to amended scheme.

**Approval / Construction**

**S.C. Green Ltd.**  
*Consulting Structural Engineers*  
 Honeywood House  
 Honeywood Rd, Whitfield  
 Dover  
 Kent  
 CT16 3EH  
 Tel: 01304 827883  
 Email: info@sogreen.co.uk

Client