

Upstand to Parapet
(Drg.No: D0901/03-00W_0-4Deg_203-ExtInt-S-DB_001)

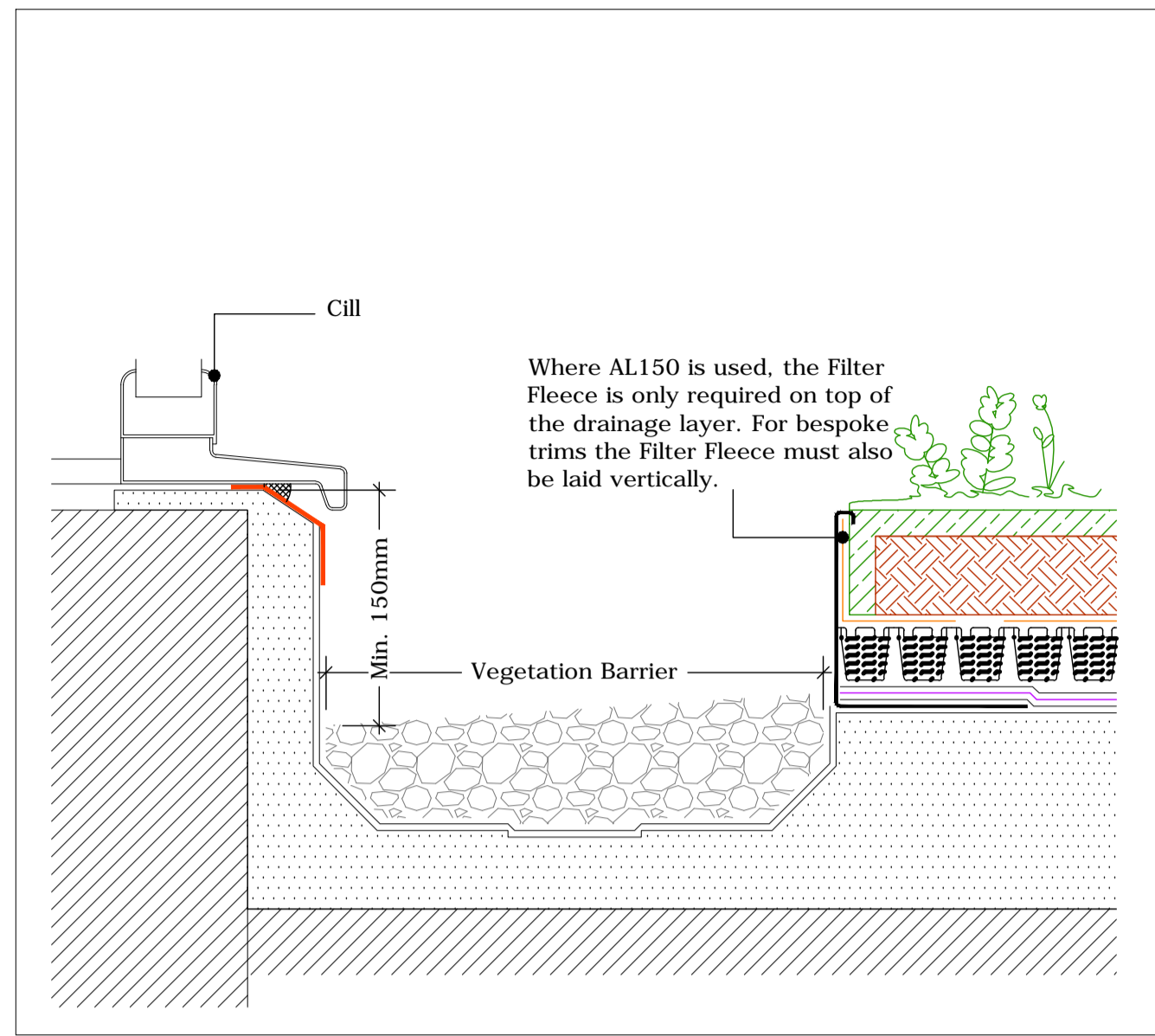

Internal Gutter to Clerestory Window
(Drg.No: D0901/03-00W_0-4Deg_206-ExtInt-S-DB_003)

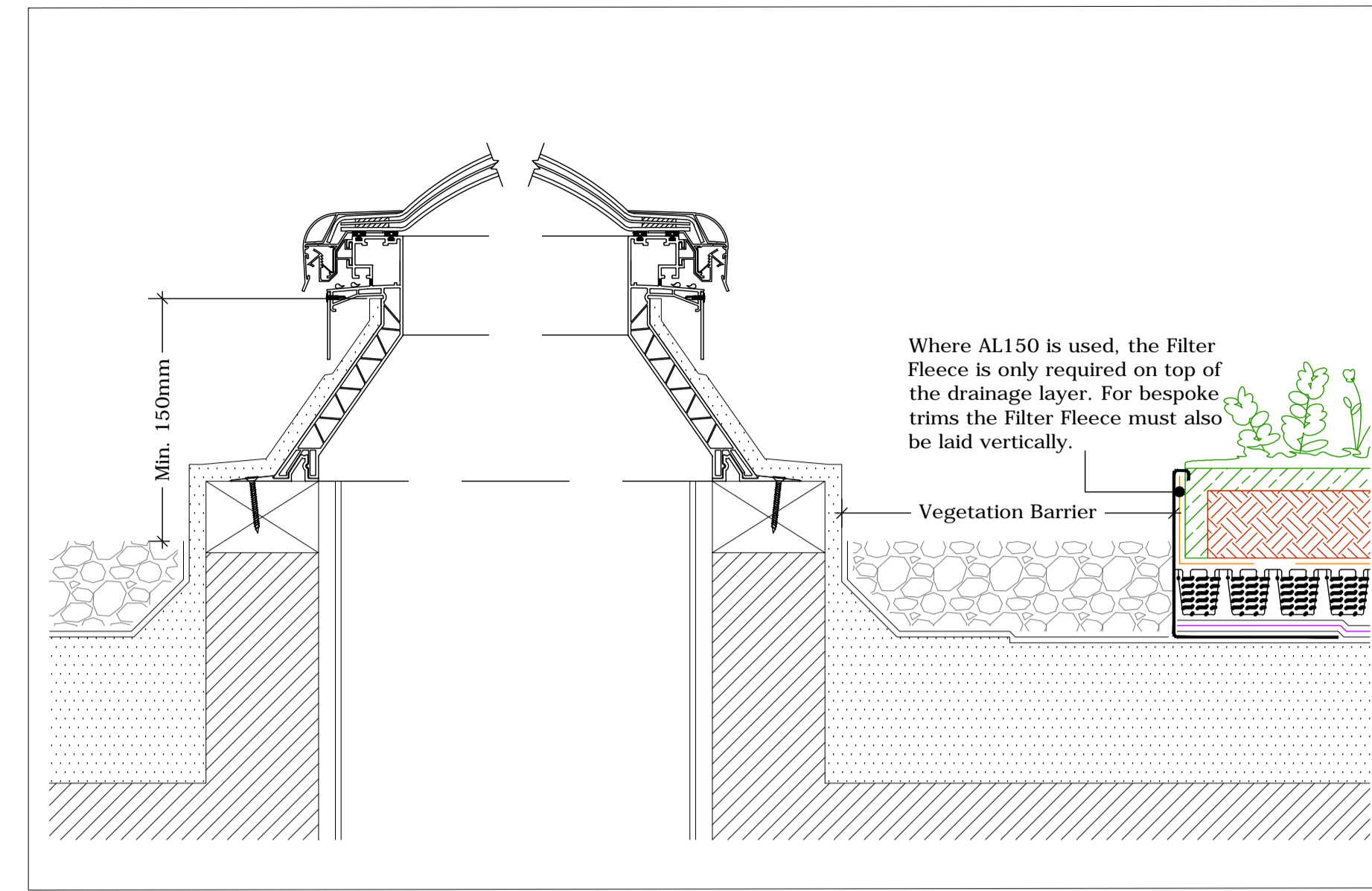

Upstand to Bauder Rooflight - Euroglaze
(Drg.No: D0901/03-00W_0-4Deg_008-ExtInt-S-DB_001)

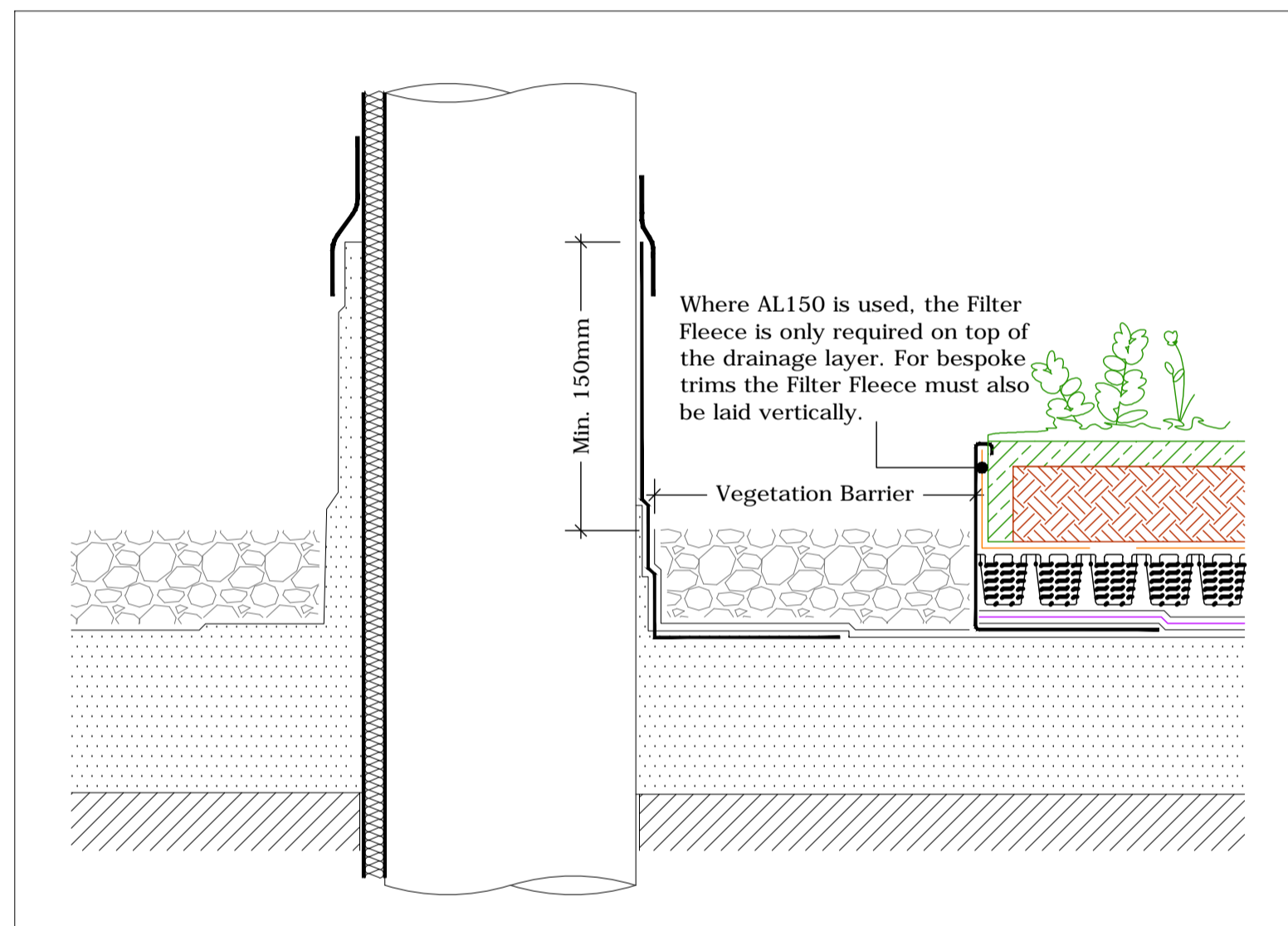

Upstand to Hot Flue or Cold Pipe
(Drg.No: D0901/03-00W_0-4Deg_007-ExtInt-S-DB_002)

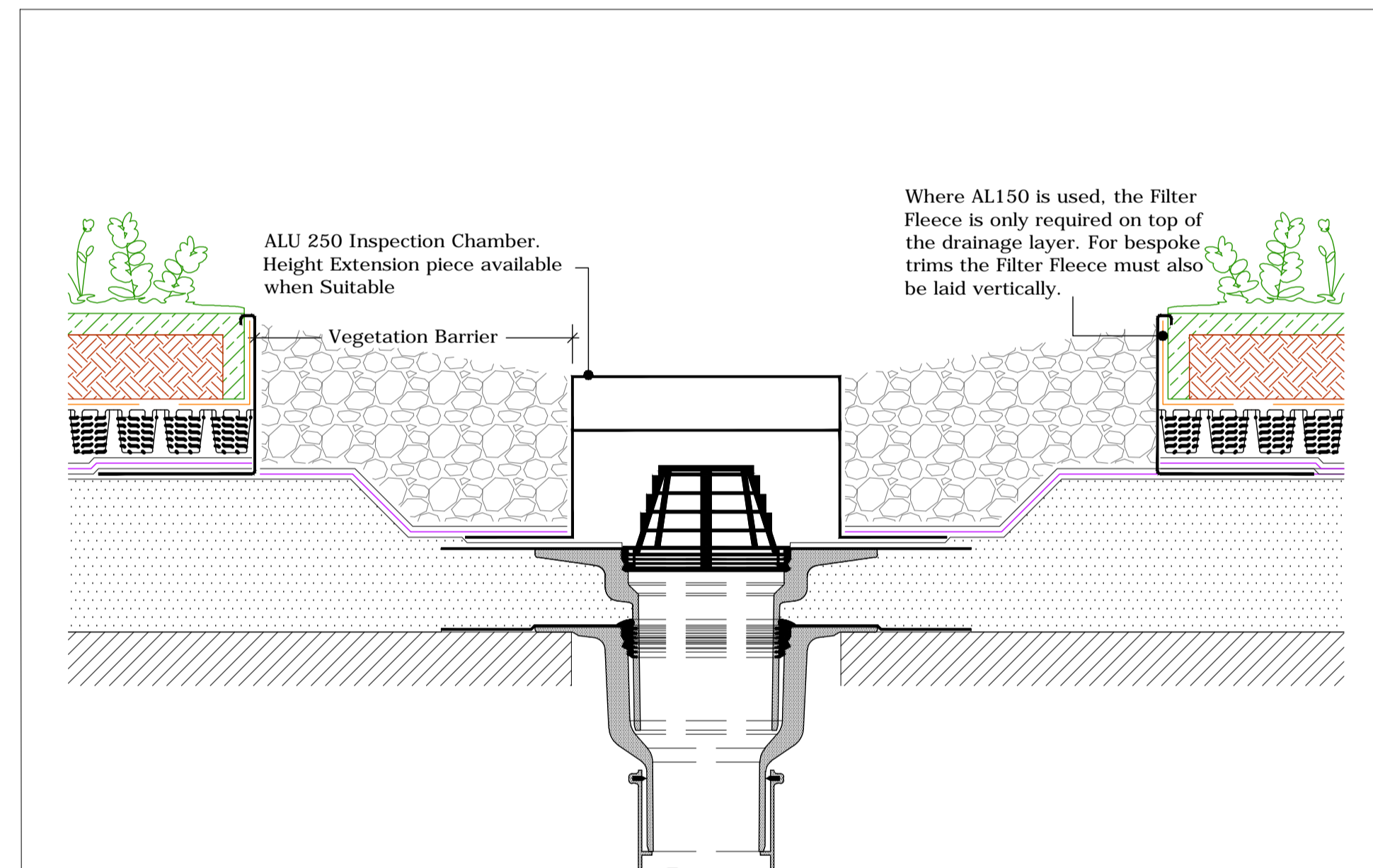

Bauder Outlet - Compact
(Drg.No: D0901/03-00W_0-4Deg_006-ExtInt-S-DB_001)

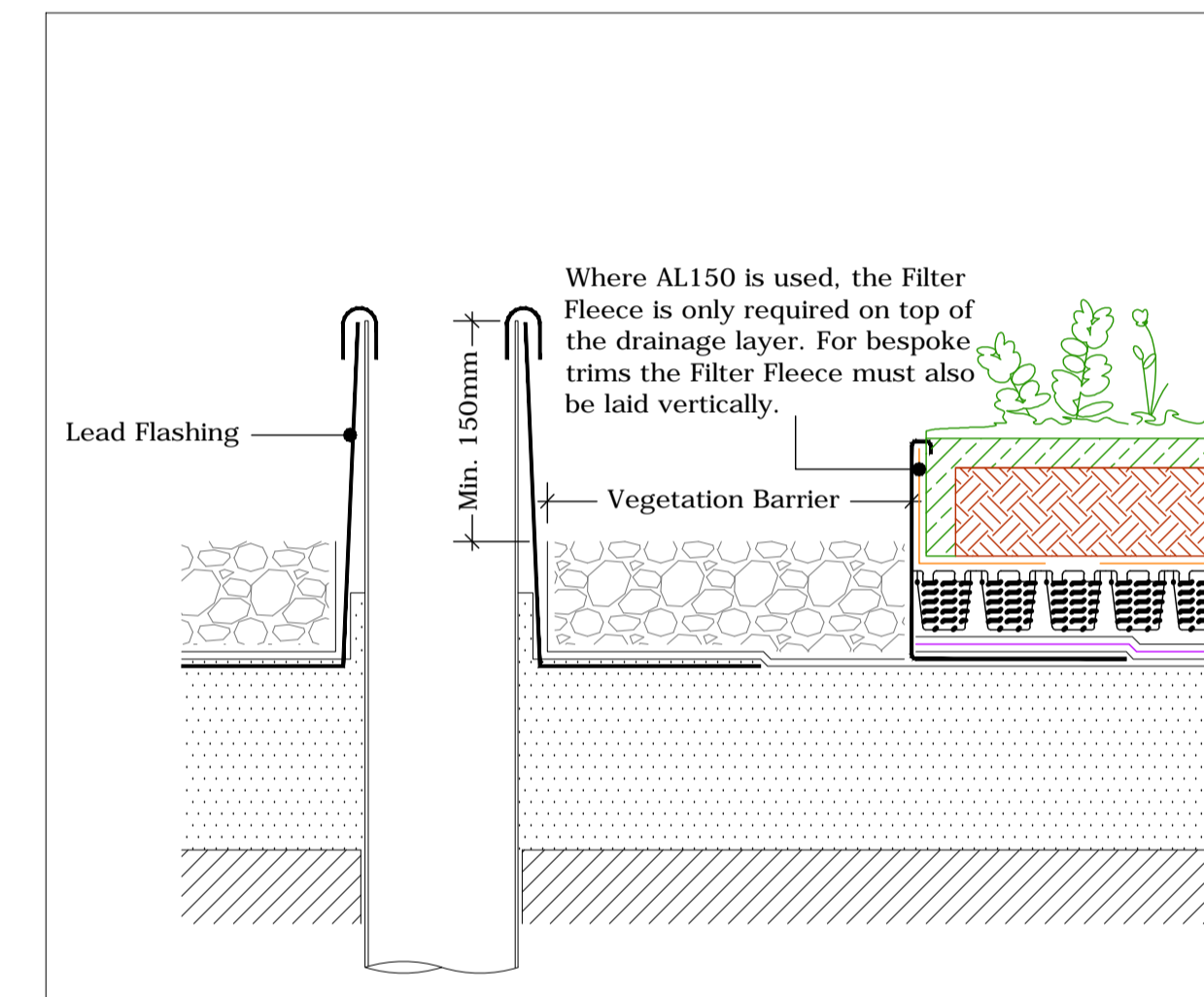

Soil Vent Pipe
(Drg.No: D0901/03-00W_0-4Deg_007-ExtInt-S-DB_001)

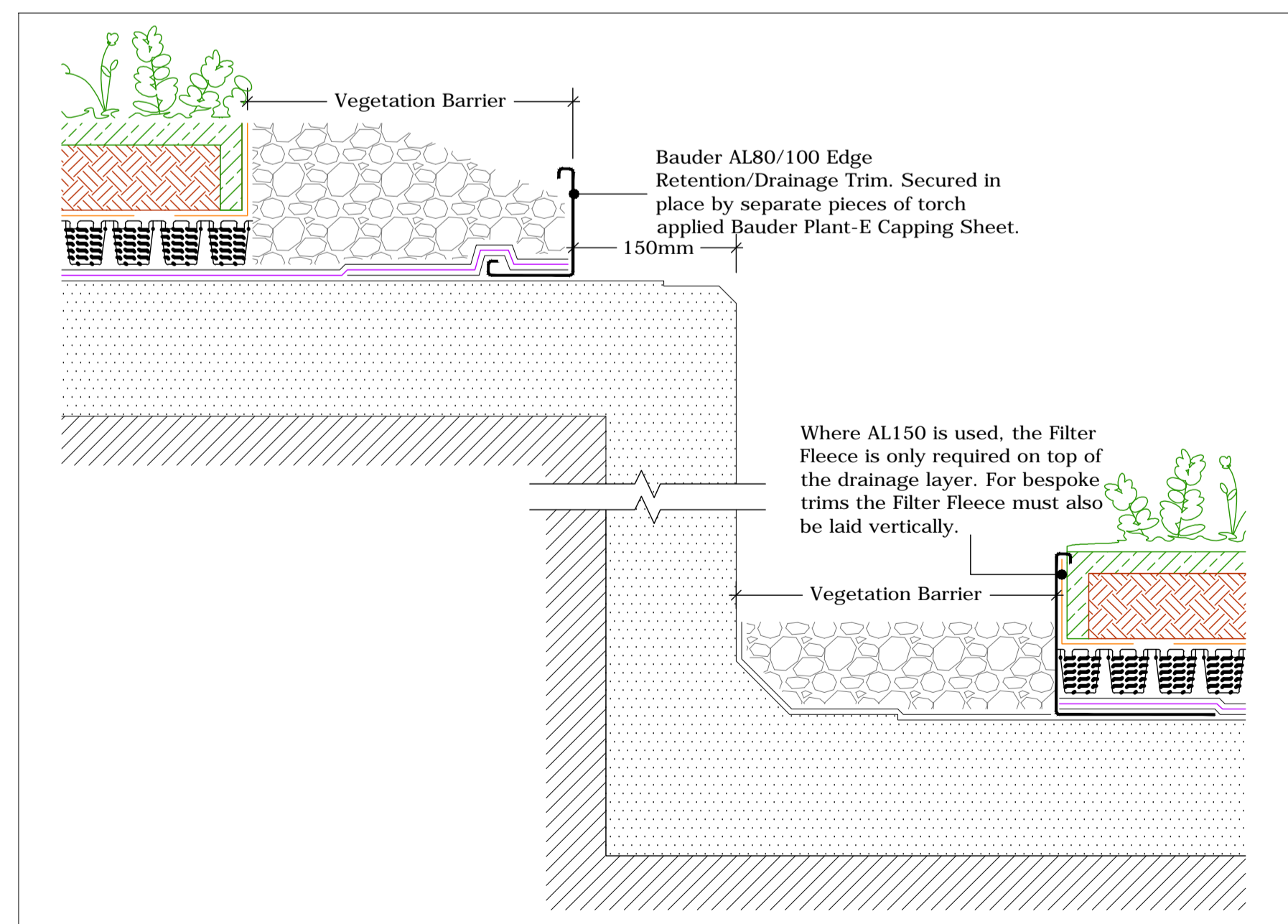

Change In Levels
(Drg.No: D0901/03-00W_0-4Deg_210-ExtInt_001)

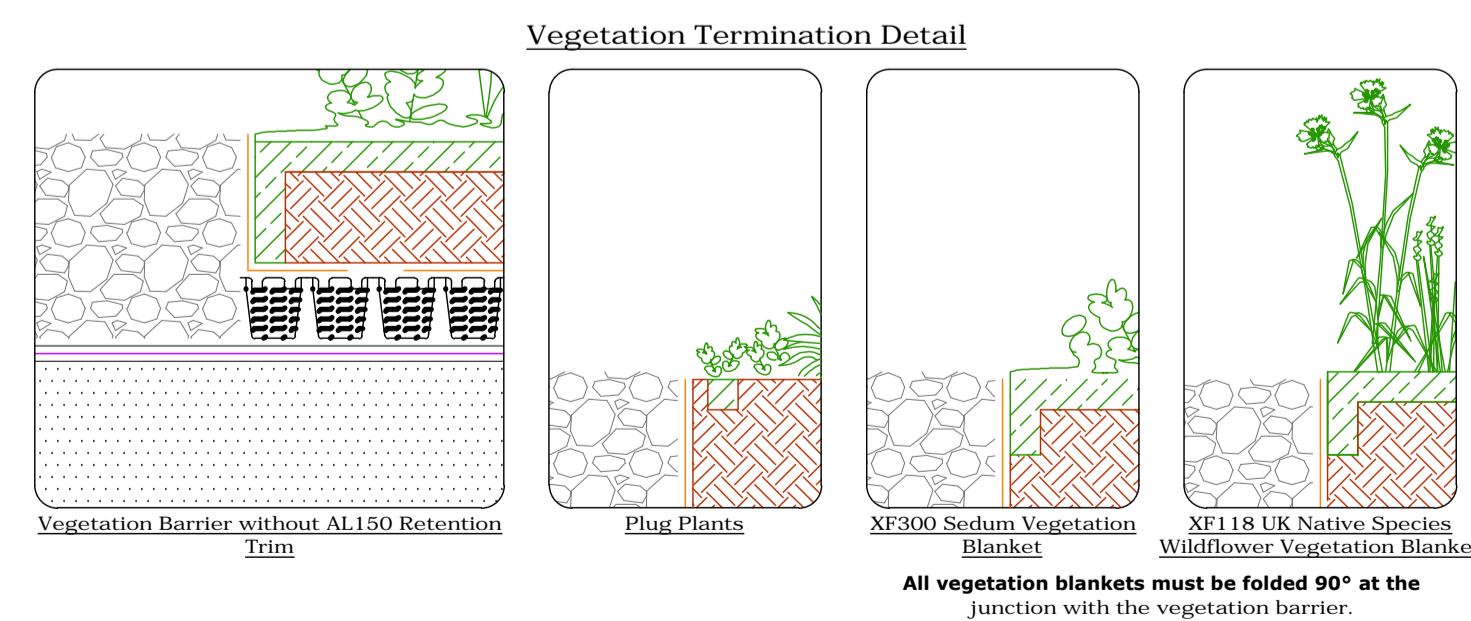

XF300 Sedum Vegetation Blanket or Sedum & Wildflower Plug Planting (DSE20 Drainage Layer) Alternative drainage board options available

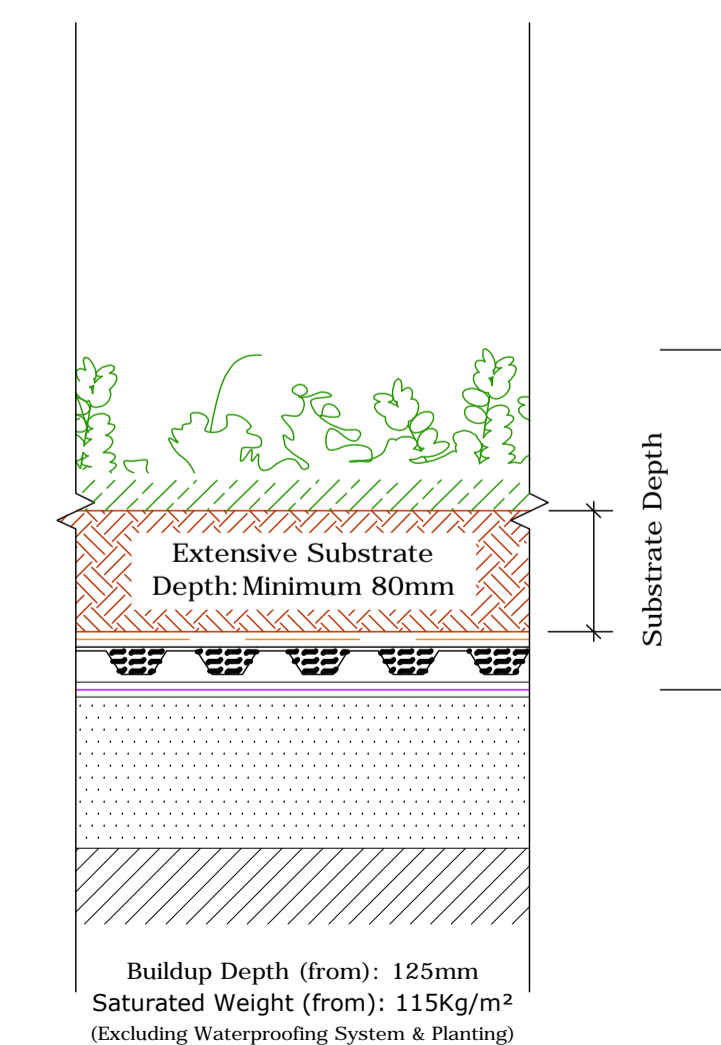

Extensive Soft Landscaping

Key

(Vegetation type is indicative only. Refer to the specification for the correct vegetation to be Used)

- Extensive / Biodiverse Substrate
- DSE20 Drainage Board (Refer to the specification for the correct board to be used)
- Bauder Filter Fleece
- Bauder Protection Mat
- Bauder PE Fleece - Not required on Single Ply Systems
- Additional Bauder Capping Sheet / Membrane to secure the metal trim (Refer to the Specification for the correct option)
- Bauder Waterproofing System (Refer to the specific Bauder waterproofing details drawings for further information)
- Deck / Substrate
- Vegetation barrier Minimum 80mm deep & 300mm wide. Width must be increased to at least 500mm when positioned adjacent to opening rooflights, windows or door openings. In accordance with both green and fire roof codes.
- AL150 Edge / Drainage trim. Secured in place by separate pieces of torch applied Bauder Plant-E Capping Sheet. For vegetation/substrate build-up depths greater than 150mm, a bespoke perforated edge/drainage trim is required.

IMPORTANT NOTE:
This drawing shows alternative details. For the correct solution to be used, refer to the project specific specification.

- IMPORTANT NOTES:**
- This detail is suitable for the following Bauder Systems:
Bauder Total Green Roof System
Bauderflex Green
Thermofol and Thermoplan (Excluding Intensive)
 - This Drawing Shows Alternative Options. For the Correct Solution to be Used, Refer to the Project Specific Specification.
 - Do not scale to ascertain dimensions.
 - All dimensions to be checked and verified on site prior to commencement of work.
 - This drawing is to be read in conjunction with the specification and associated drawings.
 - This detail is a guideline only, representing typical detailing conditions and illustrate the correct application of the above Bauder System. It may be necessary to modify this detail to suit specific project design constraints and conditions.
 - Refer to the Bauder Specification for the product description and method of application. For clarity the method of attachment has not been shown.
 - Provision should be made by the installer for mechanically fixing the top

Rev	Date	Description	Drawn By
--	--	-----	--

BAUDER

UK OFFICE
Bauder Limited
70 Lambour Road, Ipswich,
Suffolk IP3 0DH,
England.
Tel: +44 (0)1473 257671
Fax: +44 (0)1473 230761
Email: technical@bauder.co.uk
bauder.co.uk

IRELAND OFFICE
Bauder Limited
O'Duffy Centre, Cross Lane,
Carrickmacross, Co. Monaghan,
Ireland.
Tel: +353 (0)42 96892 333
Fax: +353 (0)42 96892 839
Email: technical@bauder.ie
bauder.ie

Extensive Green Roof System (0°-4° Slope)

Scale: 1:5 @ A1 Drawing Number: D0901/03-00W_0-4Deg_200-ExtInt-S-DB_001 Rev: -

Drawn By: PCH Checked By: CR Approved By: NB Date: N/A

© Copyright: - This drawing is subject to copyright. No part of this document may be reproduced in any form, without the permission of BAUDER LTD.