

- 3 x new DT01 dormers
- 2 x Bird Box Type 2
- New dormer type DT04
- New east extension serving Unit 1
- New single glazed leaded window
- Stone padstone
- New single glazed leaded door and window
- New New single glazed leaded window to existing building fabric
- New single glazed leaded door to existing building fabric
- New single glazed leaded window to replace existing door



PROPOSED NORTH ELEVATION

- New gate and fence
- New single glazed leaded door
- Red brick, to match existing
- Stone quoins
- Window to be replaced



EXISTING NORTH ELEVATION

Revisions					Revisions						
Rev	Date	By	Description	Checked	Approved	Rev	Date	By	Description	Checked	Approved
P1	21.12.18	TS	For NMA issue	JM	RH						

A1  
A3

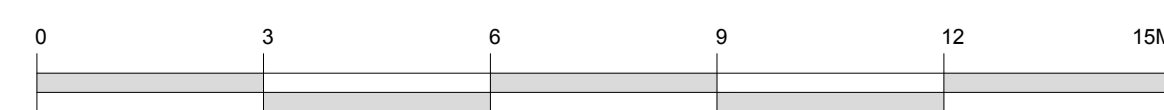

For electrical services (inc. lighting and cctv) refer to MEP engineer drawings  
For finishes refer to 289\_1\_2\_Planning Facing Materials\_1128L

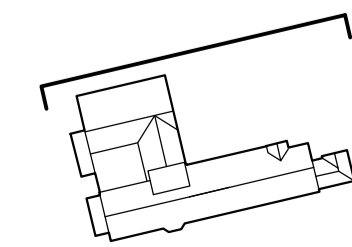

Client Sign Off	Architect/Originator:	Unit 1182, Stamford Works, 3 Gillet Street, London N16 8JH	Do not scale. All dimensions to be checked on site. This drawing is copyright.
	Client:	Platinum Land	
	Project:	Beisize Park Firestation	Date of Origin: 28.11.17
	Project:	Proposed and Existing North Elevation	Scale: 1:100 @ A1
	Client Sign Off	BFS THA PR PA 310 P1	Revision