

# PROPOSED GROUND FLOOR

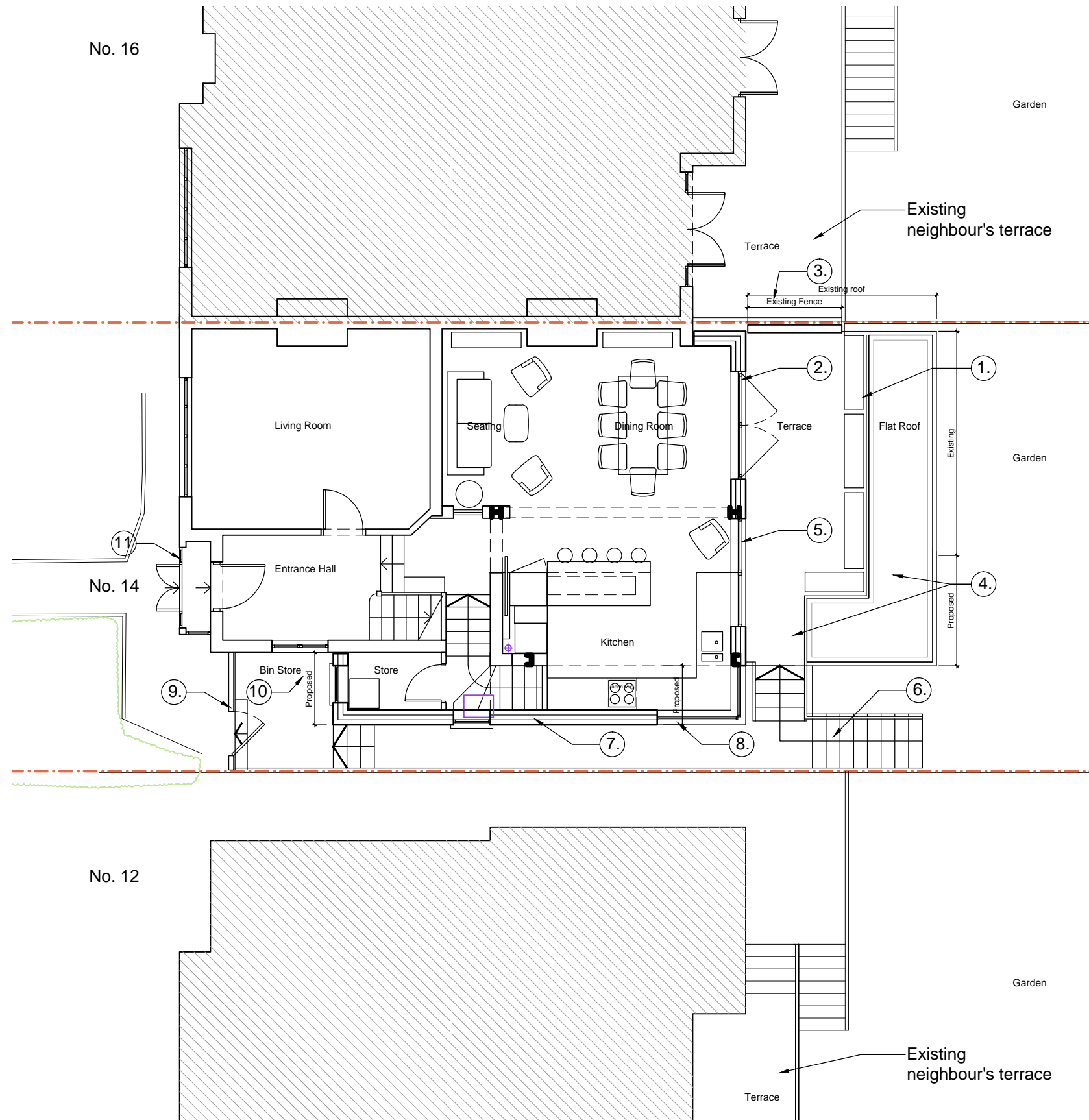

## PROPOSED WORKS

1. New handrail and planters added to define reduced terrace area in line with neighbouring terraces. Existing handrail to remain in place.
2. Infill extension with new metal framed glass doors to ground floor, in line with rear of existing house. Finished in painted render to match existing with dark gray metal capping to parapet.
3. Existing timber slated fence wall to remain
4. Extension to garden room and access route to garden level. Built in line with existing rear of house. Finished in painted render to match existing with dark gray metal capping to parapet. Metal framed dark gray painted glass doors to garden elevation and high level glass block window to side.
5. New metal framed dark gray painted window to ground floor rear elevation, with matching spandrel panel to kitchen counters
6. New stairs from side passageway to rear door and garden
7. Side extension to accommodate kitchen, store room and stair to lower ground floor. Built in line with existing rear of house and set back from the street elevation. Finished in painted render to match existing with dark gray metal capping to parapet.
8. New corner window to replace existing utility room windows, metal framed dark gray painted finish to ground floor rear elevation.
9. New painted timber clad wall and gate to side access route
10. New raised bin-store area and steps
11. Existing enclosure to porch removed to expose original front door

Scale line @ 1:100

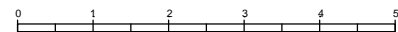

Revisions  1. This drawing and all the designs herein are the sole property of HAT and may not be used without written authorisation. 2. These drawings are not for construction and the contractor must verify all site dimensions and must notify h&dd of any discrepancies. 3. Do not scale from this drawing all dimensions shown to be confirmed on site prior to construction 4. All measurements in metric		Project		Drawing	
		14 Makepeace Avenue Holly Lodge Estate		PROPOSED PLANS GROUND FLOOR	
		Scale	Date	Drawing No	Revision
		1:100@A3	Dec 2018	226_GA-02	-

**HNT**  
ARCHITECTURE / INTERIORS

22A Iliffe Yard  
London SE17 3QA  
tel: +44(0)207 703 2270  
info@hataarch.co.uk  
www.hataarch.co.uk