

# PROPOSED ROOF PLAN

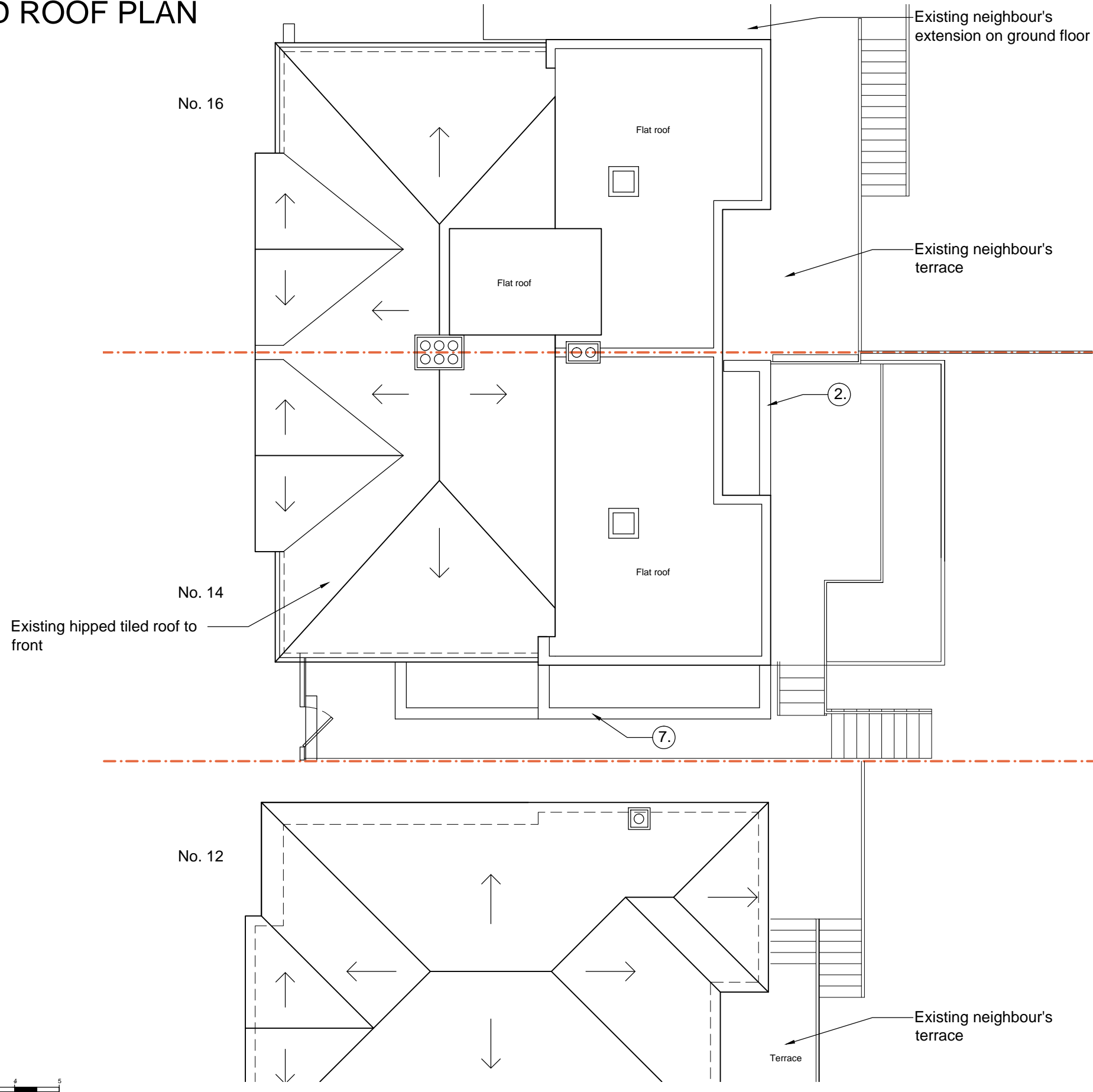

## PROPOSED WORKS

2. Infill extension with new metal framed glass doors to ground floor, in line with rear of existing house. Finished in painted render to match existing with dark gray metal capping to parapet.

7. Side extension to accommodate kitchen, store room and stair to lower ground floor. Built in line with existing rear of house and set back from the street elevation. Finished in painted render to match existing with dark gray metal capping to parapet.

Scale line@ 1:100



Revisions  1. This drawing and all the designs herein are the sole property of HAT and may not be used without written authorisation. 2. These drawings are not for construction and the contractor must verify all site dimensions and must notify h&dd of any discrepancies. 3. Do not scale from this drawing all dimensions shown to be confirmed on site prior to construction 4. All measurements in metric		Project		Drawing		
		14 Makepeace Avenue Holly Lodge Estate		PROPOSED PLANS ROOFPLAN		
		Scale	Date	Drawing No	Revision	
		1:100@A3	Dec 2018	226_GA-04	-	

**HNT**  
ARCHITECTURE / INTERIORS

22A Iliffe Yard  
London SE17 3QA  
tel: +44(0)207 703 2270  
info@hatarch.co.uk  
www.hatarch.co.uk