

OLIVER WEST & JOHN SCOTT ARCHITECTS

The Studio 3A Bath Road Bedford Park London W4 1LL 020 8995 4275 studio@westscottarchitects.co.uk

HIGHGATE CEMETERY · CHESTER ROAD ENTRANCE · ALTERATIONS FOR CONTROLLED ACCESS (B) 968/E/023

REVISION B: APRIL 2018. GENERAL REVISIONS FOLLOWING SITE MEETINGS.

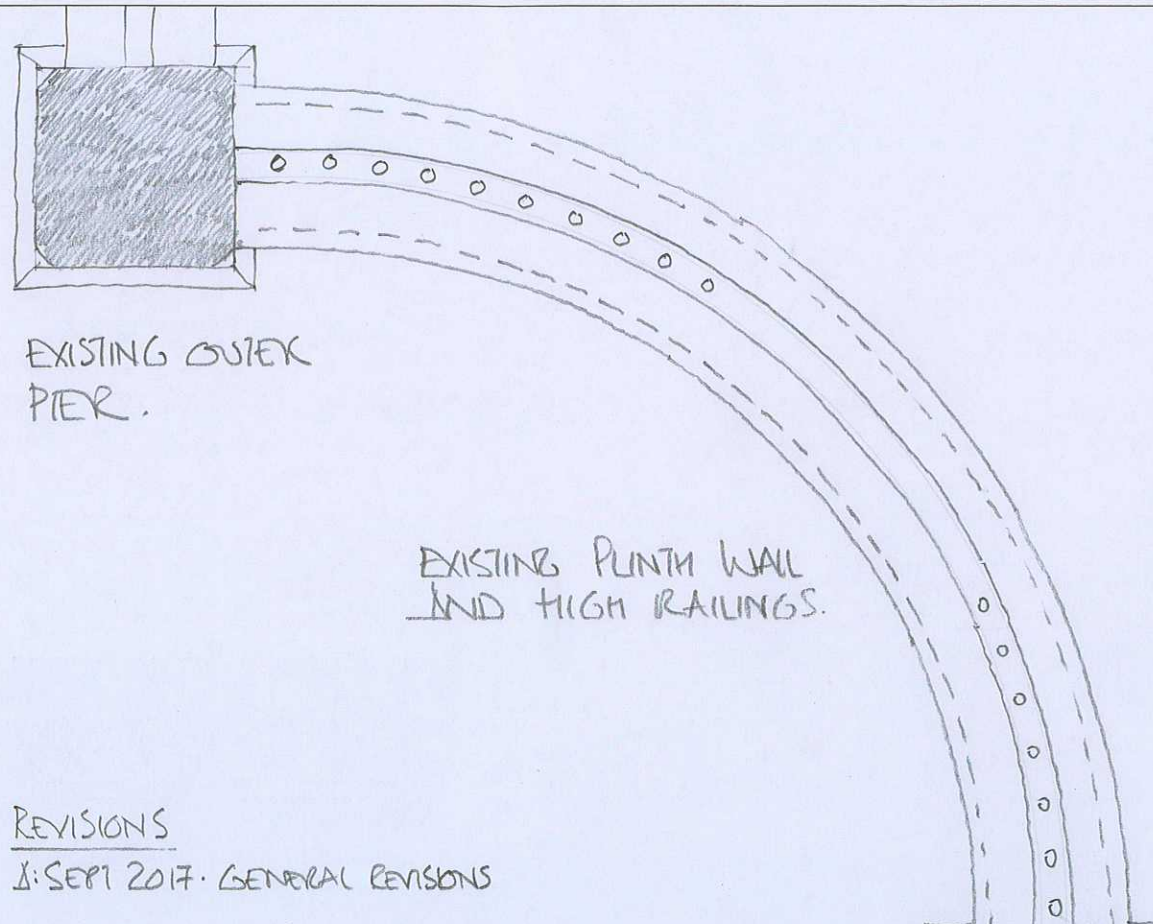

REVISIONS
A: SEPT 2017. GENERAL REVISIONS

ELEVATION OF NEW ENCLOSURE.

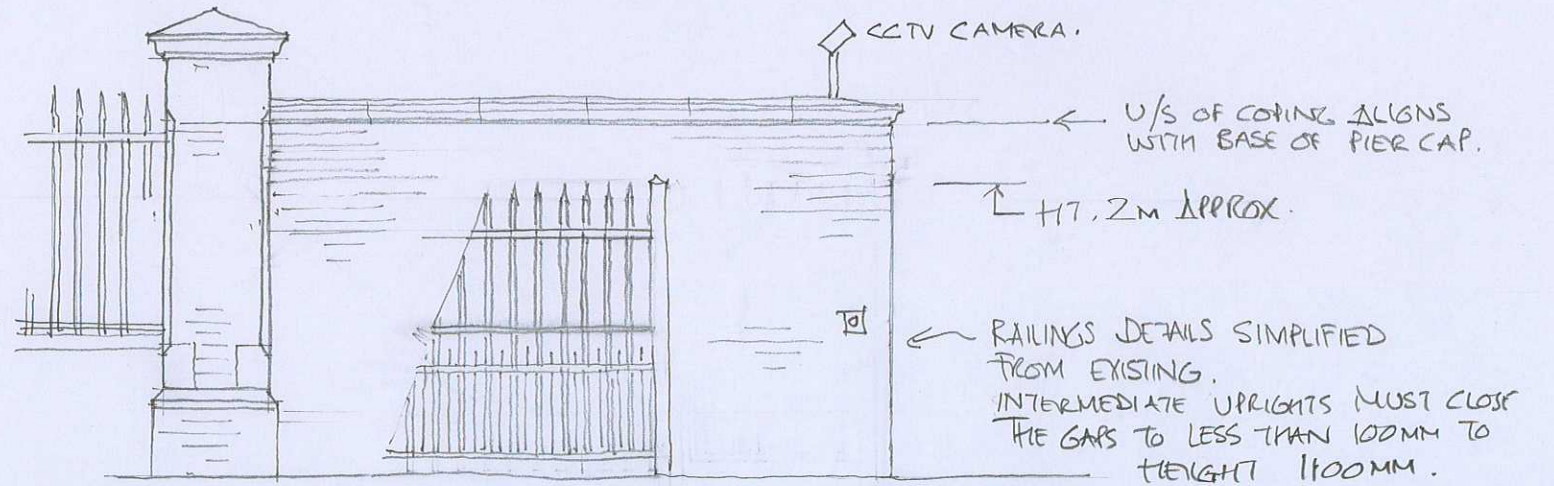

SCALE 1:50 AT A3.

BOLLARD WITH ELECTRONIC GATE SECURITY / ACTIVATION BY CARD READER.

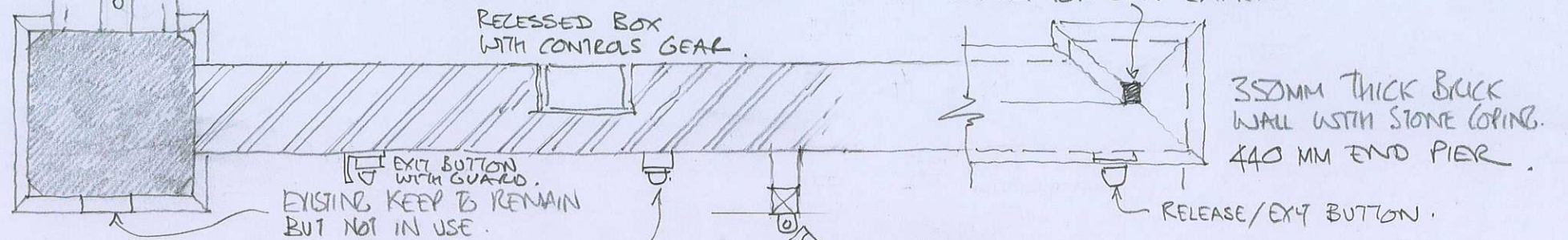

EXISTING GATE RAILINGS NOT AUTOMATED.

PLAN OF LEFT HAND GATE.

METRES
1:25 AT A3.

EXISTING PIERS.

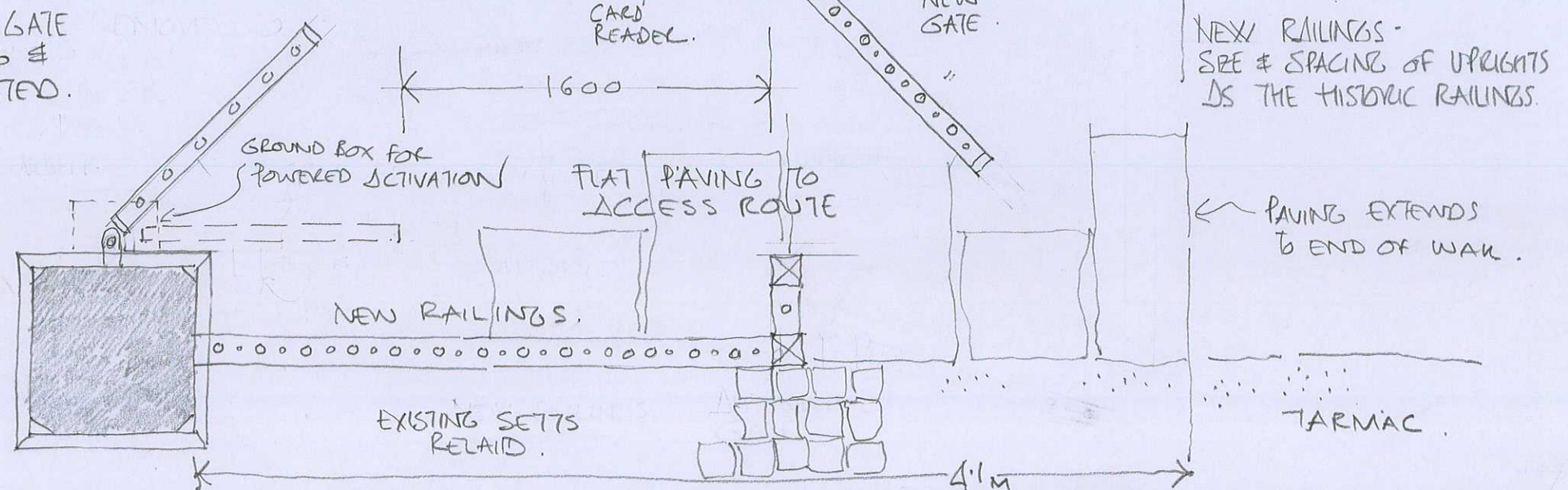

OLIVER WEST & JOHN SCOTT
ARCHITECTS

The Studio 3A Bath Road Bedford Park London W4 1LL 020 8995 4275 studio@westscottarchitects.co.uk

HIGHGATE CEMETERY - CHESTER ROAD ENTRANCE

OVERALL PLAN OF PROPOSALS 1:50 ATAS

968/E/03

