

No.	Note
1	All dimensions to be verified on site by GENERAL CONTRACTOR prior to any work, setting out or shop drawings being prepared.
2	Drawings not to be scaled. Work to figured dimensions only.
3	© copyright SAUNDERS BOSTON LIMITED. All rights reserved. This drawing remains the property of SAUNDERS BOSTON LIMITED at all times and may not be reproduced or copied in whole or in part without their prior written consent.
4	This drawing and related specifications are for use only in the stated location.
5	This drawing is to be read in conjunction with all other Consultants drawings and specifications.
6	Drainage has not been surveyed and any/all pipe locations and below ground drainage runs are indicative.
7	It is assumed that all works will be carried out by a competent contractor who will be working, where appropriate, to an approved method statement.

By Department Legend

- Circulation
- IRDR Spaces
- Not Included

Refurbishment Legend

- ASBESTOS REMOVAL AS PER LUCION REPORT
- RE-CARPET
- RE-PAINT WALLS
- AIR CONDITIONING
- NEW VINYL FLOORING
- NEW ABSENCE DETECTION LIGHTING

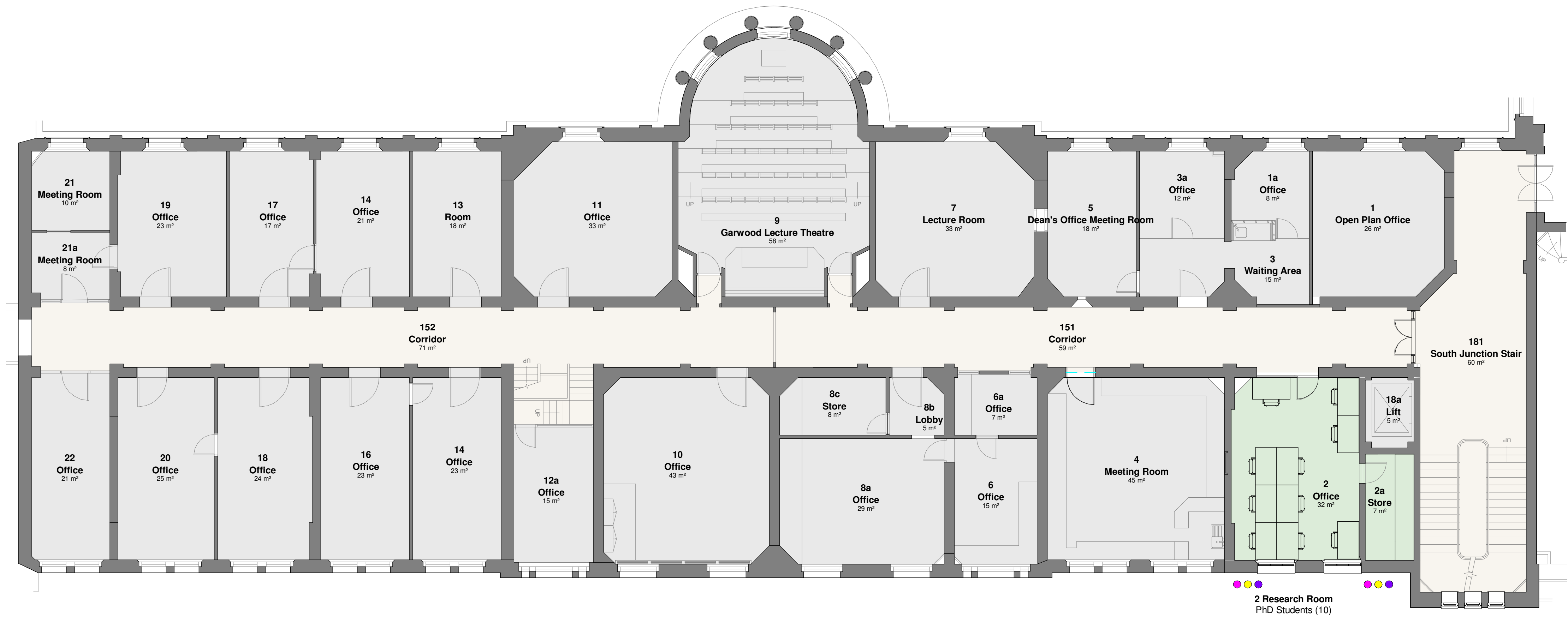

Proposed First Floor GA Plan  
1 : 100

2	Planning Issue	18/12/2018	RJB	LJM
1	First Floor Room 2 / 2a added to scope	06/12/2018	RJB	LJM
No.	Revision	Date	Chk.	Auth.

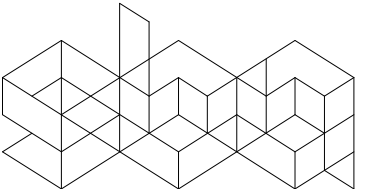

**Saunders  
Boston  
Architects**

Eastern Gate House, 119 Newmarket Road,  
Cambridge CB5 8HA  
T 01223 367733  
office@saundersboston.co.uk

The Generator, The Gallery, King's Wharf  
The Quay, Exeter EX2 4AN  
T 01392 349627  
www.saundersboston.co.uk

University College London

Job  
Wilkins-South Wing Level 2 Refurb

Drawing  
Proposed GA Plan - First Floor

Scale  
1 : 100 @A1

Revision  
**2**

SBA Project Code <b>1657</b>	Drawn LJM Checked RJB	Date 05/12/18 Suitability Code	project PS00999	originator -SBA-XX-01	zone -DR-A-011	level -	type -	role -	number -
---------------------------------	--------------------------------	---	--------------------	--------------------------	-------------------	------------	-----------	-----------	-------------