

S96a Revision:  
Location of re-provided cycle storage  
amended, now shown on drawing PL(00)40.  
Number of re-provided cycle spaces  
unchanged.

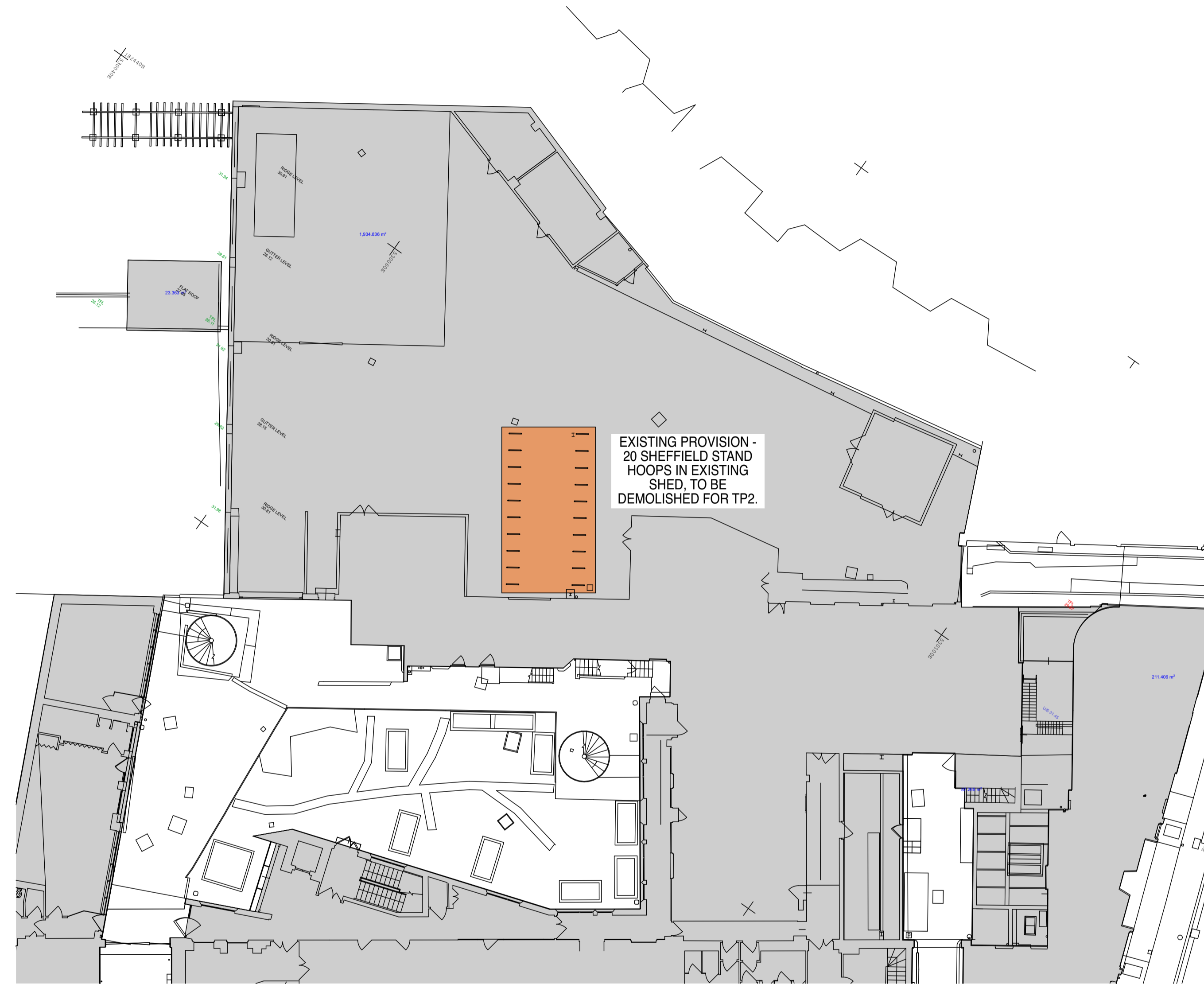

Drawing shows location of 20 existing 'Sheffield' hoop cycle stands to be removed as part of proposed demolition works.

A total of 24 Cycle Spaces to be re-provided for users of the existing building (TP1) as part of the proposed works. Refer to drawing PL(00)40 for location of new cycle stands.