

new IQ Glass Mondrian
single glazed entrance doors
and screen. RAL 8022

existing piers / columns to be
retained, made good and
redecorated to match existing
adjacent

underside of Bernard Katz concrete slab behind

WILKINS BUILDING
THE BERNARD KATZ BUILDING

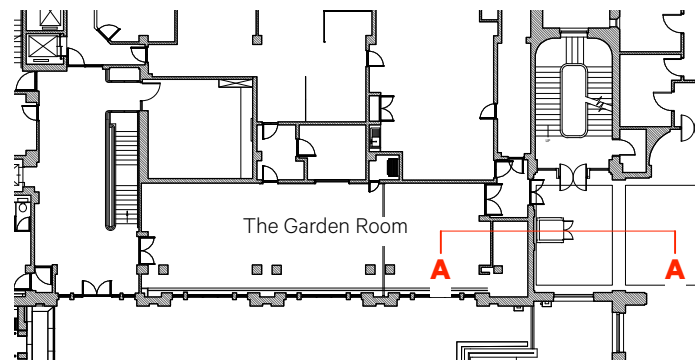

Location Plan 1:200.

Revision	Date	Amendment	Notes					Client	University College London	Burwell Deakins <small>info@burwellarchitects.com www.burwellarchitects.com</small>	
P1	11.12.18	Planning issue						Project	Wilkins Building Core Areas - The Garden Room		
								Drawing	Section - As Proposed		
								Scale	1:20 @ A1	Drawn	CL
								Date	November 2018		
								Project N°	791	Drawing N°	791/PL/013
								Revision	P1	Unit 001	First Floor
										California Building	6 Southernhay
										London SE13 7SF	West Exeter EX1 1JG
										+44 (0) 2083 056010	+44 (0) 1392 423981

NO DIMENSIONS ARE TO BE SCALED FROM THIS DRAWING. THE CONTRACTOR/MANUFACTURER IS RESPONSIBLE FOR CHECKING ALL DIMENSIONS AND QUERYING ANY DISCREPANCIES. THIS DRAWING IS THE PROPERTY OF BDA ARCHITECTS LTD. COPYRIGHT IS RESERVED BY THEM AND THE DRAWING IS ISSUED ON CONDITION THAT IT IS NOT COPIED, REPRODUCED, RETAINED OR DISCLOSED TO ANY UNAUTHORISED PERSON, EITHER WHOLLY OR IN PART, WITHOUT WRITTEN CONSENT.