

CHECKED

Chrissy Elliott
Atkins Limited
The Hub
500 Park Avenue
Aztec West
Almondsbury
Bristol
BS32 4RZ

Plant Protection
Cadent
Block 1; Floor 1
Brick Kiln Street
Hinckley
LE10 0NA
E-mail: plantprotection@cadentgas.com
Telephone: +44 (0)800 688588

National Gas Emergency Number:
0800 111 999*

National Grid Electricity Emergency Number:
0800 40 40 90*

* Available 24 hours, 7 days/week.
Calls may be recorded and monitored.

www.cadentgas.com

Date: 14/12/2018

Our Ref: NL_TE_Z5_3SL_495813-2

Your Ref: 71681 - LSBUD-181207-14367497

RE: Proposed Works, Site off Wadham Gardens, London

Thank you for your enquiry which was received on 14/12/2018.
Please note this response and any attached map(s) are valid for 28 days.

An assessment has been carried out with respect to Cadent Gas Limited, National Grid Electricity Transmission plc's and National Grid Gas Transmission plc's apparatus. Please note it does not cover the items listed in the section "Your Responsibilities and Obligations", including gas service pipes and related apparatus.

For details of Network areas please see the Cadent website (<http://cadentgas.com/Digging-safely/Dial-before-you-dig>) or the enclosed documentation.

As your works are at a "proposed" stage, any maps and guidance provided are for information purposes only. This is not approval to commence work. You must submit a "Scheduled Works" enquiry at the earliest opportunity and failure to do this may lead to disruption to your plans and works. Plant Protection will endeavour to provide an initial assessment within 14 days of receipt of a Scheduled Works enquiry and dependent on the outcome of this, further consultation may be required.

In any event, for safety and legal reasons, works must not be carried out until a Scheduled Works enquiry has been completed and final response received.

Your Responsibilities and Obligations

The "Assessment" Section below outlines the detailed requirements that must be followed when planning or undertaking your scheduled activities at this location.

It is your responsibility to ensure that the information you have submitted is accurate and that all relevant documents including links are provided to all persons (either direct labour or contractors) working for you near Cadent and/or National Grid's apparatus, e.g. as contained within the Construction (Design and Management) Regulations.

This assessment solely relates to Cadent Gas Limited, National Grid Electricity Transmission plc (NGET) and National Grid Gas Transmission plc (NGGT) and apparatus. This assessment does **NOT** include:

- Cadent and/or National Grid's legal interest (easements or wayleaves) in the land which restricts activity in proximity to Cadent and/or National Grid's assets in private land. You must obtain details of any such restrictions from the landowner in the first instance and if in doubt contact Plant Protection.
- Gas service pipes and related apparatus
- Recently installed apparatus
- Apparatus owned by other organisations, e.g. other gas distribution operators, local electricity companies, other utilities, etc.

It is **YOUR** responsibility to take into account whether the items listed above may be present and if they could be affected by your proposed activities. Further "Essential Guidance" in respect of these items can be found on either the [National Grid](#) or [Cadent](#) website.

This communication does not constitute any formal agreement or consent for any proposed development work; either generally or with regard to Cadent and/or National Grid's easements or wayleaves nor any planning or building regulations applications.

Cadent Gas Limited, NGGT and NGET or their agents, servants or contractors do not accept any liability for any losses arising under or in connection with this information. This limit on liability applies to all and any claims in contract, tort (including negligence), misrepresentation (excluding fraudulent misrepresentation), breach of statutory duty or otherwise. This limit on liability does not exclude or restrict liability where prohibited by the law nor does it supersede the express terms of any related agreements.

If you require further assistance please contact the Plant Protection team via e-mail ([click here](#)) or via the contact details at the top of this response.

Yours faithfully

Plant Protection Team

ASSESSMENT

Affected Apparatus

The apparatus that has been identified as being in the vicinity of your proposed works is:

- Low or Medium pressure (below 2 bar) gas pipes and associated equipment. (As a result it is highly likely that there are gas services and associated apparatus in the vicinity)
- Electricity Transmission underground cables and associated equipment

Requirements

BEFORE carrying out any work you must:

- **Refer to the attached cable profile drawings (if any) which provide details about the location of National Grid's high voltage underground cables.**
- Carefully read these requirements including the attached guidance documents and maps showing the location of apparatus.
- Contact the landowner and ensure any proposed works in private land do not infringe Cadent and/or National Grid's legal rights (i.e. easements or wayleaves). If the works are in the road or footpath the relevant local authority should be contacted.
- Ensure that all persons, including direct labour and contractors, working for you on or near Cadent and/or National Grid's apparatus follow the requirements of the HSE Guidance Notes HSG47 - 'Avoiding Danger from Underground Services' and GS6 – 'Avoidance of danger from overhead electric power lines'. This guidance can be downloaded free of charge at <http://www.hse.gov.uk>
- In line with the above guidance, verify and establish the actual position of mains, pipes, cables, services and other apparatus on site before any activities are undertaken.

GUIDANCE

Working Near National Grid Electricity Transmission equipment:

If you are carrying out any work in proximity to an overhead line or any excavation that may be near an underground cable then please consult National Grid Technical Guidance Note 287 that can be found at https://www.nationalgrid.com/sites/default/files/documents/8589935533-TGN%20287_Third%20party%20guidance%20for%20working%20near%20NGET%20equipment.pdf Further guidance related to underground cables can also be found at <https://www.nationalgrid.com/sites/default/files/documents/8589936512-Excavating%20Safety%20Leaflet%20Electricity.pdf>

Excavating Safely - Avoiding injury when working near gas pipes:

http://www.nationalgrid.com/NR/rdonlyres/2D2EEA97-B213-459C-9A26-18361C6E0B0D/25249/Digsafe_leaflet3e2finalamends061207.pdf

Standard Guidance

Essential Guidance document:

<http://www2.nationalgrid.com/WorkArea/DownloadAsset.aspx?id=8589934982>

General Guidance document:

<http://www2.nationalgrid.com/WorkArea/DownloadAsset.aspx?id=35103>

Excavating Safely in the vicinity of gas pipes guidance (Credit card):

<http://www.nationalgrid.com/NR/rdonlyres/A3D37677-6641-476C-9DDA-E89949052829/44257/ExcavatingSafelyCreditCard.pdf>

Excavating Safely in the vicinity of electricity cables guidance (Credit card):



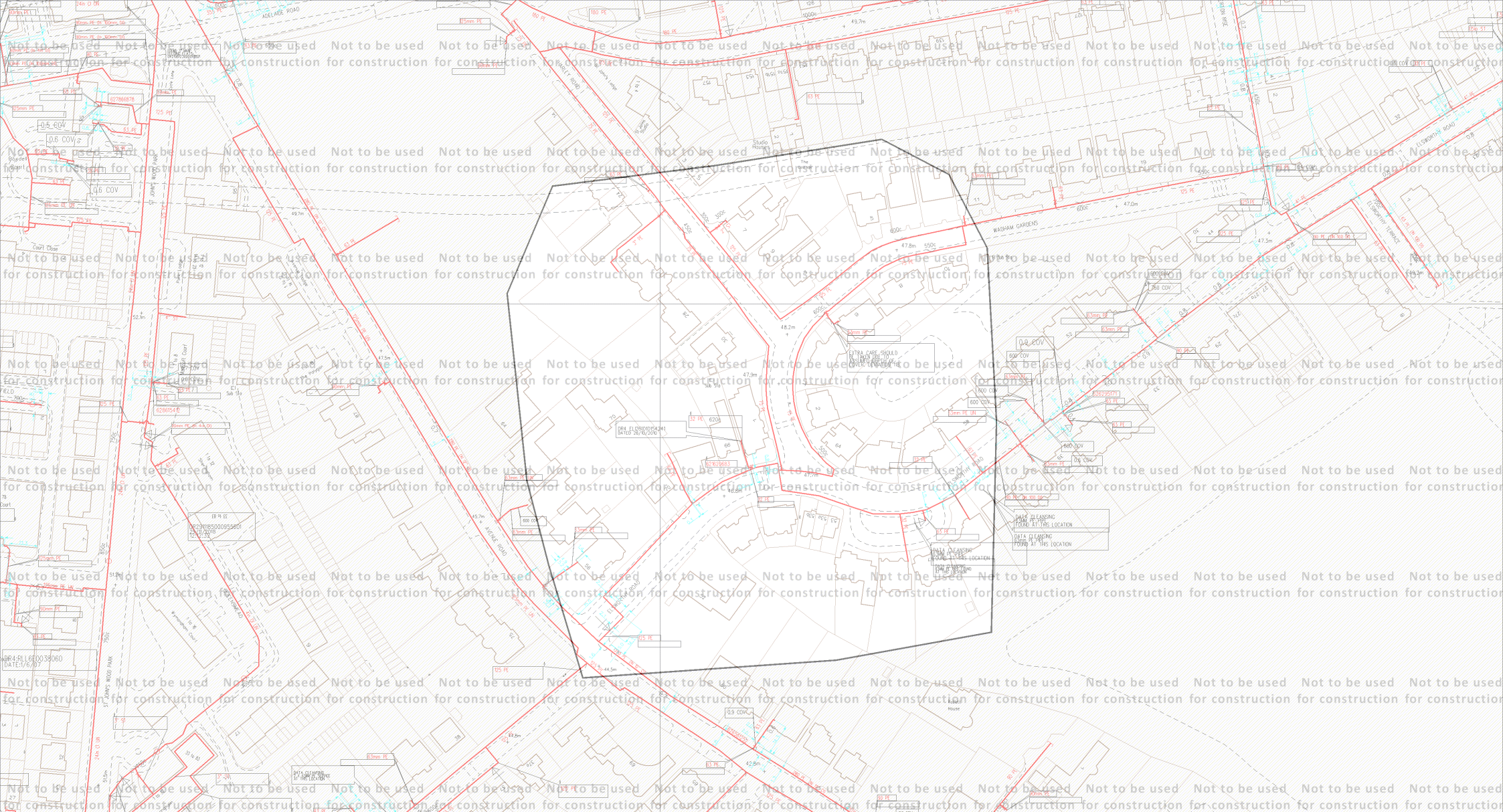

<http://www.nationalgrid.com/NR/rdonlyres/35DDEC6D-D754-4BA5-AF3C-D607D05A25C2/44858/ExcavatingSafelyCreditCardelectricitycables.pdf>

Copies of all the Guidance Documents can also be downloaded from the [National Grid](#) and [Cadent](#) websites.



ID: NL_TE_Z5_3SL_495813-2
 USER: RTD
 DATE: 14/12/2018
 DATA DATE: 13/12/2018
 REF: 71681 - LSBUD-181207-143674
 MAP REF: TQ2783
 CENTRE: 527044, 183950

View extent: 723m, 393m

LP MAINS 
 MP MAINS 
 IP MAINS 
 LHP MAINS 
 NHP MAINS 

0m  50m
 Approximate scale 1:2500
 on A4 Colour Landscape

Map not to be used for construction

This plan shows those pipes owned by Cadent Gas Limited in its role as a Licensed Gas Transporter (GT). Gas pipes owned by other GTs, or otherwise privately owned, may be present in this area. Information with regard to such pipes should be obtained from the relevant owners. The information shown on this plan is given without warranty, the accuracy thereof cannot be guaranteed. Service pipes, valves, syphons, stub connections, etc., are not shown but their presence should be anticipated. No liability of any kind whatsoever is accepted by Cadent Gas Limited or their agents, servants or contractors for any error or omission. Safe digging practices, in accordance with HS(G)47, must be used to verify and establish the actual position of mains, pipes, services and other apparatus on site before any mechanical plant is used. It is your responsibility to ensure that this information is provided to all persons (either direct labour or contractors) working for you on or near gas apparatus. The information included on this plan should not be referred to beyond a period of 28 days from the date of issue.

Map 1 of 2 (GAS)

MAPS Plot Server Version 1.11.0









Cadent
Your Gas Network

Requested by: Atkins Limited



This plan is reproduced from or based on the OS map by Cadent Gas Limited, with the sanction of the controller of HM Stationery Office. Crown Copyright Reserved. Ordnance Survey Licence number 100024886

Some examples of Plant items:

Valve  Depth of Cover  Syphon  Diameter Change  Material Change  Out of Standard Service 



ID: NL_TE_Z5_3SL_495813-2
 USER: RTD
 DATE: 14/12/2018
 DATA DATE: 20/08/2018
 REF: 71681 - LSBUD-181207-143674
 MAP REF: TQ2783
 CENTRE: 527044, 183950

View extent: 2890m, 1570m
 Underground cables 
 Overhead lines 
 0m  200m
 Approximate scale 1:10000
 on A4 Colour Landscape

Map not to be used for construction

This plan shows those cables owned by National Grid Electricity Transmission plc in its role as a Licensed Electricity Transporter (ET). Electricity cables owned by other ETs, or otherwise privately owned, may be present in this area. Information with regard to such cables should be obtained from the relevant owners. The information shown on this plan is given without warranty, the accuracy thereof cannot be guaranteed. Ancillary equipment such as cooling systems and communication cables are not shown but their presence should be anticipated. No liability of any kind whatsoever is accepted by National Grid Electricity Transmission plc or their agents, servants or contractors for any error or omission. Safe digging practices, in accordance with HS(G)47, must be used to verify and establish the actual position of cables and other apparatus on site before any mechanical plant is used. It is your responsibility to ensure that this information is provided to all persons (either direct labour or contractors) working for you on or near electricity apparatus. The information included on this plan should not be referred to beyond a period of 28 days from the date of issue.

Map 2 of 2 (ELECTRIC)
 MAPS Plot Server Version 1.11.0

 Requested by: Atkins Limited
 This plan is reproduced from or based on the OS map by National Grid Electricity Transmission plc, with the sanction of the controller of HM Stationery Office. Crown Copyright Reserved. Ordnance Survey Licence number 100024241

ENQUIRY SUMMARY

Received Date

14/12/2018

Your Reference

71681 - LSBUD-181207-14367497

Location

Centre Point: 527044, 183950

X Extent: 236

Y Extent: 260

Postcode: NW3 3BP

Location Description: Site off Wadham Gardens, London

Map Options

Paper Size: A4

Orientation: LANDSCAPE

Requested Scale: 2500

Actual Scale: 1:2500 (GAS), 1:10000 (ELECTRIC)

Real World Extents: 723m x 393m (GAS), 2890m x 1570m (ELECTRIC)

Recipients

stat.enquiries@atkinsglobal.com

Enquirer Details

Organisation Name: Atkins Limited

Contact Name: Chrissy Elliott

Email Address: stat.enquiries@atkinsglobal.com

Telephone: 01454662397 (01454662397)

Address: The Hub, 500 Park Avenue, Aztec West, Almondsbury, Bristol, BS32 4RZ

Description of Works

Building Works - Low Rise

Enquiry Type

Proposed Works

Activity Type

Small-scale Construction

Work Types

Work Type: Plans Only

THIS DOCUMENT IS FOR VIEWING PURPOSES ONLY - NOT TO BE TREATED AS THE MASTER DRAWING

FDR1. 'Y' PHASE SERVING FAULT
20.5.66. DUE TO WATER IN JOINT
BOX.

FACING MILL HILL

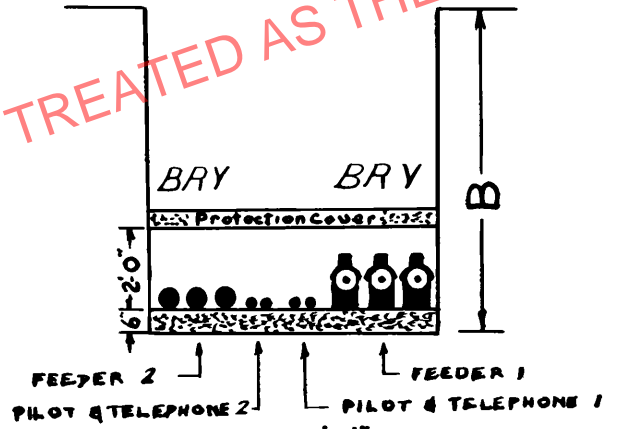
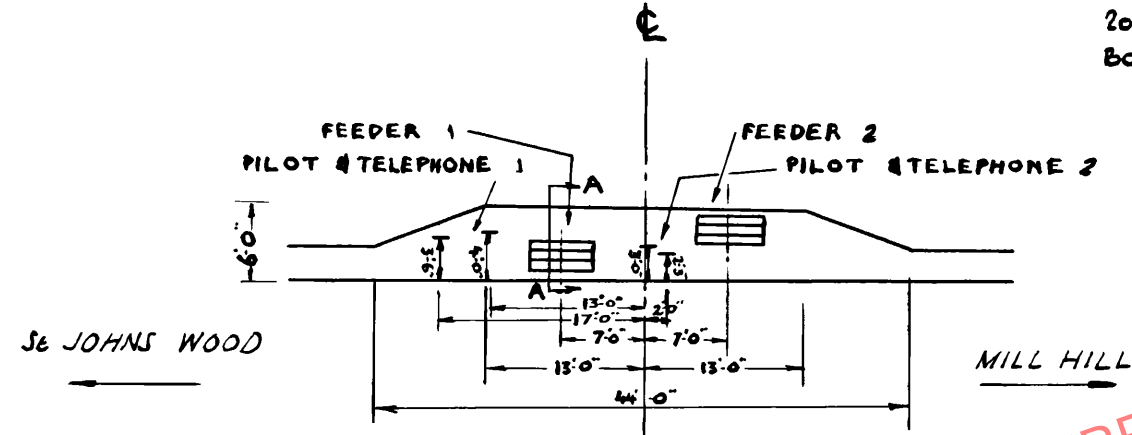

J
B
5
6

JOINTERS NAME:- FDRS. 1+2 PILOT+TELE.
T. CLARK B. LEEKS
WEATHER :- DRY

SCALE 1/6" = 1'

SCALE 4" = 1'
CROSS SECTION ON A-A B=6'3"

70/16948 SHT76

THIS DOCUMENT IS FOR VIEWING PURPOSES ONLY - NOT TO BE TREATED AS THE MASTER DRAWING

NOTE:- FEEDER NO 1 Bφ NEW BOX
 APPLIED MILL HILL SIDE OF
 JOINT ABOVE OIL NIPPLE JUNE.68.

FACING MILL HILL

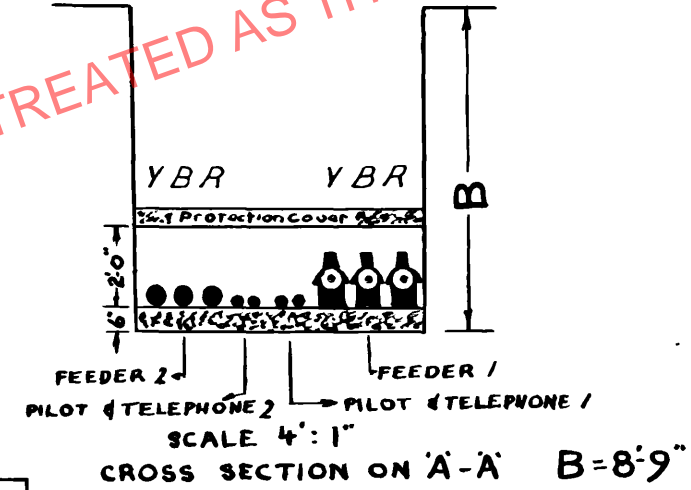
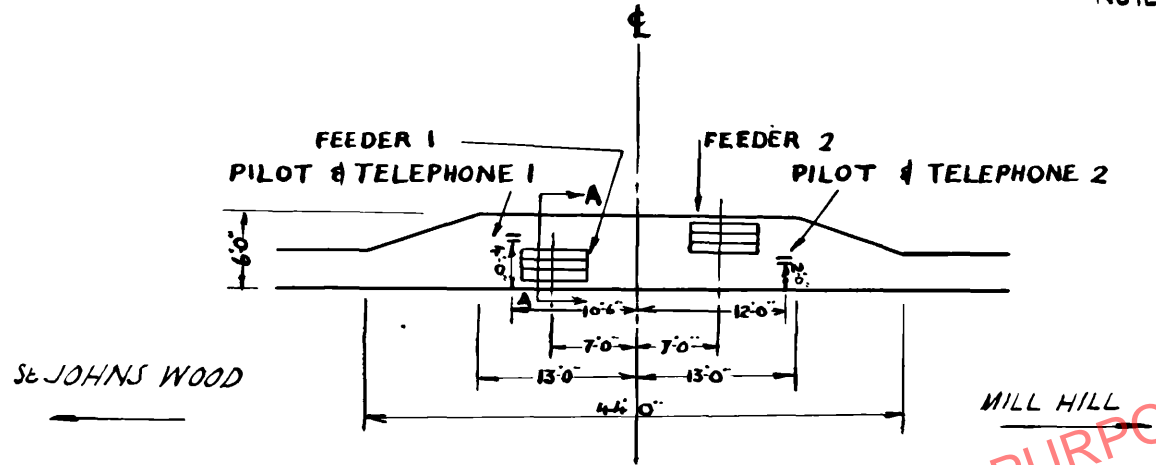

J
B
6
7

JOINTERS NAME :- FDRS 1 & 2 PILOT & TELE.
 T. CLARK
 WEATHER :- DRY.

SCALE 16' : 1"

70/16948 SHT82

THIS DOCUMENT IS FOR VIEWING PURPOSES ONLY - NOT TO BE TREATED AS THE MASTER DRAWING

NOTES:

FEEDER TWO ALL PHASES REFURBISHED. TO SPECIFICATION TGN <T> 100. PCCo 17-1-2000.

FEEDER TWO RED PHASE SERVING FAULT ON EARTH BOND RESIN REPAIR FITTED. PCCo 5-2-2000.

2 M FROM JOINTS ON YELLOW PHASE (SWISS COTTAGE SIDE) RING CUT OUT FOR FREEZE. RESIN REPAIR TO CABLE. PCCo 24-1-2000.

FEEDER ONE ALL JOINT BOX LIDS REMOVED TO INSPECT COMPOUND FOR OIL LEAKS FOUND TO BE OK. PCCo 7-2-2000.

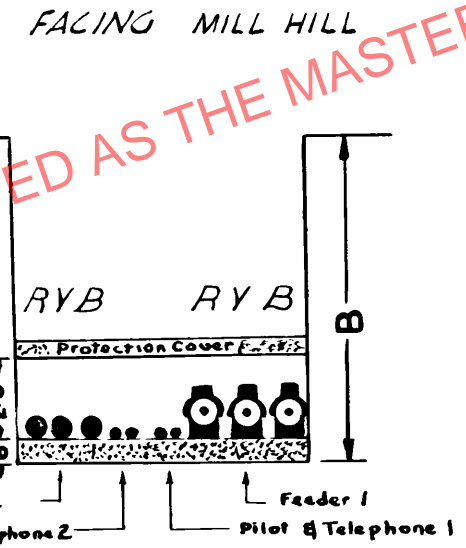
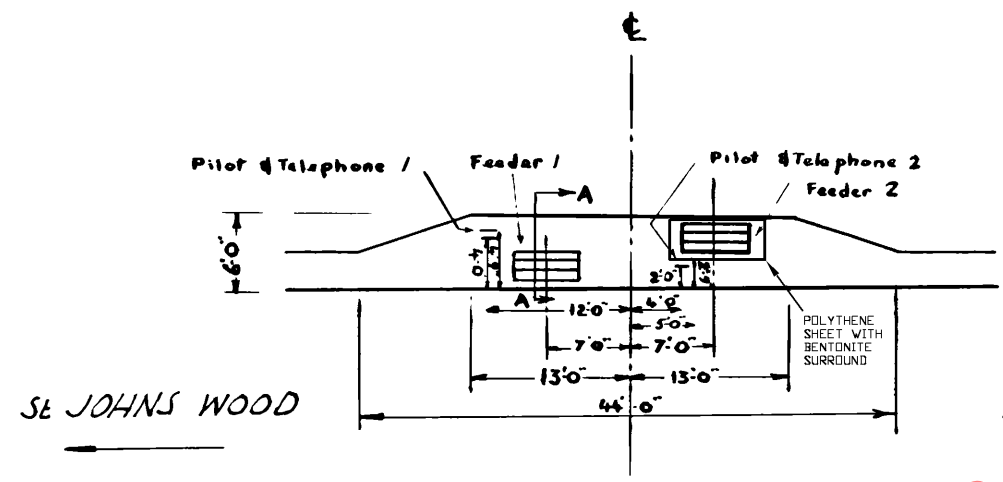

SE JOHNS WOOD

MILL HILL

J/B. 7/8

SCALE 16:1

JOINTERS NAME:- FDRS PILOT of TELE. T. CLARK. WEATHER:- DRY.

Scale 4":1"

CROSS SECTION ON A-A B=6'6"

70/16948 SHT89

REV	1	J.M.M
		25-6-70

THIS DOCUMENT IS FOR VIEWING PURPOSES ONLY - NOT TO BE TREATED AS THE MASTER DRAWING

FEEDER N°1.

- A.) ALL THREE PHASES BROKEN DOWN & REMADE JANUARY 97 BY D.GLOVER .
- B.) YØ LEAD SPLIT ST. JOHNS WOOD SIDE OF JOINT BY THE PLUMB 4" LEAD SAMPLE TAKEN & REPLACED WITH COPPER SLEEVE BY D.GLOVER - JANUARY 97.
- C.) SERVING REPAIRS CARRIED OUT ON R & BØ BONDING LEADS 5" FROM CORNER OF LINK BOX BY D. GLOVER ~ JANUARY 97.
- D.) R & YØ JOINT BOXES REFIRBISHED INCLUDING RESIN REINFORCEMENT @ BOTH ENDS. BY D. GLOVER 8.11.89.
- E.) BØ CHECKED & TOPPED UP 8.11.89.
- F.) LINK BOX STOLEN ~ REPLACED WITH REFIRBISHED BOX. ALL BONDS EXTENDED INTO NEW BOX BY D.GLOVER ON 22.11.89

FEEDER N°2.

- A.) R & YØ JOINT BOXES REFIRBISHED INCLUDING RESIN REINFORCEMENT @ BOTH ENDS BY D. GLOVER - 18/20.11.89.
- B.) BØ CHECKED & TOPPED UP ~ 18/20.11.89.
- C.) LINK BOX STOLEN ~ REPLACED WITH NEW BOX ALL BONDS EXTENDED INTO NEW BOX BY D. GLOVER ON 22.11.89.

THIS DOCUMENT IS FOR VIEWING PURPOSES ONLY - NOT TO BE TREATED AS THE MASTER DRAWING

THIS DOCUMENT IS FOR VIEWING PURPOSES ONLY - NOT TO BE TREATED AS THE MASTER DRAWING

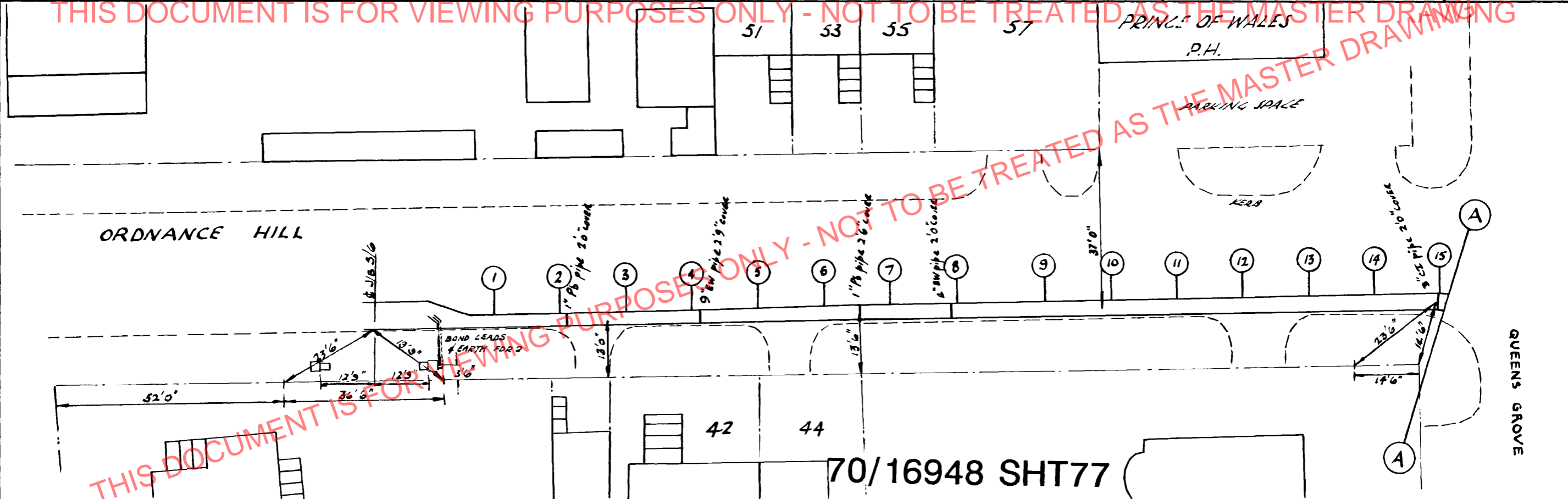

70/16948 SHT77

THIS DOCUMENT IS FOR VIEWING PURPOSES ONLY - NOT TO BE TREATED AS THE MASTER DRAWING

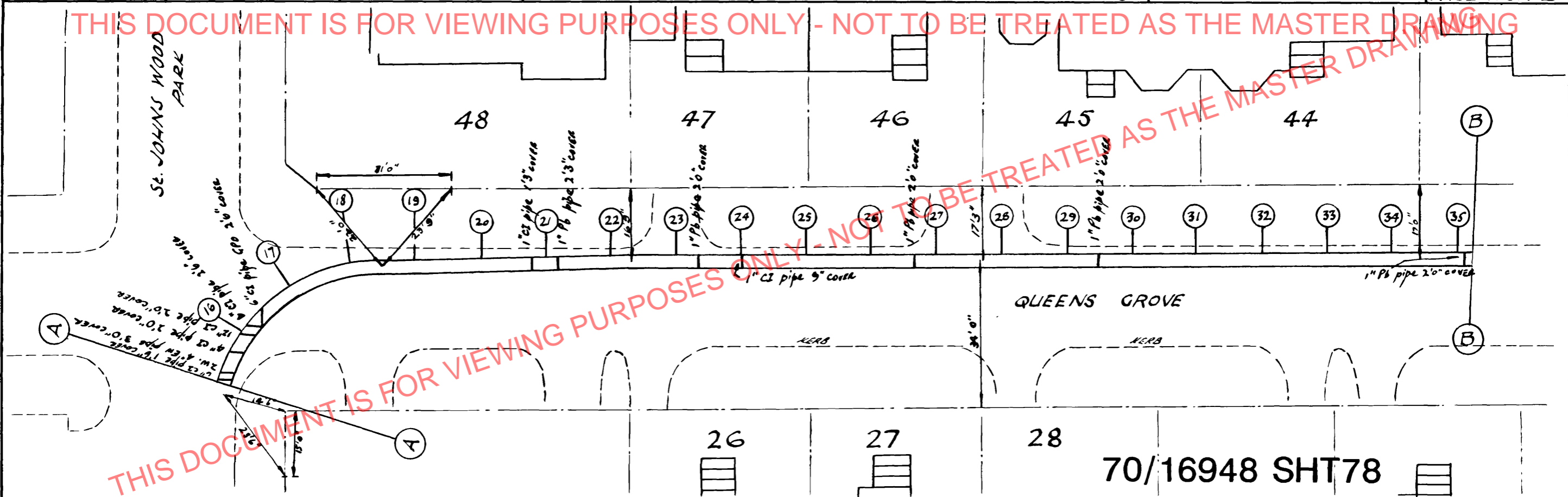

THIS DOCUMENT IS FOR VIEWING PURPOSES ONLY - NOT TO BE TREATED AS THE MASTER DRAWING

70/16948 SHT78

THIS DOCUMENT IS FOR VIEWING PURPOSES ONLY - NOT TO BE TREATED AS THE MASTER DRAWING

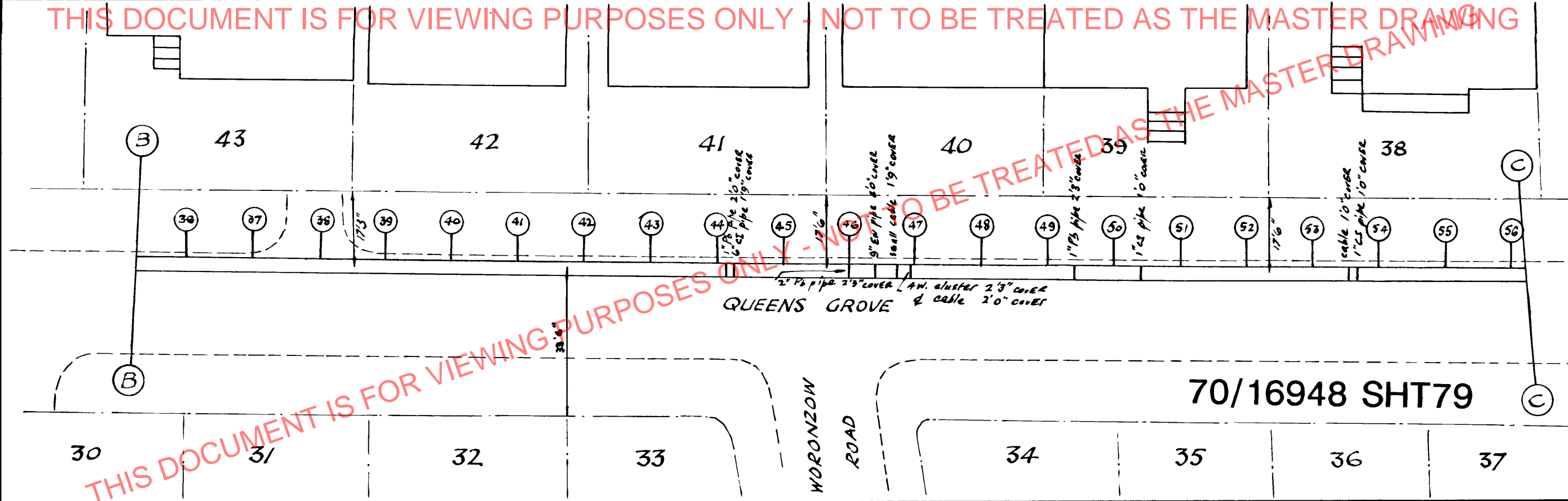

THIS DOCUMENT IS FOR VIEWING PURPOSES ONLY - NOT TO BE TREATED AS THE MASTER DRAWING

THIS DOCUMENT IS FOR VIEWING PURPOSES ONLY - NOT TO BE TREATED AS THE MASTER DRAWING

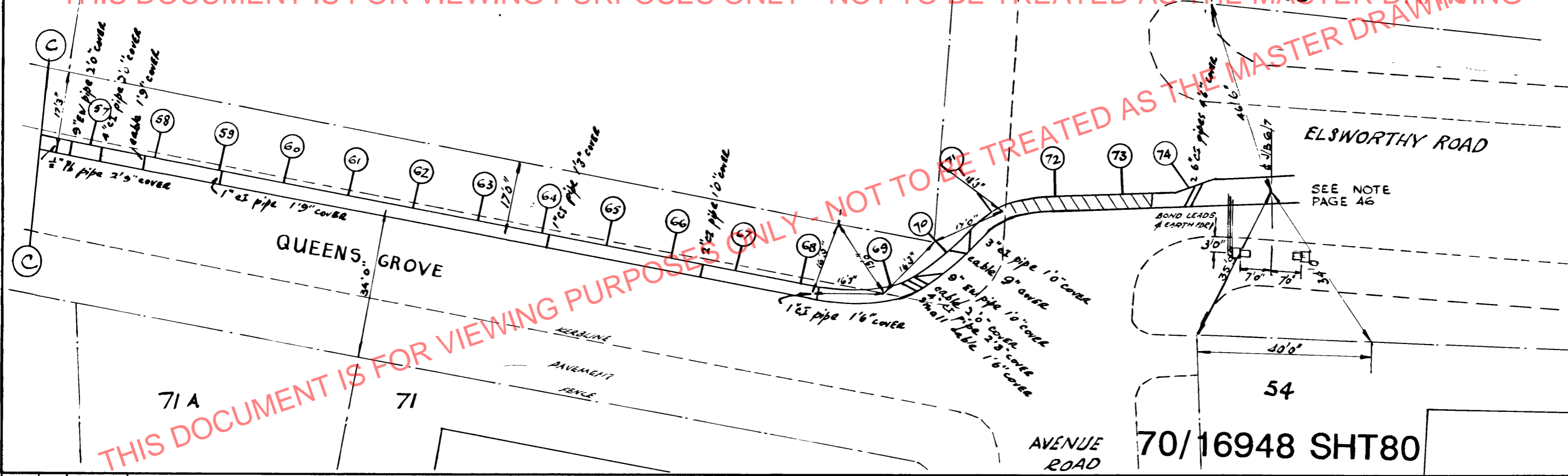

70/16948 SHT 80

FACING ST. JOHNS WOOD.

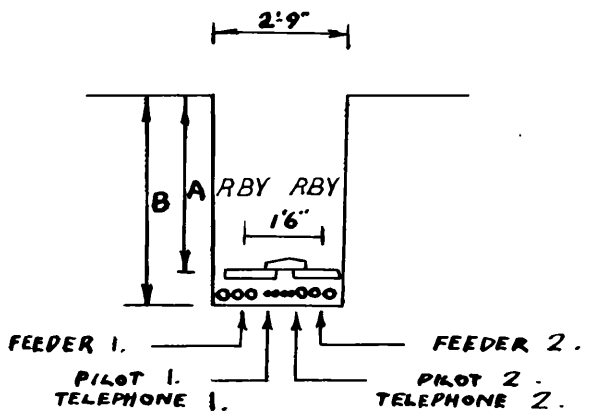

C/S	1	2	3	4	5	6	7	8	9	10	11	12	13	14	15	16	17	18	19	20
A	4'-3"	4'-3"	4'-3"	4'-3"	4'-0"	4'-0"	4'-0"	4'-0"	4'-0"	4'-0"	4'-0"	4'-0"	4'-0"	4'-0"	4'-3"	4'-3"	4'-6"	4'-9"	4'-0"	4'-0"
B	5'-0"	5'-0"	5'-0"	5'-0"	4'-9"	4'-9"	4'-9"	4'-9"	4'-9"	4'-9"	4'-9"	4'-9"	4'-9"	4'-9"	5'-0"	5'-0"	5'-3"	5'-6"	4'-9"	4'-9"
C/S	21	22	23	24	25	26	27	28	29	30	31	32	33	34	35	36	37	38	39	40
A	3'-9"	3'-9"	3'-9"	3'-9"	3'-9"	3'-6"	3'-6"	3'-6"	3'-6"	3'-6"	3'-6"	3'-6"	3'-6"	3'-6"	3'-6"	3'-6"	3'-6"	3'-9"	3'-9"	3'-9"
B	4'-6"	4'-6"	4'-6"	4'-6"	4'-6"	4'-3"	4'-3"	4'-3"	4'-3"	4'-3"	4'-3"	4'-3"	4'-3"	4'-3"	4'-3"	4'-3"	4'-3"	4'-6"	4'-6"	4'-6"
C/S	41	42	43	44	45	46	47	48	49	50	51	52	53	54	55	56	57	58	59	60
A	3'-9"	3'-9"	4'-0"	4'-0"	4'-0"	5'-0"	5'-0"	4'-9"	4'-3"	4'-3"	4'-3"	4'-0"	4'-0"	4'-0"	4'-0"	4'-0"	3'-9"	3'-9"	3'-9"	3'-9"
B	4'-6"	4'-6"	4'-9"	4'-9"	4'-9"	5'-9"	5'-9"	5'-6"	5'-0"	5'-0"	5'-0"	4'-9"	4'-9"	4'-9"	4'-9"	4'-9"	4'-6"	4'-6"	4'-6"	4'-6"
C/S	61	62	63	64	65	66	67	68	69	70	71	74								
A	3'-9"	3'-9"	3'-9"	3'-9"	3'-6"	3'-6"	3'-6"	3'-9"	3'-9"	4'-0"	4'-6"	6'-3"								
B	4'-6"	4'-6"	4'-6"	4'-6"	4'-3"	4'-3"	4'-3"	4'-6"	4'-6"	4'-9"	5'-3"	7'-0"								

THIS DOCUMENT IS FOR VIEWING PURPOSES ONLY - NOT TO BE TREATED AS THE MASTER DRAWING

70/16948 SHT81

THIS DOCUMENT IS FOR VIEWING PURPOSES ONLY - NOT TO BE TREATED AS THE MASTER DRAWING

FACING MILL HILL

c/s	72	73
A	7'-0"	7'-0"
D	4'-9"	4'-9"

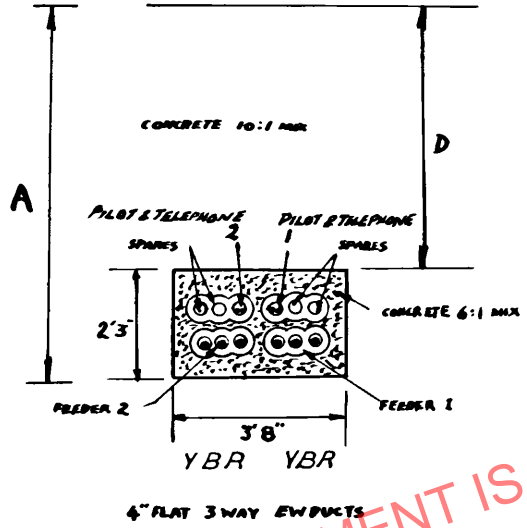

THIS DOCUMENT IS FOR VIEWING PURPOSES ONLY - NOT TO BE TREATED AS THE MASTER DRAWING

70/16948 SHT83

THIS DOCUMENT IS FOR VIEWING PURPOSES ONLY - NOT TO BE TREATED AS THE MASTER DRAWING

ROAD
AVENUE

ELSWORTHY ROAD.

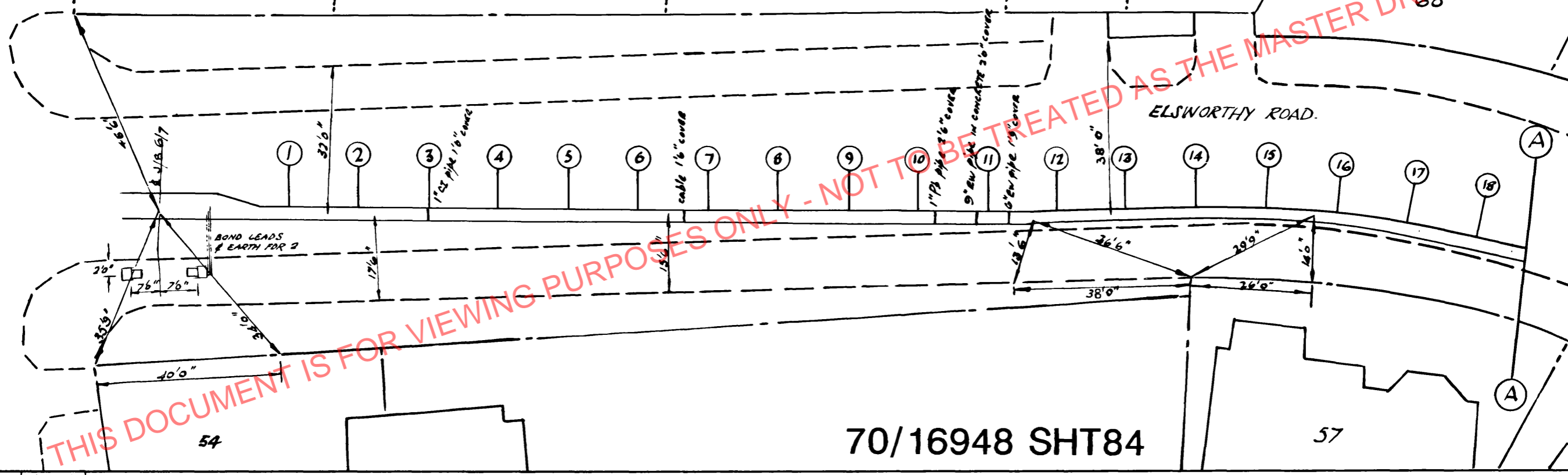

70/16948 SHT84

REV.	1	J.M.M.
		25.6.70

THIS DOCUMENT IS FOR VIEWING PURPOSES ONLY - NOT TO BE TREATED AS THE MASTER DRAWING

THIS DOCUMENT IS FOR VIEWING PURPOSES ONLY - NOT TO BE TREATED AS THE MASTER DRAWING

ELSWORTHY ROAD.

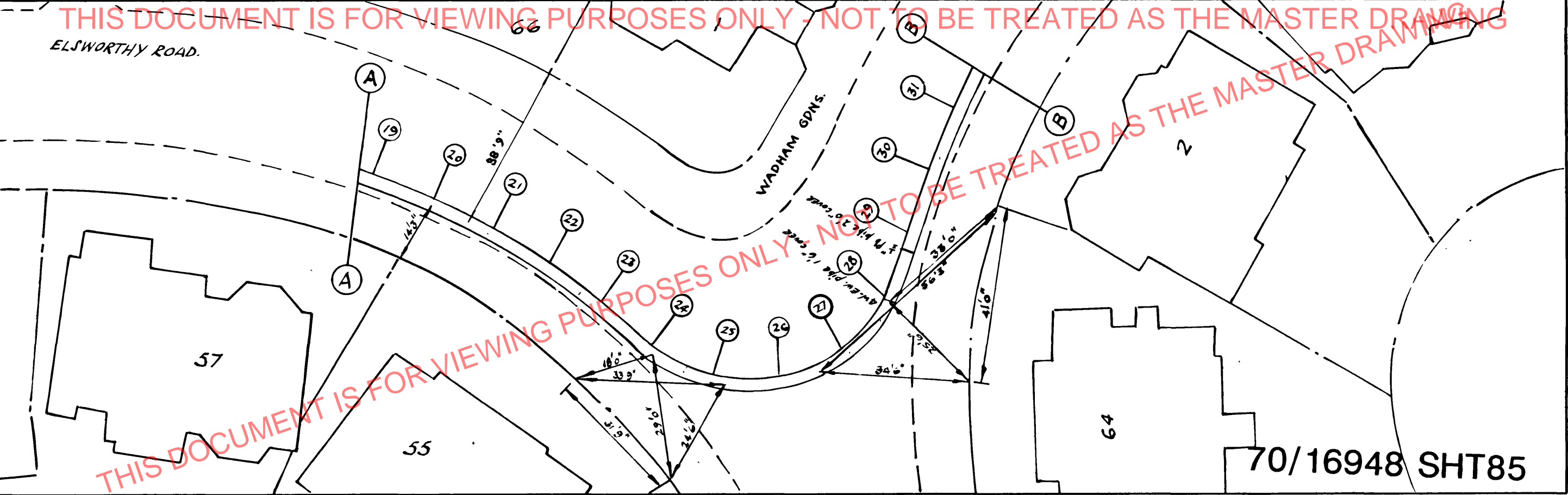

THIS DOCUMENT IS FOR VIEWING PURPOSES ONLY - NOT TO BE TREATED AS THE MASTER DRAWING

70/16948 SHT85

THIS DOCUMENT IS FOR VIEWING PURPOSES ONLY - NOT TO BE TREATED AS THE MASTER DRAWING

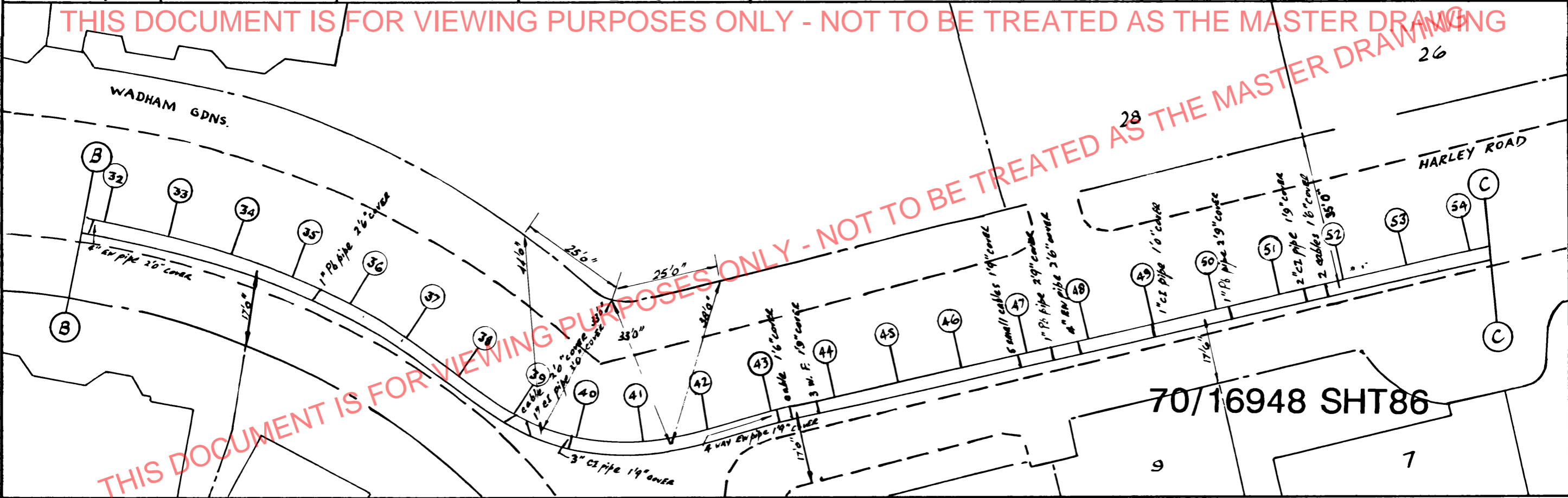

70/16948 SHT86

REV.	1	JMM
		25 6-70

THIS DOCUMENT IS FOR VIEWING PURPOSES ONLY - NOT TO BE TREATED AS THE MASTER DRAWING

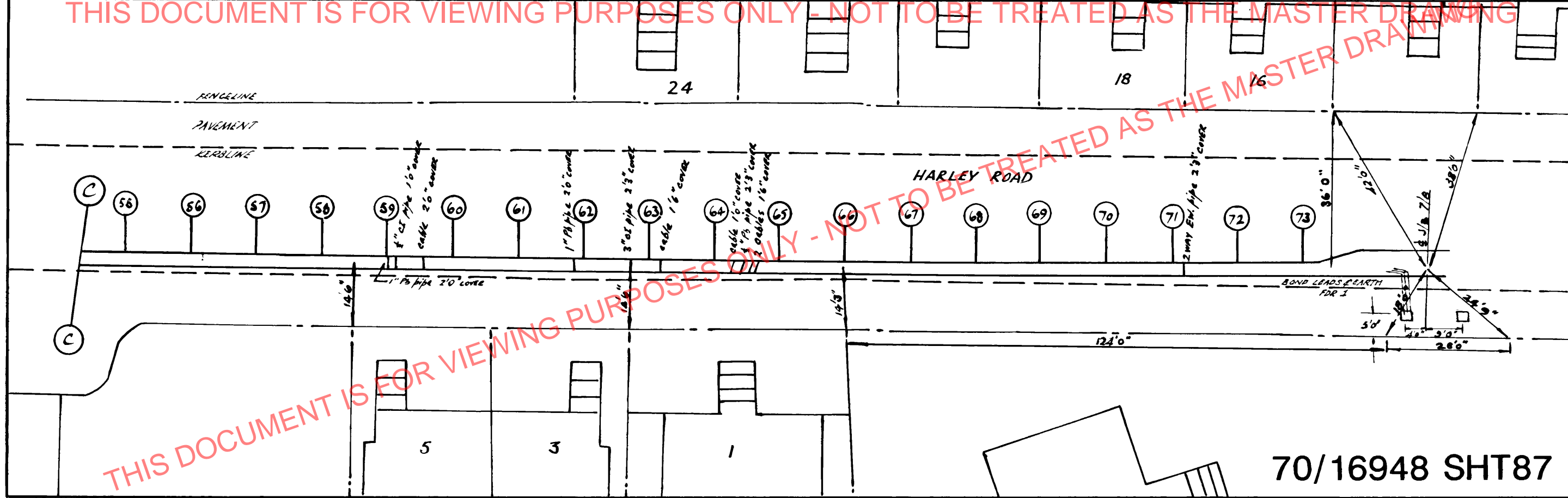

THIS DOCUMENT IS FOR VIEWING PURPOSES ONLY - NOT TO BE TREATED AS THE MASTER DRAWING

70/16948 SHT87

THIS DOCUMENT IS FOR VIEWING PURPOSES ONLY - NOT TO BE TREATED AS THE MASTER DRAWING

FACING ST. JOHNS WOOD.

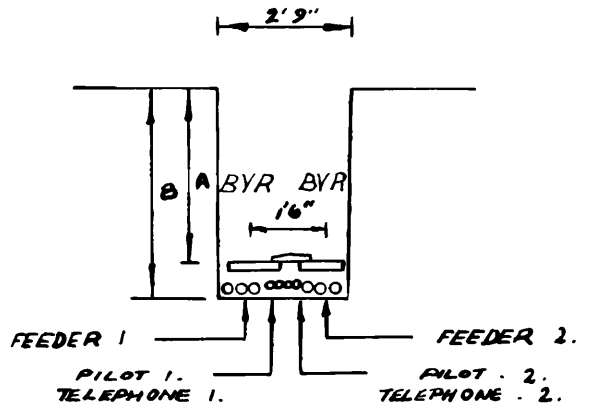

qs.	1	2	3	4	5	6	7	8	9	10	11	12	13	14	15	16	17	18	19	20
A	8' 0"	6' 9"	5' 0"	4' 3"	3' 6"	3' 3"	3' 3"	3' 3"	3' 6"	3' 6"	3' 6"	3' 9"	3' 6"	3' 6"	3' 6"	3' 6"	3' 6"	3' 6"	3' 6"	3' 6"
B	8' 9"	7' 6"	5' 9"	5' 0"	4' 3"	4' 0"	4' 0"	4' 0"	4' 3"	4' 3"	4' 3"	4' 6"	4' 3"	4' 3"	4' 3"	4' 3"	4' 3"	4' 3"	4' 3"	4' 3"
C/S.	21	22	23	24	25	26	27	28	29	30	31	32	33	34	35	36	37	38	39	40
A	3' 6"	3' 6"	3' 6"	3' 9"	3' 9"	3' 9"	4' 6"	4' 3"	4' 3"	4' 0"	3' 9"	3' 6"	3' 6"	3' 6"	3' 6"	3' 6"	3' 6"	3' 6"	3' 6"	3' 6"
B	4' 3"	4' 3"	4' 3"	4' 6"	4' 6"	4' 6"	5' 3"	5' 0"	5' 0"	4' 9"	4' 6"	4' 3"	4' 3"	4' 3"	4' 3"	4' 3"	4' 3"	4' 3"	4' 3"	4' 3"
C/S.	41	42	43	44	45	46	47	48	49	50	51	52	53	54	55	56	57	58	59	60
A	3' 6"	3' 6"	3' 6"	3' 9"	3' 9"	3' 9"	3' 9"	3' 9"	3' 6"	3' 6"	3' 6"	3' 6"	3' 6"	3' 6"	3' 6"	3' 6"	3' 6"	3' 6"	3' 9"	3' 9"
B	4' 3"	4' 3"	4' 3"	4' 6"	4' 6"	4' 6"	4' 6"	4' 6"	4' 3"	4' 3"	4' 3"	4' 3"	4' 3"	4' 3"	4' 3"	4' 3"	4' 3"	4' 3"	4' 6"	4' 6"
C/S.	61	62	63	64	65	66	67	68	69	70	71	72	73							
A	3' 9"	3' 9"	3' 6"	3' 6"	3' 6"	3' 6"	3' 6"	3' 9"	3' 9"	3' 9"	4' 0"	4' 6"	5' 9"							
B	4' 6"	4' 6"	4' 3"	4' 3"	4' 3"	4' 3"	4' 3"	4' 6"	4' 6"	4' 6"	4' 9"	5' 3"	6' 6"							

THIS DOCUMENT IS FOR VIEWING PURPOSES ONLY - NOT TO BE TREATED AS THE MASTER DRAWING

70/16948 SHT88

REV	1	JMM	REV.	2.	N.M.
		25 6 70			22-4-99

THIS DOCUMENT IS FOR VIEWING PURPOSES ONLY - NOT TO BE TREATED AS THE MASTER DRAWING

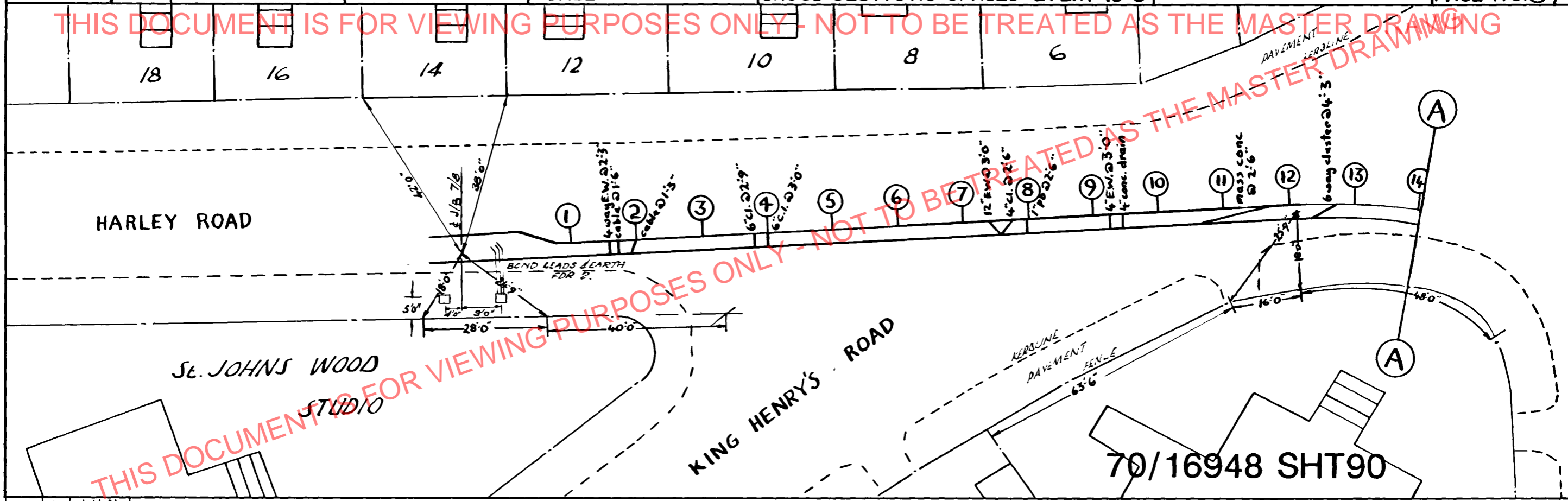

THIS DOCUMENT IS FOR VIEWING PURPOSES ONLY - NOT TO BE TREATED AS THE MASTER DRAWING

REV	1	JMM
	25	6 70

70/16948 SHT90

THIS DOCUMENT IS FOR VIEWING PURPOSES ONLY - NOT TO BE TREATED AS THE MASTER DRAWING

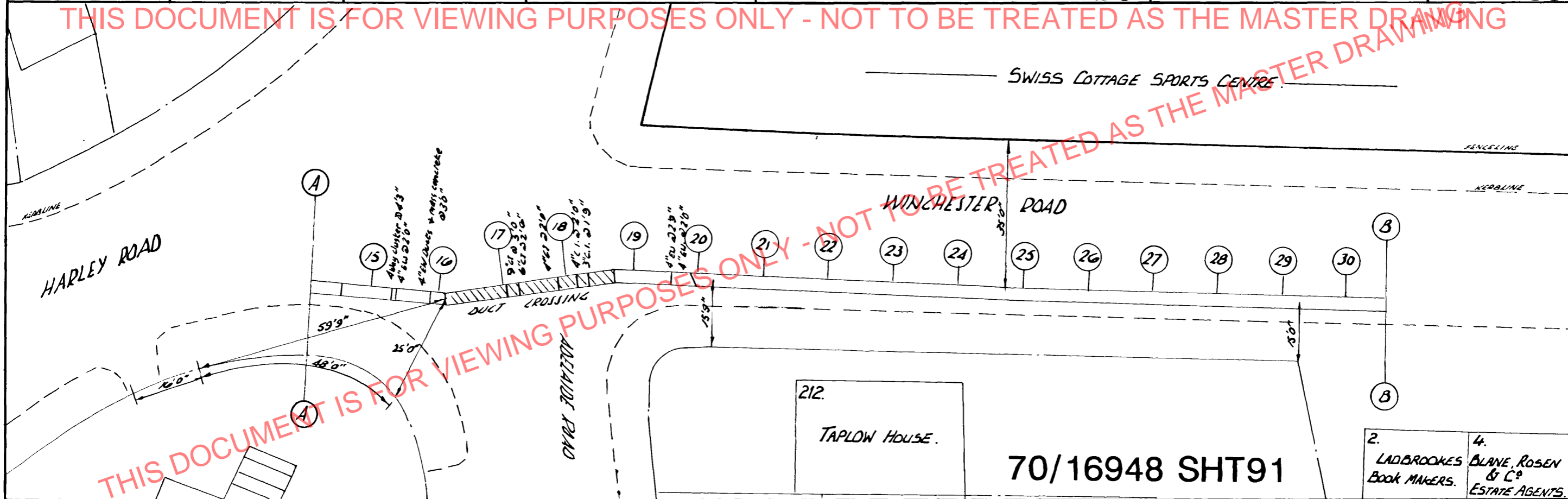

70/16948 SHT91

2. LADBROOKES BOOK MAKERS.	4. BLANE, ROSEN & CO ESTATE AGENTS.
----------------------------------	--

REV. 1	J.M.M. 25.6.70	REV. 2.	N.M. 26.4.99.
--------	-------------------	---------	------------------

THIS DOCUMENT IS FOR VIEWING PURPOSES ONLY - NOT TO BE TREATED AS THE MASTER DRAWING

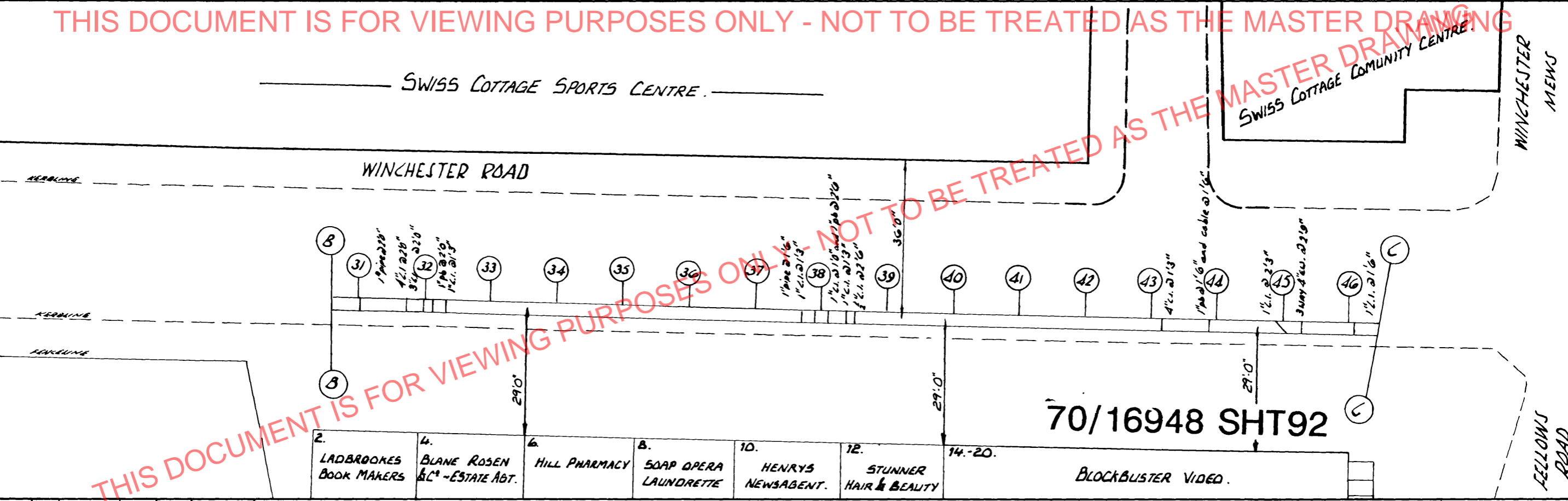

THIS DOCUMENT IS FOR VIEWING PURPOSES ONLY - NOT TO BE TREATED AS THE MASTER DRAWING

REV	1	JMM	25 6 70	REV	2.	N.M.	26-4-89.
-----	---	-----	---------	-----	----	------	----------

THIS DOCUMENT IS FOR VIEWING PURPOSES ONLY - NOT TO BE TREATED AS THE MASTER DRAWING

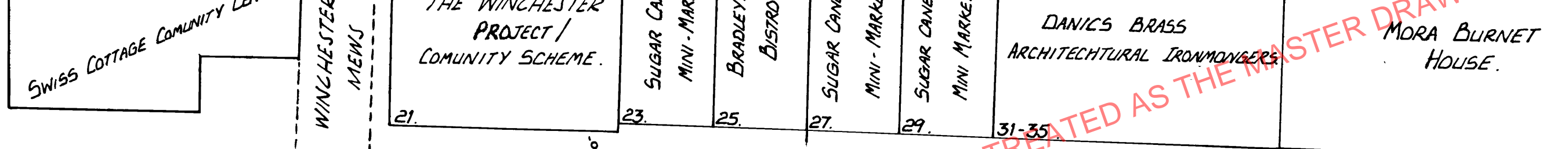

WINCHESTER ROAD

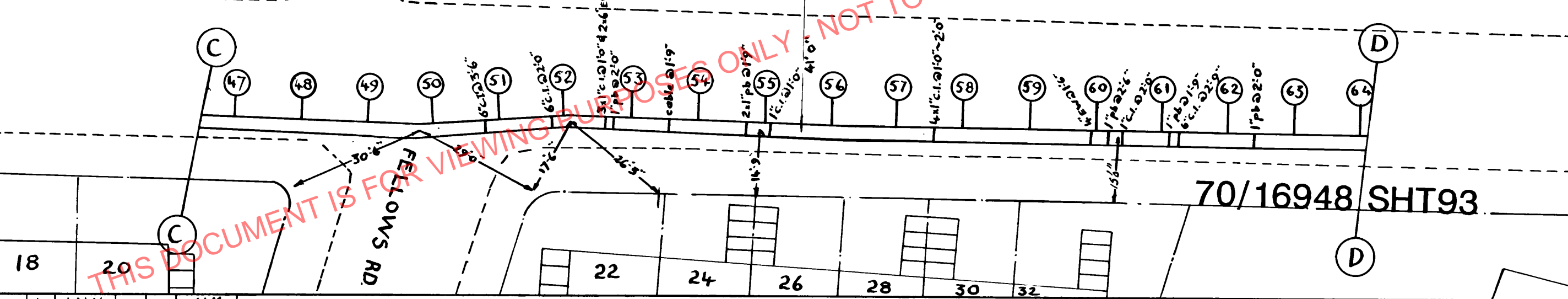

70/16948 SHT93

REV. 1	J.M.M. 25.6.70	REV. 2.	N.M. 26.4.99
--------	-------------------	---------	-----------------

THIS DOCUMENT IS FOR VIEWING PURPOSES ONLY - NOT TO BE TREATED AS THE MASTER DRAWING

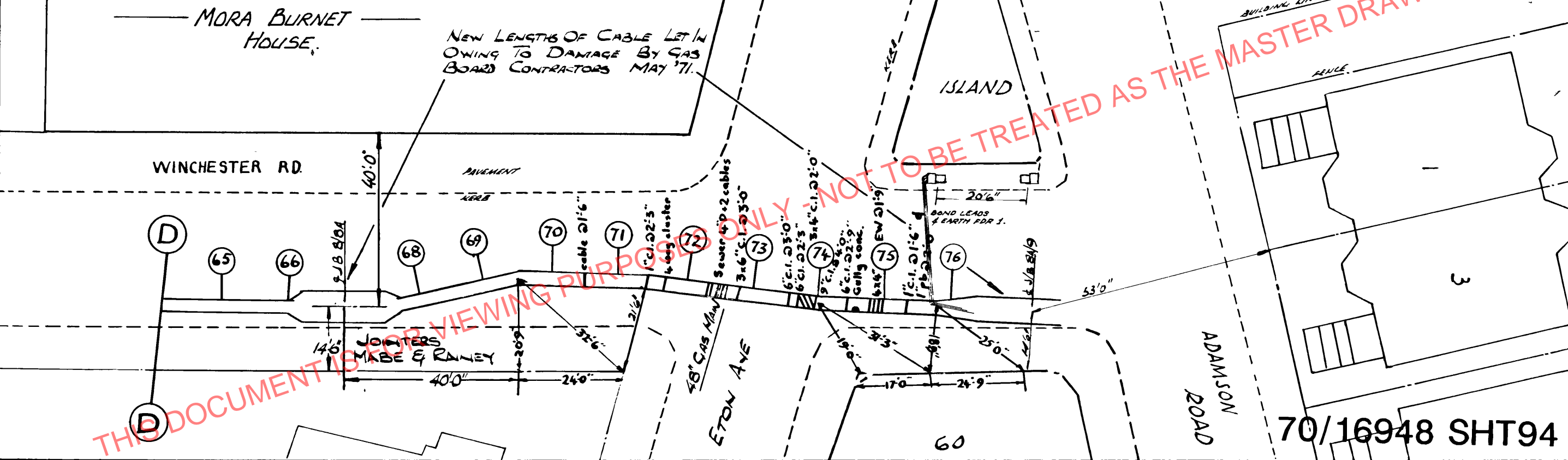

THIS DOCUMENT IS FOR VIEWING PURPOSES ONLY - NOT TO BE TREATED AS THE MASTER DRAWING

70/16948 SHT94

REV	1	JMM	25.6.70	2	DB	21-7-78	REV	3.	N.M.	27.4.99
-----	---	-----	---------	---	----	---------	-----	----	------	---------

THIS DOCUMENT IS FOR VIEWING PURPOSES ONLY - NOT TO BE TREATED AS THE MASTER DRAWING

FACING ST. JOHNS WOOD.

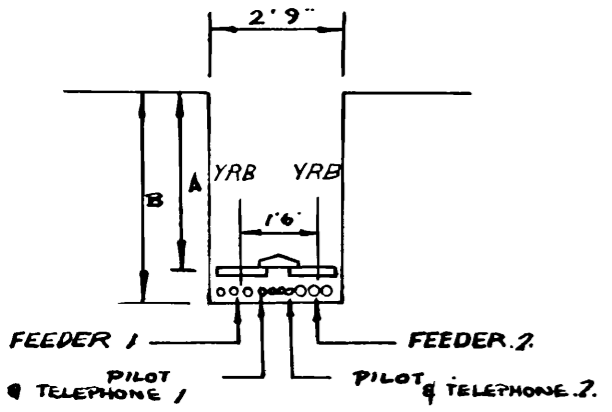

e/s	1	2	3	4	5	6	7	8	9	10	11	12	13	14	15	16	19	20	21	22
A	5'9"	5'9"	5'6"	4'9"	4'6"	4'6"	5'3"	5'3"	5'3"	5'3"	5'3"	5'6"	6'0"	5'9"	5'6"	5'6"	5'9"	5'3"	5'0"	5'0"
B	6'6"	6'6"	6'3"	5'6"	5'3"	5'3"	6'0"	6'0"	6'0"	6'0"	6'0"	6'3"	6'9"	6'6"	6'3"	6'3"	6'6"	6'0"	5'9"	5'9"
c/s	23	24	25	26	27	28	29	30	31	32	33	34	35	36	37	38	39	40	41	42
A	4'9"	4'9"	4'3"	4'0"	4'0"	4'0"	3'9"	3'9"	3'9"	3'9"	3'9"	3'9"	3'9"	3'9"	3'9"	3'9"	3'9"	3'9"	3'9"	3'9"
B	5'6"	5'6"	5'0"	4'9"	4'9"	4'9"	4'6"	4'6"	4'6"	4'6"	4'6"	4'6"	4'6"	4'6"	4'6"	4'6"	4'6"	4'6"	4'6"	4'6"
c/s	43	44	45	46	47	48	49	50	51	52	53	54	55	56	57	58	59	60	61	62
A	3'9"	3'9"	3'9"	3'9"	3'9"	3'9"	4'0"	4'0"	4'3"	4'6"	4'0"	4'0"	4'0"	4'0"	3'9"	3'9"	3'9"	3'9"	3'9"	3'9"
B	4'6"	4'6"	4'6"	4'6"	4'6"	4'6"	4'9"	4'9"	5'0"	5'3"	4'9"	4'9"	4'9"	4'6"	4'6"	4'6"	4'6"	4'6"	4'6"	4'6"
c/s	63	64	65	66	67	68	69	70	71	72	73	74	75	76						
A	3'9"	3'9"	3'9"	3'9"	4'0"	4'0"	4'0"	4'9"	6'3"	7'3"	7'6"	6'3"	6'3"	6'3"						
B	4'6"	4'6"	4'6"	4'6"	4'9"	4'9"	4'9"	5'6"	7'0"	8'0"	8'3"	7'0"	7'0"	7'0"						

THIS DOCUMENT IS FOR VIEWING PURPOSES ONLY - NOT TO BE TREATED AS THE MASTER DRAWING

70/16948 SHT95

THIS DOCUMENT IS FOR VIEWING PURPOSES ONLY - NOT TO BE TREATED AS THE MASTER DRAWING

FACING MILL HILL

C/S	17	18
D	4'3"	4'3"

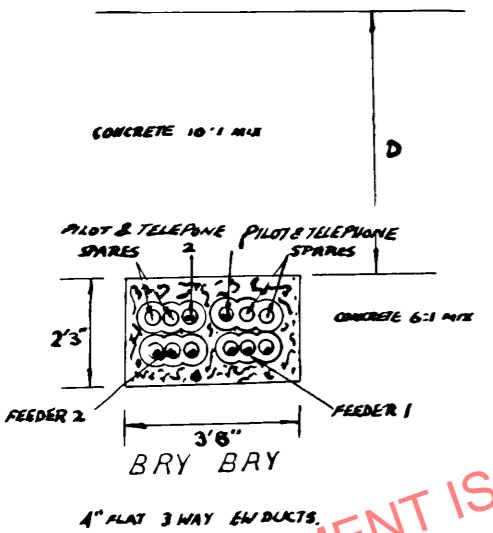

THIS DOCUMENT IS FOR VIEWING PURPOSES ONLY - NOT TO BE TREATED AS THE MASTER DRAWING

70/16948 SHT97