

- Notes
1. This drawing is to be read in conjunction with all relevant Architects and Engineer's drawings and specifications.

2. All workmanship and materials are to comply with Specification, Building Regulations, relevant British Standard and manufacturers recommendations.

3. All dimensions are in mm unless noted. This drawing is not to be scaled.  
For General Notes Refer to drawing 1550-GN01 to GN03

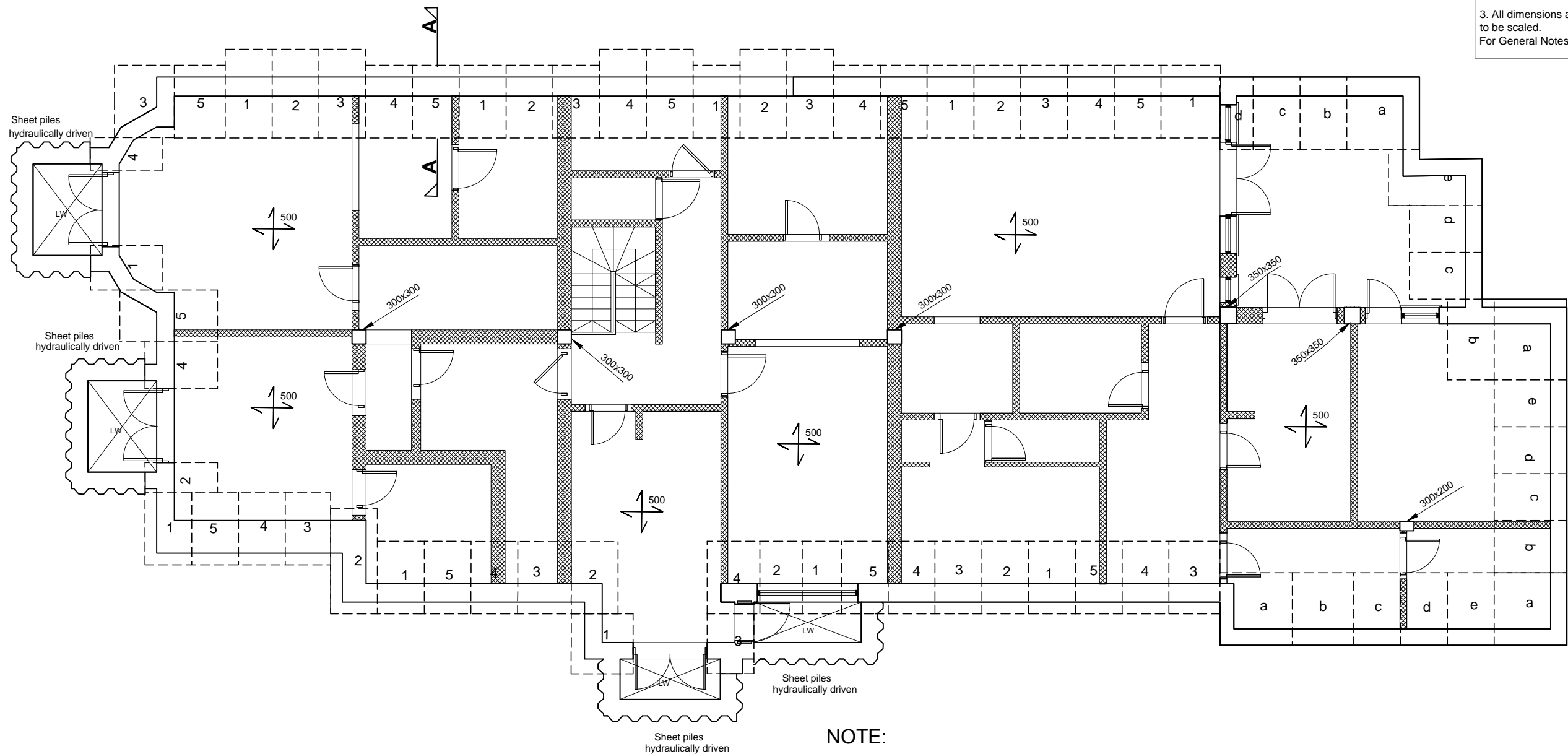

NOTE:  
Piles to be vibrationless press  
in piles. Giken or similar  
Impact driven piles are not  
permitted.

Plan  
(Scale 1: 100)

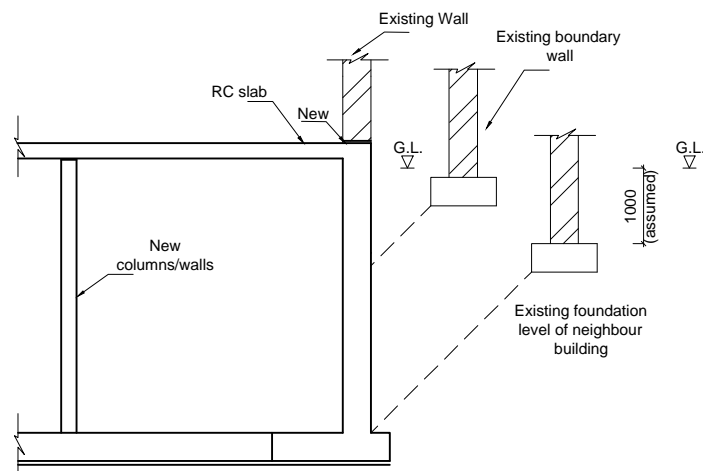

Section A-A



		FOR_PLANNING			
3	17/12/18	Piles noted as press in type	FD	SOH	
2	28/10/15	For planning	CM	SOH	
1	22/10/15	For planning	CM	SOH	
REV	DATE	DESCRIPTION	BY	CHKD	
CLIENT AMEK_PROPERTY_INVESTMENT_LL PROJECT 1_WADHAM_GARDENS LONDON_NW3_3DN TITLE  UNDERGROUND_FLOOR					
DATE OCTOBER_2015 PRODUCED BY CM					
SCALE A1_1:50 A3_1:100 CHECKED SOH					
CAD REF APPROVED					
ORIGINAL DRAWING SIZE A3					
<div>Quadrant Harmon Consulting Ltd.</div> Consulting Civil & Structural Engineers  Morley House 320 Regent Street London W1B 3BD Tel. 020 7637 2770 Fax. 020 7436 7823					
JOB No.  1550			DRAWING No.  02		REV.  3