

For construction purposes:

- All dimensions and levels to be checked on site.
- Discrepancies to be reported to Mitzman Architects before proceeding.
- If in any doubt about information on this drawing contact Mitzman Architects.

| REVISION |          |    |                    |
|----------|----------|----|--------------------|
| NUMBER   | DATE     | BY | NOTES              |
| P1       | 19/12/18 | NE | Issued to planning |

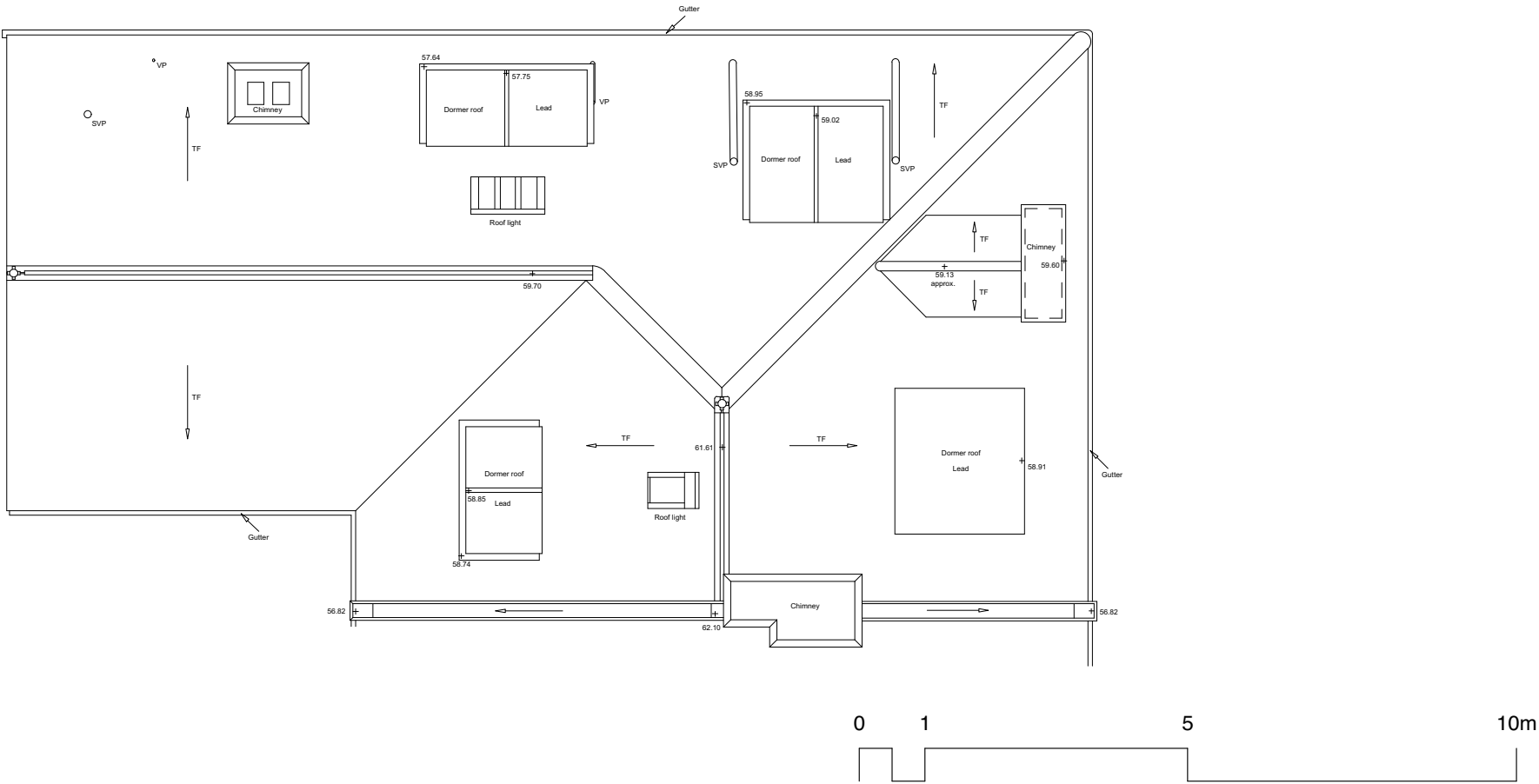

1 Existing Roofplan  
1:100



**M** MITZMAN architects llp  
020 7722 8525 Unit 1 Primrose Mews  
mail@mitzmanarchitects.com Sharpleshall Street  
www.mitzmanarchitects.com London NW1 8YW  
**CLIENT**  
Mr & Mrs A Salter

**PROJECT**  
13 Belsize Lane, London, NW3

**SHEET TITLE**  
Existing Roof Plan

**SCALE**  
1:100@A3

**DATE CREATED** **FILE REFERENCE**

| DRAWING NUMBER  | REVISION |
|-----------------|----------|
| 293-DWG-003-RPb | P1       |