

For construction purposes:

- All dimensions and levels to be checked on site.
- Discrepancies to be reported to Mitzman Architects before proceeding.
- If in any doubt about information on this drawing contact Mitzman Architects.

REVISION NUMBER	DATE	BY	NOTES
P1	19/12/18	NE	Issued to planning

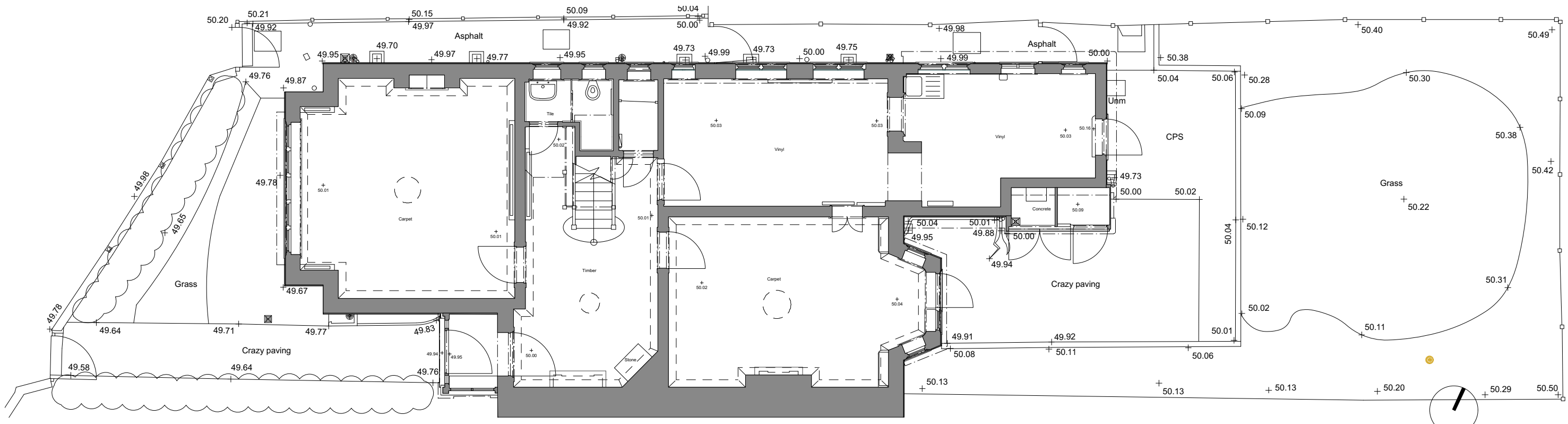

1 Existing Ground Floor Plan
1:100

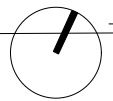
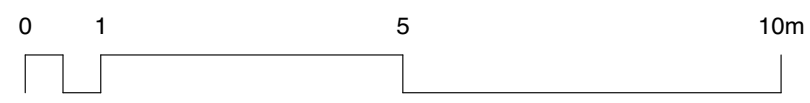

M MITZMAN architects llp
020 7722 8525 Unit 1 Primrose Mews
mail@mitzmanarchitects.com Sharpleshall Street
www.mitzmanarchitects.com London NW1 8YW

CLIENT
Mr & Mrs A Salter

PROJECT
13 Belsize Lane, London, NW3

SHEET TITLE
Existing Ground Floor Plan

SCALE
1:100@A3

DATE CREATED **FILE REFERENCE**

DRAWING NUMBER	REVISION
293-DWG-000-00a	P1