

# Location Plan

Scale 1:2500

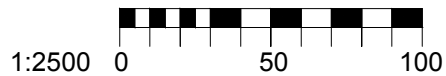
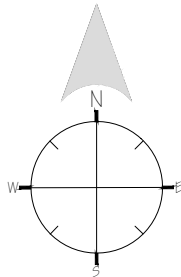

**Proctor Watts Cole Rutter**  
Chartered Architects & Town Planners

Grosvenor House, Bleke Street, Shaftesbury, Dorset, SP7 8AW.  
Phone: 01747 851881 Fax: 01747 851081  
mail@pwcr.co.uk www.pwcr.co.uk

Client: Four Quarters Development Ltd  
Dwg: 17 Wibun Mews, Kentish Town

Drawn By: JP  
Checked By:

Job No:  
4672(18)

Dwg No:  
S66

Notes:

Date: 30 Nov 2018

Scale: 1:2500@A4

**Notes:**  
 This drawing is protected by copyright. No part of this document may be reproduced, altered, or transmitted in any form or by any means without permission.  
 Do not scale off these drawings for construction purposes. If any discrepancies are found, please contact Proctor Watts Cole Rutter.

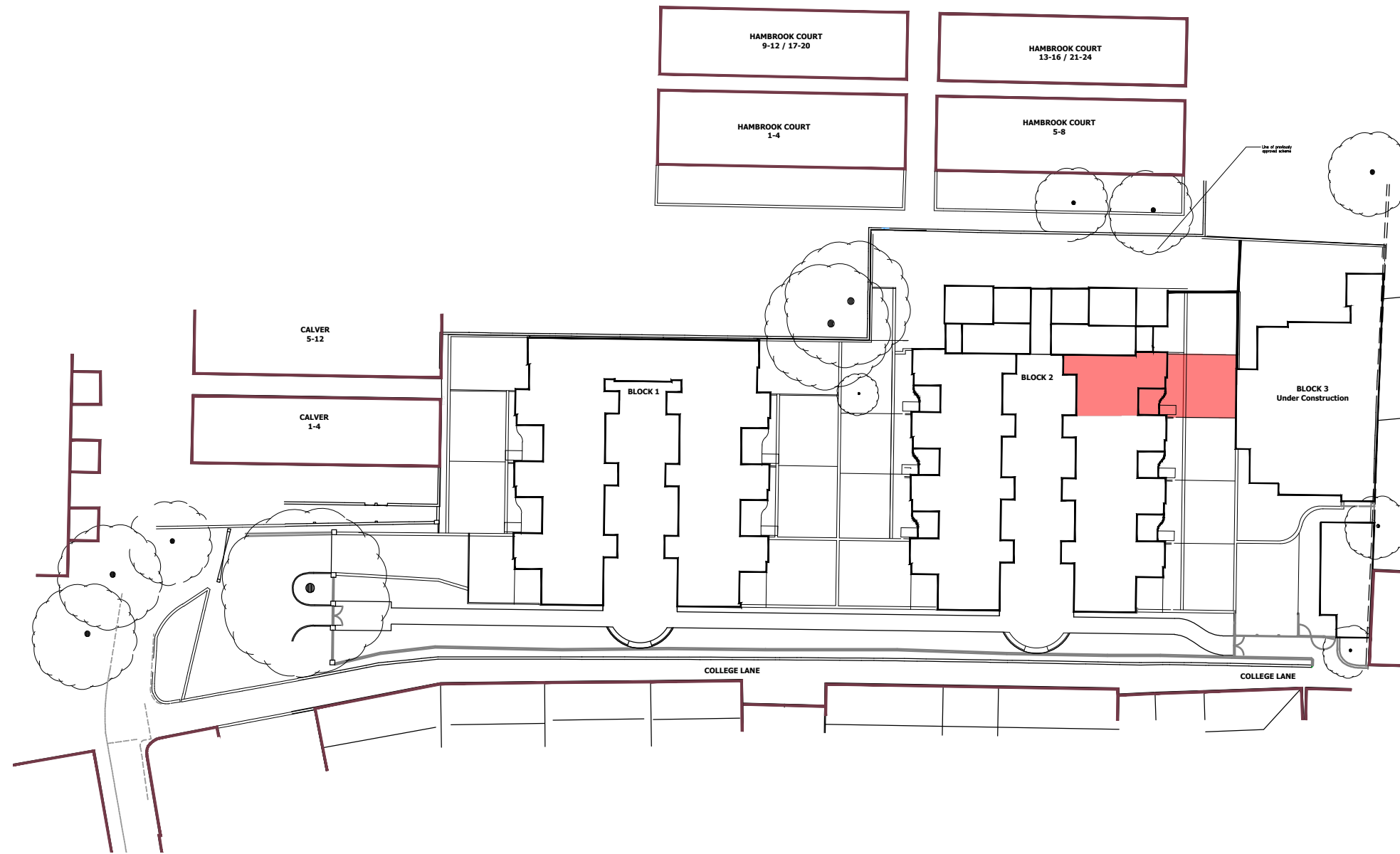

**Site Plan**  
 Scale 1:500

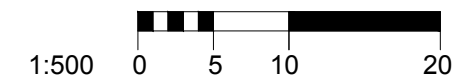
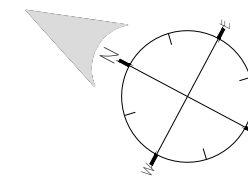

Rev.	Description:	By	Date
-	-	-	-
Client: Four Quarters Development Ltd		Drawn By:	JP
Title: Site Plan		Checked By:	-
Project: 17 Wiblin Mews, College Lane, Kentish Town, London		Scale:	1:500@A3
		Date:	30 Nov 2018
Job No:	Dwg No:	Revision:	
4672(18)	S65	-	