

Fire & Life Safety

	Illuminated Exit Signage With Directional Arrow - A52035
	Illuminated Hanging Exit Sign - A52037 / A52038
	Emergency Lighting - A52036
	Fire Alarm Panel
	Call Point (Red Break Glass)
	Emergency Door Release (Green Break Glass)
	Smoke Detector
	Sounder
	Bell
	Visual Alert
	Dry Powder Fire Extinguisher
	Water Fire Extinguisher
	Carbon Dioxide Fire Extinguisher
	Foam Spray Fire Extinguisher
	Fire Blanket

HVAC

	Air-Con Cassette
	Not Mounted Air-Con Cassette
	Ceiling Ventilation Supply Gille
	Ceiling Ventilation Return Gille
	Ceiling Access Hatch
	Recessed Heater Panel
	Radiator
	Overhead Heater

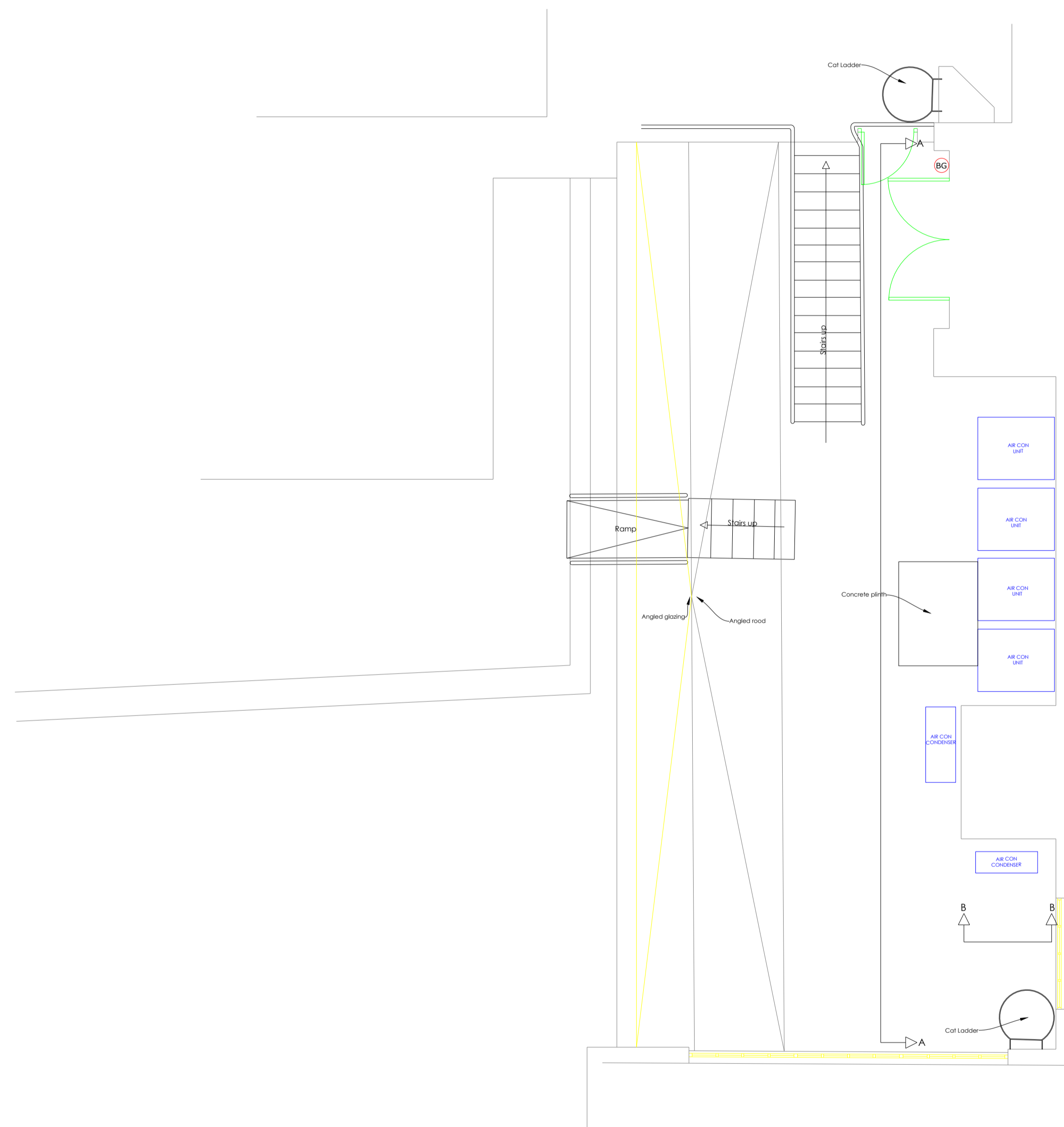

- Existing Structural Walls
- Existing Partition Walls
- Existing Column
- No Access

Existing Roof GA Layout
Scale 1:50 @ A1

Total Gross Area -
Roof 41.6 sqm
447.8 sqft

IMPORTANT NOTE

- THE CONTRACTOR MUST VERIFY ALL DIMENSIONS & LEVELS ON SITE BEFORE ANY WORKS ARE UNDERTAKEN OR THE MANUFACTURE OF SITE COMPONENTS, DISCREPANCIES ARE TO BE REPORTED TO THE PROJECT ARCHITECT/DESIGNER FOR CLARIFICATION.
- THIS DRAWING IS NOT TO BE SCALED.
- DIMENSIONS ARE IN MILLIMETRES UNLESS OTHERWISE STATED.
- COPYRIGHT OF THIS DRAWING BELONGS SOLELY TO RETAIL DESIGN SOLUTIONS LTD.

SURVEY LIMITATIONS

- PARTS OF THE BUILDING MAY HAVE BEEN INACCESSIBLE AT THE TIME OF THE SURVEY. THESE AREAS HAVE BEEN CLEARLY MARKED ON THE DRAWINGS. A STRIP OUT SURVEY IS RECOMMENDED FOR THESE AREAS TO VERIFY DETAILS.
- RETAIL DESIGN SOLUTIONS DO NOT CARRY OUT INTRUSIVE SURVEYS. AREAS COVERED BY BOXING OUT CANNOT BE CONFIRMED UNTIL MAIN CONTRACTOR EXPOSES THESE AREAS.

DRAWING TITLE

EXISTING ROOF GA

DRAWING NAME	REVISION
Sigma-Tottenham Place-Existing	-

SCALE	DATE	DRAWN BY	CHECKED BY
A1 - AS SHOWN	12.12.2018	RDS	BF

PROJECT ADDRESS
SECOND FLOOR, BLOCK B
THE HEALS BUILDING
TOTTENHAM COURT ROAD
LONDON
W1

STATUS
EX