

NOTE:  
 1. DO NOT SCALE, IF IN DOUBT ASK.  
 2. THIS DRAWING IS TO BE READ IN CONJUNCTION WITH ALL RELEVANT STRUCTURAL ENGINEER'S DRAWINGS AND DETAILS, THE SPECIFICATION FOR THE WORKS, THE RELEVANT ARCHITECT'S DRAWINGS AND ANY OTHER SPECIALIST'S DRAWINGS.

REFER TO DRAWINGS SA[2]01 TO SA[2]04 FOR SECTION DETAILS.

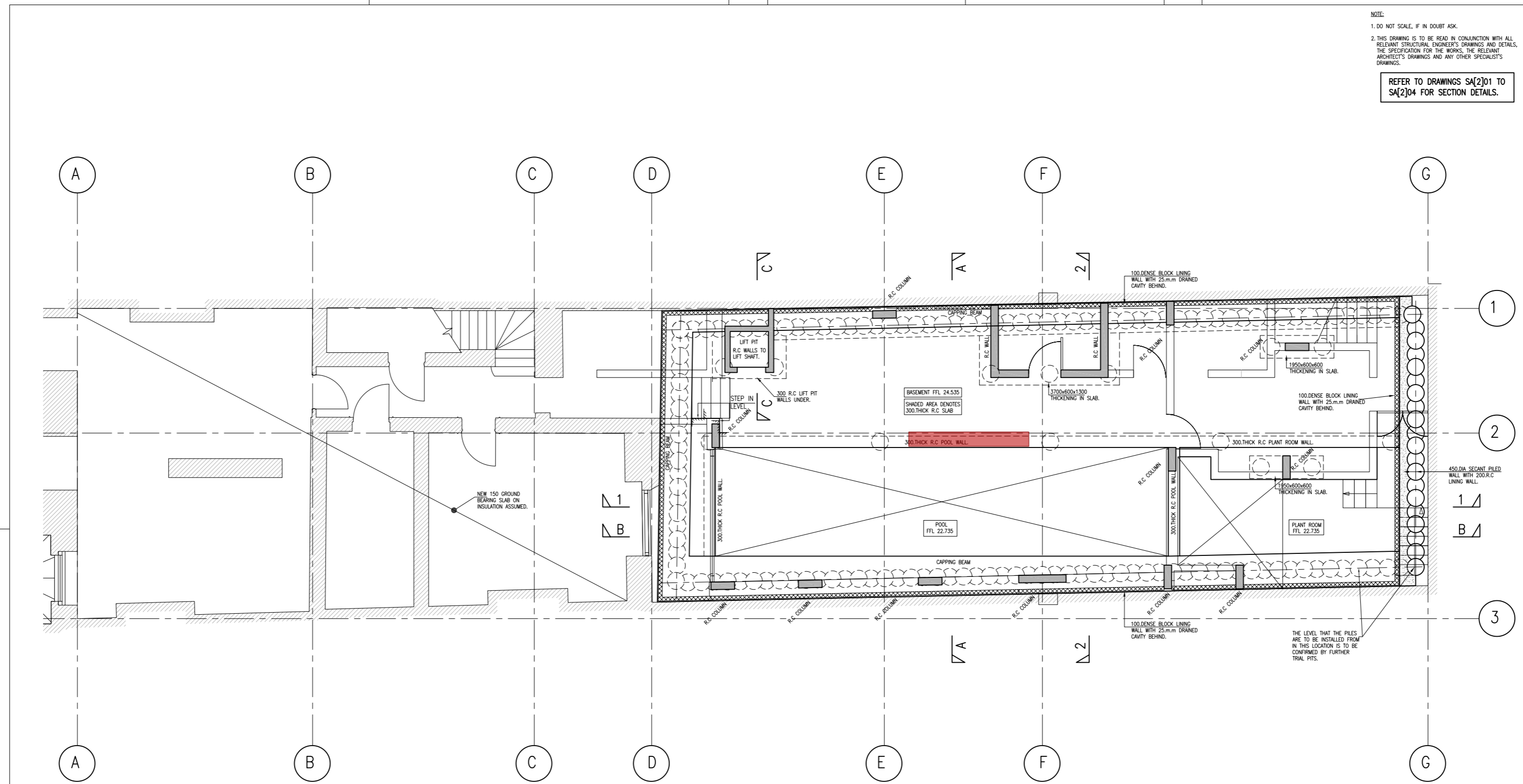

PROPOSED BASEMENT PLAN

**PRELIMINARY DRAWING:**  
 THIS DRAWING IS FOR PRELIMINARY PURPOSES ONLY AND MUST NOT BE READ AS A CONSTRUCTION ISSUE. IT INDICATES DESIGN INTENT ONLY AND IS SUBJECT TO AMENDMENT DURING FINAL DESIGN DEVELOPMENT.

I:\0201\01313088 - 3 Fitzroy Square\DW Drawings\SL[2]10.dwg, Net: 02/2010-9:30am  
 DB11

Revision Details	By	Date	Surf'n

Drawing Status: **PRELIMINARY**

Client	3 FITZROY SQUARE LONDON W1
--------	-------------------------------

Drawing Title	PROPOSED BASEMENT LAYOUT
---------------	-----------------------------

Scale at A1	1:1500
Drawn	MIN
Checked	MIN
Stage 1 check	RAL
Stage 2 check	RAL
Originated	RAL
Date	22.10.10

Scott Wilson 6-8 Greencoat Place London Telephone: (020) 7798 5000 Fax: (020) 7798 5001 www.scottwilson.com	Drawing Number <b>D133388 SL[2]10</b>	Rev. <b>P2</b>
--	--	-------------------

This document has been prepared in accordance with the scope of Scott Wilson's appointment with its client and is subject to the terms of that appointment. Scott Wilson accepts no liability for any use of this document other than by the client and only for the purposes for which it was prepared and provided, only where dimensions shall be used, of Scott Wilson Group PLC 2008