

The use of this data by the recipient acts as an agreement of the following statements. Do not use this data if you do not agree with any of the following statements:-

All drawings are based upon site information supplied by third parties and as such their accuracy cannot be guaranteed. All features are approximate and subject to clarification by a detailed topographical survey, statutory service enquiries and confirmation of the legal boundaries.

Do not scale except for planning purposes.

Report any discrepancies in writing to Palmer Lunn Architects before proceeding.

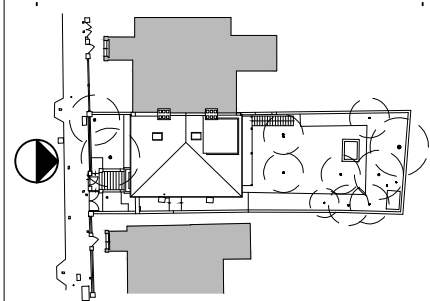

KEY PLAN

Rev	Description	Date	Drn	Chk
P01	Planning	03.12.2018	APa	MLu

Status
PLANNING

Client
Mitzi Mina & Greg Rubinstein

Project
100 Chetwynd Road
London NW5

Drawing
Front Elevation
as Proposed

Project No.	Drawing No.	Revision
18008	CWN-PL-04	P01
Scale @ A3		Drawn By
1:100		APa

SCHEDULE OF PROPOSED WORKS

1. Re-construct front boundary wall comprising new brick piers, dwarf wall, coping stones, railings and gates. Existing bricks to be re-used with new bricks, where required, to match existing. Brickwork to have flush lime mortar pointing. Railings and gates to be wrought-iron with finials to match no. 104 Chetwynd Road. Double-pitched coping stones to match no. 104 Chetwynd Road
2. Existing brick pier and coping stone retained.
3. New coping stone to existing brick pier.

