

Project name:		160523
Drawing title:		Bedford Estates
Drawing number:	Revision	
Client:	Bedford Estates	
Agent:		
Date:	29/11/2018	
Scale:	1:1000@A4	

Bedford Place (No. of Trees: 4)

ID	No.	Species name	Height (m)	DBH (cm)	Crown spread(m)	Vitality	Life Stage	Physiological Condition	Structural Condition	Targets	Condition Notes	Recommendations	Status - Safety action date
T24	1	Pittosporum tenuifolium	4.0	7	4.0	Moderate	Early Mature	Fair	Fair	Footpath within crown spread. Tree overhangs neighbouring property.	Epicormic growth - Base / bole / principal stems. Fork - Weak with included bark. Form - Low canopy. Multi-stemmed.	Lift low canopy - Pedestrian clearance lift to 2.5m over footpath and neighbouring property	Proposed - (2019-05-31)

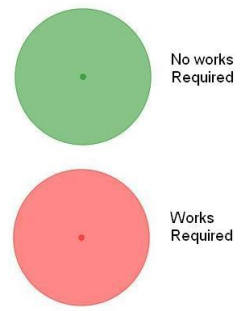
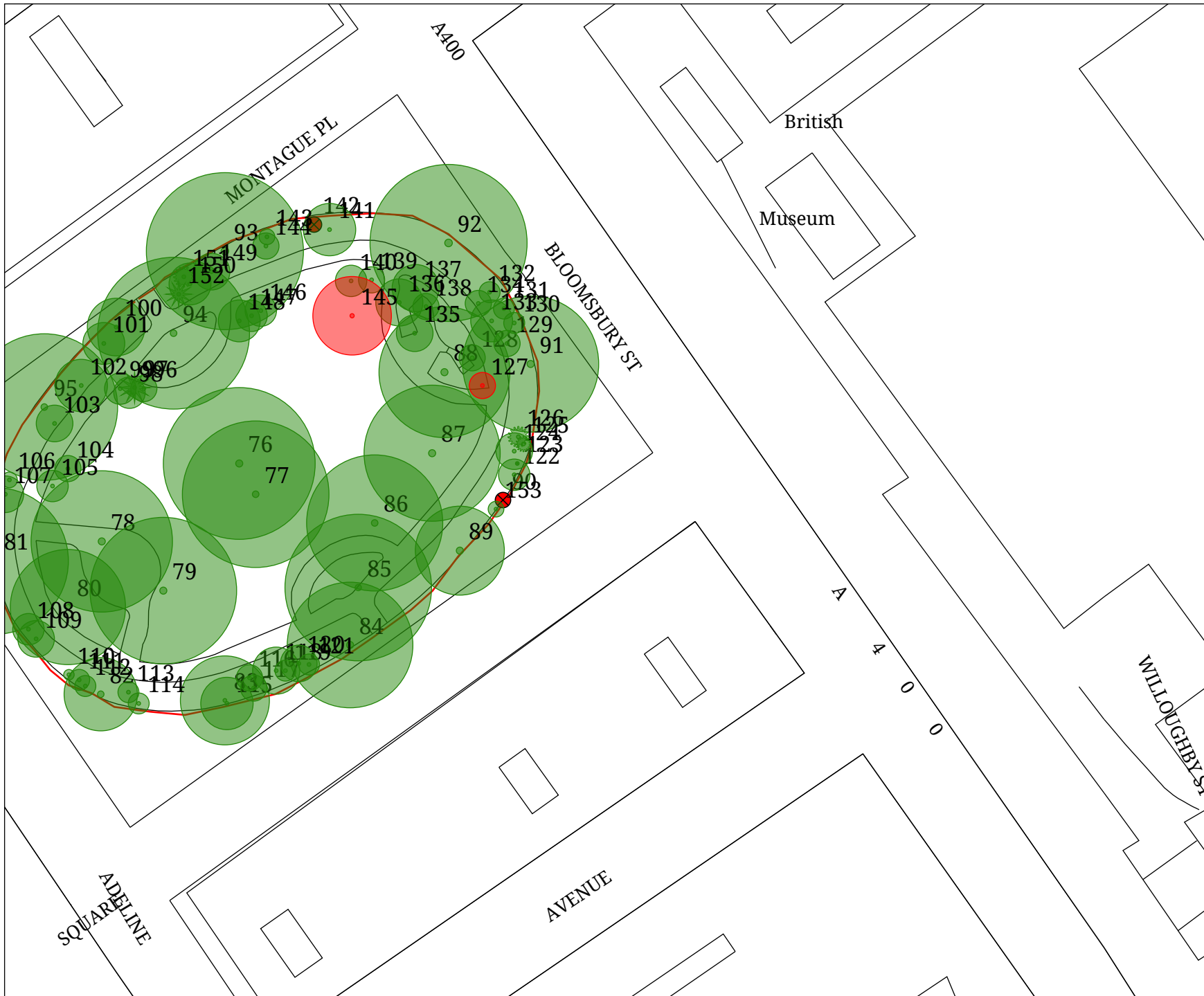

Project name:		160523
Drawing title:		Bedford Estates
Drawing number:	Revision	
Client:	Bedford Estates	
Agent:		
Date:	29/11/2018	
Scale:	1:1000@A4	



Bedford Square (No. of Trees: 78)

ID	No. Species name	Height (m)	DBH (cm)	Crown spread(m)	Vitality	Life Stage	Physiological Condition	Structural Condition	Targets	Condition Notes	Status - Safety action date
Old tag										Recommendations	
T127	1 Ilex aquifolium Holly	5.0	18	5.0	Moderate	Early Mature	Fair	Fair	Footpath within crown spread.	Arboricultural work - Historic. Form - Low canopy. Leaning trunk - Major. Suppressed crown - Minor. Lift low canopy - Pedestrian clearance to 2.5m over footpath	Proposed - (2019-05-31)
T145	1 Ulmus glabra 'Camperdownii' Camperdown Elm	8.0	80	15.0	Moderate	Late Mature	Fair	Poor	Footpath within falling distance of tree.	Coalesced decay seam - Suspected. Decline - Suspected. Decay / structural defect in crown limb / limbs - Localised. Deadwood - Minor. Decay / structural defect - Extensive. Decay / structural defect - Open cavity / cavities. Decay / structural defect - Bole. Epicormic growth - Base / bole / principal stems. Fungal fruiting body - structural decay suspected. Habitat - High value. Pruning wounds - Historic. Rigidoporus ulmarius bracket at base on north side of stem. Tap tests around base and stem indicate significant hollowing. Reduce crown by - Specified extent lateral branch length by 1-2m to suitable growth points to establish a smaller crown and minimise risk of branch or stem failure, leaving furnishing growth to minimise visual impact	Proposed - (2019-11-26)

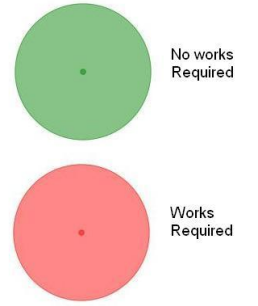

Project name:		160523
Drawing title:		Bedford Estates
Drawing number:	Revision	
Client:	Bedford Estates	
Agent:		
Date:	29/11/2018	
Scale:	1:1000@A4	

Montague Street (No. of Trees: 30)

ID	No. Species name	Height (m)	DBH (cm)	Crown spread(m)	Vitality	Life Stage	Physiological Condition	Structural Condition	Targets	Condition Notes	Status - Safety action date
Old tag										Recommendations	
T13	1 Robinia pseudoacacia 'Frisia' Golden False Acacia	17.0	45	12.0	High	Mature	Good	Fair	Neighbouring property in falling distance. Footpath within crown spread.	Crown reduction - Historic. Dense crown. Decay / structural defect in crown limb / limbs - Major. Decay / structural defect - Principal stems. Epicormic growth - Crown. Root damage - Mower. Raised surface roots. Shedding limb / limbs - Recent. Reduce crown by - Specified extent to most recent reduction points to minimise risk of branch failure and continue established management	Proposed - (2019-11-26)



No works
Required

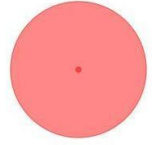

Works
Required



TIM MOYA ASSOCIATES

Project name:
160523

Drawing title:
Bedford Estates

Drawing number:	Revision
-----------------	----------

Client:
Bedford Estates

Agent:

Date:
29/11/2018

Scale:
1:1000@A4

Health and Safety Tree Schedule & Works history



Ridgmount Gardens (No. of Trees: 25)

ID	No. Species name	Height (m)	DBH (cm)	Crown spread(m)	Vitality	Life Stage	Physiological Condition	Structural Condition	Targets	Condition Notes	Status - Safety action date
Old tag										Recommendations	
T53	1 Robinia pseudoacacia 'Frisia' Golden False Acacia	25.0	45	13.0	Moderate	Mature	Fair	Poor	Seating area within crown spread. Car parking within falling distance of tree. Building within falling distance of tree.	Decay / structural defect in crown limb / limbs - Suspected. Epicormic growth - Crown. Foreign object. Reaction wood / Adaptive growth - Stem / stems. possible decay in trunk at 9m Reduce height - Specified extent by 3-4m to suitable growth point to relieve loading above apparently damaged area and minimise risk of crown failure - assess apparently damaged area at 9m and report findings	Proposed - (2019-05-31)
T63	1 Amelanchier lamarckii Snowy Mespilus	6.0	8	6.0	Moderate	Early Mature	Poor	Fair	Car parking within falling distance of tree. Footpath within falling distance of tree.	Access to inspect base - Restricted / obscured. Base / stems obscured - Vegetation. Decline - Suspected. Deadwood - Minor. Multi-stemmed. Dimensions - Stem diameter average of stems. Reduce faulted limb / limbs by - Specified extent remove damaged section of smallest diameter stem to prevent stem failure - using hand tools to avoid damaging remaining stems remove deadwood	Proposed - (2019-05-31)

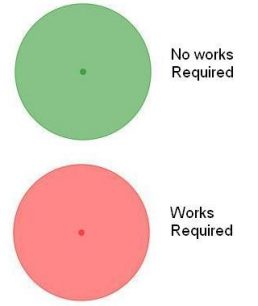
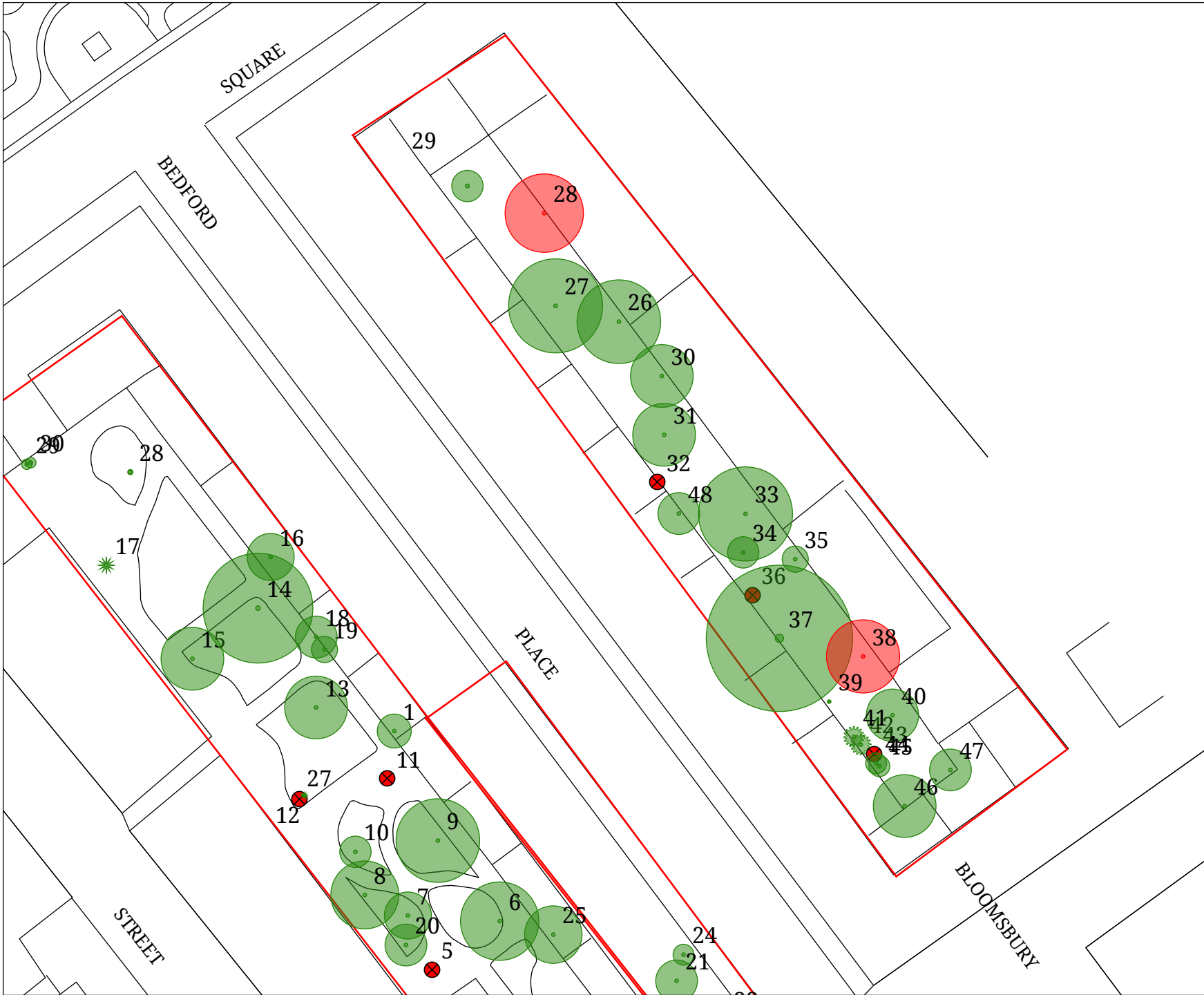

Project name:		160523
Drawing title:		Bedford Estates
Drawing number:	Revision	
Client:	Bedford Estates	
Agent:		
Date:	29/11/2018	
Scale:	1:1000@A4	

Southampton Row (No. of Trees: 23)

ID	No. Species name	Height (m)	DBH (cm)	Crown spread(m)	Vitality	Life Stage	Physiological Condition	Structural Condition	Targets	Condition Notes Recommendations	Status - Safety action date
T28	1 Tilia cordata Small Leaved Lime	18.0	40	15.0	Moderate	Mature	Fair	Fair	Tree overhangs neighbouring property.	Deadwood - Minor. Eccentric growth. Fork - Suspected structurally sound. Form - Low canopy. Ivy or climbing plant. Rubbing limbs. Reduce lateral limb / limbs by approximately 2m (two lower limbs east over car park, one west over garden) to suitable growth points to relieve loading and minimise risk of branch failure onto car park	Proposed - (2019-05-31)
T38	1 Aesculus hippocastanum Horse Chestnut	14.0	45	14.0	Moderate	Mature	Poor	Fair	Tree overhangs neighbouring property.	Decay / structural defect in crown limb / limbs - Localised. Foliar / bud damage - Insect. Suppressed crown - Major. Unbalanced crown - Major. End-weight reduction - Specified extent approximately 5m from lowest branch (remove lowest, heaviest section to suitable growth point) to relieve loading on cracked (by union with trunk) branch and minimise risk of failure, to prolong useful life of tree	Proposed - (2019-05-31)