

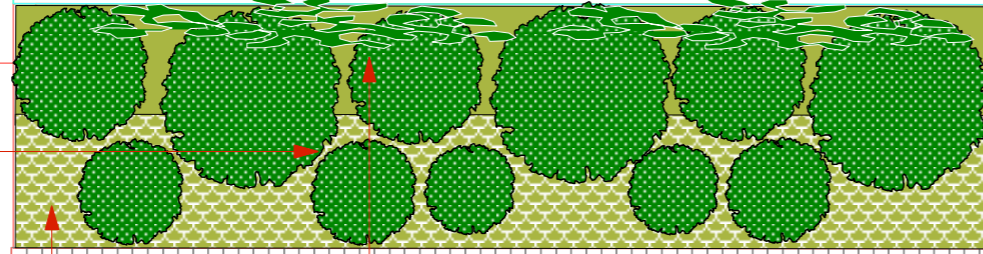

EXISTING BOUND

TOPIARY BALLS
 3no Taxus baccata R/B 1200mm diam (Yew)
 3no Taxus baccata R/B 900mm diam (Yew)
 3no Taxus baccata R/B 700mm diam (Yew)
 2no Taxus baccata R/B 500mm diam (Yew)
 allowed to grow to 'cloud' shape



11no Pachysandra terminalis 'Green Sheen' 1L
 (Japanese Spurge) groundcover

+56.06

2no Hydrangea seemanii 5L on wall
 (Evergreen Climbing Hydrangea)

+56.23

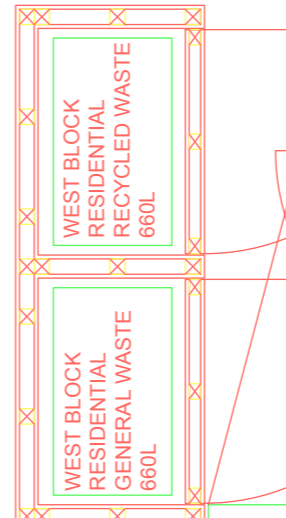

TOPIARY BALLS Taxus baccata (Yew) various sizes allowed to grow to 'cloud' shape



Pachysandra terminalis 'Green Sheen' (Japanese Spurge) groundcover



Hydrangea seemanii climbing on wall (Evergreen Climbing Hydrangea)

4no Taxus baccata R/B 1.25 - 1.5 tall at planting
 clipped and maintained at 1.5M tall
 (Yew)

Intercp
 m

+56.4
 Vehic

SVP1

**NOTE: ALL PLANTING AT GROUND LEVEL
 (NO RAISED PLANTERS)**

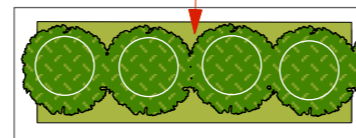

Planting bed to form division between residential entrance and retail units.



Taxus baccata HEDGE clipped and maintained at 1.5M tall (Yew)