

No.	Revision	Date
A	Rear Conservatory Extension at 1F All windows replaced with identical windows double glazed	27.07.2018
B		22.11.2018



108
UNIT 1

108
UNIT 2

Timber windows and glazing bars with slimlite double glazing

FRONT ELEVATION



106
UNIT 1

106
UNIT 1

108
UNIT 1

108
UNIT 2

Timber windows and glazing bars with slimlite double glazing

REAR ELEVATION

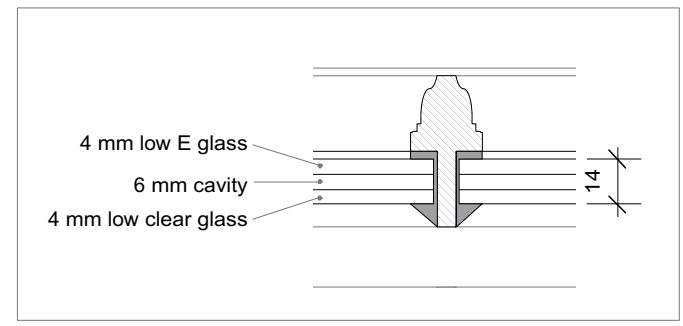

GENERIC GLAZING BAR SECTION WITH SLIMLITE GLASS OR SIMILAR

PLANNING

All dimensions must be confirmed on site and verified with the Architect. Any discrepancies on the drawing must be reported to the Architect prior to any works being carried out on site.

DO NOT SCALE OFF THIS DRAWING, only use stated dimensions for setting out purposes.

The copyright of this schedule / drawing remains with the Architect. No part of this schedule / drawing may be reproduced in any form or by any means without the written permission of Greenway Architects.

Project:
106 - 108 Regent's Park Road
NW1 8UG

Drawing Title:
Proposed Elevations

Drawing No.:
1939 P- 211 rev B

Date 15.03.2018	Scale 1:100 @ A3
--------------------	---------------------

greenwayarchitects
Branch Hill Mews, London NW3 7LT
Tel +44 (0)20 7435 6091
www.greenwayarchitects.co.uk