

Disclaimer
Do not scale from this drawing.
Check all dimensions on site before fabrication or setting out.
This document is copyright and may not be reproduced without permission of the owner.

Notes

Rev	Reason for Issue	Date	Iss
P00	OLA Issue	30.06.17	RPP
P01	Planning Issue	16.10.17	RPP
P02	Additional Cycle Spaces	19.10.18	RPP

Key	Description
- - - - -	Application site boundary
.....	Inside face of existing reservoir

- Consultants**
- Accessibility: Cudd Bentley
 - Acoustics, BREEM, M&E Engineer: Quantum
 - Cost Consultant: James Blake Associates
 - Ecology: KPM
 - Fire Engineering: Montagu Evans
 - Heritage: Andy Sturgeon Design
 - Landscape Designer: Strutt & Parker
 - Planning Consultant: Point 2
 - RoL, Daylight & Sunlight Analysis: Waterman Structures
 - Structural & Civil Engineer: AR Urbanism
 - Townscape Consultant: Cannon Consulting Engineers
 - Transport: Cannon Consulting Engineers

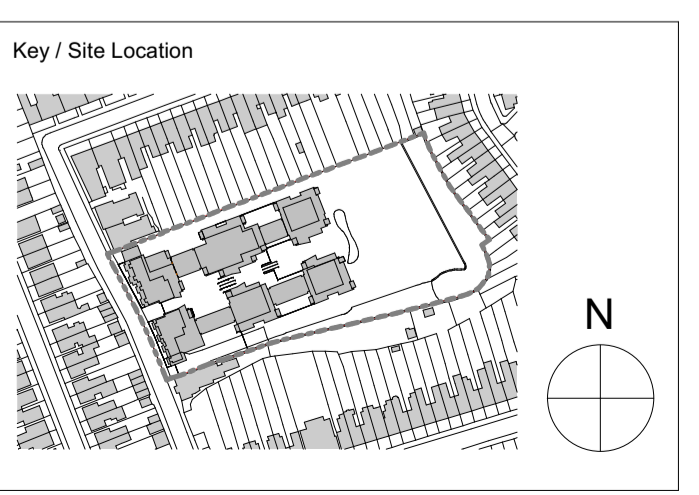

Robin Partington & Partners
Castlewood
77-91 New Oxford Street
London
WC1A 1DG
+44 20 7419 3500
mail@rpplondon.com
www.rpplondon.com

Client
LifeCare Residences Limited

Project Persephone Gardens		
Drawing Title Level 00		
Scale 1 : 200 @ A1	Drawn By RPP	Issued By RPP
Planning		
Project No. 16069	Drawing No. A_PL_P_100	Revision P02