



FINISHES SCHEDULE:

EXTERNAL WALLS: SIBERIAN LARCH PAINTED IN RAL 9005
 INTERNAL WALLS: WHITE
 ROOF FACIA: BLACK
 DOOR: BLACK
 RAIN WATER DOWN PIPES: INTERNAL

APPROVED FOR CONSTRUCTION:

SIGNED.....

PRINT NAME.....

NOTE:
ALL GAS EQUIPMENT WILL BE LPG.

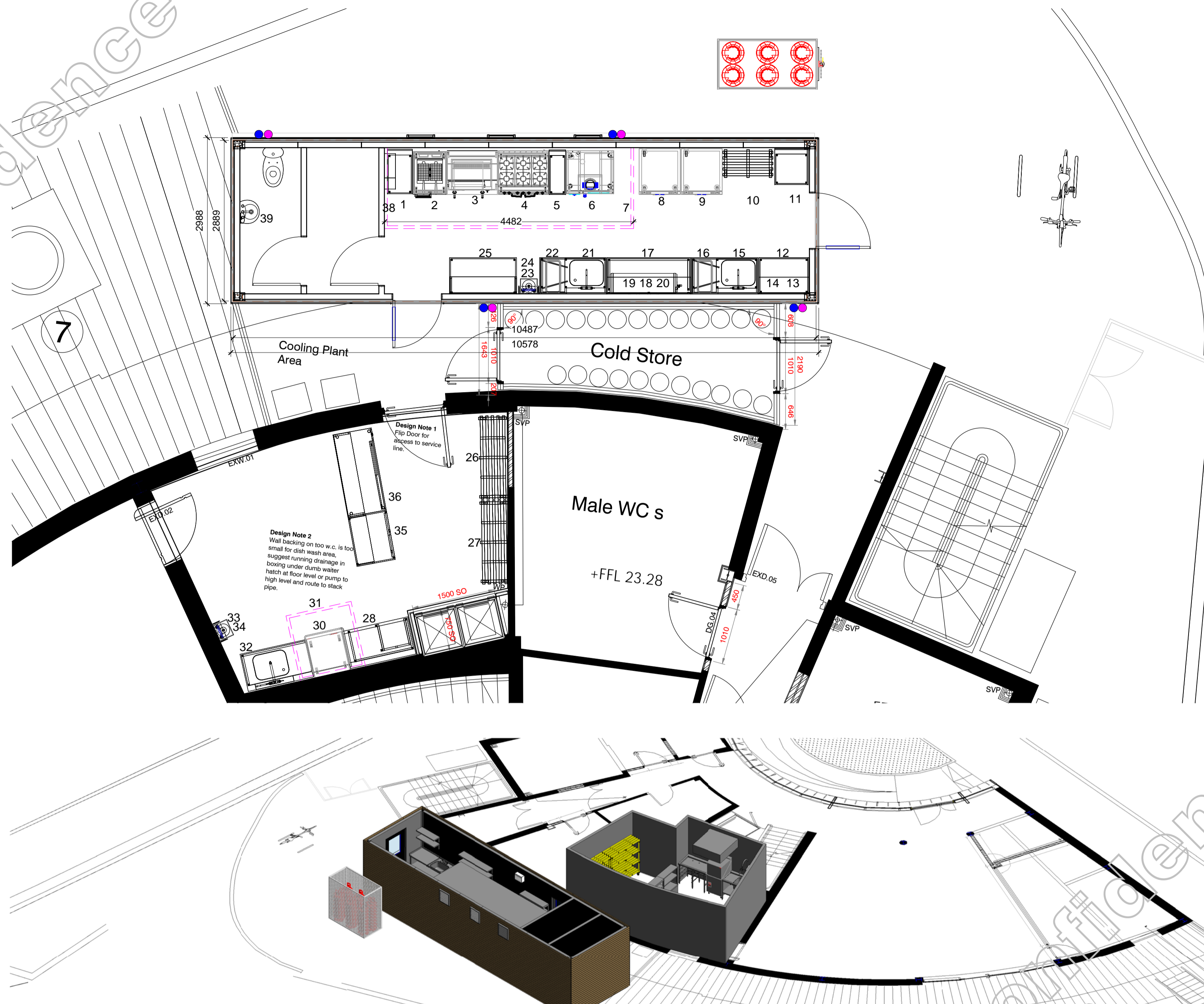

Equipment Schedule 4 GA					
Mark	PKL Description	PKL ID	Width MM	Depth MM	Height MM
	Extra Upstand	EU	630	20	50
1	Preparation Table	8T30-45	450	800	900
1.1	Rear Upstand	RU	450	20	50
1.2	Base Shelf Frame	BSF	410	680	850
2	Fryer 600mm - Gas				
3	Salamander Grill - Gas				
4	Six Burner Range				
5	Preparation Table	8T30-45	300	800	900
5.1	Rear Upstand	RU	300	20	50
5.2	Base Shelf Frame	BSF	260	680	850
6	Combination Oven 10 Grid - Gas				
7	Extraction Canopy	ES	4482	1450	
8	Upright Refrigerator 600lt				
9	Upright Freezer 600lt				
10	Storage Racking		900	500	1565
11	Preparation Table	65T60-90	605	650	900
11.1	Rear Upstand	RU	605	20	50
11.2	Base Shelf Frame	BSF	565	530	850
12	Preparation Table	65T60-90	900	650	900
12.1	Rear Upstand	RU	900	20	50
12.2	Base Shelf Frame	BSF	860	610	850
12.3	Extra Upstand	EU	650	20	50
13	Wall Shelf (Box Section Brackets)	3WS9	900	300	1500
14	Wall Shelf (Box Section Brackets)	3WS9	900	300	1800
15	Single Bowl Sink	6SB12	1200	650	900
15.1	Rear Upstand	RU	1200	20	50

Equipment Schedule 4 GA					
Mark	PKL Description	PKL ID	Width MM	Depth MM	Height MM
15.2	Part Void to Underframe	PV	1160		
15.3	Sink Drainer	DR			
15.4	Sink Mixer Lever Tap	SMLT			
15.5	Sink Bowl 610 x 460 x 300 mm	61B46D3			
16	Slim Jim Bin				
17	Preparation Table	65T120-150	1500	650	900
17.1	Rear Upstand	RU	1500	20	50
17.2	Straight Tie Bar Frame	STB	1460	565	850
18	Water Heater Horizontal 100L 3kW				
19	Wall Shelf (Box Section Brackets)	3WS15	1500	300	1800
20	Wall Shelf (Box Section Brackets)	3WS15	1500	300	1500
21	Single Bowl Sink	6SB12	1200	650	900
21.1	Rear Upstand	RU	1200	20	50
21.2	Part Void to Underframe	PV	1160		
21.3	Sink Mixer Lever Tap	SMLT			
21.4	Sink Drainer	DR			
21.5	Sink Bowl 610 x 460 x 300 mm	61B46D3			
22	Slim Jim Bin				
23	Wash Hand Basin, Wall Mounted, Small	HG169A			
24	Fly Killer	88			
25	Preparation Table	65T120-150	1205	650	900
25.1	Rear Upstand	RU	1205	20	50
25.2	Base Shelf Frame	BSF	1165	625	850
25.3	Heated Gantry Double Tier	3HGD12	1200	300	750
26	Storage Racking		1500	500	1565

Equipment Schedule 4 GA					
Mark	PKL Description	PKL ID	Width MM	Depth MM	Height MM
27	Storage Racking		1500	500	1565
28	Dishwash Exit Tabling	68DW155-180	1205	685	900
28.3	Dishwash Tabling Leg Set & Tie Bar	DWTB	1085	565	850
28.4	Bank of Basket Runners - End	BBRE			
30	Hood Dishwasher 3ph				
31	Dishwash Canopy		1200	1200	360
32	Dishwash Tabling	68DW120-150	1205	685	900
32.1	Dishwash Sink Bowl 610 x 460 x 300 mm	DWS			
32.2	Pre-rinse Spray Arm (Hot & Cold) and Bowl Fill Tap	PRS2			
32.3	Splashguard	SG7	700	100	225
33	Wash Hand Basin, Wall Mounted, Small	HG169A			
34	Fly Killer	88			
35	Base Cupboard (Sliding Doors)	70BC9	900	700	900
35.1	Gantry Double Tier	3GD9	900	300	750
36	Hotcupboard (Sliding Doors)	HC15	1500	700	900
36.1	Heated Gantry Double Tier	3HGD15	1500	300	750
38	Fire Suppression - Twin Tank	FS2	640	200	600
39	Water Heater Wash Hand Basin 2.8kW ES3				
40	Gas Cage & Six Bottles +Change Over Board				

No.	Date	Description	Dr'n	Ch'd
2	21.09.18	Removed prep water heater. Added finishes schedule.	KH	BS
1	19.09.18	Re-sited & Service area amended	CG	BS

CLIENT CHAPEL DOWN GIN DISTILLERY

PROJECT KPO/193779

TITLE GENERAL ARRANGEMENT

STATUS DESIGN DEVELOPMENT

ORIGINATOR BS SCALE (ON A1) As indicated
 DRAWN BY CG CREATED ON 16.07.18

CHECKED BY

DRAWING NO. KP18220-GA REVISION 2

T:\ISSUED\Foodservice\2018\KP18220 - Chapel Down Gin Distillery\01 - Drawings\KP18220.rvt

PKL Group (UK) Ltd
 This document and all information herein is confidential and the intellectual property of PKL Group (UK) Ltd. It is disclosed in confidence on terms that it will not be disclosed to any third party, used, sold, loaned, licensed, or reproduced in whole or in any part in any manner or form for manufacturing, tendering or for any other purpose without the written permission of PKL Group (UK) Ltd. The copyright is retained by PKL Group (UK) Ltd.