

Bauder Sedum Vegetation Blanket XF301

Lightweight blanket system featuring 11 species of sedums combined with some mosses and grasses. Selected porous aggregate and composted green waste substrate. Approx planting density: 95%

Species:

- sedum acre*
- sedum album* - bella d'inverno
- sedum album* - coral carpet
- sedum ewersie*
- sedum kamtschaticum* - eliacombianum
- sedum kamtschaticum* - weinstephaner gold
- sedum montanum orientale*
- sedum pulchellum*
- sedum rupestri* (reflexum)
- sedum sexangulare*
- sedum spurium* - mesemlanthemum - delosferma
- sedum spurium* - mesemlanthemum = halli
- sedum verticillatam*

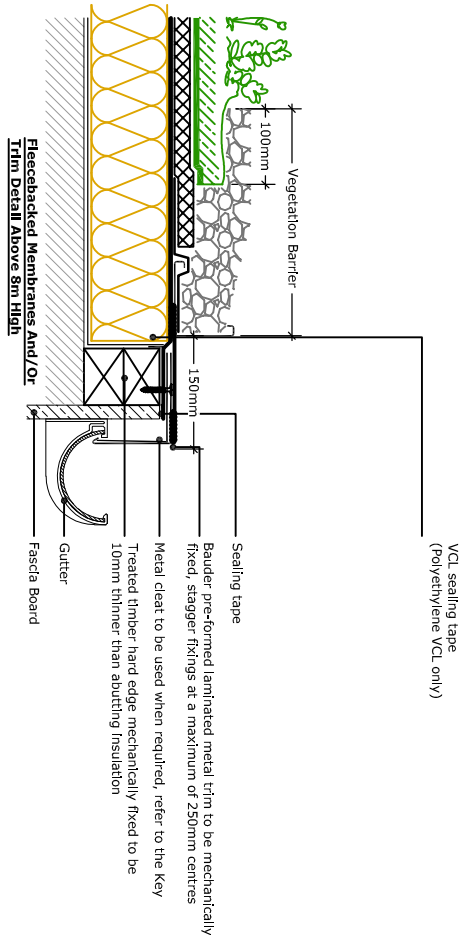

External Gutter - Less than 8m High

(Dwg No: DD100-00W_A1_006-005)

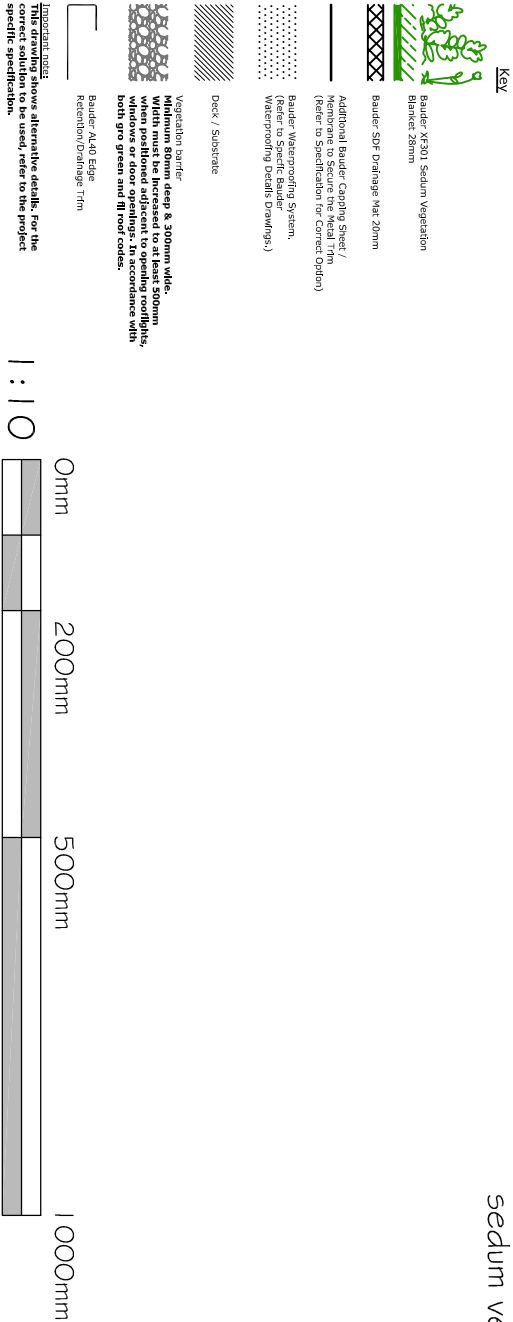

ESTABLISHMENT MAINTENANCE

After completion of the installation it will be necessary to keep the substrate and blanket damp for a period of at least 4 weeks immediately afterwards, and it may be necessary to irrigate for longer than this if installation is followed by a warm, dry spell of weather.

It is equally important to ensure that the green roof substrate does not become totally saturated by either excessive watering through periods of cool, wet weather. Further information on watering requirements for this product is available to view or download from the Bauder web site and the document “Watering Requirement Guidelines for Extensive and Biodiverse Green Roof installations”

To encourage the plants to survive without too much irrigation and to harden them off in readiness to survive winter, it is important to start cutting back on watering from early September. The maintenance requirement in the following years will depend upon the weather experienced through the winter and early spring of each year and should follow Bauder's standard biodiversity green roof maintenance guidelines.

Modern extensive and bio-diverse green roof installations will normally require only minimal maintenance. Bauder can offer advice on any issues concerning the green roof and enquires should be forwarded to the Green Roof Technical Department.

Notes:

Do not scale drawings and larger scale drawings take precedence. Figured dimensions only are to be taken from this drawing.

At building and site dimensions, levels and sawer inset levels at contractor before the commencement of works. All dimensions are to be checked prior to the placement of materials or the fabrication of work and any discrepancy, omission or error is to be reported to the Architect immediately for verification.

This contractor is to comply with current Building Legislation, British Standard Specifications, Building Regulations etc. Whether or not specifically stated on this drawing. This drawing must be checked against the relevant Building Regulations, British Standard Specifications and design documentation provided.

Revisions:

Client: Matthew Bown

Project: Residential extension
114 Greencroft Gardens
Hampstead
London
Description: Sedum Roof
Proposed plan and elevation



Head office: the old stone masons, 10 St Johns St, Aberystwyth, Ceredigion, SY23 2DA
Tel: 01873 851125 Fax: 01873 851127

Newport: ground floor, 126 castle road, Newport, South Wales NP19 7DB
Tel: 01633 245020 Fax: 01633 246812
e-mail: info@jdwarchitects.co.uk
w: www.jdwarchitects.co.uk

DRAWN: scale @A3
MD: 1:10
date: sheet of:
job dwg no: JW542-SPO3

This drawing is copyright of the architect and may not be reproduced without licence