

Architecture // Branding // Concept // Design // Interiors

mail // c3m_studio@me.com
 mobile // 07989555882
 www // c3mstudio.com

PROCUREMENT TEAM

MAIN CONTRACTOR	AMBIT
SPECIALIST SUB CONTRACTOR	London Stone
INVESTIGATIVE WORKS	FESCAPE
PROJECT MANAGEMENT	QUEST COST
MEP CONSULTANT	WATTS
STRUCTURAL ENGINEER	HAYNE TILLET STEEL
APPROVED INSPECTOR	JMP
PD / CDM	SHORE ENGINEERING
ARCHITECT	c3M studio
DETAIL DESIGNER	Fabrica c3M

CLIENT:
The Rayne Foundation

PROJECT
THE RAYNE FOUNDATION
3 BROMLEY PLACE, W1T 6BJ.



Notes:
Do not scale from this drawing except via scale bar and for planning purposes only
Check all dimensions on site before fabrication or setting out
This document is copyright and may not be reproduced without permission

All existing drawings have been produced with survey information supplied by The Rayne Foundation
Survey information is authored by Pure Real Estate Services Limited
C3m Studio take no responsibility for the accuracy of the information produced

Revision	Reason For Issue	Date
01	Issued For Planning	30.09.18

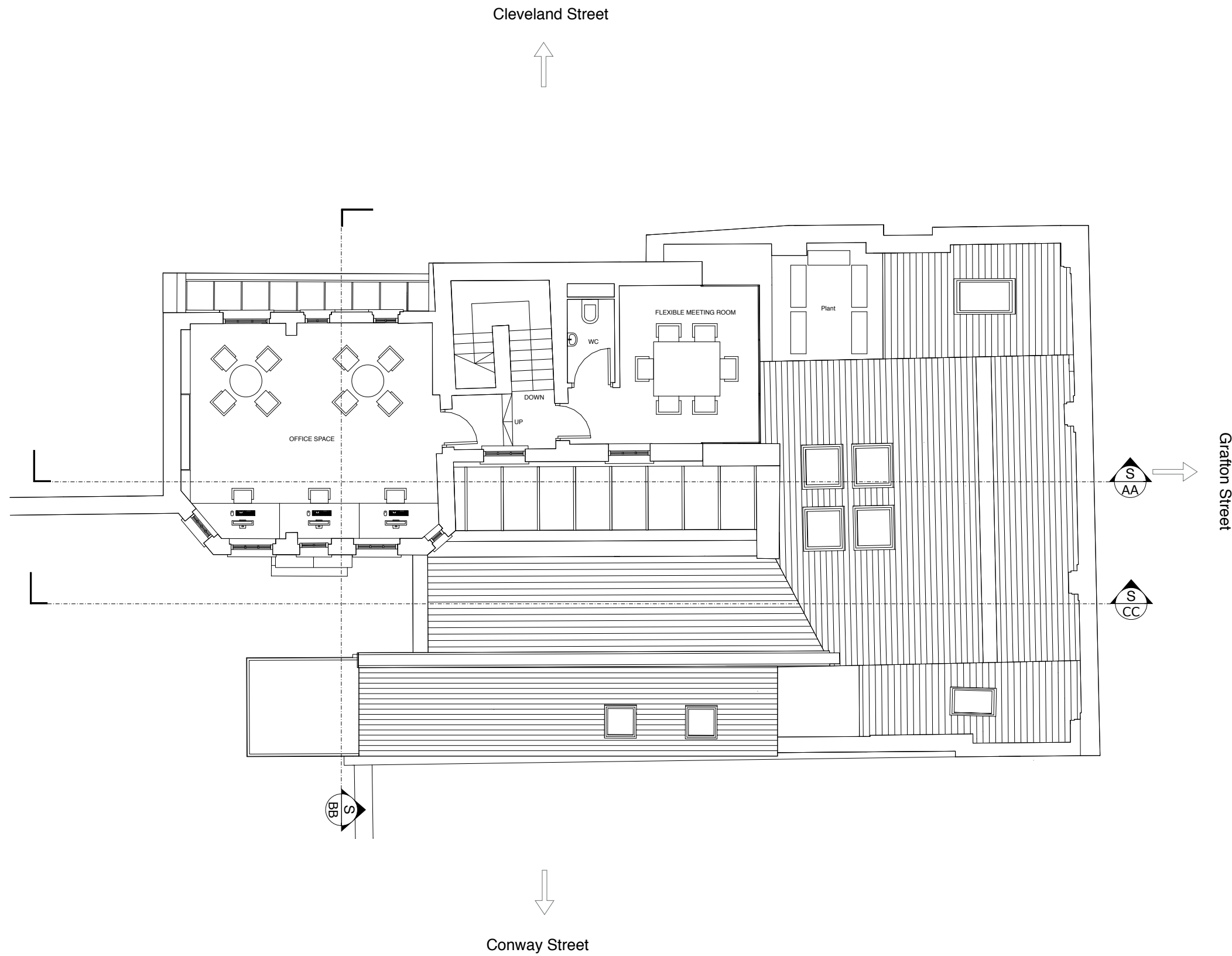

Proposed Second Floor Plan

1:100 @ A3. 1:50 @ A1



REF: PL_PR_102

Drawing Name: Proposed Drawing

Drawing Description: Second Floor Plan

Scale: 1:100 @ A3 1:50 @ A1