

**PROCUREMENT TEAM**

MAIN CONTRACTOR	AMBIT
SPECIALIST SUB CONTRACTOR	London Stone
INVESTIGATIVE WORKS	FESCAPE
PROJECT MANAGEMENT	QUEST COST
MEP CONSULTANT	WATTS
STRUCTURAL ENGINEER	HAYNE TILLET STEEL
APPROVED INSPECTOR	JMP
PD / CDM	SHORE ENGINEERING
ARCHITECT	c3M studio
DETAIL DESIGNER	Fabrica c3M

CLIENT:  
The Rayne Foundation

**PROJECT**  
**THE RAYNE FOUNDATION**  
 3 BROMLEY PLACE, W1T 6BJ.



PREPARED BY

ISSUE DATE  
SEPTEMBER 2018

Notes  
 Do not scale from this drawing except via scale bar and for planning purposes only  
 Check all dimensions on site before fabrication or setting out  
 This document is copyright and may not be reproduced without permission

All existing drawings have been produced with survey information supplied by The Rayne Foundation  
 Survey information is authored by Pure Real Estate Services Limited  
 C3m Studio take no responsibility for the accuracy of the information produced

Revision	Reason For Issue	Date
00	Issued For Planning	September 2018

REF: PL\_EX\_101

Drawing Name: Existing Drawing

Drawing Description: FIRST FLOOR PLAN

Scale: 1:100 @ A3, 1:50 @ A1

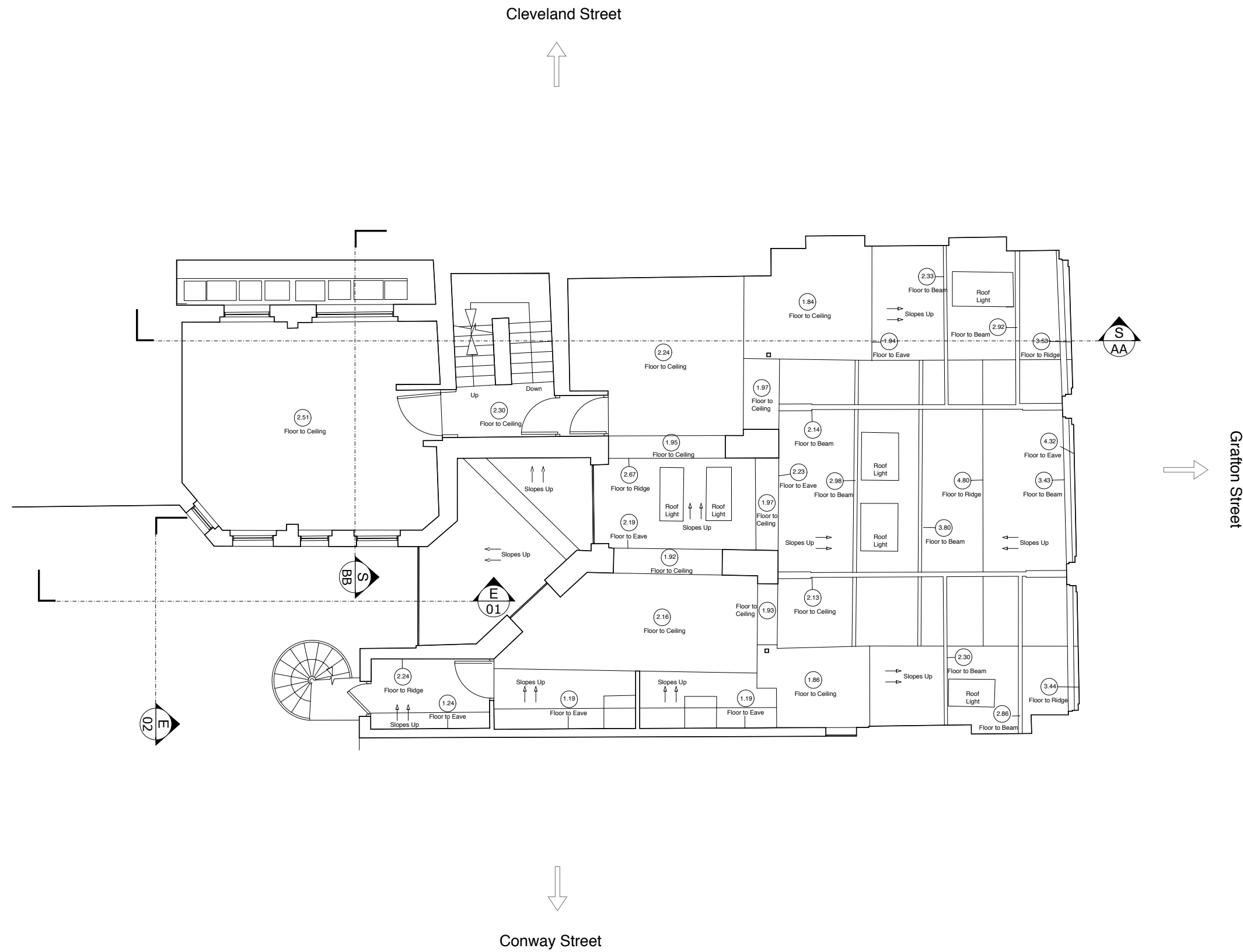

**EXISTING FIRST FLOOR PLAN**

1:100 @ A3, 1:50 @ A1

