

# GEORGE BARNSDALE

Est. 1884

## Historic Range



TIMBER WINDOWS & DOORS

 **MADE IN  
BRITAIN**

# Sliding Sash Windows

Featuring narrow sash rails and thin frames to fit in original openings, our Historic sliding sash window provides an authentic, high quality replacement. All designs offer a high degree of customisation for an accurate match to the original with a number of layouts, horn styles and period window furniture.

## High security



For maximum security, locking sash fasteners are fitted to the meeting rail. The windows are fitted with sash stops on either side of the frame so that whilst they can be opened for ventilation, the opening is restricted for security and safety.

## Accurate replication



For an accurate match to the original, top and/or bottom sashes can be specified with traditional sash horns. We offer several different horn types (see page 17), but if required we can match to existing designs.

## Excellent weather performance



Our innovative, concealed weather seals achieve a much higher degree of weather performance than most of our competitors' products. Air-tight and discreet they do not detract from the authentic appearance of the window.

## Choice of profiles



For single glazing we offer 21mm glazing bars and 24mm for narrow cavity insulated glazing. Both sizes are available in a variety of profiles including pencil round and ovolo (see pages 16 to 17 for an overview of the profiles offered).

## Enhanced durability



Frame linings have always been a vulnerable point within sliding sash window designs. To overcome this design issue, and at no detriment to the window's traditional appearance, we only use Accoya® timber linings which provide greater durability.

## Design customisation



Our sliding sash windows can be adapted to replicate almost any existing design. We can manufacture them with arched heads, internal arches to the sash, as well as a range of bay and bow window designs (see pages 14 to 15 for our standard layout options).



Historic box sliding sash window finished in a white paint coating and fitted with furniture from The Sash Collection in polished chrome.



## Window designs

### Traditional box

Based on the original cords and weights design, the traditional box sash window is the most authentic. It provides effortless movement for larger, heavier sashes.

### Spiral balance

This window design is traditional in appearance but more modern in operation. Rather than using cords, weights and pulleys to counterbalance the sashes, a concealed spring balance offsets the weight of the sash.

# Window Furniture Collections

The look and feel of any window is influenced by the choice of furniture. In the creation of our window furniture collections for the Historic Range we have focussed upon the key elements of authenticity, quality, security and performance.

## The Classic Collection

Elegant in appearance with a high quality finish, the Classic Collection has an understated beauty that suits any style of property.

### Ball End Handle

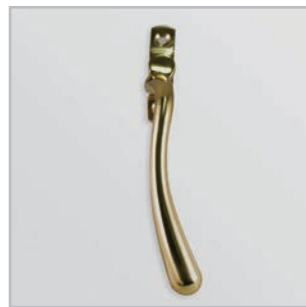

### Casement Stay



### Finish Options

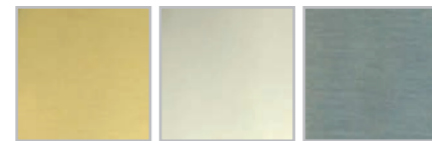

Polished Brass\*    Polished Chrome    Satin Chrome

*Shown in polished brass*

## The Foundry Collection

Offering antique wrought iron handles and casement stays, the Foundry Collection has been designed to provide a rustic appearance that makes it ideally suited to traditional cottages and farmhouses.

### Monkey Tail Handle



### Monkey Tail Casement Stay



### Pear Drop Handle



### Pear Drop Casement Stay



### Finish Options

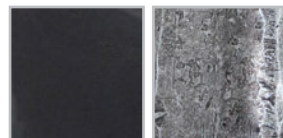

Black    Pewter

*Shown in black*

## The Sash Collection

For our sliding sash windows we have an elegant furniture collection that provides simple, effortless operation and high security. The design and finish options allow a perfect match with all of our furniture collections.

### Sash Pull



### Sash Fastener



### Sash Stop



### Sash Eye



### Sash Pulley



### Finish Options



Polished Brass    Polished Chrome    Satin Chrome    Satin Nickel    Antique Brass    Bronze    Pewter

*Shown in polished brass*

## The Original Collection

The Original Collection features our standard window handles. With simple, ergonomic design and push button locking, the handles are available in a range of colours, allowing seamless integration with a range of buildings and styles.

### Original Handle

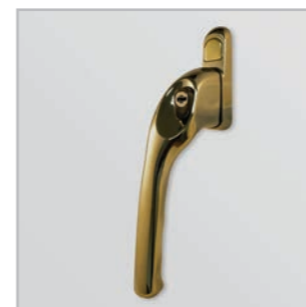

### Finish Options



Gold    Polished Chrome    Satin Chrome    White    Black

*Shown in gold*

\* Please note, within The Classic Collection the polished brass option is supplied unlacquered on all external furniture for a more durable finish. The unlacquered finish can either be left to take on an antique brass finish or cleaned using a quality metal cleaner to maintain the polished finish.

# Window Configurations

To meet the requirements of your project, for each window design we offer a number of opening and layout options. However, if your project demands alternatives we will work with you to develop new variations to meet the brief.

## Opening options

### Casement

(Shown from outside)

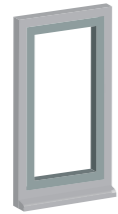

Fixed Sash



Side Hung

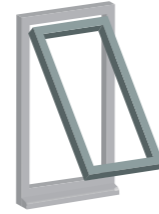

Top Hung

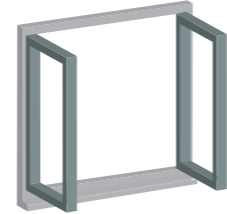

French / False Mullion\*

### Sliding Sash

(Shown from outside)

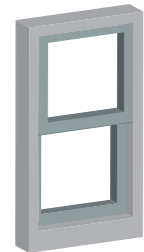

Fixed Sash

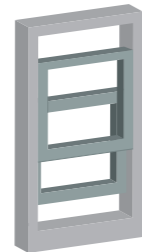

Sliding Sash

### Yorkshire Sash

(Shown from outside)

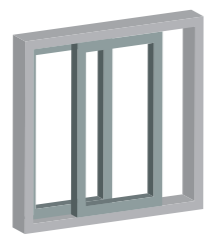

Right Sliding



Left Sliding



Double Sliding

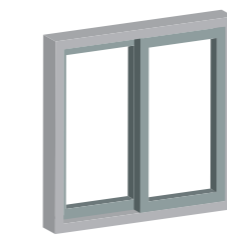

Fixed Sash

## Bay & Bow layout options

### Casement

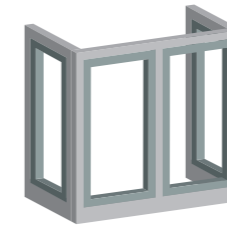

Square Bay

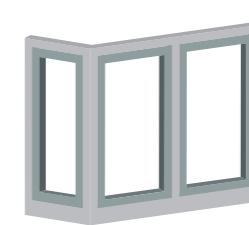

Angled Bay

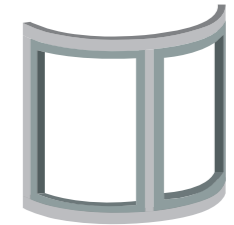

Bow

### Sliding Sash

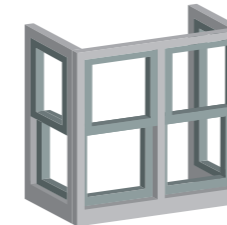

Square Bay

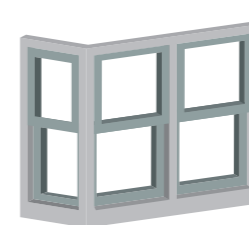

Angled Bay

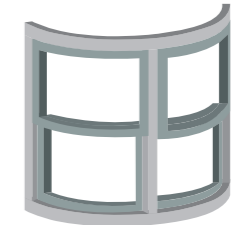

Bow

## Round work / Arches options

### Casement



Arch Top



Internal Arch

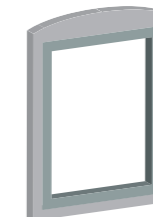

Arch Fillet

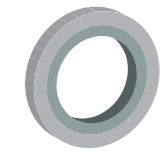

Circular

### Sliding Sash



Arch Top



Internal Arch

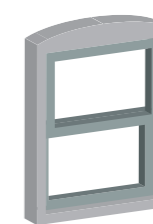

Arch Fillet

\*The French option has the two sash rails meeting together, whereas the false mullion option has the frame mullion attached to the second sash to visually replicate a mullion when closed.

# Window Frame, Glazing Bead & Sash Bar Options

## Casement windows

For outward opening flush casement windows, the following options will need to be specified. Please note, matching sash bead and astragal bar profiles are available.

### Internal frame profile

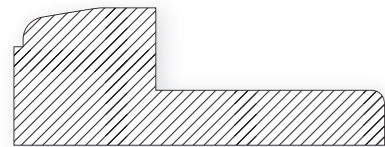

Standard

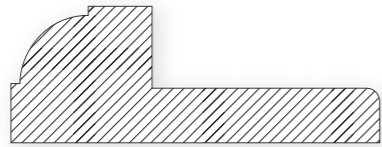

Ovolo

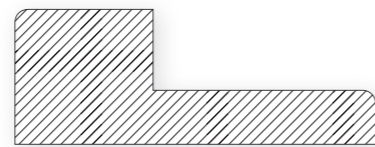

Square

### Extended frame profile

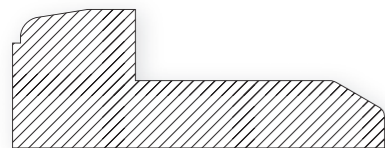

Bevelled Extended

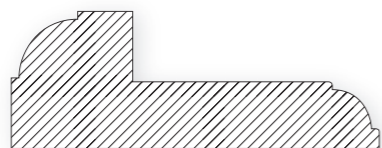

Ovolo Extended

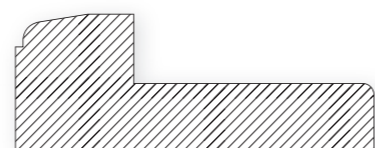

Square Extended

### Drips

If your windows are fitted flush with the outside brickwork, we recommend that a head drip is fitted.

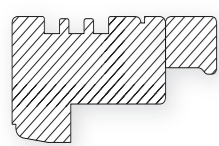

Head Drip

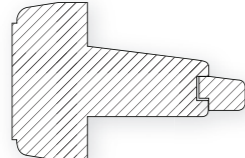

Transom Drip  
Type 1

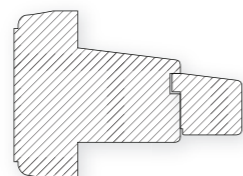

Transom Drip  
Type 2

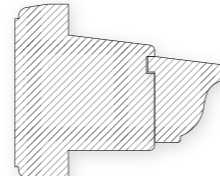

Transom Drip  
Type 3

## Sliding sash windows

Applicable only to sliding sash windows, top and/or bottom sashes can be specified with traditional sash horns. We offer the following types, but if required we can match existing designs.

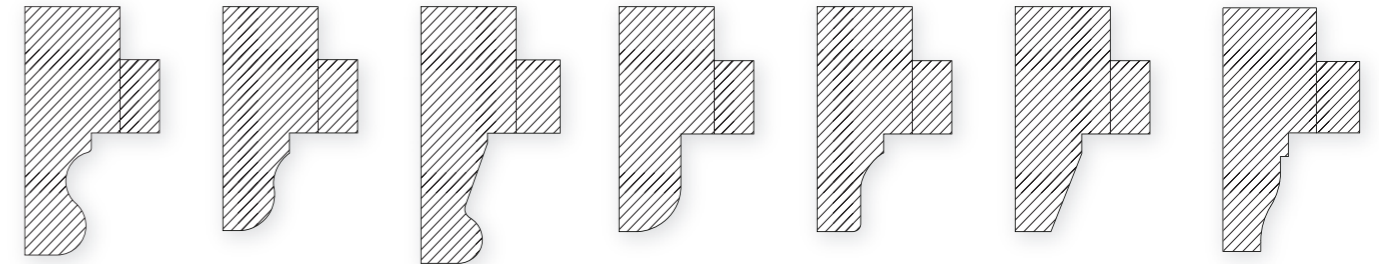

Type A

Type B

Type C

Type D

Type E

Type F

Type G

## Sash profiles & glazing bar options

Our externally glazed system has a range of sash profiles and glazing bars, allowing for an accurate match with existing designs.

We have a wide range of sash profiles that allow us to match almost any original glazing system, as shown below. Our standard range uses a 44mm sash, but we have a variety of thicknesses available to suit specific requirements.

The glazing bars are matched with the outside sash profile. A solid glazing bar measures 21mm for single glazing and 24mm for narrow cavity insulated glazing.

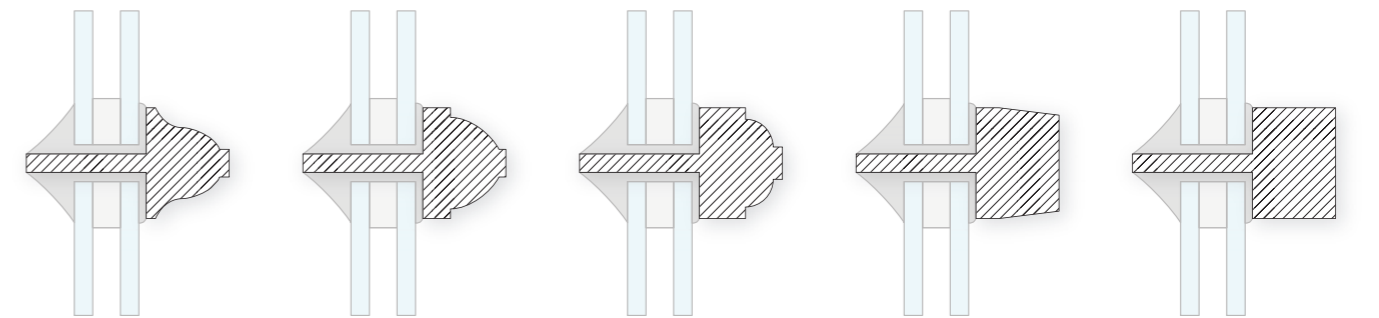

Lambs Tongue

Gothic

Ovolo

Bevelled

Square

# Glazing Units

Due to historic timber windows and doors featuring narrow sashes and sightlines, the specification of double-glazed units becomes more complicated.

Over recent years, narrow cavity insulated glazing has been developed to overcome these challenges. Commonly referred to as slim double-glazing, narrow cavity insulated glazing has a smaller cavity compared to conventional double-glazing which results in a smaller overall thickness. With a narrower cavity, there is the requirement of specific gases to provide thermal insulation and advanced edge seals to space and seal the gas.

## Glazing unit options

Working with leading glazing suppliers we offer three types of glazing, all of which have proven test data to ensure that they meet our exacting performance requirements. The glazing option that you choose will depend upon conservation planning requirements, your own personal preference and the allocated budget. The types of glazing units that we offer are summarised below:

### Historic narrow cavity glazing unit

This is our standard narrow cavity insulated glazing option. With a cavity of 6mm, this unit incorporates a warm edge spacer bar and Krypton gas to provide good thermal insulation. Glazing finishes offered with this unit are as follows:

- Hand drawn glass
- Machine drawn glass
- Decorative glass
- Acoustic glass
- Thermal laminates
- Obscure glass

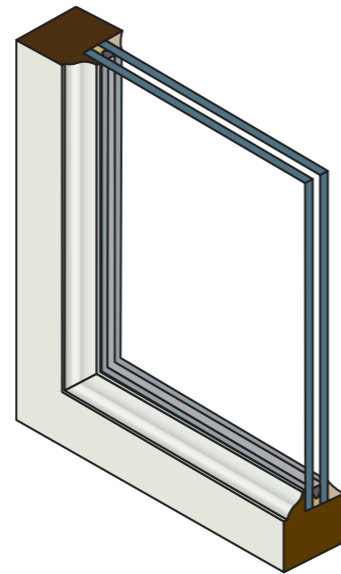

Glazing Style	Safety Type	Thermal		Acoustic	Delivery	Price
		U glass	U window	Rw		
Barnsdale Historic	Toughened or Laminated	1.2 – 2.1	1.5 – 2.1	31-35	Standard	£££

### Single glazing unit

We offer single glazing in a range of thicknesses. Glazing finishes offered with this unit are as follows:

- Hand drawn glass
- Machine drawn glass
- Decorative glass
- Acoustic glass
- Thermal laminates
- Obscure glass

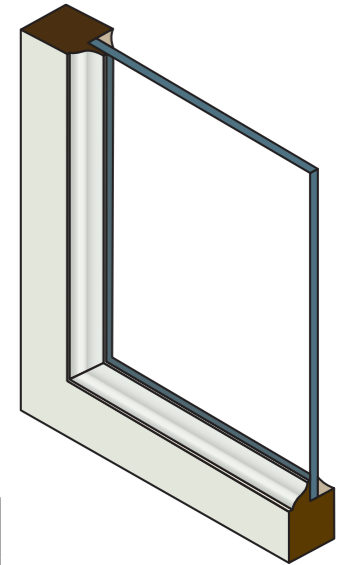

Glazing Style	Safety Type	Thermal		Acoustic	Delivery	Price
		U glass	U window	Rw		
Single Glazed	Toughened or Laminated	5.7	4.5	29	Standard	£

### Pilkington Spacia (vacuum glass) unit

By creating a vacuum between the two panes, this glass is the best performing and also the narrowest with a 0.2mm cavity. The use of this glass allows most products to meet the thermal performance criteria outlined in the Building Regulations. In order to achieve a vacuum, the glass uses micro spacers within the unit and has a plug in the corner (the point where the air is extracted). Whilst the plug is discreetly positioned, it is visible when stood within a few metres of the window.

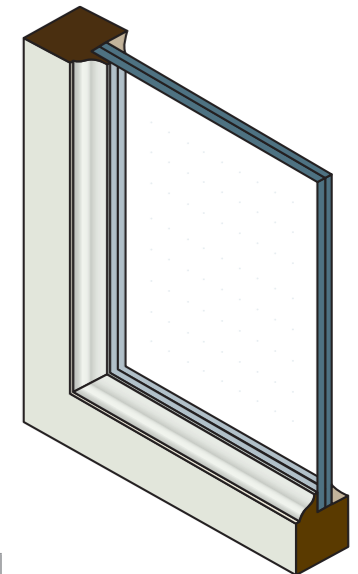

Glazing Style	Safety Type	Thermal		Acoustic	Delivery	Price
		U glass	U window	Rw		
Pilkington Spacia	Safety Film	1.1	1.6	34	+ 6 weeks	££££

# Timber Options

All of our timber is sustainably sourced and we can provide full FSC® chain of custody for our windows and doors upon request.

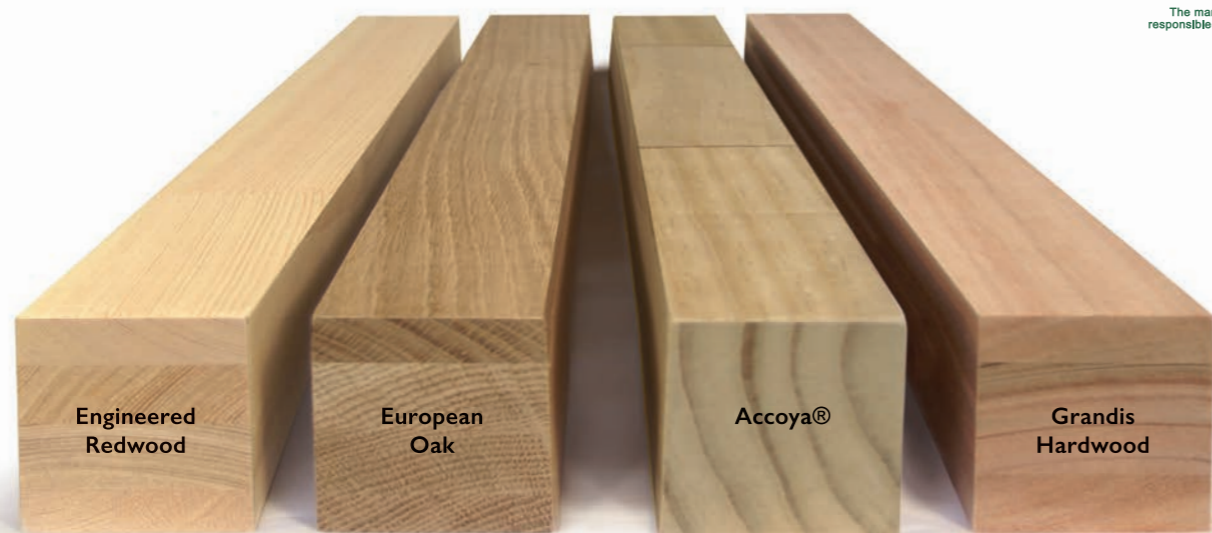

## Engineered Redwood

Engineered Redwood is an excellent timber species for products requiring a paint finish because the reduced moisture uptake and increased stability of the timber produces a substrate which enhances the coating's life span. Being free of knots and imperfections not only enhances the aesthetic effect but also prevents the risk of resin exudation damaging the coating.

## European Oak

European Oak is a very strong, durable hardwood that benefits from an attractive grain and colour. In the past, high quality windows and doors have been made from European Oak due to its durability. However, it has a tendency to move which can cause failure of the coating system and the glazing units. To overcome these problems we use knot free laminated European Oak which provides a greater amount of stability.

## Accoya®

Accoya® has earned the highest durability rating of any timber, surviving for 25 years when submerged, uncoated, in fresh water. It is our timber of choice in the manufacture of external profiles because it provides a durable, stable base for our advanced paint system, promoting a long lasting, low maintenance finished product. We recommend Accoya® for coastal areas.

## Grandis Hardwood

Grandis Hardwood provides a stable and durable substrate and is supplied as a three ply laminated material for extra stability. With its clear faced attractive grain pattern we manufacture all doors from Grandis as standard. We also recommend that Grandis is used to manufacture those products that require a stain finish.

# Paint and Stain Colours

The type of coating and how it is applied significantly contributes to the longevity of any timber window or door. We have spent years researching the application of timber coatings, so that our advanced system provides maximum protection to the timber, while allowing it to breathe and let its natural beauty show through.

We offer the following standard paint and stain colours. If the colour you require is not included in the options below, then we can match to a physical sample or to an existing RAL, Natural Colour System or British Standard colour reference.



## Paint colours\*



## Stain colours

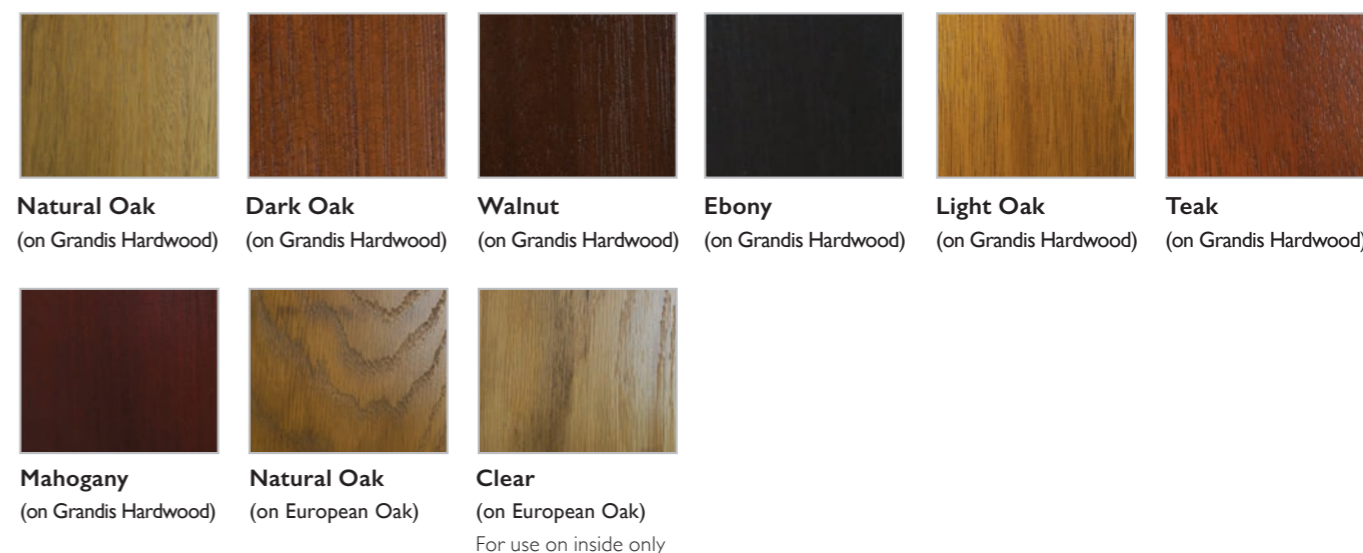

\*Due to print variations these colours may vary, please contact us for a physical paint sample

For more information please  
call 01775 823000  
email [enquiries@georgebarnsdale.co.uk](mailto:enquiries@georgebarnsdale.co.uk)  
or visit [www.georgebarnsdale.co.uk](http://www.georgebarnsdale.co.uk)

