

[01] EXISTING GROUND FLOOR PLAN - UNCHANGED @1:100

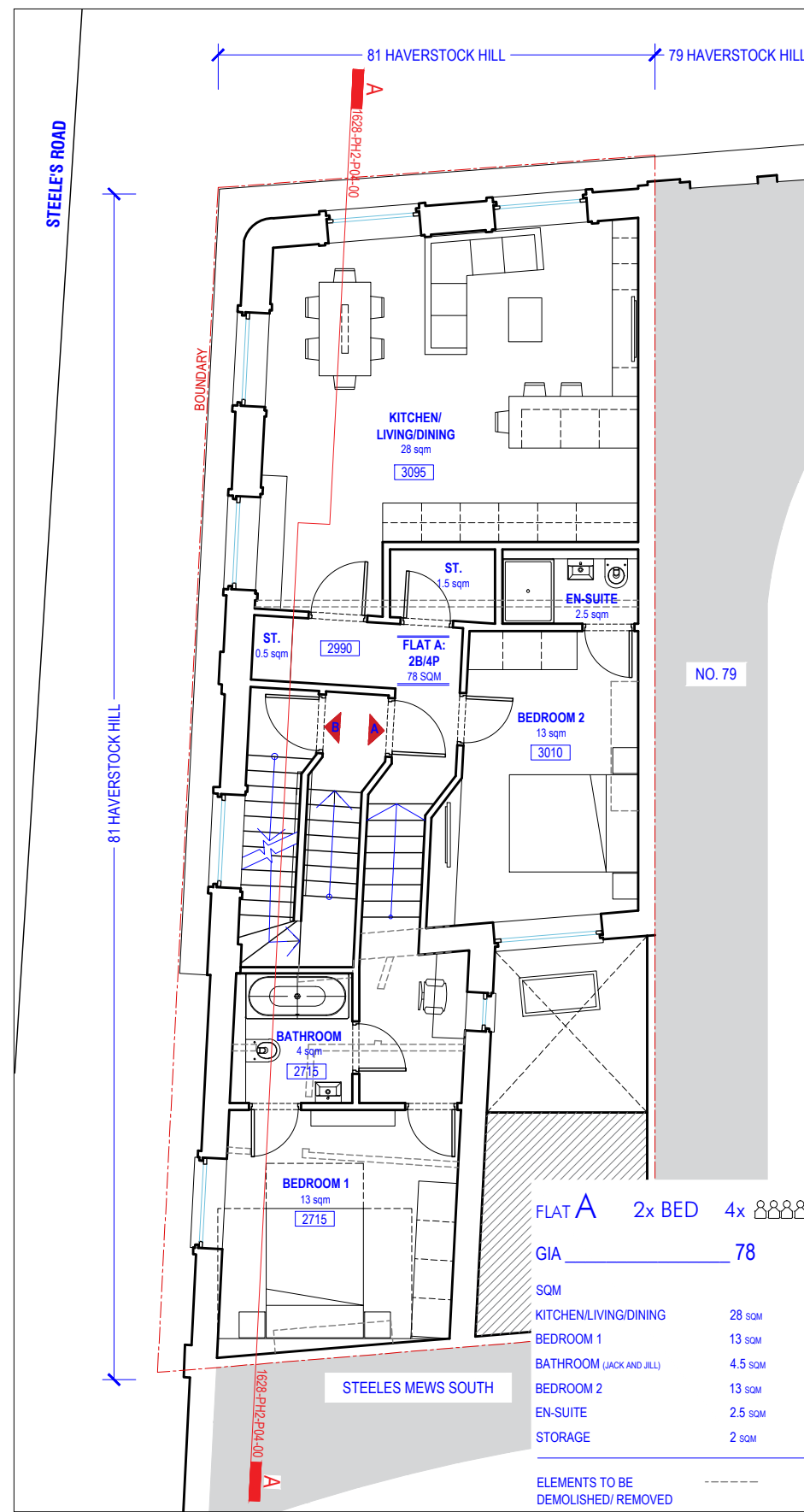

[02] PROPOSED FIRST FLOOR PLAN @1:100

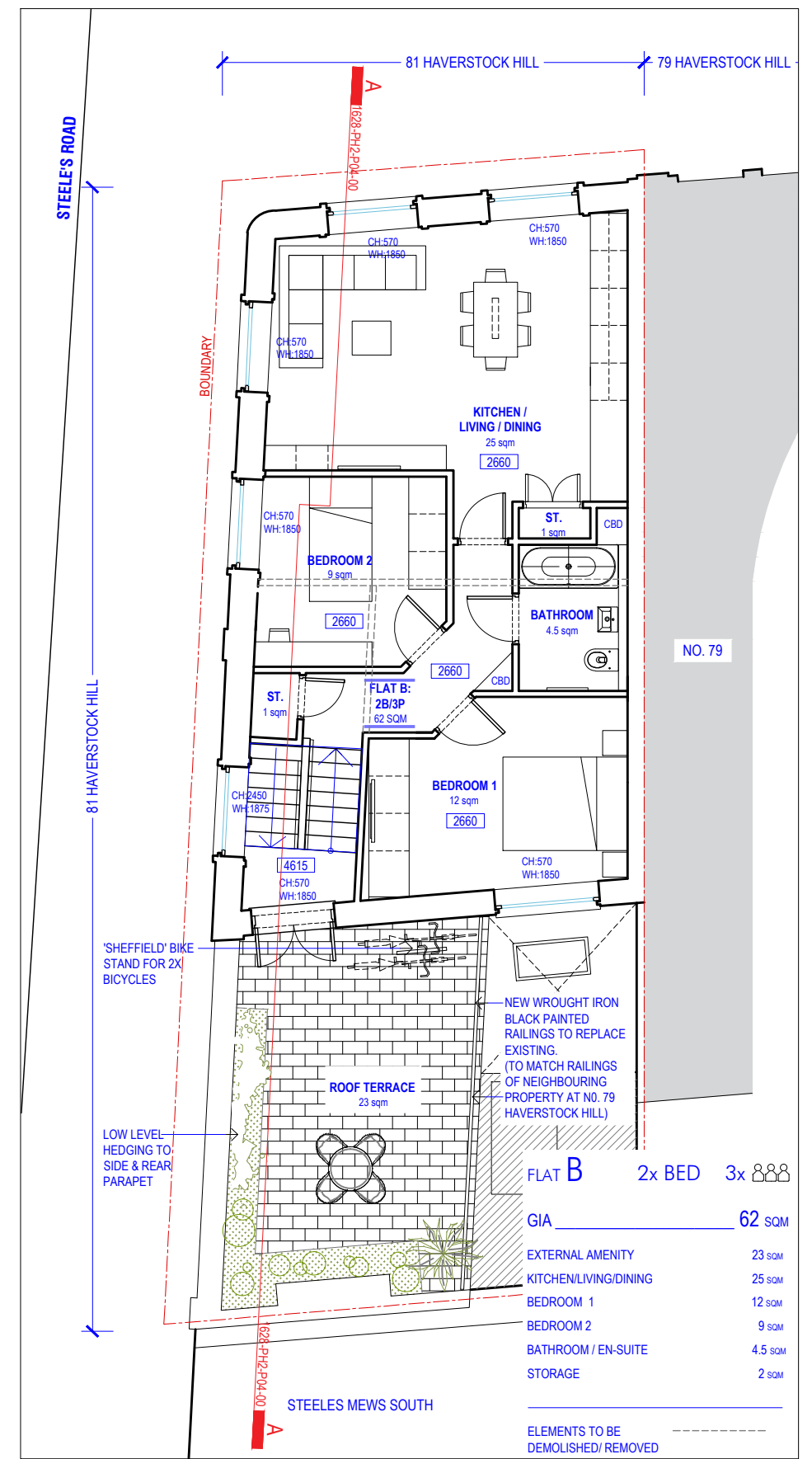

[03] PROPOSED SECOND FLOOR PLAN @1:100

NOTE:
DO NOT SCALE FROM DRAWINGS - EXCEPT FOR PLANNING PURPOSES.
ALL DISCREPANCIES TO BE REPORTED TO ARCHITECT IMMEDIATELY.
ALL DIMENSIONS TO BE VERIFIED BY CONTRACTOR ON SITE PRIOR TO THE COMMENCEMENT OF ANY WORKS.

P1 20/09/18 Full Planning Application Issue
P2 22/10/18 Minor Amendment to Drawings for Roof Terrace Railing

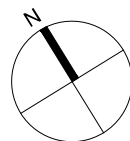

ISO-A3

VIVENDI ARCHITECTS LTD

Unit E3U, Bounds Green Industrial Estate, Ringway, London N11 2UD
Tel/Fax +44 (0)20 3232 4000 - email: info@vivendiarchitects.com

© VIVENDI ARCHITECTS LTD 2009
All rights reserved. Including but not limited to The Copyright, Designs and Patents Act 1988

PROJECT TITLE:
81 HAVERSTOCK HILL, LONDON NW3 4SL

DRAWING TITLE:
Proposed Floor Plans

CLIENT:
AMAK PROPERTY INVESTMENTS LTD.

DRAWN:
SM
CHECKED:
PK
ISSUED BY:
PK

STATUS:
PLA
SCALE AT A3:
1:100
REVISION:
P2

JOB AND DRAWING NO.:

1628-PH2-P02-00